

PROJECT REFERENCE NO. <i>R-5737</i>	SHEET NO. <i>EC-22/CONST.08</i>
RW SHEET NO.	
ROADWAY DESIGN ENGINEER	HYDRAULICS ENGINEER

CURVE DATA FOR -Y2-

PI Sta 27+77.03 $\Delta = 3^{\circ}49'11.0"$ (LT) D = 154'35.5" L = 200.00' T = 100.04' R = 3,000.00' Se = EXIST.	PI Sta 29+80.99 $\Delta = 6^{\circ}42'23.1"$ (LT) D = 313'40.6" L = 207.76' T = 104.00' R = 1,775.00' Se = EXIST.	PI Sta 31+83.69 $\Delta = 32^{\circ}20'34.3"$ (LT) D = 1647'33.9" L = 192.60' T = 98.94' R = 341.9' Se = EXIST.
---	---	---

CURVE DATA FOR -L-

PI Sta 70+27.77 $\Delta = 15^{\circ}12'24.7"$ (RT) D = 1033'25.6" L = 1,438.52' T = 723.51' R = 5,420.00' Se = 0.03 Runoff = 150'	PI Sta 77+82.77 $\Theta_s = 0^{\circ}38'03.4"$ Ls = 120.00' LT = 80.00' ST = 40.00'
--	---

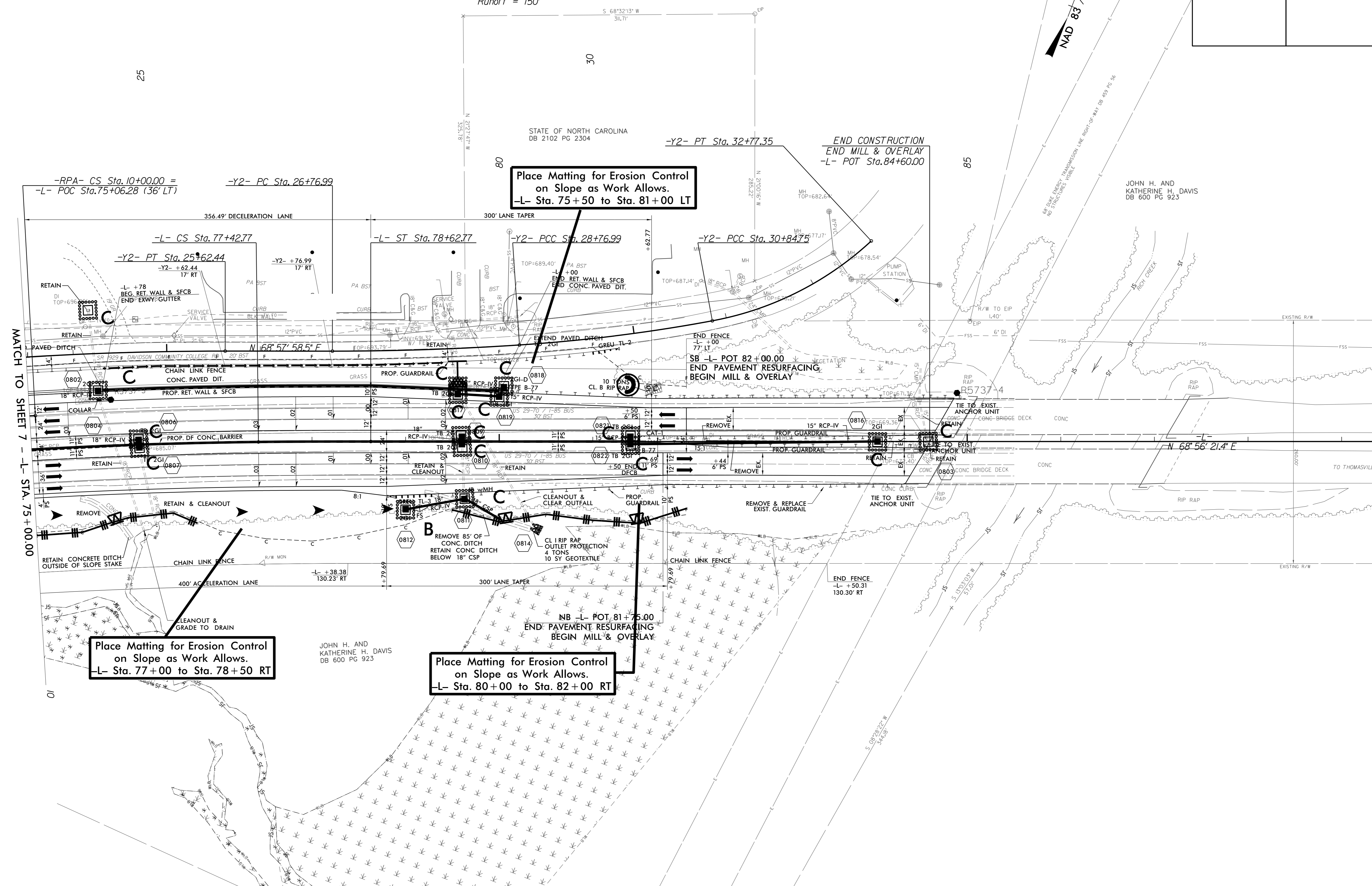

MATCH TO SHEET 7 - L- STA. 75 + 00.00

