

4 BREAK PROPOSED CURB & GUTTER FROM -Y1- STA. 24+14 TO -Y1- STA. 24+34 IN ORDER TO ACCOMODATE THE PHASE III, STEP 3 TEMPORARY DRIVEWAY CONNECTION

RETAIN PHASE II DETOUR AND USE TO MAINTAIN BUSINESS INGRESS AND EGRESS

REINSTALL TYPE III BARRICADES WITH SIGN R11-4 ATTACHED AT THE INTERSECTION OF -Y6- AND -L- AS SHOWN ON SHEET TMP-30.

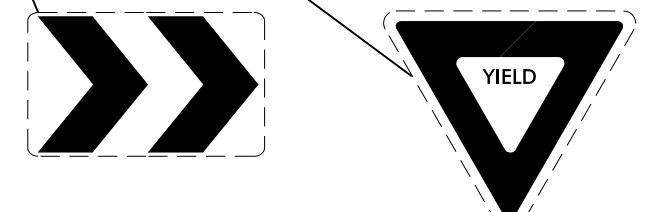
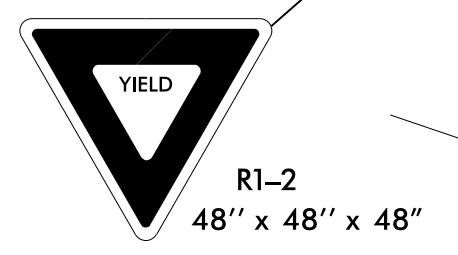
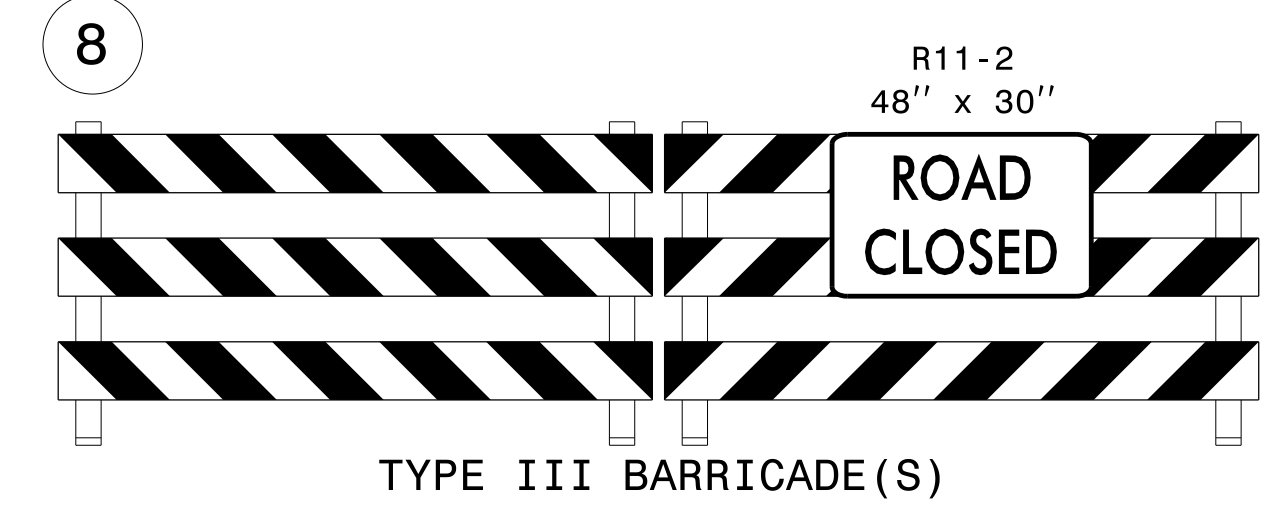
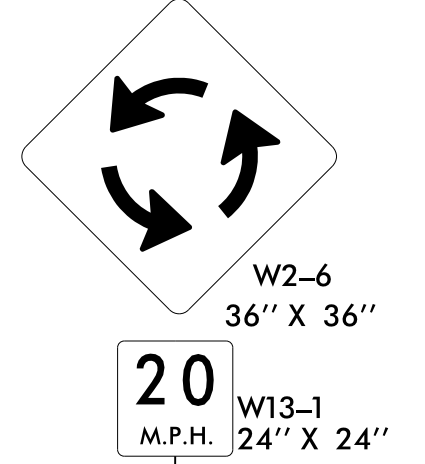

TEMPORARY PAVEMENT MARKING		
PAVEMENT MARKING LINES:		
P13	YELLOW DOUBLE CENTER	PAINT (4")
P40	WHITE GORELINE	PAINT (8")
P42	YELLOW DIAGONAL	PAINT (8")
P46	WHITE CROSSWALK	PAINT (8")
P55	3FT-3FT WHITE MINISKIP	PAINT (12")

MOTORISTS WISHING TO ACCESS NB US 29 / EB US 70 WILL UTILIZE THE EVANS ROAD DETOUR SHOWN ON SHEET TMP-22. CONTRACTOR TO MAINTAIN APPLICABLE DETOUR SIGNING AND DEVICES.

SEE ICT FOR PHASE III, STEP 9 WORK PERFORMED UNDER A ROAD CLOSURE

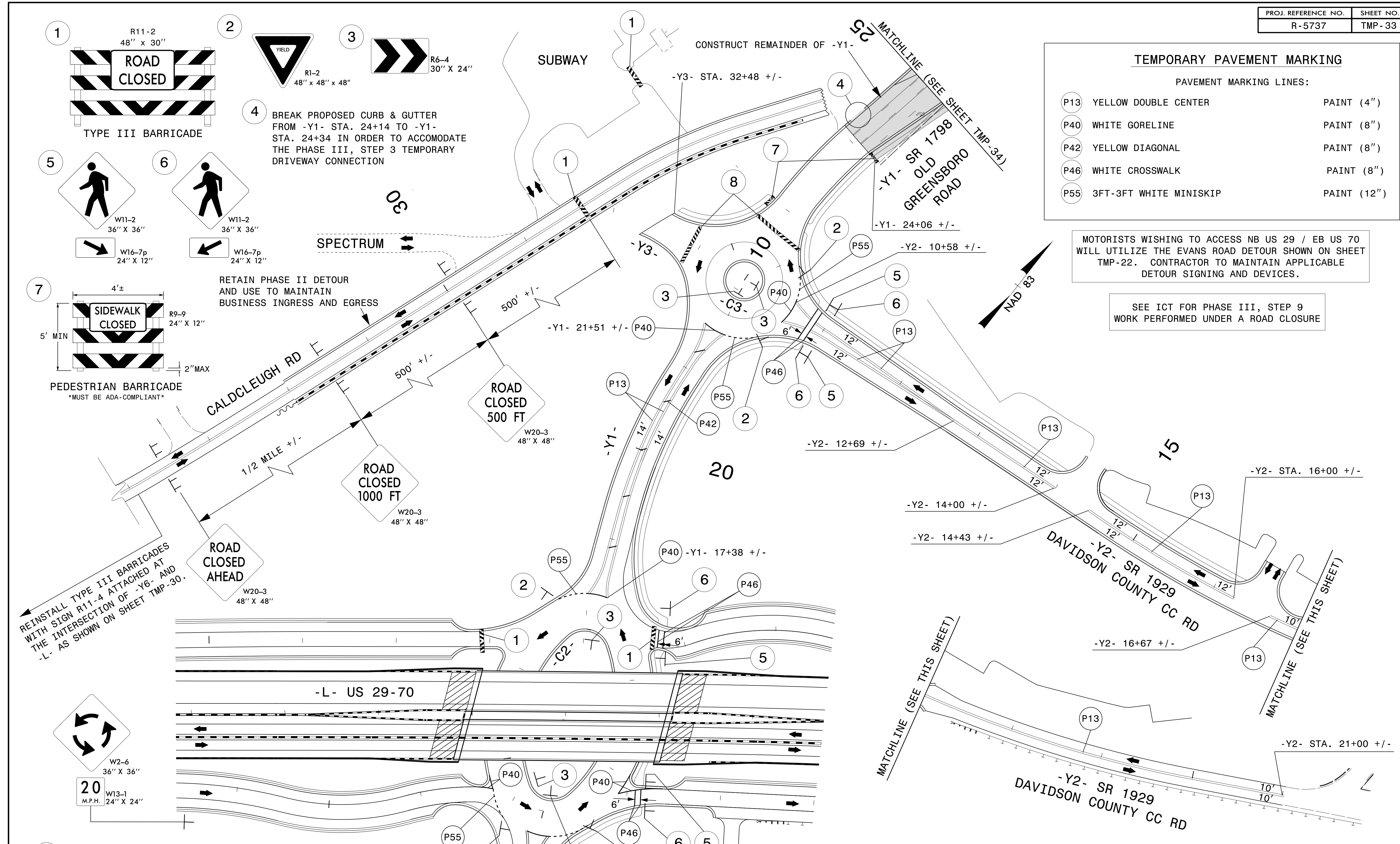

04-AUG-2021 08:46 P:\50064071\CAD\CIVIL\5737\TrafficControl\Plans\Alternative\5737_TCP_ICP_33.dgn AT PF2JAC4N mlshok

Dewberry
2610 WYCLIFF ROAD
SUITE 410
RALEIGH, NC 27607
PHONE: 919.881.9939
NC COA No. F-0929

APPROVED: _____
DATE: _____
SEAL

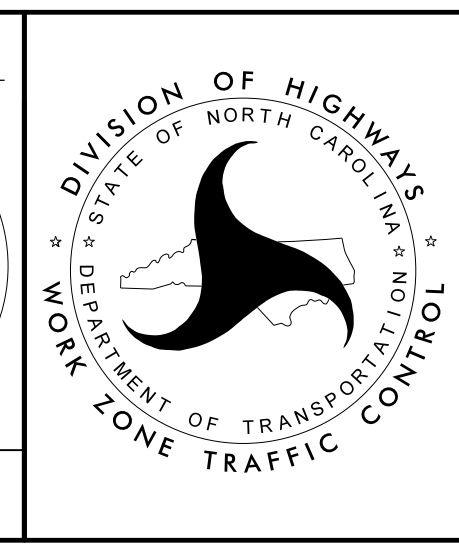

PHASE III DETAIL

DOCUMENT NOT CONSIDERED FINAL UNLESS ALL SIGNATURES COMPLETED