

DETOUR ROUTE FROM US 29-70  
 ● — ● — ●  
 DETOUR LENGTH = 2.4 MILES

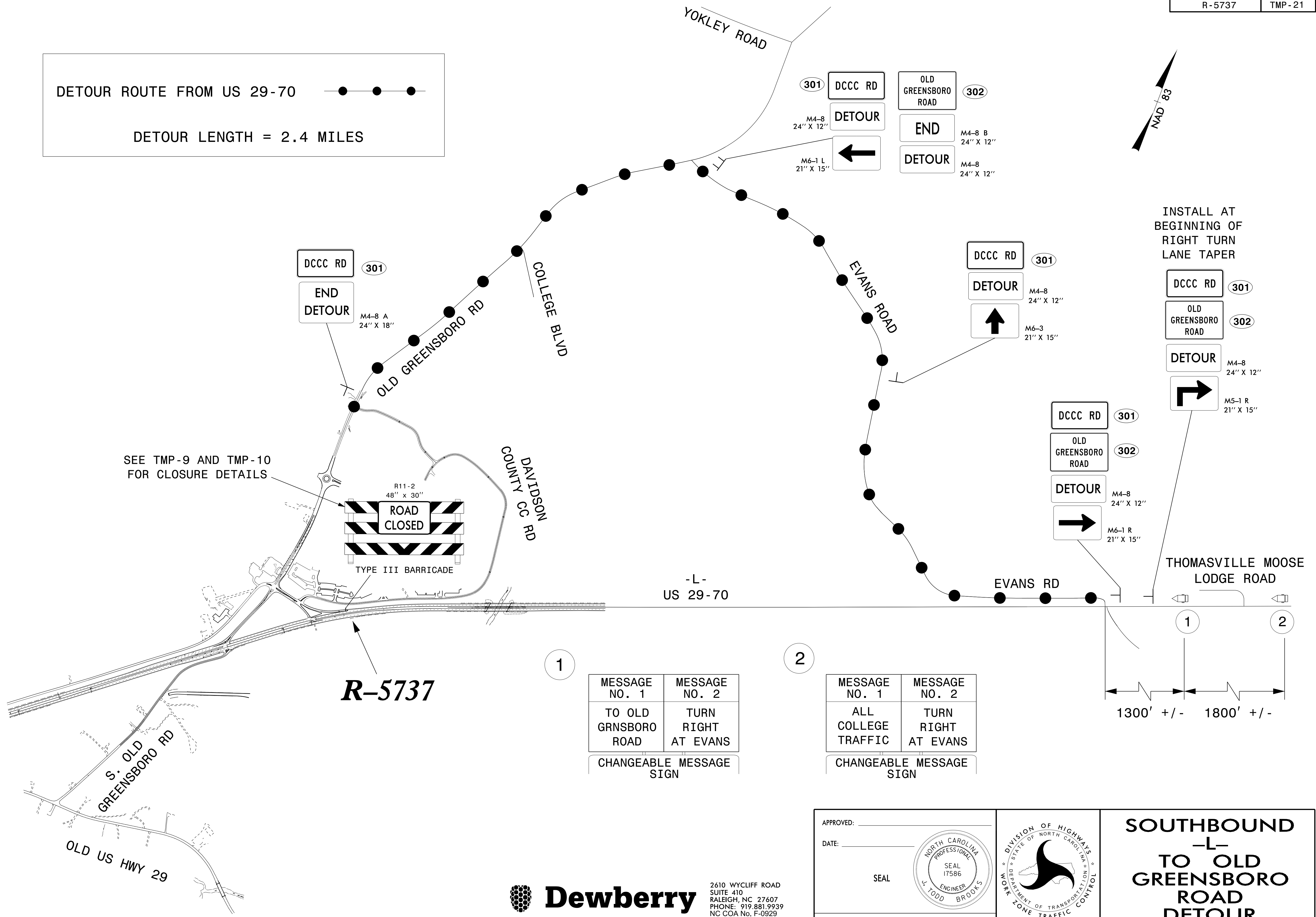
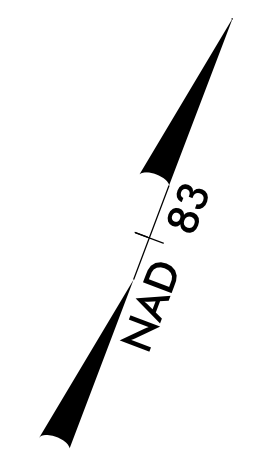

SEE TMP-9 AND TMP-10  
 FOR CLOSURE DETAILS

**R-5737**

MESSAGE NO. 1	MESSAGE NO. 2
TO OLD GRNSBORO ROAD	TURN RIGHT AT EVANS
CHANGEABLE MESSAGE SIGN	

MESSAGE NO. 1	MESSAGE NO. 2
ALL COLLEGE TRAFFIC	TURN RIGHT AT EVANS
CHANGEABLE MESSAGE SIGN	

1300' +/- 1800' +/-

13-JUL-2021 10:37  
 P:\5006407\NCAD\CIVIL\N5737\TrafficControl\CP\Plans\Alternative\N5737\_TCP\_TCP\_21.dgn  
 AT PC00A13J  
 abeshears

**Dewberry**  
 2610 WYCLIFF ROAD  
 SUITE 410  
 RALEIGH, NC 27607  
 PHONE: 919.881.9939  
 NC COA No. F-0929

APPROVED: \_\_\_\_\_  
 DATE: \_\_\_\_\_  
 SEAL  
  
 DOCUMENT NOT CONSIDERED FINAL  
 UNLESS ALL SIGNATURES COMPLETED

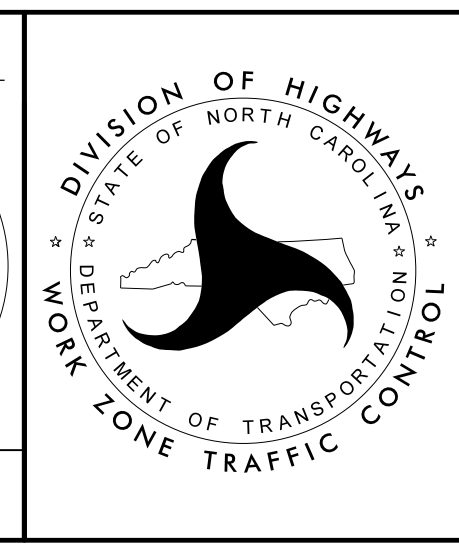

**SOUTHBOUND**  
 -L-  
**TO OLD GREENSBORO ROAD**  
**DETOUR**