

09/06/19

TIP PROJECT: R-5737

STATE	STATE PROJECT REFERENCE NO.	SHEET NO.	TOTAL SHEETS
N.C.		RW01	

STATE OF NORTH CAROLINA
 DIVISION OF HIGHWAYS
 SURVEY CONTROL, EXISTING CENTERLINES,
 RIGHT OF WAY, EASEMENTS AND PROPERTY TIES
DAVIDSON COUNTY

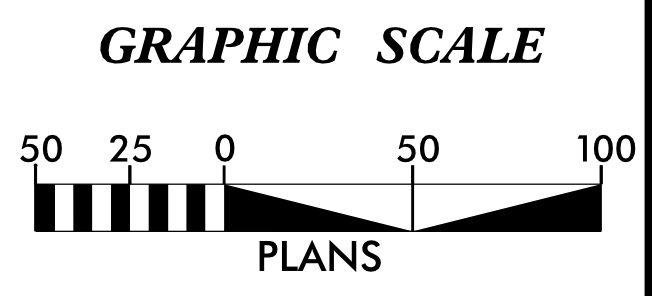
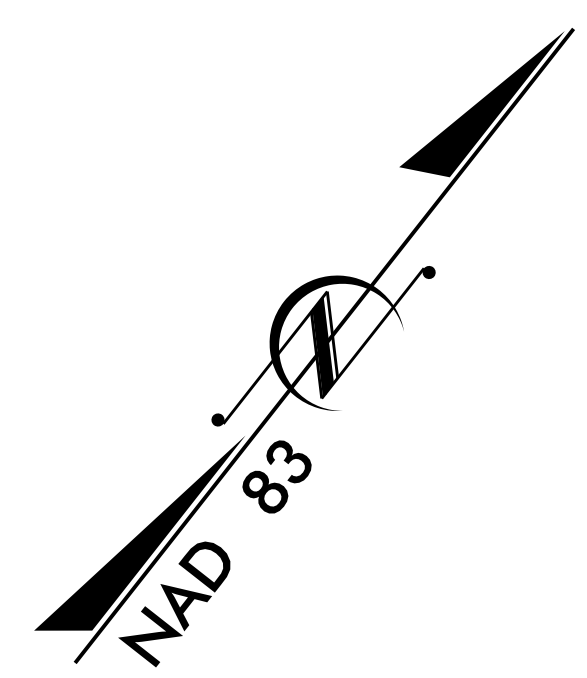
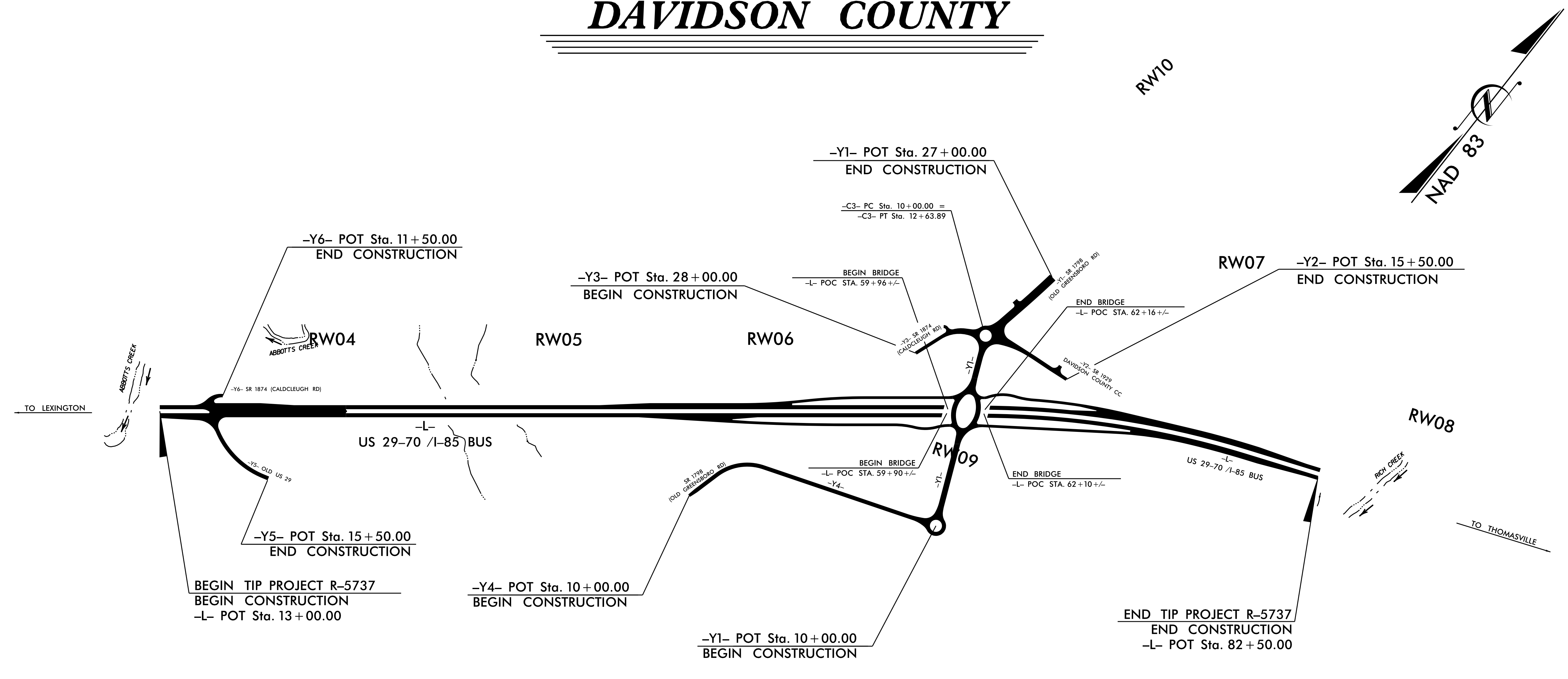

DATUM DESCRIPTION

THE LOCALIZED COORDINATE SYSTEM DEVELOPED FOR THIS PROJECT IS BASED ON THE STATE PLANE COORDINATES ESTABLISHED BY NCDOT GPS MONUMENT "R5737-3" WITH NAD 83/NA 2011 STATE PLANE GRID COORDINATES OF NORTHING: 771,624.696(ft) EASTING: 1,650,463.369(ft) ELEVATION: 687.380 (ft) THE AVERAGE COMBINED GRID FACTOR USED ON THIS PROJECT (GROUND TO GRID) IS: 0.99990171 THE N.C. LAMBERT GRID BEARING AND LOCALIZED HORIZONTAL GROUND DISTANCE FROM "R5737-3" TO -L- STATION 10+00.00 IS S 53-00'47.4" W 6,585.32(ft) ALL LINEAR DIMENSIONS ARE LOCALIZED HORIZONTAL DISTANCES VERTICAL DATUM USED IS NAVD 88/GEOID G12NC

Prepared in the Office of:

2018 STANDARD SPECIFICATIONS

RIGHT OF WAY DATE: AUGUST 18, 2018	LETTING DATE: AUGUST 14, 2019
---------------------------------------	----------------------------------

PROFESSIONAL LAND SURVEYOR

DocuSigned by:

 408CE025263344E...
 SIGNATURE: _____ Date: _____

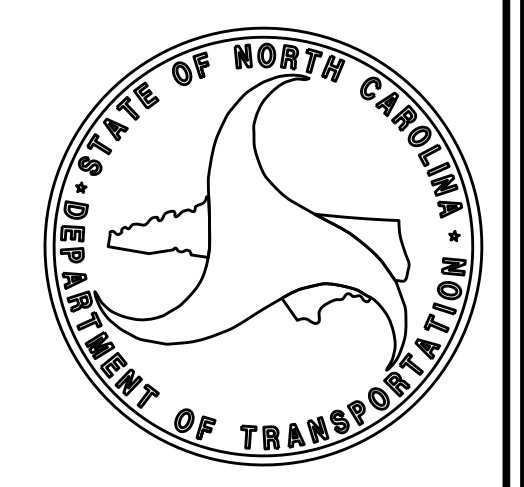

\$\$\$\$\$ SYSTEM \$\$\$\$\$\$
 \$\$\$ DDN \$\$\$
 \$\$\$ USERNAME \$\$\$