

5/28/99

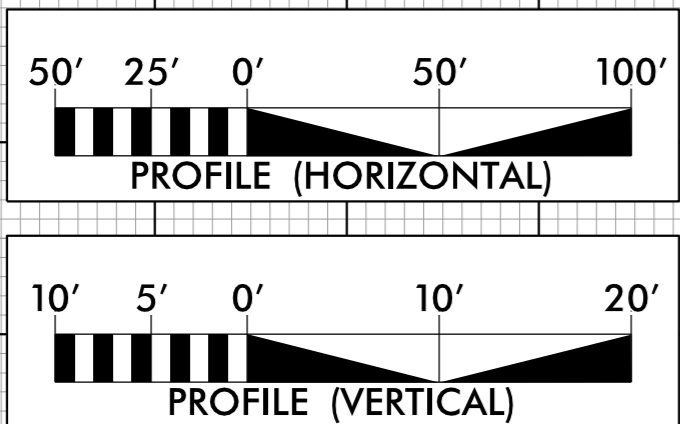

# -WL2-

PROJECT REFERENCE NO.	SHEET NO.
R-5014	UC-18
DESIGNED BY: DMD	
DRAWN BY: DMD/MNG	
CHECKED BY: JDB	
APPROVED BY: CMT	
REVISED:	
NORTH CAROLINA DEPARTMENT OF TRANSPORTATION UTILITIES ENGINEERING SEC. PHONE: (919) 707-6690 FAX: (919) 250-4151	
UTILITY CONSTRUCTION PLANS ONLY	

**UTILITY CONSTRUCTION**

**DOCUMENT NOT CONSIDERED FINAL  
UNLESS ALL SIGNATURES COMPLETED**

# -WL3-

NOTE:  
1. WHEN DEPTH OF COVER ABOVE THE PROPOSED WATERLINE IS LESS THAN 3', TRANSITION TO DUCTILE IRON AND ENCASE IN CONCRETE. SEE DETAIL C ON SHEET UC-3E.

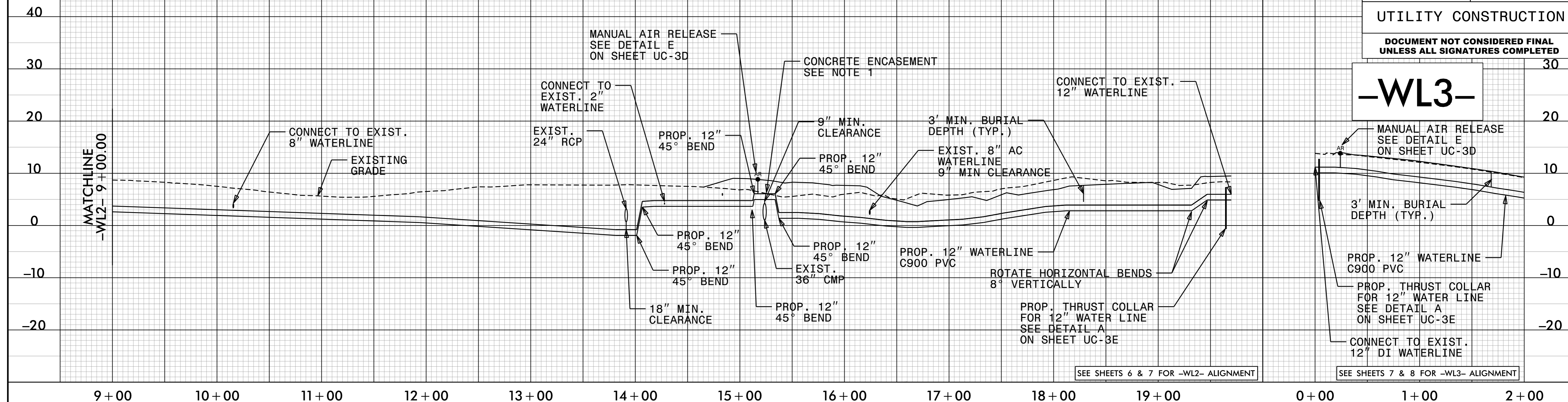

SEE SHEETS 6 & 7 FOR -WL2- ALIGNMENT

SEE SHEETS 7 & 8 FOR -WL3- ALIGNMENT

# -WL3-

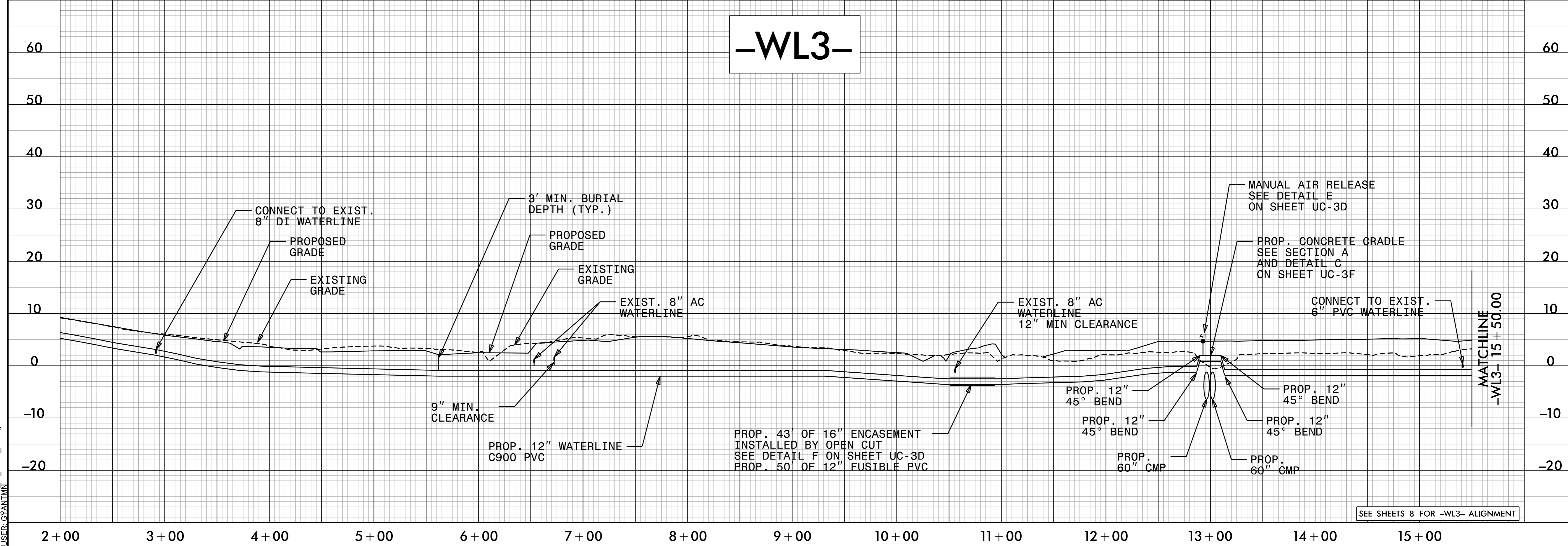

SEE SHEETS 8 FOR -WL3- ALIGNMENT

SYSTEM: R09014\_U\_UC18\_pst.dgn  
USER: CANTANK