

PROJECT REFERENCE NO. R-5014	SHEET NO. <i>EC-36/CONST.19</i>
RW SHEET NO.	HYDRAULICS ENGINEER
ROADWAY DESIGN ENGINEER	

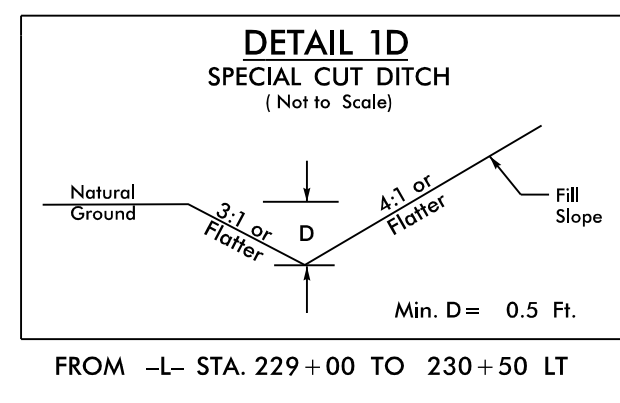
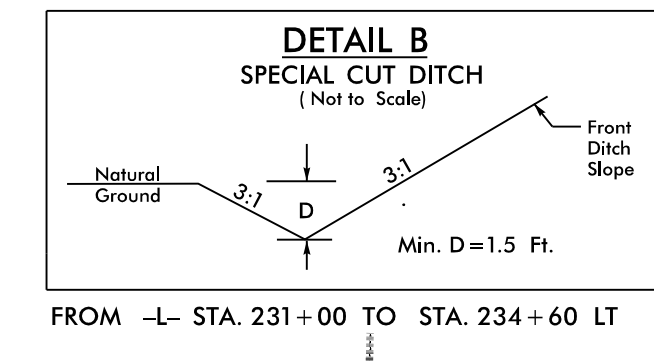

- (134) LOINGOC TRAN
DB 1599 - PG 54
PB A - PG 372
- (135) JOSEPH ANDREW LIVERMAN
DB 282 - PG 364
PB A - PG 372
- (136) MICHAEL A. MCVAUGH
DB 1744 - PG 420
PB A - PG 372

ALL CONSTRUCTION PERFORMED OUTSIDE OF THE EXISTING RIGHT OF WAY IS ALLOWED THROUGH SPECIAL USE PERMIT # USA 18 5700 16

END OVERLAY - BEGIN GRADE
-L- STA. 229+00.00

NO CLAIM
(132)

UNITED STATES DEPARTMENT OF INTERIOR
DB 78 - PG 206

MATCH LINE -L- STA. 221+50.00
SEE SHEET 18

MATCH LINE -L- STA. 233+50.00
SEE SHEET 20

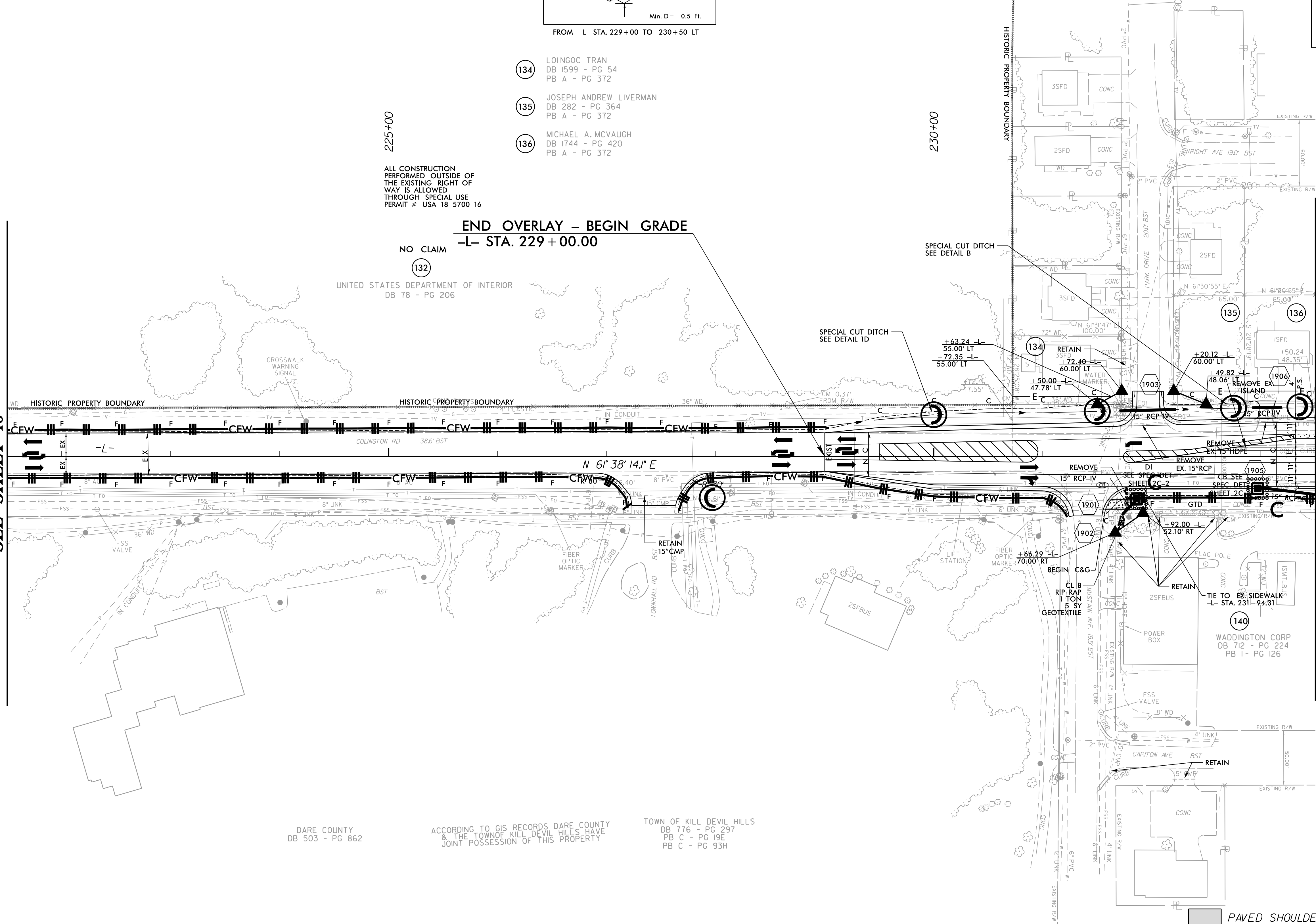

DARE COUNTY
DB 503 - PG 862

ACCORDING TO GIS RECORDS DARE COUNTY & THE TOWN OF KILL DEVIL HILLS HAVE JOINT POSSESSION OF THIS PROPERTY

TOWN OF KILL DEVIL HILLS
DB 776 - PG 297
PB C - PG 19E
PB C - PG 93H

PAVED SHOULDER
SIDEWALK / CONCRETE ISLAND
GTD = GRADE TO DRAIN

NOTES:
DRIVEWAY RADII ARE 5' UNLESS OTHERWISE NOTED
SEE SHEET 28 FOR -L- PROFILE
SEE SHEET 2B-1 FOR INTERSECTION DETAIL

RIGHT OF WAY REVISION - 06/06/2018 - ADJUSTED ROW ON PARCEL 134,135 & 140. ADJUSTED CONSTRUCTION EASEMENT ON PARCEL 134,135 & 136

REVISIONS
1/5/2018
K:\Projects\Commentary\Design\RE014_hyd_EC_psh_36.dwg
10:50:00

8/17/99