

8/17/99

**CALYX**  
ENGINEERS + CONSULTANTS  
6750 TRYON ROAD  
CARY, NC 27518  
PHONE: 919.851.1912  
CALYXengineers.com  
NC License # F-1333  
Formerly Hubbs Engineers & Consultants

PROJECT REFERENCE NO. <b>R-5014</b>	SHEET NO. <i>EC-34/CONST.17</i>
RW SHEET NO.	
ROADWAY DESIGN ENGINEER	HYDRAULICS ENGINEER

-L-  
PI Sta 209+11.27  
 $\Delta = 62^{\circ}13'20.7"$  (LT)  
 $D = 6^{\circ}05'00.0"$   
 $L = 1,022.83'$   
 $T = 568.41'$   
 $R = 941.85'$   
 $SE = EXIST.$   
 $V = 50$  MPH

ALL CONSTRUCTION PERFORMED OUTSIDE OF THE EXISTING RIGHT OF WAY IS ALLOWED THROUGH SPECIAL USE PERMIT # USA 18 5700 16

NO CLAIM

(132)  
UNITED STATES DEPARTMENT OF INTERIOR  
DB 78 - PG 206

NO CLAIM

(133)  
UNITED STATES DEPARTMENT OF INTERIOR  
DB 78 - PG 206

ALL CONSTRUCTION PERFORMED OUTSIDE OF THE EXISTING RIGHT OF WAY IS ALLOWED THROUGH SPECIAL USE PERMIT # USA 18 5700 16

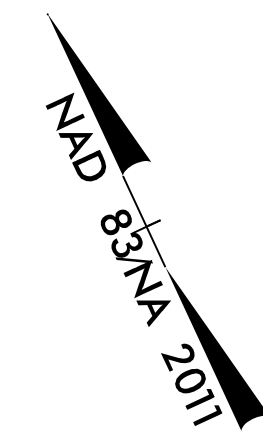

MATCH LINE -L- STA. 196+50.00  
SEE SHEET 16

MATCH LINE -L- STA. 209+50.00  
SEE SHEET 18

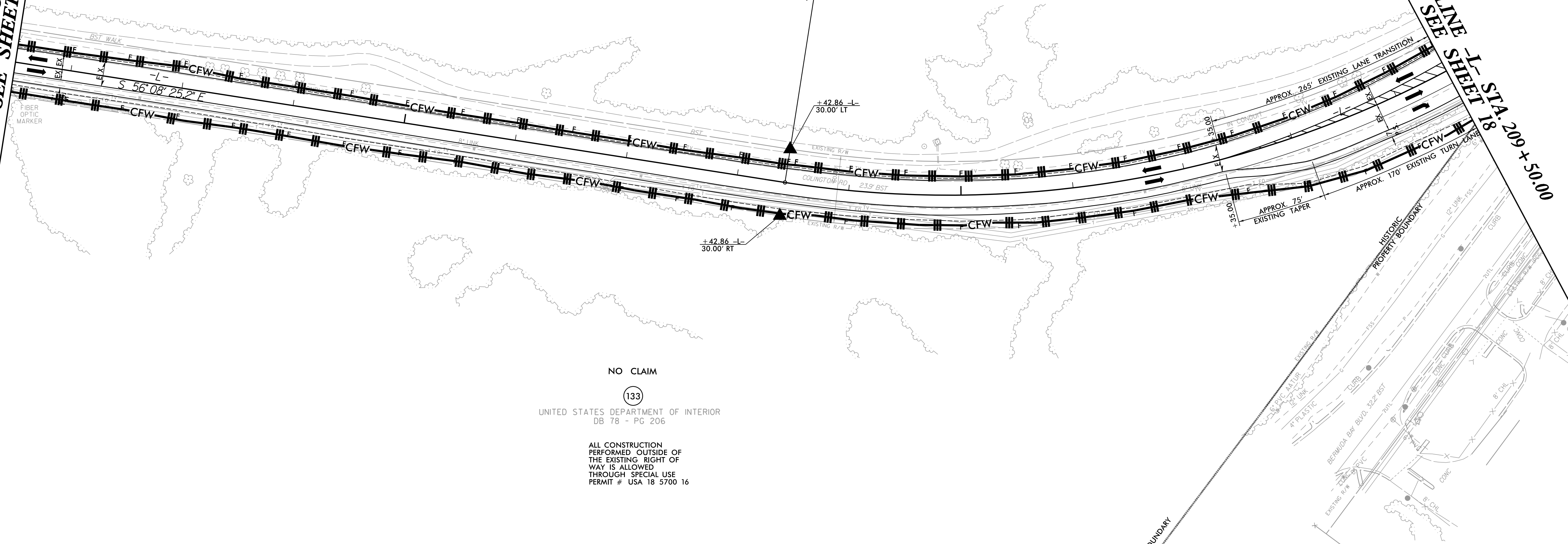

PAVED SHOULDER

NOTES:  
DRIVEWAY RADII ARE 10' UNLESS OTHERWISE NOTED  
SEE SHEET 27 AND 28 FOR -L- PROFILE

I:\5/2008  
R:\CADD\Commental\Design\RE014\_hyd\_EC\_psh\_34.dgn  
10/20/08