

PROJECT REFERENCE NO.	SHEET NO.
R-5014	EC-33/CONST.16
RW SHEET NO.	
ROADWAY DESIGN ENGINEER	HYDRAULICS ENGINEER

-L-  
PI Sta 187+68.88  
 $\Delta = 43^{\circ}02'44.8" (RT)$   
 $D = 4^{\circ}30'00.0"$   
 $L = 956.57'$   
 $T = 502.13'$   
 $R = 1,273.24'$   
 $SE = EXIST.$   
 $V = 55 MPH$

ALL CONSTRUCTION PERFORMED OUTSIDE OF THE EXISTING RIGHT OF WAY IS ALLOWED THROUGH SPECIAL USE PERMIT # USA 18 5700 16

NO CLAIM

132

UNITED STATES DEPARTMENT OF INTERIOR  
DB 78 - PG 206

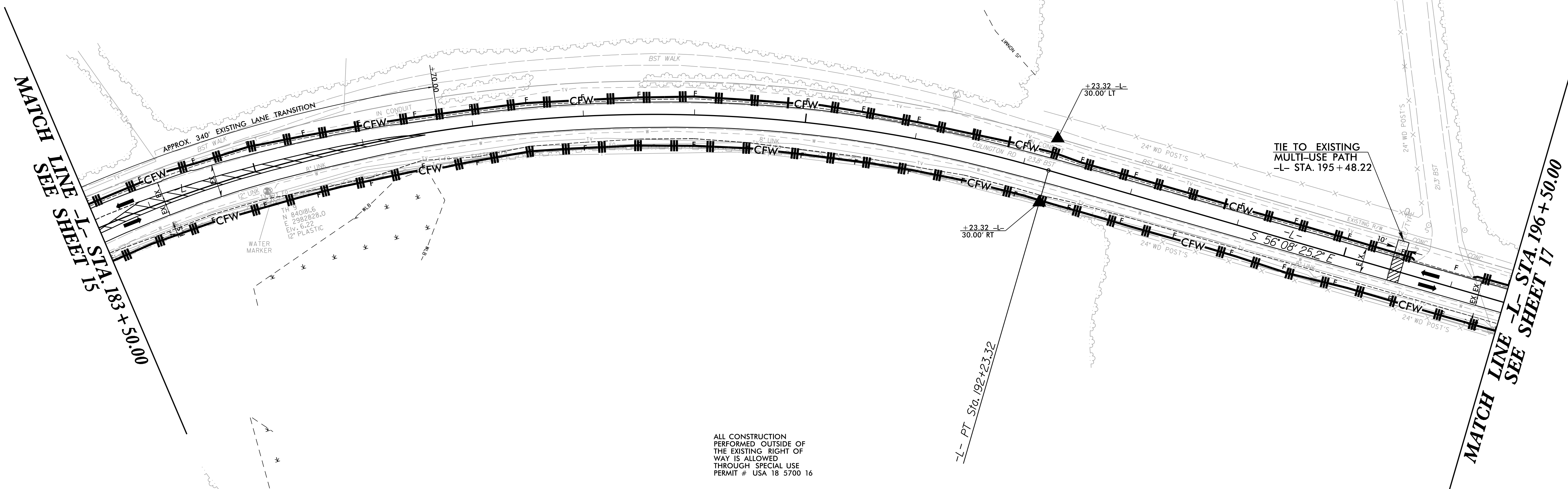
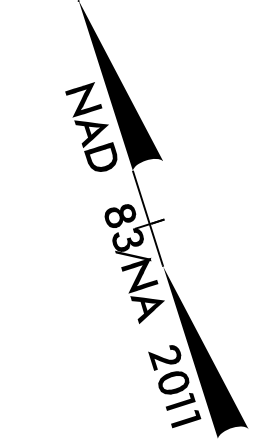

ALL CONSTRUCTION PERFORMED OUTSIDE OF THE EXISTING RIGHT OF WAY IS ALLOWED THROUGH SPECIAL USE PERMIT # USA 18 5700 16

NO CLAIM

133

UNITED STATES DEPARTMENT OF INTERIOR  
DB 78 - PG 206

PAVED SHOULDER

NOTES:  
DRIVEWAY RADII ARE 10' UNLESS OTHERWISE NOTED  
SEE SHEET 27 FOR -L- PROFILE

REVISIONS

8/17/99  
11/5/2018  
C:\Users\jason\Documents\Design\RE014\_hyd\_EC\_psh\_33.dwg  
jason