

09/08/19

STATE OF NORTH CAROLINA  
DIVISION OF HIGHWAYS

**JOHNSTON & WILSON COUNTY**

STATE	STATE PROJECT REFERENCE NO.	SHEET NO.	TOTAL SHEETS
N.C.	I-5936	1	
STATE PROJ. NO.	F.A. PROJ. NO.	DESCRIPTION	
45878.1.1		PE	
45878.3.1	0095074	CONST	
51209.1K		CONST	

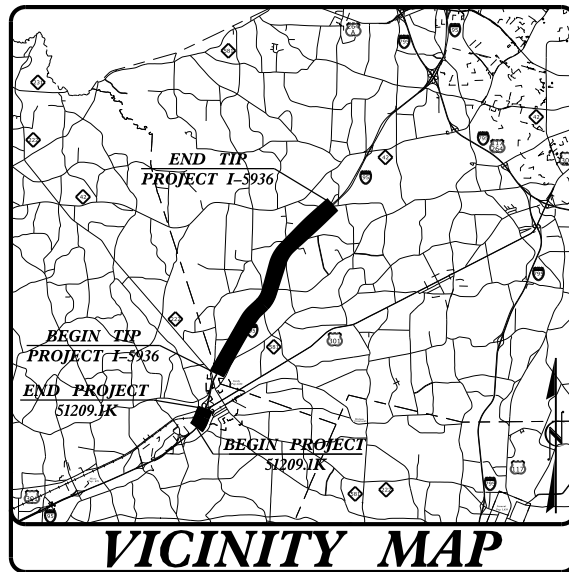

**LOCATION:** I-5936 45878.3.1 – I-95 FROM THE JOHNSTON COUNTY LINE TO SOUTH OF SR 1116 (GOVERNOR HUNT ROAD) MILE MARKER 114.50

51209.1K – I-95 FROM END OF CONSTRUCTION OF PROJECT I-5786 TO US-301 BRIDGE

**TYPE OF WORK:** PAVEMENT REHABILITATION

**TIP PROJECT: I-5936**

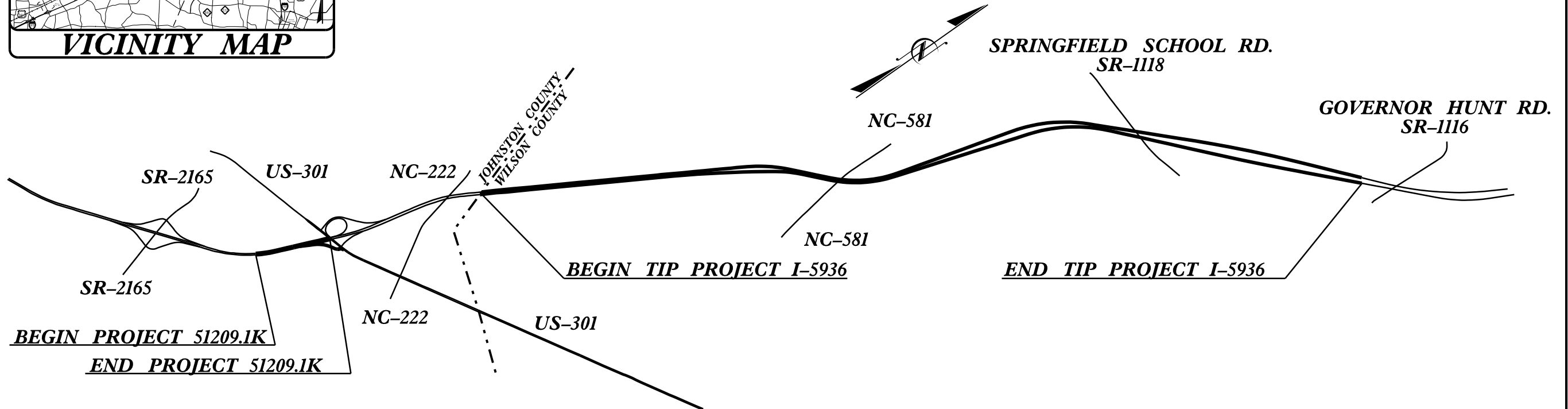

**CONTRACT: C204653**

NOT TO SCALE

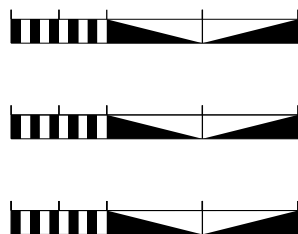

DESIGN DATA

FUNC CLASS =  
INTERSTATE

PROJECT LENGTH

LENGTH ROADWAY TIP PROJECT I-5936 SBL = 6.19 MI  
LENGTH ROADWAY TIP PROJECT I-5936 NBL = 6.19 MI  
LENGTH ROADWAY TIP PROJECT 51209.1K SBL = 0.40 MI  
LENGTH ROADWAY TIP PROJECT 51209.1K NBL = 0.40 MI

Prepared In the Office of:  
**DIVISION OF HIGHWAYS**  
1000 Birch Ridge Dr., Raleigh NC, 27610

2018 STANDARD SPECIFICATIONS

RIGHT OF WAY DATE:  
NA

LETTING DATE:  
September 21, 2021

K.G. BOWEN, PE  
PROJECT ENGINEER

N.A. GAINEY, PE  
PROJECT DESIGN ENGINEER

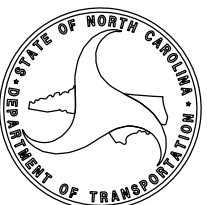

16-JUL-2021 11:34 AM  
S:\DDC\2019\16-5936-DDC4-TSH.dgn  
\$\$\$\$USERNAME\$\$\$\$

# WILSON COUNTY NORTH CAROLINA

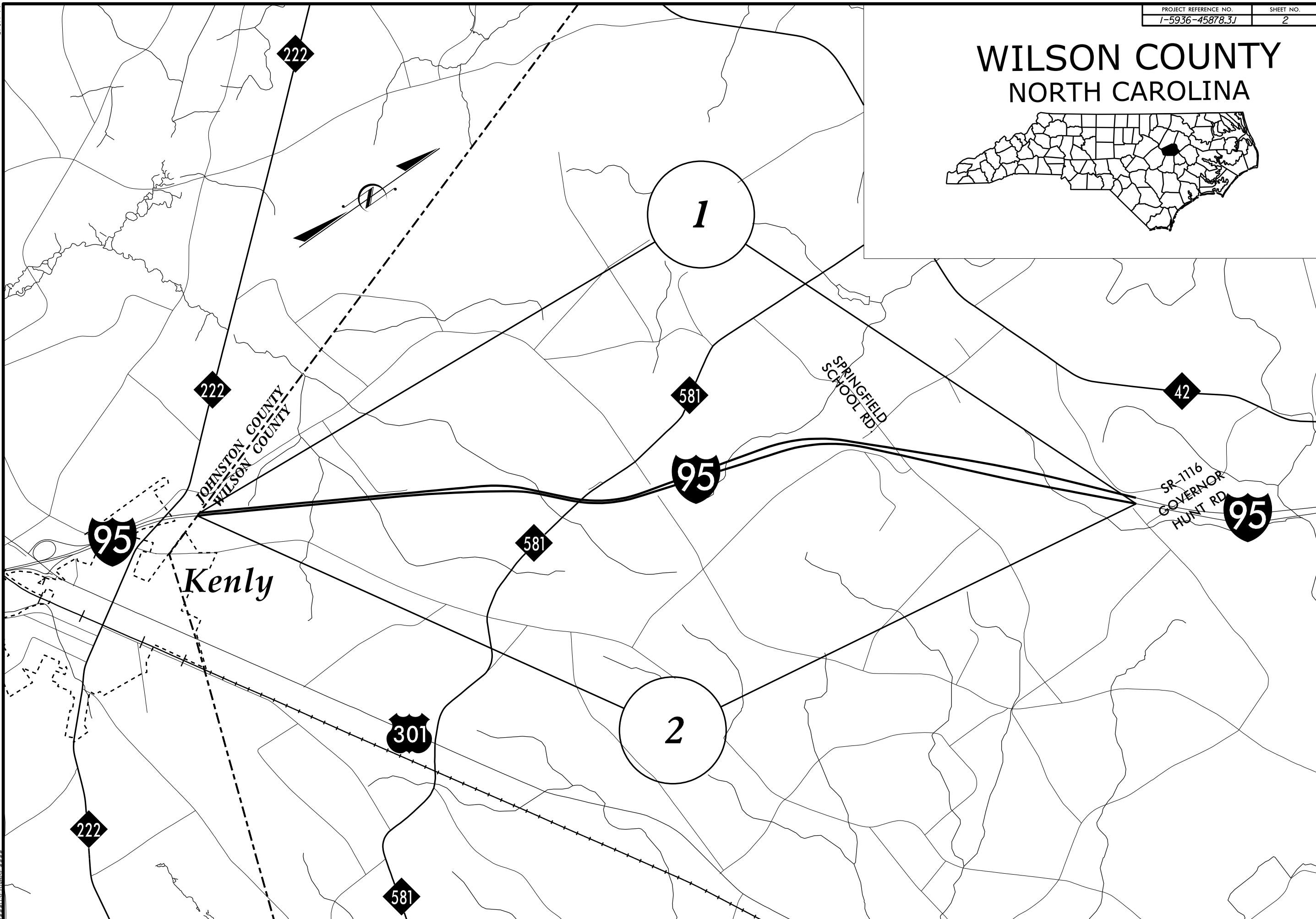
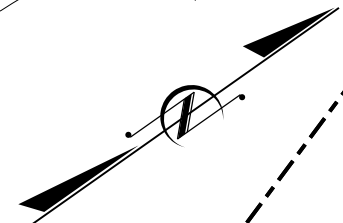

# JOHNSTON COUNTY NORTH CAROLINA

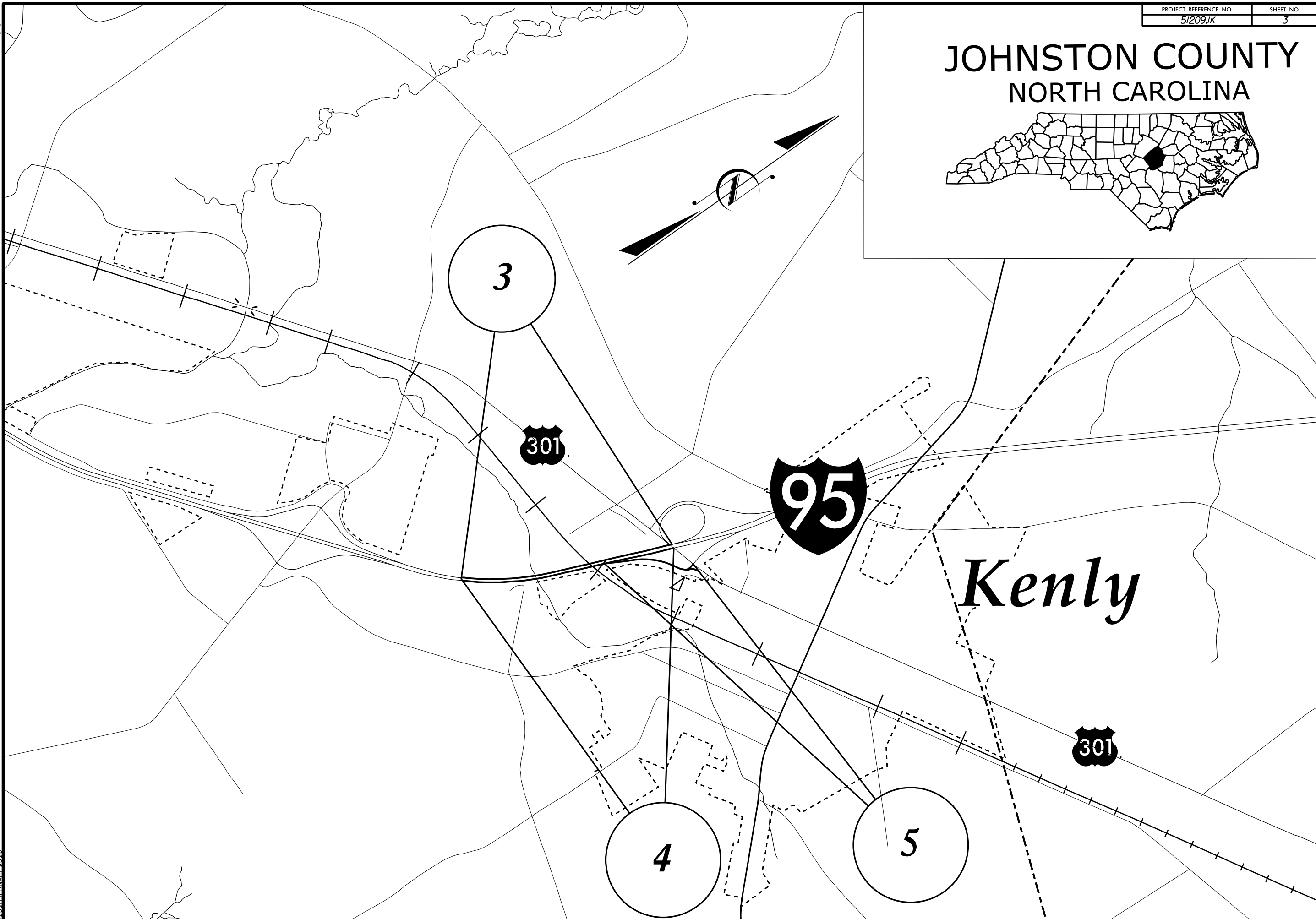
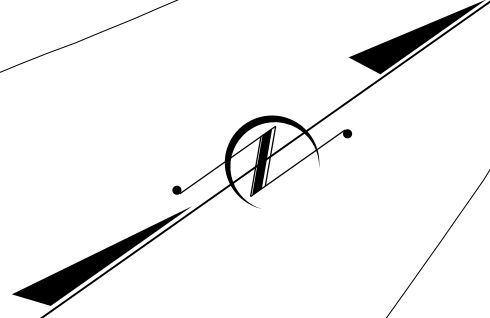
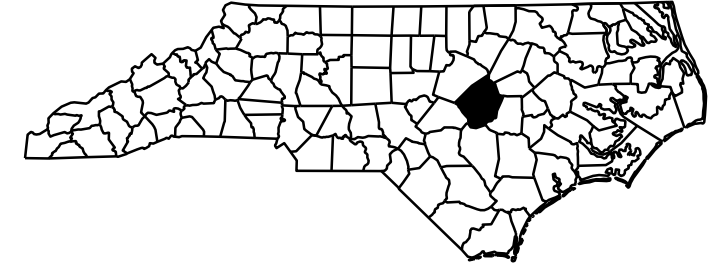

8/17/99

I6-JUL-2021 11:34  
S:\DDC\15936\1-5936 Map Sheet.dgn  
USER:DDC

### PAVEMENT SCHEDULE

C1	PROP. APPROX. 1.5" ASPHALT CONC. SURFACE COURSE, TYPE S9.5D, AT AN AVERAGE RATE OF 168 LBS. PER SQ. YARD
C2	PROP. APPROX. 2" ASPHALT CONC. SURFACE COURSE, TYPE S9.5D, AT AN AVERAGE RATE OF 224 LBS. PER SQ. YARD
M1	MILL EXISTING ASPHALT PAVEMENT 1.5" IN DEPTH
M2	MILL EXISTING ASPHALT PAVEMENT 2.75" IN DEPTH
M3	MILL EXISTING ASPHALT PAVEMENT 2" IN DEPTH
M4	MILLED RUMBLE STRIPS
U	EXISTING PAVEMENT

NOTE: PAVEMENT EDGE SLOPES ARE 1:1 UNLESS SHOWN OTHERWISE. SEE SHOULDER WEDGE DETAIL

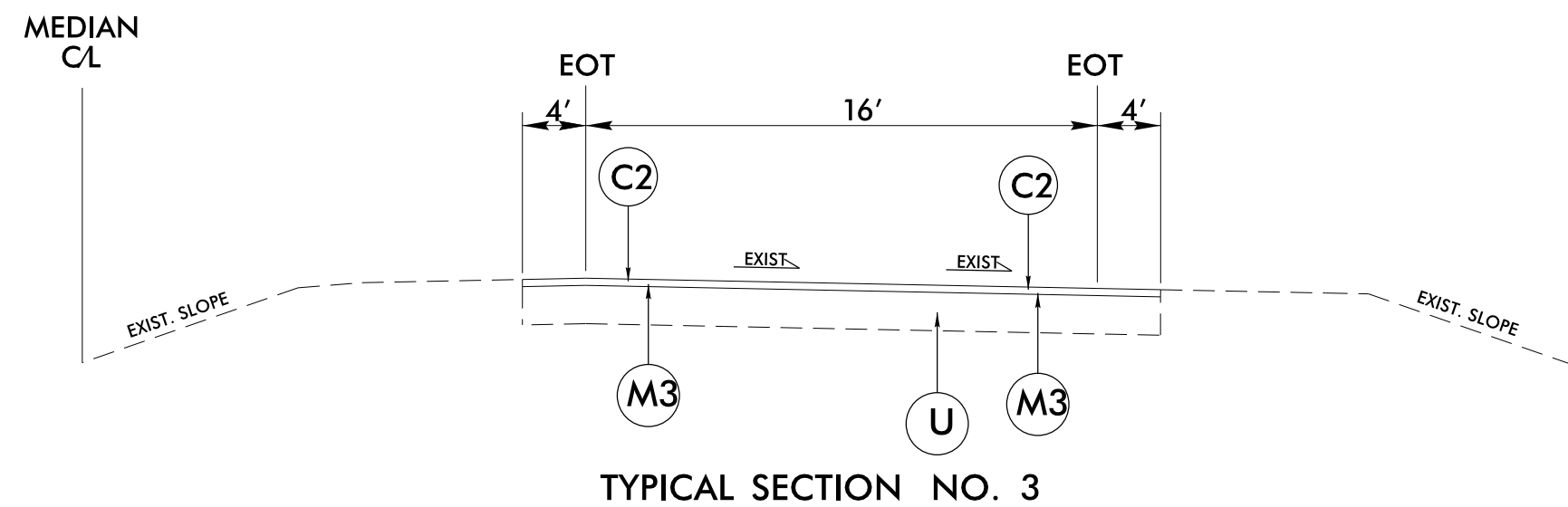
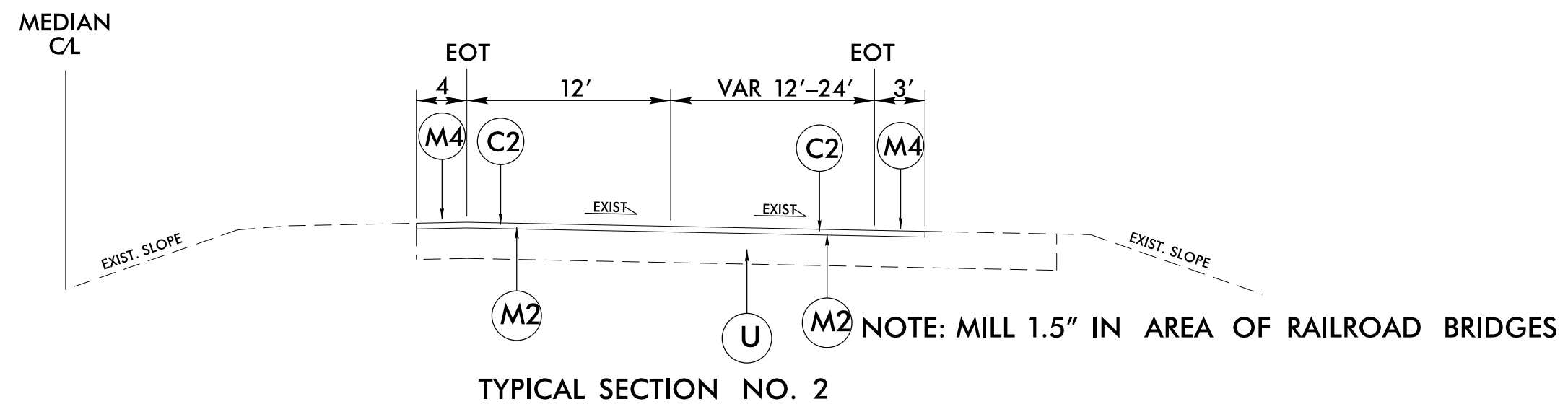
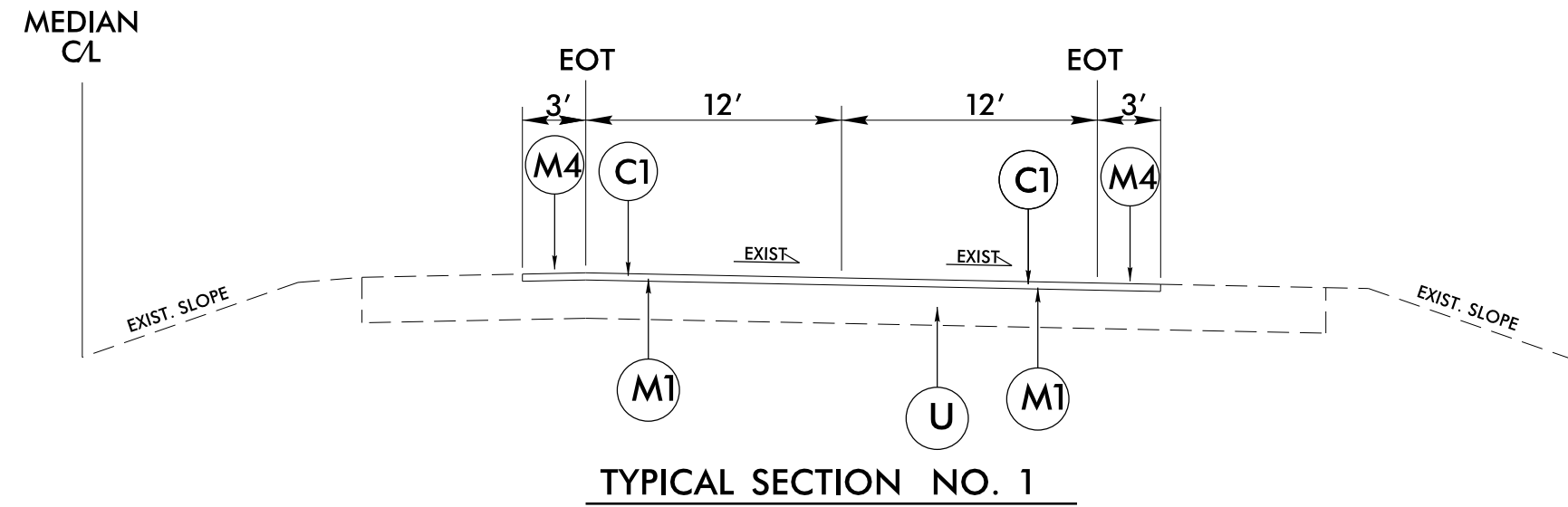

**NOTES:**

**MILLING**

ALL MILLED SURFACES MUST BE RESURFACED BY THE END OF EACH WORK DAY.

NOTE: LIMITS OF TYPICAL SECTIONS INDICATED ON THE SUMMARY OF QUANTITIES ARE APPROXIMATE. TYPICAL SECTION LIMITS AND TRANSITIONS TO BE VERIFIED BY THE ENGINEER IN FIELD.

5/14/99  
 15-JUL-2021 11:34  
 SS-D:\C:\1-5936\1-5936.DDC4-TYP.dgn  
 \$\$\$\$USERNAME\$\$\$\$



SUMMARY OF QUANTITIES																				PROJECT NO.		SHEET NO.		TOTAL NO.				
PROJECT NO	COUNTY	MAP NO	ROUTE	DESCRIPTION	TYPICAL SECTION NO.	LANES	LANE TYPE	FINAL SURFACE TESTING REQUIRED	WARM MIX ASPHALT REQUIRED	LENGTH	WIDTH	1297000000-E	1297000000-E	1297000000-E	1524200000-E	1577000000-E	1840000000-E	3030000000-E	3287000000-N	3360000000-E	4400000000-E	4420000000-N	4423000000-N	4424000000-N	4434000000-N			
												MILLING ASPHALT PAVEMENT, 1.5" DEPTH	MILLING ASPHALT PAVEMENT, 2.75" DEPTH	MILLING ASPHALT PAVEMENT, 2" DEPTH	ASPHALT CONC SURFACE COURSE, TYPE S9.5D	POLYMER MODIFIED ASPHALT BINDER FOR PLANT MIX	MILLED RUMBLE STRIPS (ASPHALT CONCRETE)	STEEL BEAM GUARDRAIL	GUARDRAIL END UNITS, TYPE TL-3	REMOVE EXISTING GUARDRAIL	WORK ZONE SIGNS (STATIONARY)	PORTABLE CHANGEABLE MESSAGE SIGN	WORK ZONE DIGITAL SPEED LIMIT SIGNS	WORK ZONE PRESENCE LIGHTING	SEQUENTIAL FLASHING WARNING LIGHTS			
										MI	FT	SY	SY	SY	TON	TON	LF	LF	EA	LF	SF	EA	EA	EA	EA			
I-5936 45878.3.1	WILSON	1	I-95 SBL	JOHNSTON/WILSON COUNTY LINE TO SOUTH OF SR-1116 (MM 114.5)	1	2	MD	NO	NO	6.19	30	109,100			9,200	525	65,500	50	1	100	95							
I-5936 45878.3.1	WILSON	2	I-95 NBL	JOHNSTON/WILSON COUNTY LINE TO SOUTH OF SR-1116 (MM 114.5)	1	2	MD	NO	NO	6.19	30	109,100			9,200	525	65,500	100	2	200	95							
I-5936 45878.3.1	WILSON	SAY																					4	5	14	12		
I-5936 45878.3.1	WILSON	SUB TOTAL										12.38		218,200			18,400	1,050	131,000	150	3	300	190	4	5	14	12	
I-5936 45878.3.1	WILSON	PAY ITEM TOTAL												218,200			18,400	1,050	131,000	150	3	300	190	4	5	14	12	
51209.1K	JOHNSTON	3	I-95 SBL	END OF PROJECT I-5786 TO US-301 BRIDGE	2	2	MD	NO	NO	0.4	VAR 31'-43'	700	7,600		1,000	60	4,300				95							
51209.1K	JOHNSTON	4	I-95 NBL	END OF PROJECT I-5786 TO US-301 BRIDGE	2	2	MD	NO	NO	0.4	VAR 31'-43'	700	6,600		900	55	4,300				95							
51209.1K	JOHNSTON	5	EXIT RAMP	I-95 TO US-301	3	1		NO	NO	0.3	24			4,600	600	35					8							
51209.1K	JOHNSTON	SAY																										
51209.1K	JOHNSTON	SUB TOTAL										1.1		1,400	14,200	4,600	2,500	150	8,600			198						
51209.1K	JOHNSTON	PAY ITEM TOTAL												1,400	14,200	4,600	2,500	150	8,600			198						
SAY																												
TOTAL										13.48		219,600	14,200	4,600	20,900	1,200	139,600	150	3	300	388	4	5	14	12			
PAY ITEM TOTAL												219,600	14,200	4,600	20,900	1,200	139,600	150	3	300	388	4	5	14	12			
PROJECT NO	COUNTY	MAP NO	ROUTE	DESCRIPTION	TYPICAL SECTION NO.	LANES	LANE TYPE	FINAL SURFACE TESTING REQUIRED	WARM MIX ASPHALT REQUIRED	LENGTH	WIDTH	4510000000-N	4600000000-N	4600000000-N	4600000000-N	4600000000-N	4688000000-E	4688000000-E	4700000000-E	4725000000-E	4725000000-E	4725000000-E	4725000000-E	4815000000-E	4815000000-E	4825000000-E		
										MI	FT	HR	EA	EA	EA	EA	LF	LF	LF	EA	EA	EA	EA	EA	EA	EA	EA	
I-5936 45878.3.1	WILSON	1	I-95 SBL	JOHNSTON/WILSON COUNTY LINE TO SOUTH OF SR-1116 (MM 114.5)	1	2	MD	NO	NO	6.19	30	560	35				40,900	32,800						40,900	32,800			
I-5936 45878.3.1	WILSON	2	I-95 NBL	JOHNSTON/WILSON COUNTY LINE TO SOUTH OF SR-1116 (MM 114.5)	1	2	MD	NO	NO	6.19	30	560	35				40,900	32,800						40,900	32,800			
I-5936 45878.3.1	WILSON	SAY																										
I-5936 45878.3.1	WILSON	SUB TOTAL											1,120	70		2	81,800	65,600						81,800	65,600			
I-5936 45878.3.1	WILSON	PAY ITEM TOTAL											1,120	70		2	147,400							147,400				
51209.1K	JOHNSTON	3	I-95 SBL	END OF PROJECT I-5786 TO US-301 BRIDGE	2	2	MD	NO	NO	0.4	VAR 31'-43'	80	5				2,700	2,200						2,700	2,200			
51209.1K	JOHNSTON	4	I-95 NBL	END OF PROJECT I-5786 TO US-301 BRIDGE	2	2	MD	NO	NO	0.4	VAR 31'-43'	80	5				2,700	2,200	780				2,700	2,200	780			
51209.1K	JOHNSTON	5	EXIT RAMP	I-95 TO US-301	3	1		NO	NO	0.3	24	32		2	2		1,600	1,600		1	1	1	1,600	1,600				
51209.1K	JOHNSTON	SAY																										
51209.1K	JOHNSTON	SUB TOTAL											192	10	2	2	7,000	6,000	780	1	1	1	7,000	6,000	780			
51209.1K	JOHNSTON	PAY ITEM TOTAL											192	10	2	2	13,000		780	3			13,000		780			
SAY																												
TOTAL										13.48		1,312	80	2	2	2	88,800	71,600	780	1	1	1	88,800	71,600	780			
PAY ITEM TOTAL												1,312	80	2	2	2	160,400		780	3		160,400		780				

SUMMARY OF QUANTITIES																	PROJECT NO.			SHEET NO.	TOTAL NO.				
PROJECT NO	COUNTY	MAP NO	ROUTE	DESCRIPTION	TYPICAL SECTION NO.	LANES	LANE TYPE	FINAL SURFACE TESTING REQUIRED	WARM MIX ASPHALT REQUIRED	LENGTH	WIDTH	4835000000-E	4845000000-N	4845000000-N	4845000000-N	4891000000-E	4895000000-N	5255000000-N	8881000000-E						
												PAINT PAVEMENT MARKING LINES (24") WHITE	PAINT PAVEMENT MARKING SYMBOL WRONG-WAY RAMP ARROW	PAINT PAVEMENT MARKING SYMBOL LEFT TURN ARROW	PAINT PAVEMENT MARKING SYMBOL RIGHT TURN ARROW	THERMOPLASTIC PAVEMENT MARKING LINES (24", 90 MILS) WHITE	NON-CAST IRON SNOWPLOWABLE PAVEMENT MARKER	PORTABLE LIGHTING	ASPHALT JOINT REPAIR/REPLACEMENT (18"-24" WIDE, W/ PLATE)					LF	EA
I-5936 45878.3.1	WILSON	1	I-95 SBL	JOHNSTON/WILSON COUNTY LINE TO SOUTH OF SR-1116 (MM 114.5)	1	2	MD	NO	NO	6.19	30						410								
I-5936 45878.3.1	WILSON	2	I-95 NBL	JOHNSTON/WILSON COUNTY LINE TO SOUTH OF SR-1116 (MM 114.5)	1	2	MD	NO	NO	6.19	30						410								
I-5936 45878.3.1	WILSON	SAY																1							
I-5936 45878.3.1	WILSON	SUB TOTAL										12.38						820	1						
I-5936 45878.3.1	WILSON	PAY ITEM TOTAL																820	1						
51209.1K	JOHNSTON	3	I-95 SBL	END OF PROJECT I-5786 TO US-301 BRIDGE	2	2	MD	NO	NO	0.4	VAR 31'-43'						30			3					
51209.1K	JOHNSTON	4	I-95 NBL	END OF PROJECT I-5786 TO US-301 BRIDGE	2	2	MD	NO	NO	0.4	VAR 31'-43'						70			3					
51209.1K	JOHNSTON	5	EXIT RAMP	I-95 TO US-301	3	1		NO	NO	0.3	24	65	1	1	1	65	14								
51209.1K	JOHNSTON	SAY																							
51209.1K	JOHNSTON	SUB TOTAL										1.1						65	114		6				
51209.1K	JOHNSTON	PAY ITEM TOTAL																65	114		6				
SAY																									
TOTAL										13.48							65	934	1	6					
PAY ITEM TOTAL																	65	934	1	6					

PROJECT NO	COUNTY	MAP NO	ROUTE	DESCRIPTION	TYPICAL SECTION NO.	LANES	LANE TYPE	FINAL SURFACE TESTING REQUIRED	WARM MIX ASPHALT REQUIRED	LENGTH	WIDTH													
										MI	FT													
I-5936 45878.3.1	WILSON	1	I-95 SBL	JOHNSTON/WILSON COUNTY LINE TO SOUTH OF SR-1116 (MM 114.5)	1	2	MD	NO	NO	6.19	30													
I-5936 45878.3.1	WILSON	2	I-95 NBL	JOHNSTON/WILSON COUNTY LINE TO SOUTH OF SR-1116 (MM 114.5)	1	2	MD	NO	NO	6.19	30													
I-5936 45878.3.1	WILSON	SAY																						
I-5936 45878.3.1	WILSON	SUB TOTAL																						
I-5936 45878.3.1	WILSON	PAY ITEM TOTAL																						
51209.1K	JOHNSTON	3	I-95 SBL	END OF PROJECT I-5786 TO US-301 BRIDGE	2	2	MD	NO	NO	0.4	VAR 31'-43'													
51209.1K	JOHNSTON	4	I-95 NBL	END OF PROJECT I-5786 TO US-301 BRIDGE	2	2	MD	NO	NO	0.4	VAR 31'-43'													
51209.1K	JOHNSTON	5	EXIT RAMP	I-95 TO US-301	3	1		NO	NO	0.3	24													
51209.1K	JOHNSTON	SAY																						
51209.1K	JOHNSTON	SUB TOTAL																						
51209.1K	JOHNSTON	PAY ITEM TOTAL																						
SAY																								
TOTAL										13.48														
PAY ITEM TOTAL																								

**SUMMARY OF QUANTITIES - DRAINAGE**

PROJECT NO. I-5936 45878.3.1  
SHEET NO. 7  
TOTAL NO.

PROJECT NUMBER	COUNTY	BOX NUMBER	ROUTE	LONG	LAT	DESCRIPTION	0106000000-E	2253000000-E	2365000000-N	2619000000-E	6012000000-E	6042000000-E	6071010000-E	6084000000-E					
							BORROW EXCAVATION	PIPE COLLARS	FRAME WITH TWO GRATES, STD 840.22	4" CONCRETE PAVED DITCH	SEDIMENT CONTROL STONE	1/4" HARDWARE CLOTH	WATTLE	SEEDING & MULCHING					
I-5936 45878.3.1	WILSON	1	I-95 MED	-78.125486	35.609883	REPAIR DRAINAGE STRUCTURE	4	0.3990	1		5	40	40	0.1					
		2	I-95 MED	-78.118023	35.620414	REPAIR DRAINAGE STRUCTURE	1	0.5526			5	40	40	0.1					
		3	I-95 MED	-78.105366	35.635504	REPAIR DRAINAGE STRUCTURE REMOVE & REPLACE PAVED DITCH	4	0.3990		4	5	40	40	0.1					
		4	I-95 MED	-78.102189	35.638055	REPAIR DRAINAGE STRUCTURE REMOVE & REPLACE PAVED DITCH AND RECONNECT UNDERDRAIN PIPE TO BOX	4			4	5	40	40	0.1					
TOTAL							13	1.3506	1	8	20	160	160	0.4					
SAY							15	2	1	10	20	160	160	0.5					

# WATTLE DETAIL

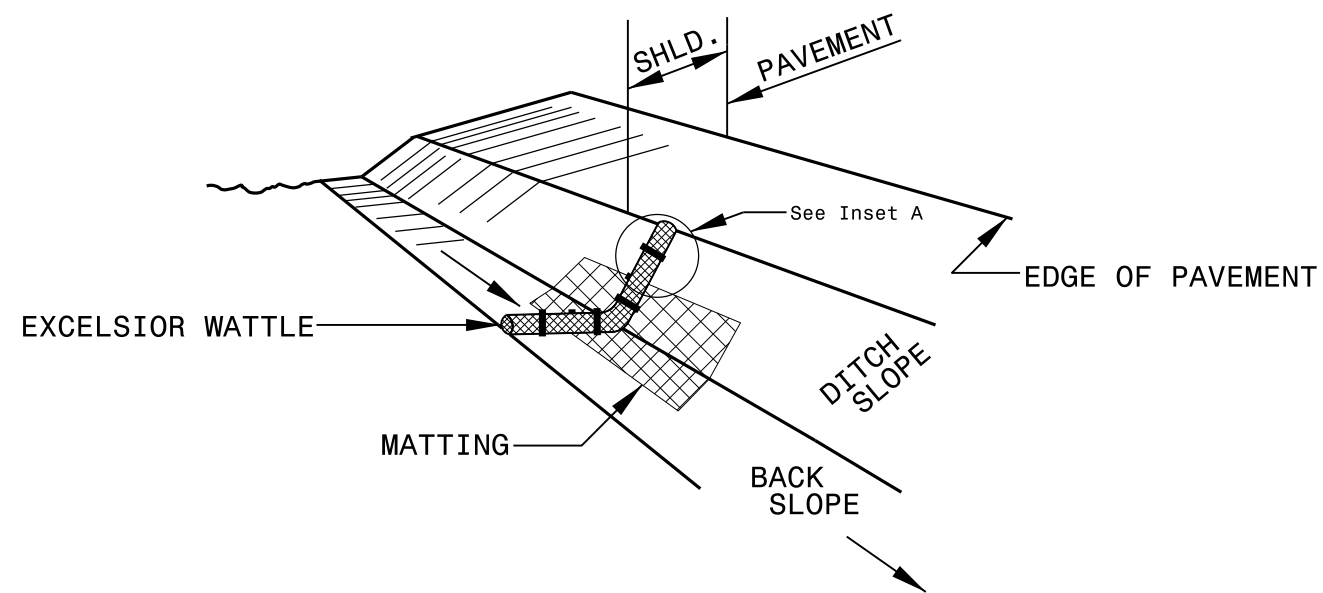

**ISOMETRIC VIEW**

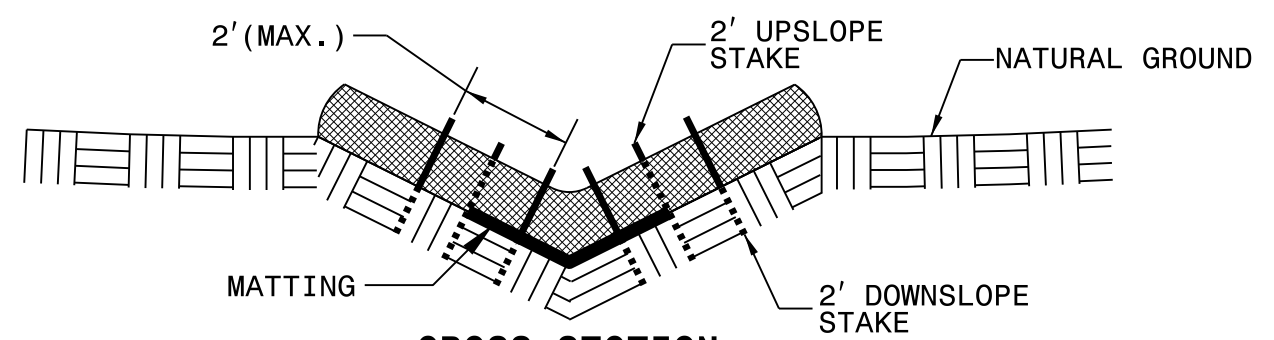

**CROSS SECTION  
VEE DITCH**

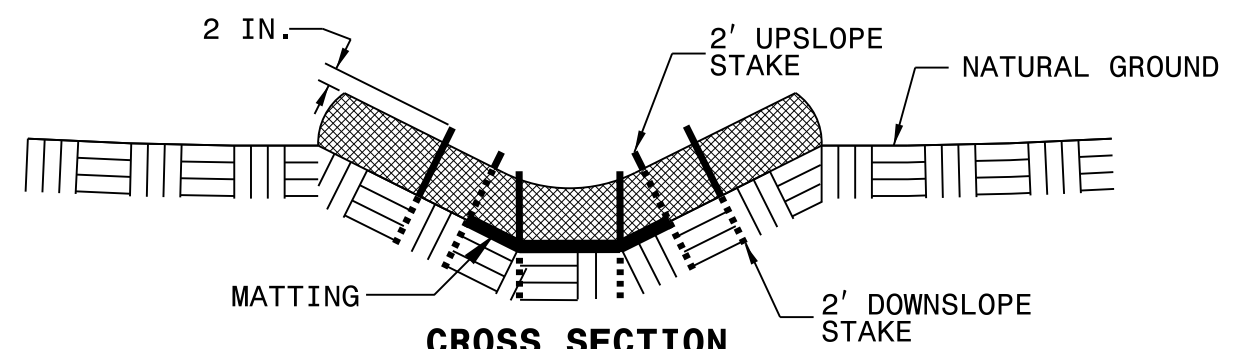

**CROSS SECTION  
TRAPEZOIDAL DITCH**

**NOTES:**

- USE MINIMUM 12 IN. DIAMETER EXCELSIOR WATTLE.
- USE 2 FT. WOODEN STAKES WITH A 2 IN. BY 2 IN. NOMINAL CROSS SECTION.
- ONLY INSTALL WATTLE(S) TO A HEIGHT IN DITCH SO FLOW WILL NOT WASH AROUND WATTLE AND SCOUR DITCH SLOPES AND AS DIRECTED.
- INSTALL A MINIMUM OF 2 UPSLOPE STAKES AND 4 DOWNSLOPE STAKES AT AN ANGLE TO WEDGE WATTLE TO BOTTOM OF DITCH.
- PROVIDE STAPLES MADE OF 0.125 IN. DIAMETER STEEL WIRE FORMED INTO A U SHAPE NOT LESS THAN 12" IN LENGTH.
- INSTALL STAPLES APPROXIMATELY EVERY 1 LINEAR FOOT ON BOTH SIDES OF WATTLE AND AT EACH END TO SECURE IT TO THE SOIL.
- INSTALL MATTING IN ACCORDANCE WITH SECTION 1631 OF THE STANDARD SPECIFICATIONS.

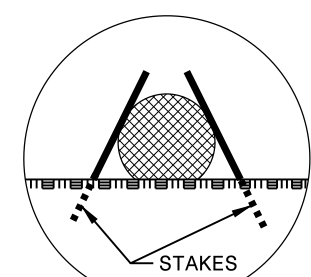

**INSET A**

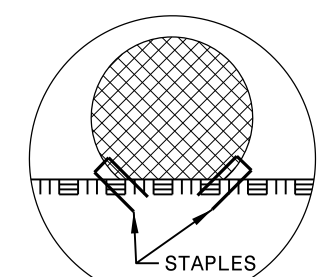

**INSET B**

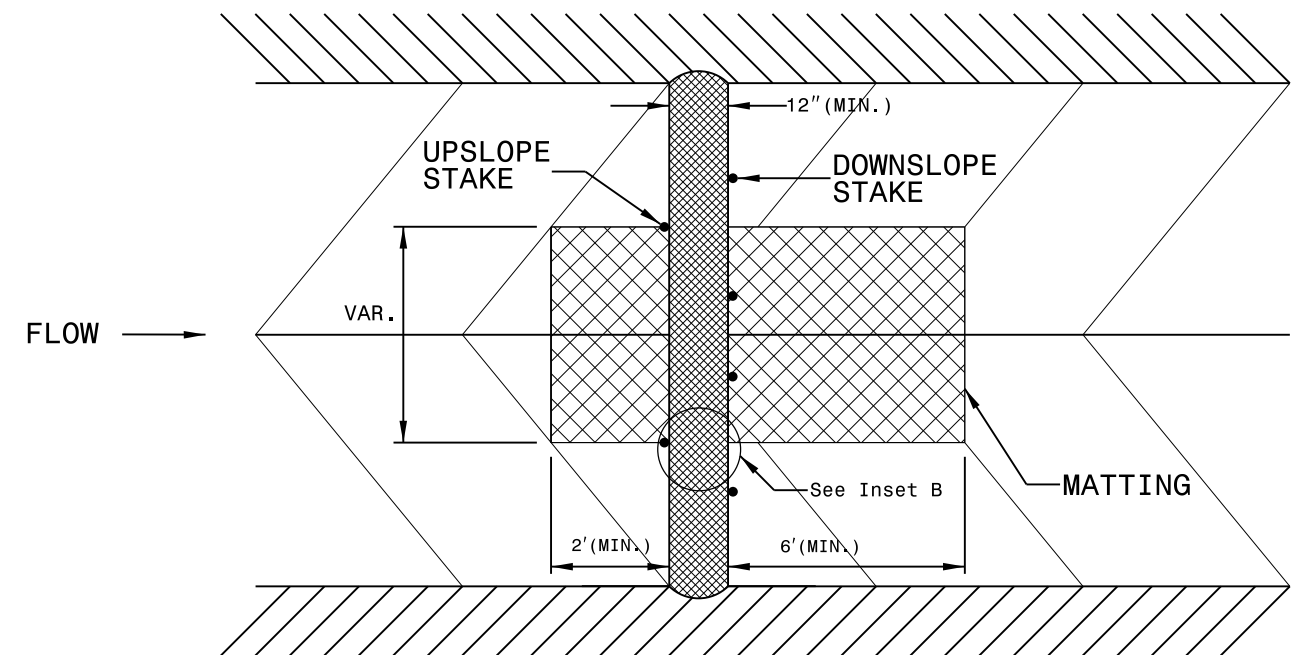

**TOP VIEW**

**STATE OF NORTH CAROLINA  
DEPARTMENT OF TRANSPORTATION**

PROJECT REFERENCE NO. <b>I-5936</b>	SHEET NO. <b>SIGN-1</b>
--	----------------------------

APPROVED:   
DocuSigned by:  
Ayman Alquodwah  
F32AC5CAF86472...  
 DATE: 7/22/2021



**DOCUMENT NOT CONSIDERED FINAL  
UNLESS ALL SIGNATURES COMPLETED**

# SIGNING PLAN WILSON COUNTY

**LOCATION: FROM JOHNSTON COUNTY LINE (MM 108.2) TO NORTH OF  
SR 1116 (GOVERNOR HUNT RD - MM 114.5)**

T.I.P.: I-5936

### ROADWAY STANDARD DRAWING

THE FOLLOWING ROADWAY STANDARDS AS APPEAR IN "ROADWAY STANDARD DRAWINGS" - PROJECT SERVICES UNIT - N.C. DEPARTMENT OF TRANSPORTATION - RALEIGH, N.C., DATED JANUARY 2018 ARE APPLICABLE TO THIS PROJECT AND BY REFERENCE HEREBY ARE CONSIDERED A PART OF THESE PLANS:

STD. NO.	TITLE
901.10	TYPE 'A' SIGNS
901.20	TYPE 'B' SIGNS
901.50	ARROWS AND SHIELDS
901.70	SIGN STRINGERS AND SUPPORT SPACING
901.80	SIGN MOUNTING DETAILS - FOR TYPE A AND TYPE B SIGNS
904.20	SECONDARY SIGN MOUNTING

### GENERAL NOTES

- . SIGNS FURNISHED BY STATE
- . CONFIRM IN WRITING AT LEAST 4 MONTHS IN ADVANCE, THE ACTUAL DATE THE DEPARTMENT FURNISHED SIGNS WILL BE REQUIRED.
- . ALL 'A' & 'B' SIGNS TO BE MOUNTED ON EXISTING SUPPORTS.

### SUMMARY OF QUANTITIES

ITEM NO.		ITEM DESCRIPTION	QUANTITY	UNIT
DESC. NO.	SECT. NO.			
4110000000	904	SIGN ERECTION, TYPE A (GROUND MOUNTED) .....	2	EA.
4110000000	904	SIGN ERECTION, TYPE B (GROUND MOUNTED) .....	4	EA.
4236000000	907	DISPOSAL OF SIGN, A OR B (GROUND MOUNTED) .....	6	EA.

### INDEX

SHEET NO.	DESCRIPTION
SIGN-1	TITLE SHEET
SIGN-2 & 2A	REVISED SIGNING ROADWAY STANDARD DRAWINGS
SIGN-3-3A	SIGN DESIGNS
SIGN-4	SIGNING PLAN SHEET

PLAN PREPARED BY: N.C.D.O.T. SIGNING AND DELINEATION UNIT

A.ALQUODWAH, P.E. SIGNING & DELINEATION REGIONAL ENGINEER
S.JOHNS SIGNING & DELINEATION PROJECT DESIGN ENGINEER

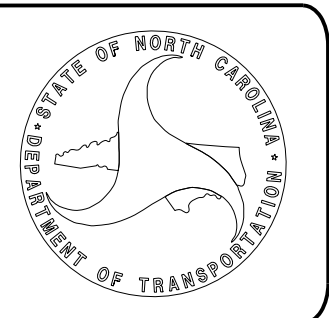

07/22/21 S:\6800\Eastern\Div 4\I-5936\I-5936-Sign-1.dgn  
Jser@JOHNS

CONTRACT:



STATE OF NORTH CAROLINA  
 DEPT. OF TRANSPORTATION  
 DIVISION OF HIGHWAYS  
 RALEIGH, N.C.

2-19

ENGLISH DETAIL DRAWING FOR  
**TYPE 'A' SIGNS**  
 WELDED STUD CONSTRUCTION

SHEET 1 OF 2

**901D10**

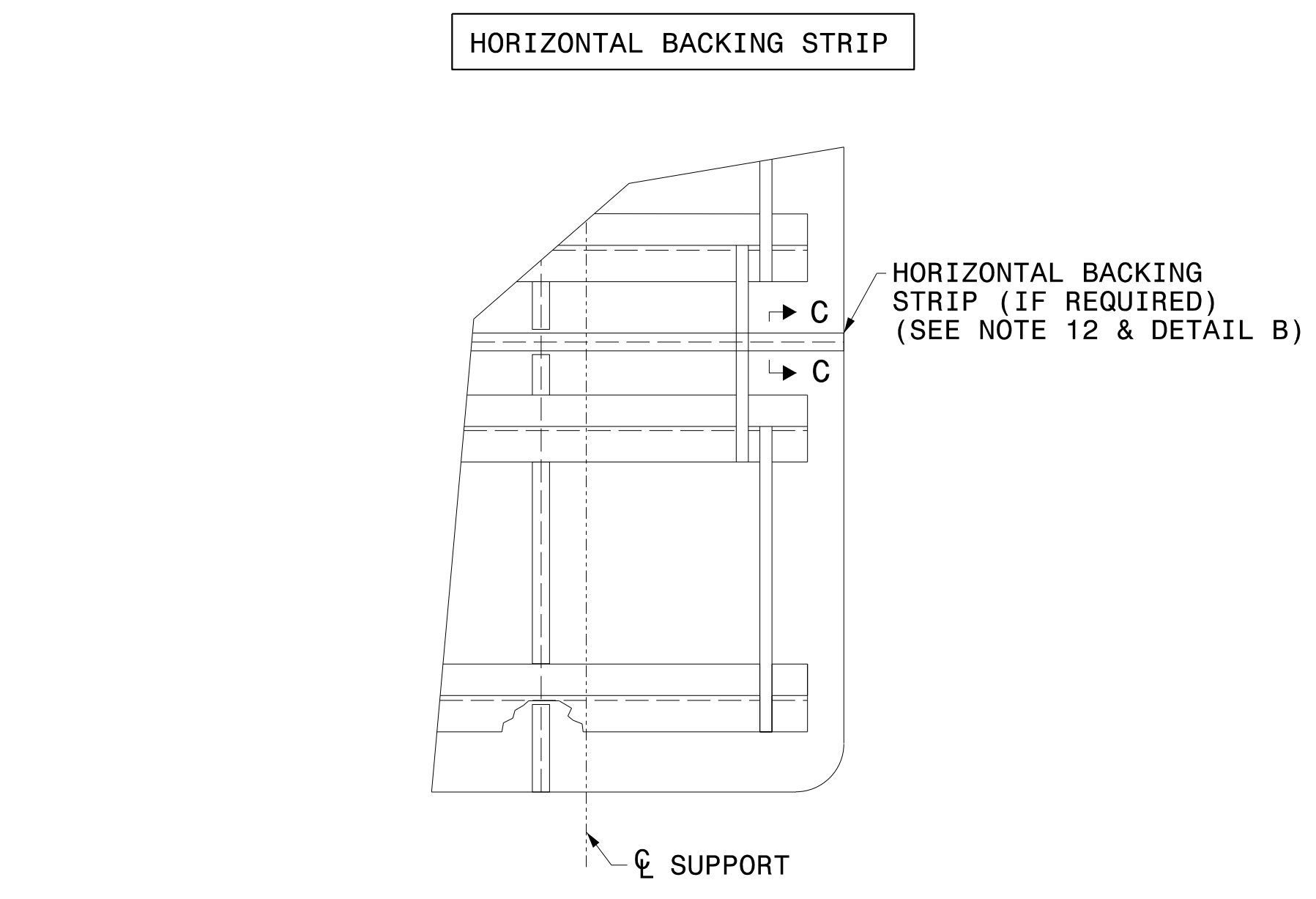
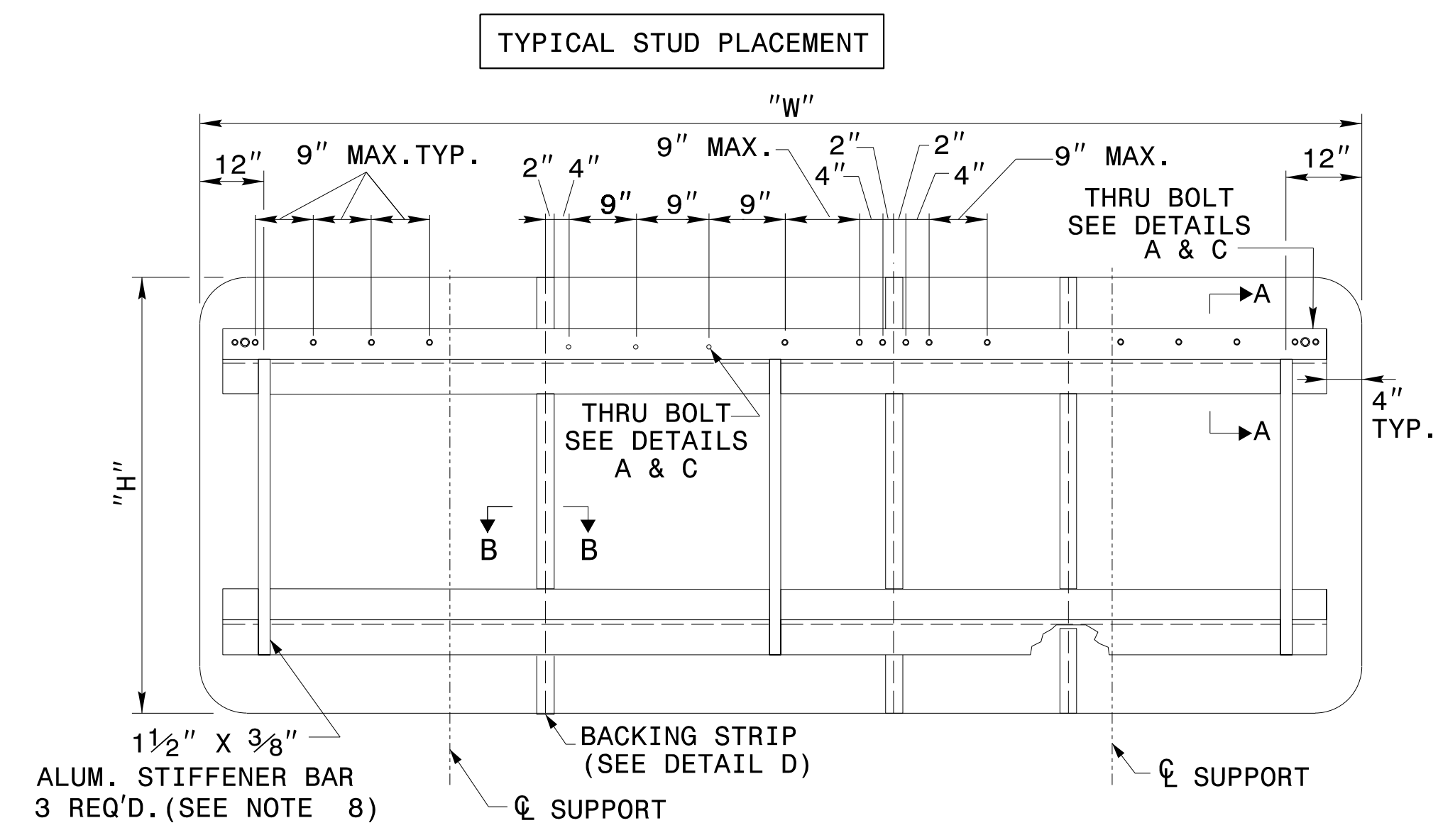

NOTES:

1. USE THE NUMBER AND SIZE OF SUPPORTS SHOWN ON THE SUPPORT CHART IN PROJECT PLANS.
2. FABRICATE SIGN PANEL SECTIONS WITH SHEETS 4'-0" WIDE. WHEN FABRICATING SIGNS WHICH ARE NOT MULTIPLES OF 4'-0" IN WIDTH, DO NOT CUT MORE THAN TWO SHEETS TO LESS THAN 4'-0" IN WIDTH. THESE PANELS SHALL NOT BE LESS THAN 1'-0" IN WIDTH.
3. SEE NCDOT STANDARD SPECIFICATIONS FOR ROADS AND STRUCTURES, FOR TYPE OF MATERIAL TO BE USED FOR SIGN PANELS, HANGER ASSEMBLIES, AND SUPPORTS.
4. USE GALVANIZED STEEL FOR BACKING PLATES AND MOUNTING BOLTS.
5. SEE ROADWAY STANDARD 904.20 WHEN TYPE "B" SECONDARY SIGN MOUNTING IS REQUIRED.
6. DETAILS FOR TYPE "A" SECONDARY SIGNS SHALL BE THE SAME AS FOR TYPE "A" SIGNS.
7. THE VERTICAL DIMENSION BETWEEN PRIMARY AND SECONDARY SIGNS IS TWO (2) INCHES.
8. ADJUST STIFFENERS TO AVOID CONFLICT WITH SUPPORTS.
9. SEE ROADWAY STANDARD 901.70 FOR SUPPORT AND "Z" BAR SPACING.
10. FABRICATE SIGNS TALLER THAN 12'-0" AS TWO SEPARATE SIGNS WITH A HORIZONTAL SPLICE. LOCATE STRINGERS ON EACH SECTION OF THE SIGN BY THE SIGN STRINGER CHART. (SEE ROADWAY STANDARD 901.70)
11. FABRICATE SIGNS TALLER THAN 12'-0" BUT SHORTER THAN 14'-6" WITH A HORIZONTAL SPLICE LOCATED 7'-0" FROM BOTTOM OF SIGN.
12. FABRICATE SIGNS 14'-6" TALL AND TALLER WITH A HORIZONTAL SPLICE. LOCATE THE SPLICE AT LEAST HALF OF THE SIGN HEIGHT FROM THE BOTTOM AND AT LEAST 7'-0" FROM THE TOP.
13. THERE SHALL ONLY BE A 1/8" GAP BETWEEN THE VERTICAL BACKING STRIP AND THE "Z" BAR.
14. SEE ROADWAY STANDARD 901.80 FOR DETAILS SHOWING SIGN MOUNTING TO SUPPORTS.
15. PLACE NYLON WASHER UNDER HEAD OF 3/8" THRU BOLTS.
16. FABRICATE EACH SIGN WITH 3/8" DIA. THRU BOLT, 4" FROM EACH END OF EACH "Z" BAR THRU SIGN PANEL AND "Z" BAR. SEE DETAILS A & C.
17. FABRICATE EACH SIGN WITH 3/8" DIA. THRU BOLT CENTERED IN EACH PANEL THRU THE TOP AND BOTTOM "Z" BAR. CENTERED THRU BOLT REQUIRED IN END PANELS GREATER THAN 2'-0" WIDE. SEE DETAILS A & C.
18. THRU BOLTS WILL HAVE A MINIMUM 1/16" TO MAXIMUM 1/8" GAP

STATE OF NORTH CAROLINA  
 DEPT. OF TRANSPORTATION  
 DIVISION OF HIGHWAYS  
 RALEIGH, N.C.

2-19

ENGLISH DETAIL DRAWING FOR  
**TYPE 'A' SIGNS**  
 WELDED STUD CONSTRUCTION

SHEET 1 OF 2

**901D10**

**REVISED SIGNING  
 ROADWAY STANDARD DRAWING**

07/20/21  
 S:\S&D\Eos+ern\Div 4\I-5936\I-5936\_Sign-2.dgn  
 User: SJOHNS



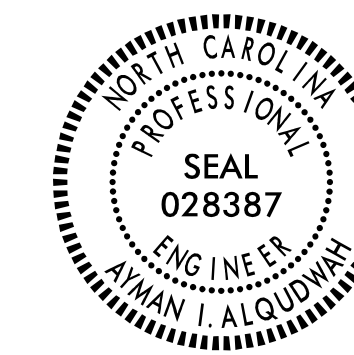

STATE OF NORTH CAROLINA  
DEPT. OF TRANSPORTATION  
DIVISION OF HIGHWAYS  
RALEIGH, N.C.

2-19

ENGLISH DETAIL DRAWING FOR  
**TYPE 'B' SIGNS**  
WELDED STUD CONSTRUCTION

SHEET 1 OF 1  
**901D20**

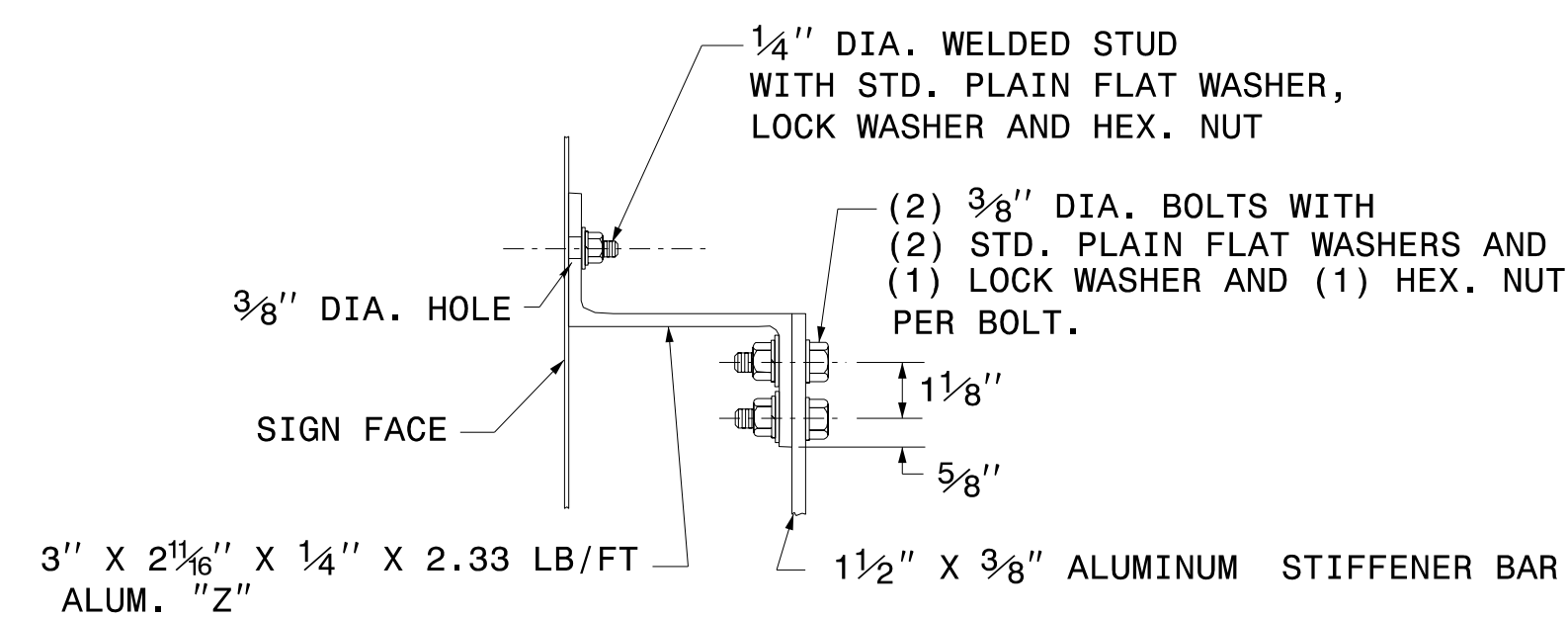
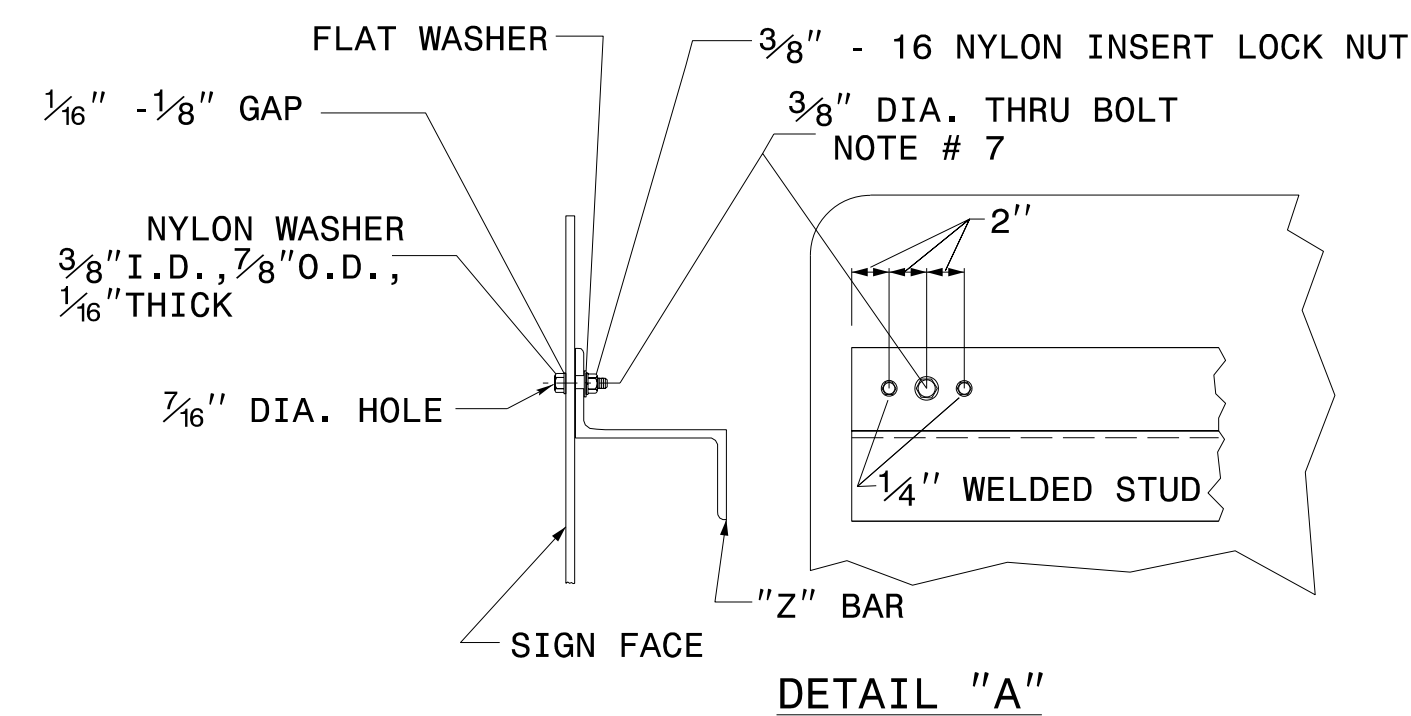

SECTION A-A  
STIFFENER DETAIL

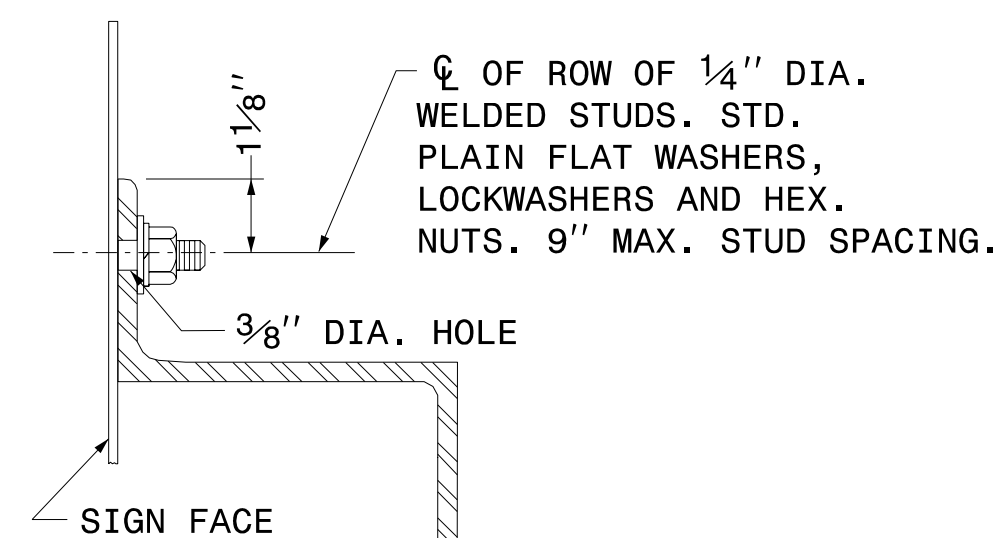

SECTION B-B

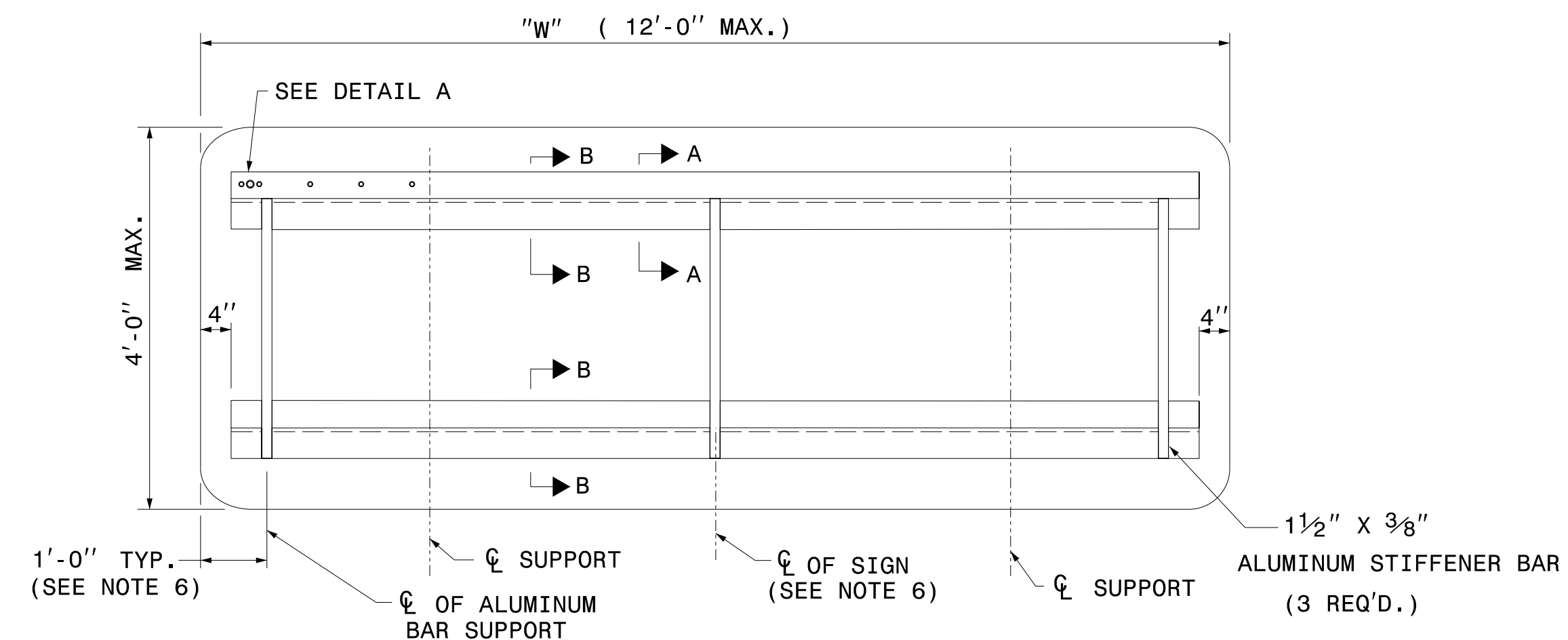

NOTES:

1. USE NUMBER AND SIZE OF SUPPORTS SHOWN ON SUPPORT CHART IN PROJECT PLAN SHEETS.
2. SEE NCDOT STANDARD SPECIFICATIONS FOR ROADS AND STRUCTURES FOR THE TYPE OF MATERIAL TO BE USED FOR SIGN PANELS, HANGER ASSEMBLIES AND SUPPORTS.
3. FURNISH ALL MOUNTING HARDWARE.
4. USE GALVANIZED STEEL FOR BACKING PLATES AND MOUNTING BOLTS.
5. THE VERTICAL DIMENSION BETWEEN PRIMARY AND SECONDARY SIGNS IS TWO (2) INCHES.
6. ADJUST STIFFENERS TO AVOID CONFLICT WITH SUPPORTS.
7. FABRICATE EACH SIGN WITH A 3/8" DIA. BOLT 4" FROM EACH END OF EACH "Z" BAR THRU SIGN PANEL AND "Z" BAR.
8. SEE ROADWAY STANDARD 901.70 FOR SUPPORT AND "Z" BAR SPACING.
9. SEE ROADWAY STANDARD 901.80 FOR DETAILS SHOWING SIGN MOUNTING TO SUPPORTS.
10. PLACE NYLON WASHER UNDER HEAD OF 3/8" THRU BOLT.
11. THRU BOLTS WILL HAVE A MINIMUM 1/16" TO MAXIMUM 1/8" GAP.

STATE OF NORTH CAROLINA  
DEPT. OF TRANSPORTATION  
DIVISION OF HIGHWAYS  
RALEIGH, N.C.

2-19

ENGLISH DETAIL DRAWING FOR  
**TYPE 'B' SIGNS**  
WELDED STUD CONSTRUCTION

SHEET 1 OF 1  
**901D20**





SIGN NUMBER: 104B      BACKG COLOR: Green      DESIGN BY: S.Johns      CHECKED BY: A. Alqudwah      Jun 30, 2021  
 TYPE: A      COPY COLOR: White      PROJECT ID: Div. Request      LOCATION: I-95 Wilson County      DIV: 4

SYMBOL	X	Y	WID	HT
M1_4	43.5	86.6	45	36

SIGN WIDTH: 11'-0"  
 HEIGHT: 11'-0"  
 TOTAL AREA: 121.0 Sq.Ft.

BORDER TYPE: FLUSH  
 RECESS: 0"  
 WIDTH: 2"  
 RADII: 12"

NO. Z BARS: 3      MAT'L: 0.125" (3.2 mm) ALUMINUM  
 LENGTH: 124.0

USE NOTES: 1,2,3  
 1. Legend and border(except those that are colored black) shall be direct applied Grade C sheeting.  
 2. Background shall be Grade C reflective sheeting.  
 3. Shields; A, B, and C type arrows shall be on 0.032" (0.8mm) aluminum and demountable.

LETTER POSITIONS

Letter spacings are to start of next letter													Series/Size
													Text Length
	K	e	n	l	y								EM 2000
31.4	15.2	15.5	17	7.8	13.6	31.4							69.1
	L	u	c	a	m	a							EM 2000
18.5	15.4	15.5	14.1	17	22.6	10.6	18.5						95
	1		M	I	L	E							E 2000
39.7	4.5	15	12	4.4	9.2	7.5	39.7						52.6

FILENAME: I-5936 Sign Designs      NORTH CAROLINA D.O.T. SIGN DETAIL

SIGN NUMBER: 105      BACKG COLOR: Brown/Brown/Brown      DESIGN BY: S.Johns      CHECKED BY: A. Alqudwah      Jun 30, 2021  
 TYPE: A      COPY COLOR: White      PROJECT ID: Div. Request      LOCATION: I-95 Wilson County      DIV: 4

SYMBOL	X	Y	WID	HT

SIGN WIDTH: 16'-0"  
 HEIGHT: 7'-6"  
 TOTAL AREA: 120.0 Sq.Ft.

BORDER TYPE: FLUSH  
 RECESS: 0"  
 WIDTH: 1"  
 RADII: 12"

NO. Z BARS: 3      MAT'L: 0.125" (3.2 mm) ALUMINUM  
 LENGTH: 184.0

USE NOTES:  
 1. Legend and border(except those that are colored black) shall be direct applied Grade B sheeting.  
 2. Background shall be Grade C reflective sheeting.

LETTER POSITIONS

Letter spacings are to start of next letter																							Series/Size			
																							Text Length			
	S	t	a	t	e		H	i	s	t	o	r	i	c		S	i	t	e				D 2000			
61.7	4.4	2.8	4	2.8	3.5	6	5.4	1.8	3.1	2.8	4.6	3	1.9	3.5	6	5	1.6	2.8	3.5	61.7			68.7			
	G	o	v	e	r	n	o	r		C	h	a	r	i	e	s		B	A	y	c	o	c	k	D 2000	
24.2	6.7	5.5	6.3	5.8	4	5.9	6.2	3	8	7	5.8	6.1	4	2.6	5.4	3.8	8	5.4	8	7.2	6.6	5.4	5.8	5.1	24.2	143.6
	B	i	r	t	h	p	l	a	c	e															D 2000	
72.2	6.6	2.9	3.3	4.1	6.2	6.1	2.5	5.8	5.4	4.7	72.2														47.6	
	1	8	7	0		s		F	a	r	m	s	t	e	a	d									D 2000	
52.8	3.8	6.8	6.8	6.8	2.1	3.8	8	5.6	6.1	4	9	4.1	3.8	5.4	5.8	4.8	52.8								86.5	
	T	o	b	a	c	c	o		F	a	r	m	L	i	f	e		M	u	s	e	u	m		D 2000	
25.2	5.7	6.2	5.7	5.8	5.4	5.4	4.9	8	5.6	6.1	4	7.9	8	6	2.4	3.5	4.7	8	7.9	5.8	4.5	5.8	6.3	7.9	25.2	141.5
	E	x	i	t		1	0	7																	D 2000	
71.8	5.8	6.8	2.5	5	8	4.7	8.8	6.8	71.8																48.3	

FILENAME: I-5936 Sign Designs      NORTH CAROLINA D.O.T. SIGN DETAIL

07/20/21  
 S:\S&U\U\_Eg\stern\Div 4\I-5936\I-5936-Sign-3A.dgn  
 User: SJOHNS

# SIGN DESIGNS



APPROVED: *Ayman Alqudwah*  
DocuSigned by:  
 F32AC5CAF965472...  
 DATE: 7/22/2021

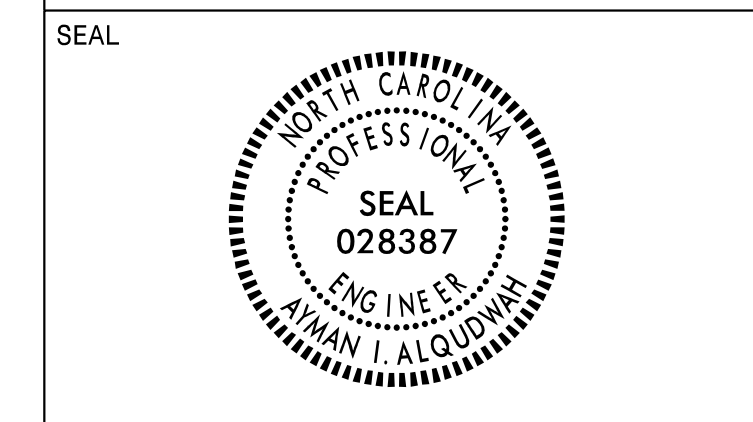

SEAL  
**DOCUMENT NOT CONSIDERED FINAL  
 UNLESS ALL SIGNATURES COMPLETED**



I-95 SB

I-95 NB

9'-6" x 2'  
 Johnston County  
 SEE NOTES 2 & 3  
 103

SEE NOTES 2 & 3  
 11' x 2'-6"  
 EXIT 107 104A  
 301  
 Kenly  
 Lucama  
 1 MILE  
 11' x 11'  
 SEE NOTES 1 & 3  
 104B

16' x 7'-6"  
 State Historic Site  
 Governor Charles B Aycock  
 Birthplace  
 1870's Farmstead  
 Tobacco Farm Life Museum  
 EXIT 107  
 SEE NOTES 1 & 3  
 105

8'-6" x 4'  
 Wilson  
 Rocky Mount 19  
 36  
 Richmond 148  
 SEE NOTES 2 & 3  
 101

9'-6" x 2'  
 Wilson County  
 SEE NOTES 2 & 3  
 102

**PROJECT NOTES**

1. SIGN ERECTION, TYPE A (GROUND MOUNTED)
2. SIGN ERECTION, TYPE B (GROUND MOUNTED)
3. DISPOSAL OF SIGN, A OR B (GROUND MOUNTED)

I-95 WILSON COUNTY  
 PROPOSED SIGNING FROM  
 MILEMARKER 108.2 TO MILEMARKER 114.5



**TIP PROJECT: I-5936**

**CONTRACT: C204653**

STATE OF NORTH CAROLINA  
DIVISION OF HIGHWAYS

**WILSON COUNTY**

**LOCATION: DYNAMIC MESSAGE SIGN AT  
MM 114, SOUTH OF SR 1116 (GOVERNOR  
HUNT ROAD) (MILEMARKER 114.5).**

**TYPE OF WORK: DYNAMIC MESSAGE SIGN REPLACEMENT  
ON EXISTING STRUCTURE**

STATE	STATE PROJECT REFERENCE NO.	SHEET NO.
N.C.	I-5936	ITS-1
STATE PROJ. NO.	F. A. PROJ. NO.	DESCRIPTION
45878.1.1		PE
45878.3.1		CONST.

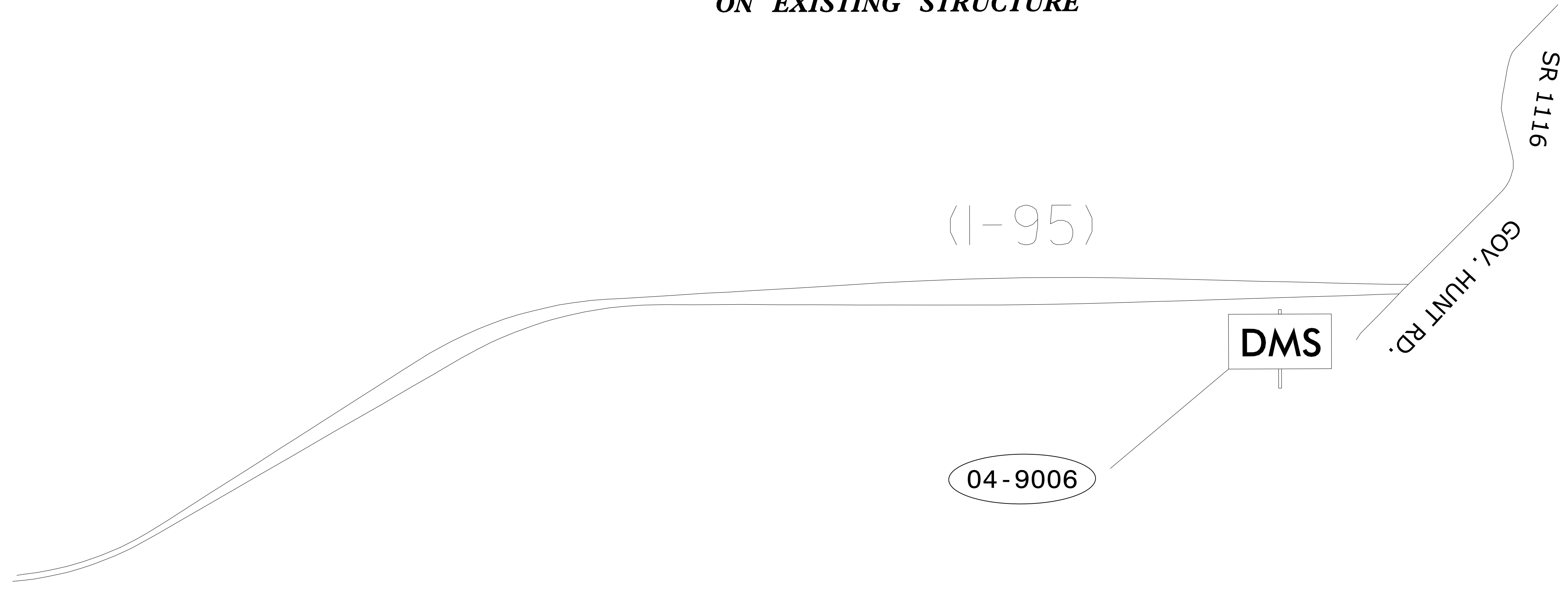

2018 STANDARD SPECIFICATIONS

PROJECT LENGTH  
PROJECT LENGTH = 0 MILES

LETTING DATE:  
SEPTEMBER 21, 2021

INDEX OF SHEETS

SHEET ITS 1.....TITLE SHEET

SHEET ITS 2.....ITS PLANS

**ROADWAY STANDARD DRAWINGS**

THE FOLLOWING ROADWAY STANDARDS AS APPEAR IN "ROADWAY STANDARD DRAWINGS" ROADWAY DESIGN UNIT - N.C. DEPARTMENT OF TRANSPORTATION - RALEIGH, N.C., DATED JANUARY 2018 ARE APPLICABLE TO THIS PROJECT AND BY REFERENCE HEREBY ARE CONSIDERED A PART OF THESE PLANS:

STD. NO.	TITLE
1101.02	TEMPORARY LANE CLOSURES
1101.03	TEMPORARY ROAD CLOSURES
1101.04	TEMPORARY SHOULDER CLOSURES

**NCDOT CONTACT:**  
**TRANSPORTATION MOBILITY AND SAFETY**  
 M. M. MCDIARMID, P.E., CPM  
 STATE TRANSPORTATION SYSTEMS  
 MANAGEMENT & OPERATIONS ENGINEER

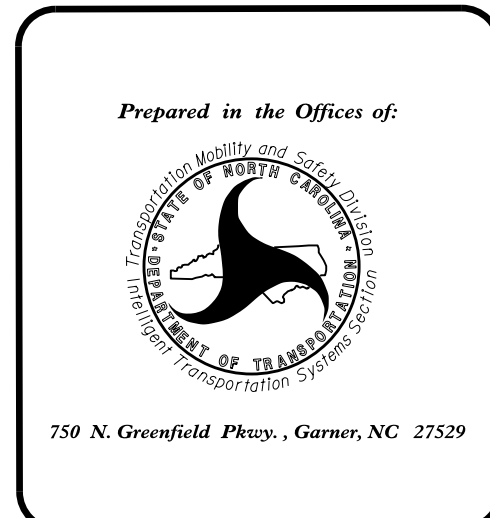

**ENGLISH**

ALL DIMENSIONS IN THESE PLANS ARE IN FEET UNLESS OTHERWISE NOTED

**DOCUMENT NOT CONSIDERED FINAL UNLESS ALL SIGNATURES COMPLETED**

SEAL

DocuSigned by:  
Andrew J. Skuce

7/22/2021

2018 STANDARD SPECIFICATION

04-9006 GPS COORDINATES  
 35.67804 N  
 -78.06721 W

**LEGEND**

- EXISTING CONDUIT
- - - - - EXISTING GUARDRAIL
- PROPOSED DMS ON EXISTING STRUCTURE
- XXXXX NEW ITS DEVICE NUMBER

INSTALL THE FOLLOWING	
QUANTITY	DESCRIPTION
1	DYNAMIC MESSAGE SIGN (TYPE 2C)

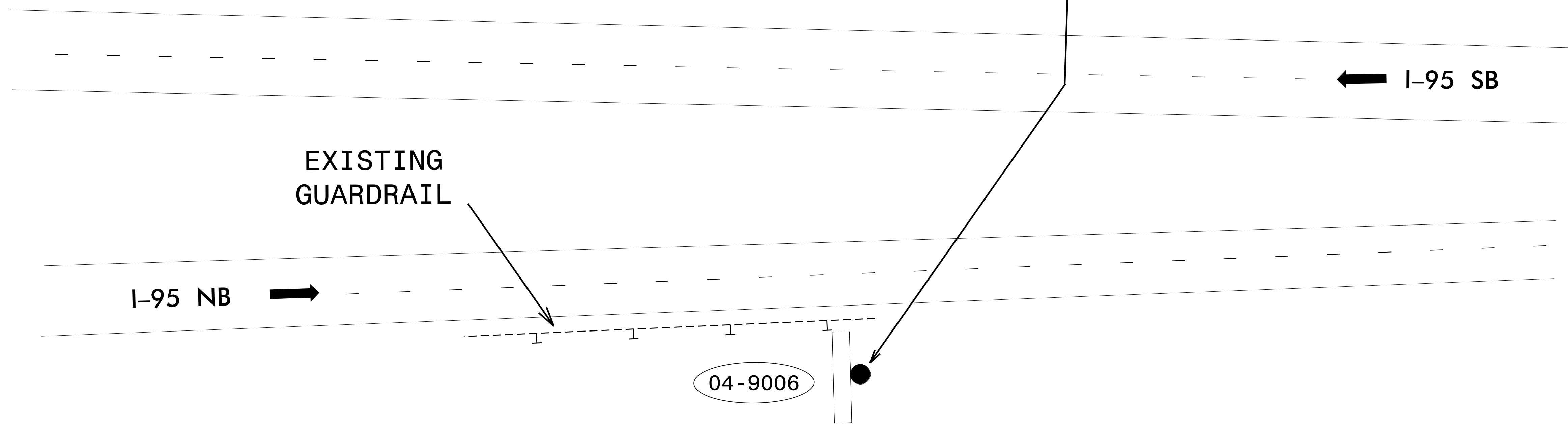

**NOTES**

1. REMOVE EXISTING DMS, CABINET, AND RISERS.
2. INSTALL NEW DMS AND CABINET ON EXISTING PEDESTAL STRUCTURE. ENSURE DMS ALIGNS WITH THE EXISTING ACCESS PLATFORM.
3. RELOCATE EXISTING CELL MODEM AND ANTENNA TO NEW CABINET.
4. CONTRACTOR SHALL MAINTAIN AND RE-USE EXISTING ELECTRICAL SERVICE AND FEEDER CONDUCTORS.

REMOVE AND DISPOSE THE FOLLOWING	
QUANTITY	DESCRIPTION
1	EXISTING DMS COMPONENTS

MM 114

**DOCUMENT NOT CONSIDERED FINAL  
 UNLESS ALL SIGNATURES COMPLETED**

<p>750 N. Greenfield Pkwy., Garner, NC 27529</p>	<b>DMS REPLACEMENT</b>		
	DIVISION 04 WILSON CO. PLAN DATE: JULY 2021 PREPARED BY: J. WALDEN	REVIEWED BY: A.J. SKUCE, PE REVIEWED BY:	
	SCALE 	REVISIONS INIT. DATE	SEAL ANDREW J. SKUCE ENGINEER 05/11/22/2021 DATE