

DEFAULT PHASING DIAGRAM

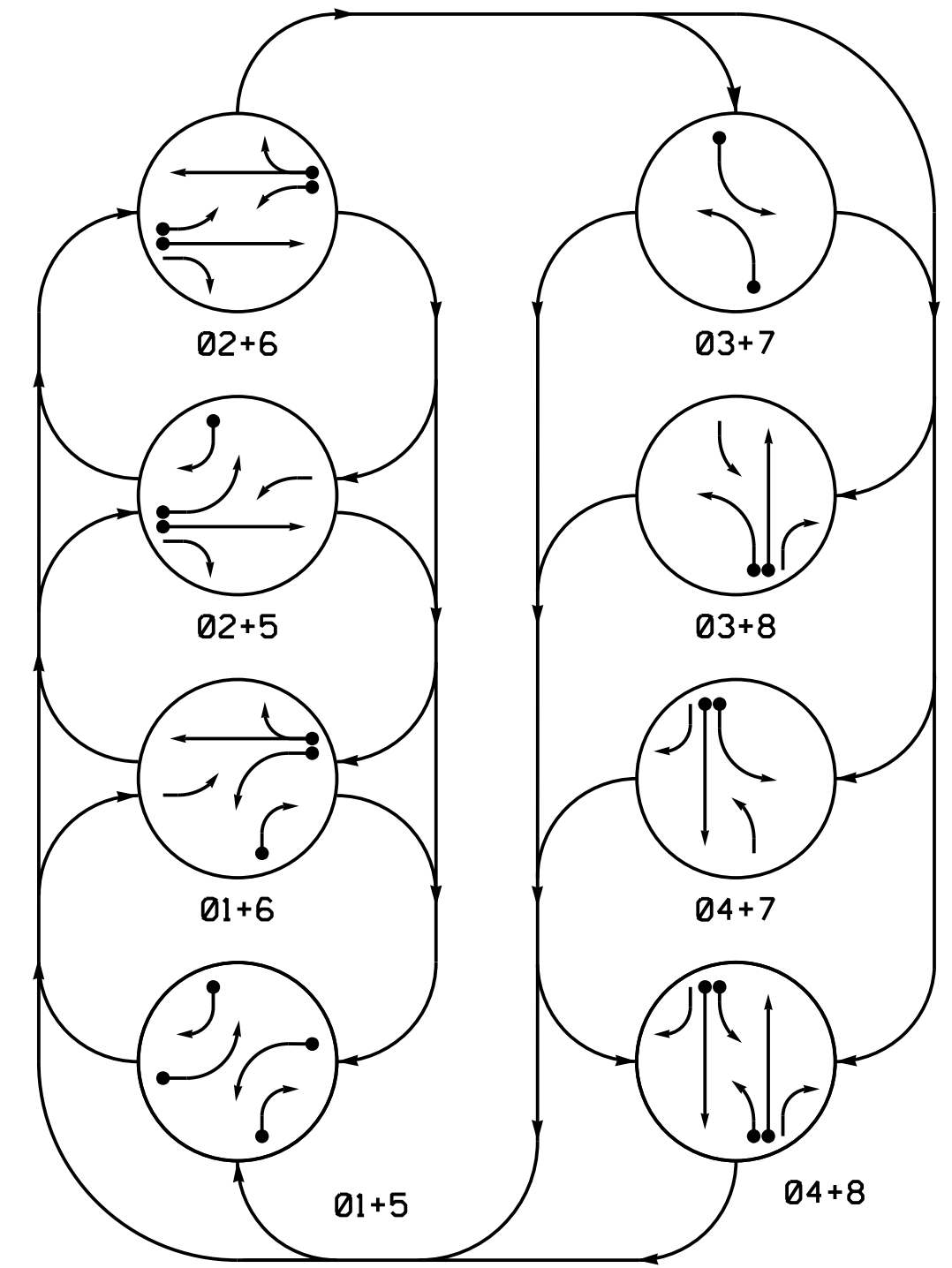

ALTERNATE PHASING DIAGRAM

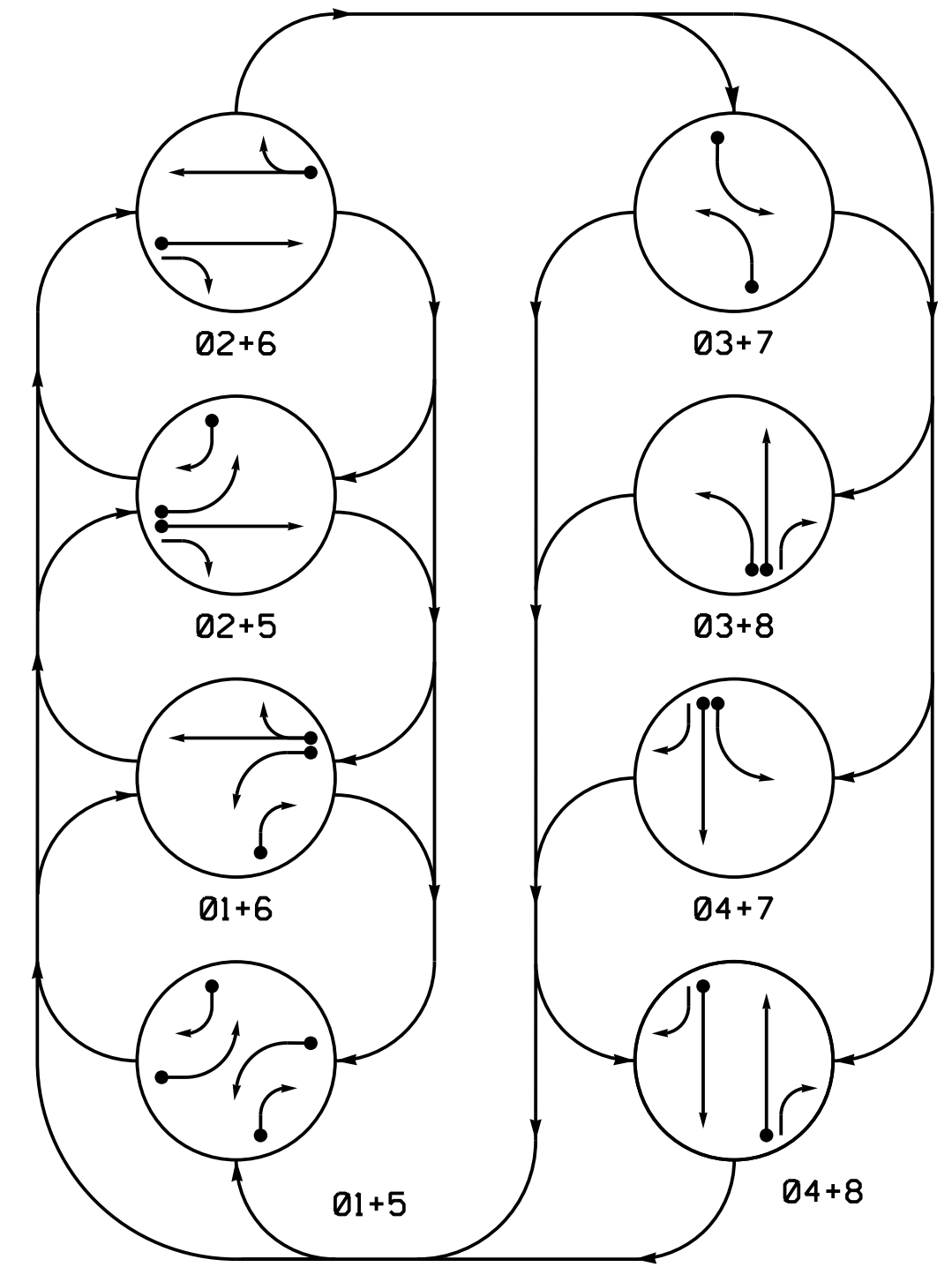

PHASING DIAGRAM DETECTION LEGEND

- ←● DETECTED MOVEMENT
- ← UNDETECTED MOVEMENT (OVERLAP)
- ←..... UNSIGNALIZED MOVEMENT
- ←- - - PEDESTRIAN MOVEMENT

DEFAULT PHASING TABLE OF OPERATION

SIGNAL FACE	PHASE							
	01+5	01+6	02+5	02+6	03+7	03+8	04+7	04+8
11								
21,22	R	R	G	G	R	R	R	Y
31	R	R	R	R				
41	R	R	R	R	R	G	G	R
42	R	R	R	R	R	G	G	R
51								
61,62	R	G	R	G	R	R	R	Y
71	R	R	R	R				
81	R	R	R	R	G	G	R	R
82	R	R	R	R	G	R	G	R

ALTERNATE PHASING TABLE OF OPERATION

SIGNAL FACE	PHASE							
	01+5	01+6	02+5	02+6	03+7	03+8	04+7	04+8
11								
21,22	R	R	G	G	R	R	R	Y
31	R	R	R	R				
41	R	R	R	R	R	G	G	R
42	R	R	R	R	R	G	G	R
51								
61,62	R	G	R	G	R	R	R	Y
71	R	R	R	R				
81	R	R	R	R	G	G	R	R
82	R	R	R	R	G	R	G	R

OASIS 2070 LOOP & DETECTOR INSTALLATION CHART

LOOP	SIZE (FT)	DISTANCE FROM STOPBAR (FT)	TURNS	NEW LOOP	DETECTOR PROGRAMMING				STRETCH TIME	DELAY TIME	SYSTEM LOOP	NEW CARD
					PHASE	CALLING	EXTENSION	FULL TIME DELAY				
1A	6X40	0	2-4-2	Y	1	Y	Y	-	**15	-	Y	
1B	6X40	0	2-4-2	Y	1	Y	Y	-	15	-	Y	
2A	6X6	300	5	Y	2	Y	Y	-	-	-	Y	
3A	6X40	0	2-4-2	Y	3	Y	Y	-	**15	-	Y	
4A	6X6	300	5	Y	4	-	Y	-	-	-	Y	
4B	6X40	0	2-4-2	Y	4	Y	Y	2	5	-	Y	
5A	6X40	0	2-4-2	Y	5	Y	Y	-	**15	-	Y	
5B	6X40	0	2-4-2	Y	5	Y	Y	-	15	-	Y	
6A	6X6	300	5	Y	6	Y	Y	-	-	-	Y	
7A	6X40	0	2-4-2	Y	7	Y	Y	-	**15	-	Y	
8A	6X40	0	2-4-2	Y	8	Y	Y	-	-	-	Y	

* Disable phase 2,4,6, and 8 call for 1A,3A,5A, and 7A during alternate phasing operation.
 ** Reduce delay to 3 seconds during alternate phasing operation.

8 Phase Fully Actuated Jacksonville City Signal System

NOTES

- Refer to "Roadway Standard Drawings NCDOT" dated January 2018 and "Standard Specifications for Roads and Structures" dated January 2018.
- Do not program signal for late night flashing operation unless otherwise directed by the Engineer.
- Phase 1 and/or phase 5 may be lagged.
- Phase 3 and/or phase 7 may be lagged.
- Locate new cabinet so as not to obstruct sight distance of vehicles turning right on red.
- Set all detector units to presence mode.
- The Division Traffic Engineer will determine the hours of use for each phasing plan.

SIGNAL FACE I.D.

All Heads L.E.D.

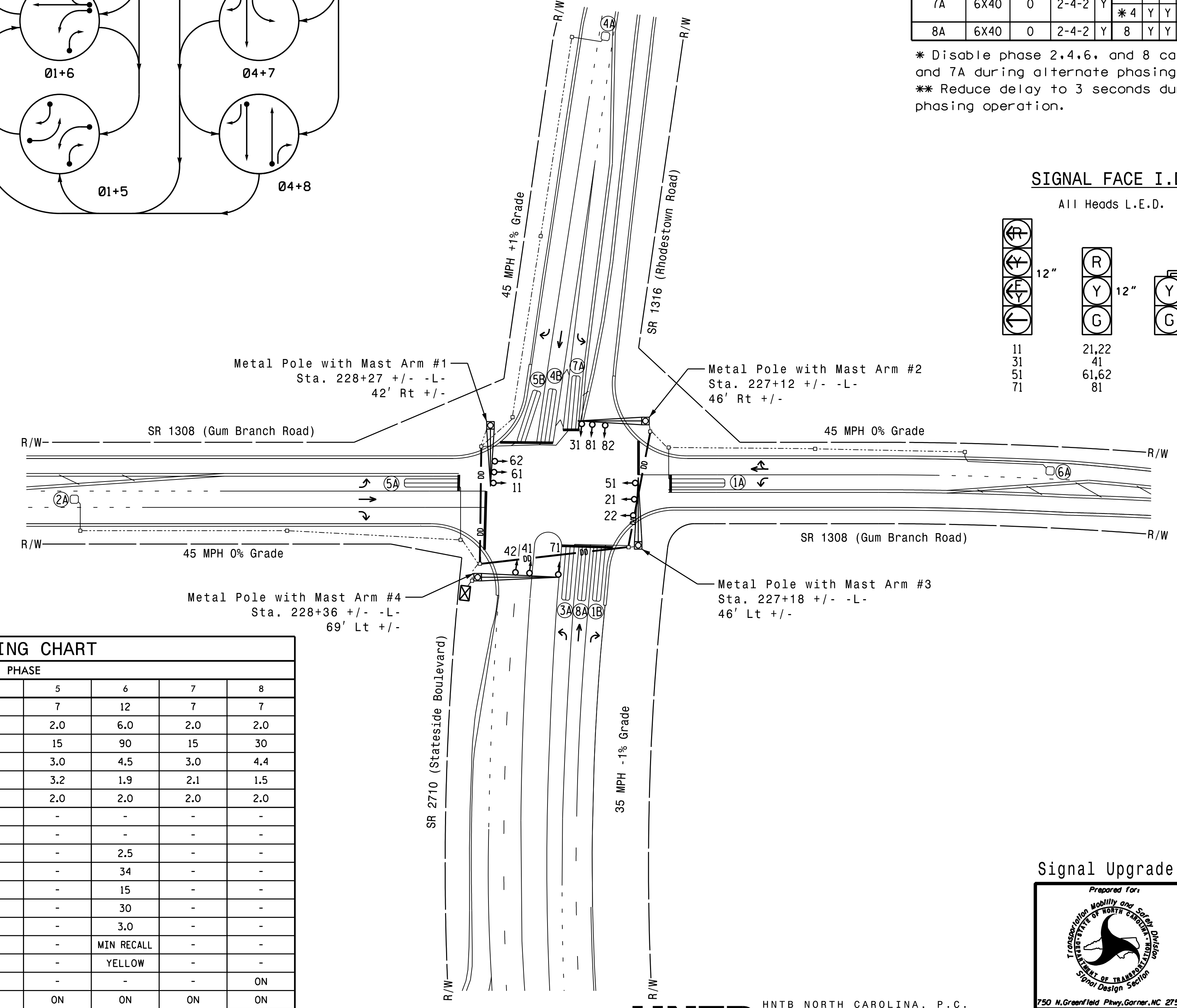
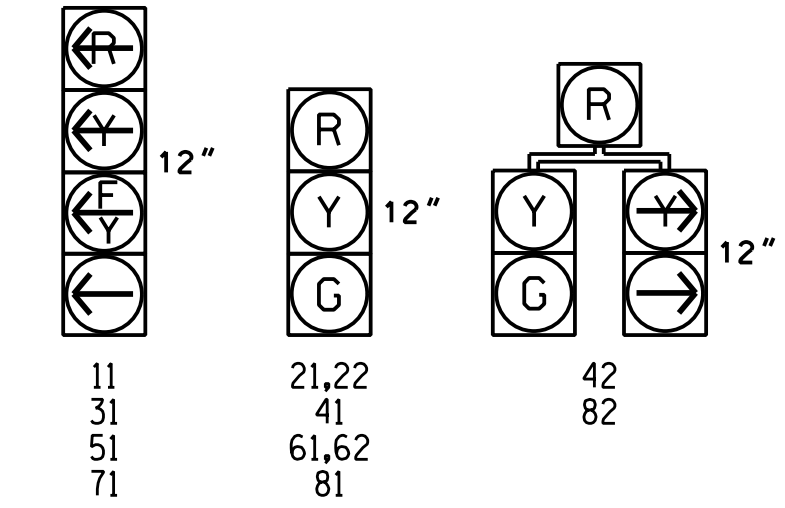

OASIS 2070 TIMING CHART

FEATURE	PHASE							
	1	2	3	4	5	6	7	8
Min Green 1 *	7	12	7	7	7	12	7	7
Extension 1 *	2.0	6.0	2.0	6.0	2.0	6.0	2.0	2.0
Max Green 1 *	15	90	15	30	15	90	15	30
Yellow Clearance	3.0	4.5	3.0	4.4	3.0	4.5	3.0	4.4
Red Clearance	3.4	1.9	2.4	1.5	3.2	1.9	2.1	1.5
Red Revert	2.0	2.0	2.0	2.0	2.0	2.0	2.0	2.0
Walk 1 *	-	-	-	-	-	-	-	-
Don't Walk 1	-	-	-	-	-	-	-	-
Seconds Per Actuation *	-	2.5	-	-	-	2.5	-	-
Max Variable Initial *	-	34	-	-	-	34	-	-
Time Before Reduction *	-	15	-	0	-	15	-	-
Time To Reduce *	-	30	-	15	-	30	-	-
Minimum Gap	-	3.0	-	3.0	-	3.0	-	-
Recall Mode	-	MIN RECALL	-	-	-	MIN RECALL	-	-
Vehicle Call Memory	-	YELLOW	-	-	-	YELLOW	-	-
Dual Entry	-	-	-	ON	-	-	-	ON
Simultaneous Gap	ON	ON	ON	ON	ON	ON	ON	ON

* These values may be field adjusted. Do not adjust Min Green and Extension times for phases 2 and 6 lower than what is shown. Min Green for all other phases should not be lower than 4 seconds.

LEGEND

PROPOSED	EXISTING
Traffic Signal Head	N/A
Modified Signal Head	N/A
Sign	N/A
Pedestrian Signal Head With Push Button & Sign	N/A
Signal Pole with Guy	N/A
Signal Pole with Sidewalk Guy	N/A
Inductive Loop Detector Controller & Cabinet	N/A
Junction Box	N/A
2-in Underground Conduit	N/A
N/A	Right of Way
→	Directional Arrow
- - -	Directional Drill
⊙	Metal Pole with Mastarm

Signal Upgrade

DOCUMENT NOT CONSIDERED FINAL UNLESS ALL SIGNATURES COMPLETED

<p>HNTB NORTH CAROLINA, P.C. 343 E. Six Forks Road, Suite 200 Raleigh, North Carolina 27609 NC License No: C-1554 (919) 546-8997</p>	SR 1308 (Gum Branch Road) at SR 1316 (Rhodestown Road)/ SR 2710 (Stateside Boulevard)	SEAL N. R. SIMMONS ENGINEER SEAL 031464
	Division 03 Onslow Co. Jacksonville PLAN DATE: October 2018 REVIEWED BY: A.D. Klinksiek PREPARED BY: A.H. Thornburg REVIEWED BY: N.R. Simmons	REVISIONS INITI. DATE SIGNATURE DATE SIG. INVENTORY NO. 03-1029