

8/17/99

PROJECT REFERENCE NO.	SHEET NO.
U-4906	EC-44/CONST.21
RW SHEET NO.	
ROADWAY DESIGN ENGINEER	HYDRAULICS ENGINEER

NOTE: UTILIZE COIR FIBER MATTING ADJACENT TO WETLANDS /JURISDICTIONAL AREAS, AND AS DIRECTED

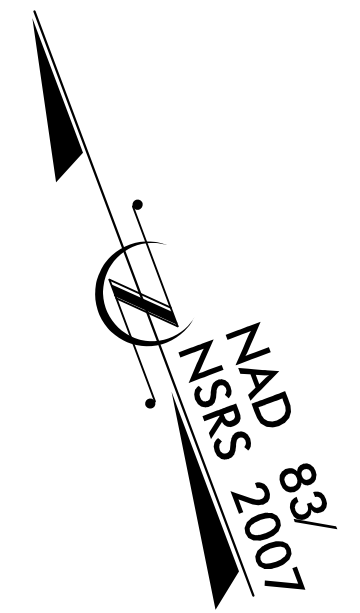

-L-

PIs Sta. 262+80.39 θs = 1° 01' 50.8" θs = 6° 02' 20.7" Ls = 200.00' LT = 123.72' ST = 76.51'	PI Sta. 266+99.00 Δ = 39° 40' 16.4" (LT) D = 6° 02' 15.0" L = 657.08' T = 342.33' R = 949.00'	PIs Sta. 270+80.49 θs = 6° 02' 15.0" Ls = 200.00' LT = 133.41' ST = 66.74'	PI Sta. 277+01.07 Δ = 34° 31' 11.7" (RT) D = 5° 46' 09.8" L = 598.33' T = 308.55' R = 993.10'
SE = EXISTING		SE = EXISTING	

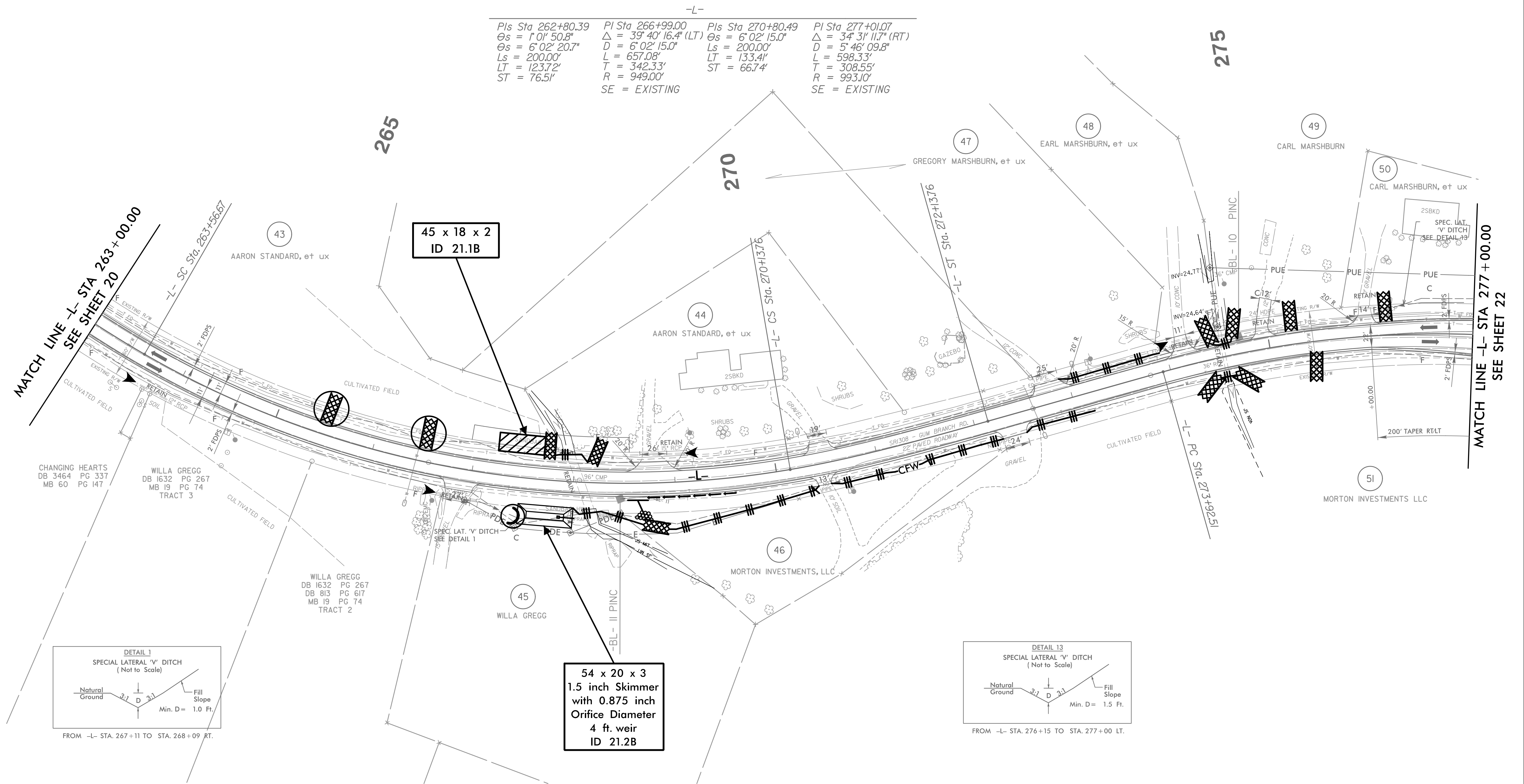

MATCH LINE -L- STA 263+00.00
SEE SHEET 20

MATCH LINE -L- STA 277+00.00
SEE SHEET 22

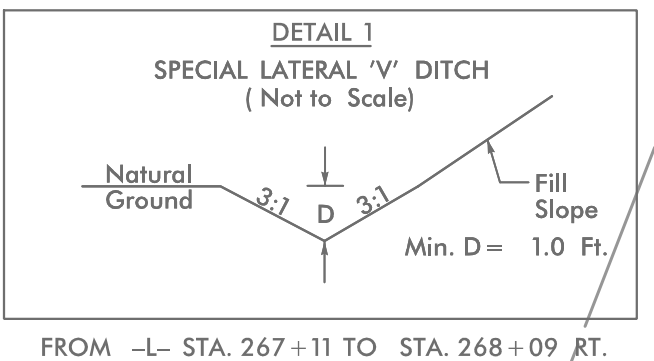

54 x 20 x 3
1.5 inch Skimmer
with 0.875 inch
Orifice Diameter
4 ft. weir
ID 21.2B

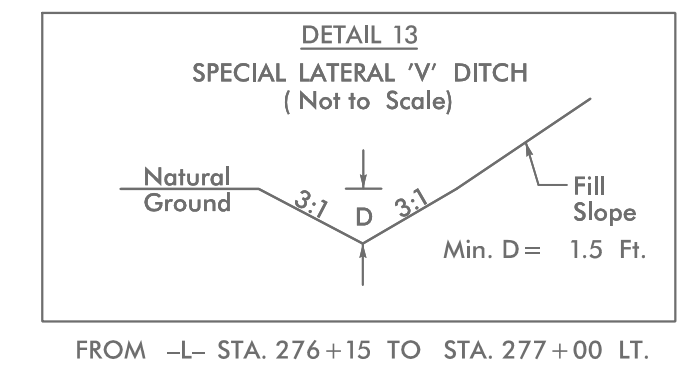

DESIGN EXCEPTION REQUESTED FOR LANE WIDTHS (11') AND USABLE SHOULDER (4' MINIMUM)

NOTE: ALL DRIVEWAY RADII ARE 10' UNLESS OTHERWISE NOTED ON PLANS

FOR -L- PROFILE, SEE SHEET 35

I:\V\1306-EC-21_Const-21.dgn