

8/17/99

HNTB HNTB NORTH CAROLINA, P.C.
343 E. SIX FORKS ROAD, SUITE 200
RALEIGH, NORTH CAROLINA 27609
NC LICENSE NO: C-1554

PROJECT REFERENCE NO.	SHEET NO.
U-4906	EC-42/CONST.19
RW SHEET NO.	
ROADWAY DESIGN ENGINEER	HYDRAULICS ENGINEER

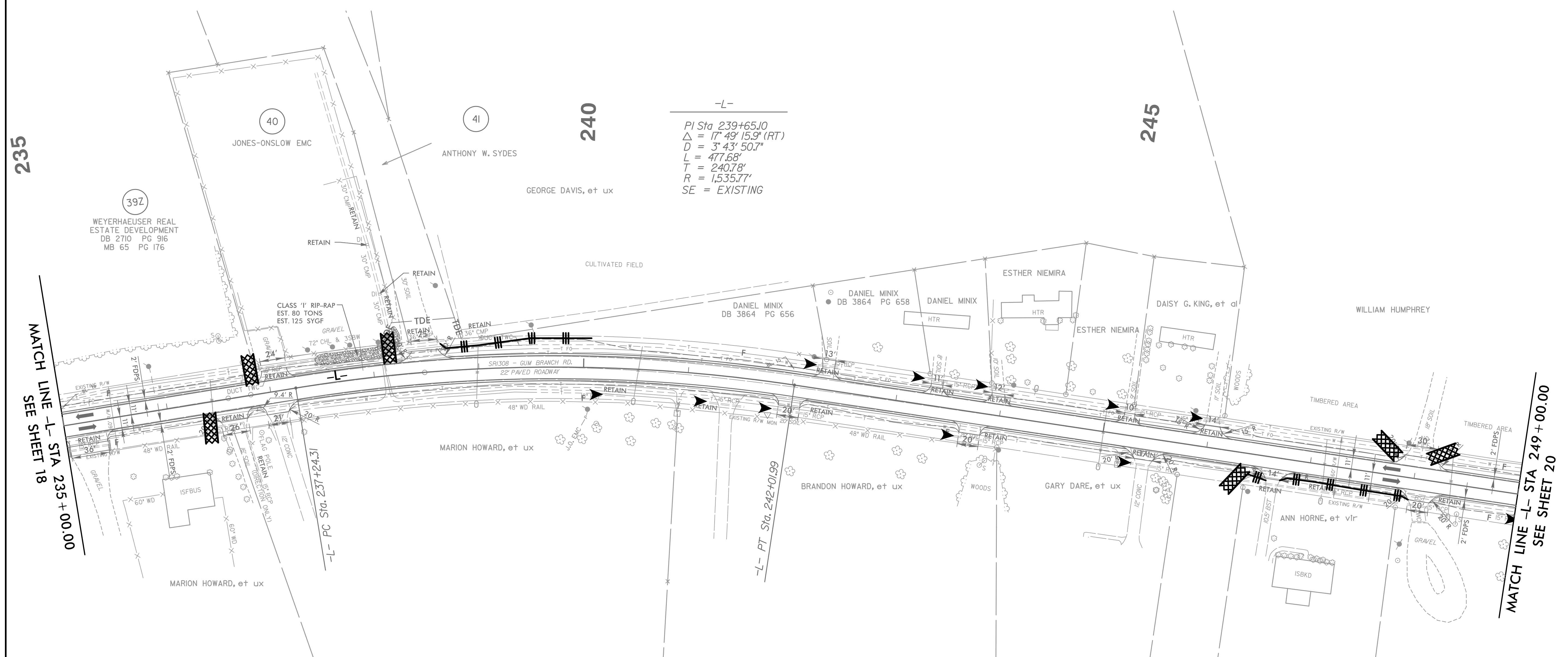
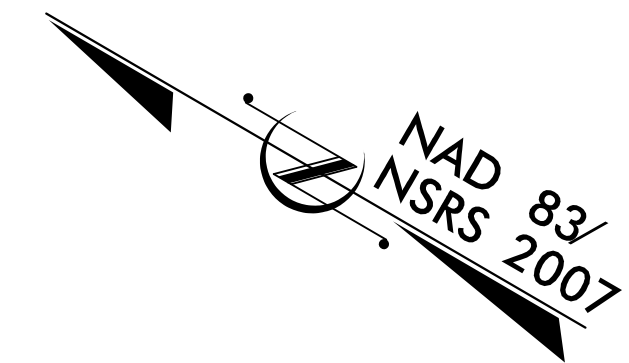

-L-
 PI Sta 239+65.10
 $\Delta = 17^\circ 49' 15.9" (RT)$
 $D = 3^\circ 43' 50.7"$
 $L = 477.68'$
 $T = 240.78'$
 $R = 1,535.77'$
 SE = EXISTING

MATCH LINE -L- STA 235 + 00.00
SEE SHEET 18

MATCH LINE -L- STA 249 + 00.00
SEE SHEET 20

DESIGN EXCEPTION REQUESTED FOR LANE WIDTHS (11') AND USABLE SHOULDER (4' MINIMUM)
 NOTE: ALL DRIVEWAY RADII ARE 10' UNLESS OTHERWISE NOTED ON PLANS

FOR -L- PROFILE, SEE SHEET 34

1/11/2009 10:06:56 EC-19_Const+19.dgn