

5/14/99  
5/18/2006  
HNTB  
5/18/2006 EC-16.Const-16.dgn

PROJECT REFERENCE NO.	SHEET NO.
U-4906	EC-39/CONST.16
RW SHEET NO.	
ROADWAY DESIGN ENGINEER	HYDRAULICS ENGINEER

NOTE: UTILIZE COIR FIBER MATTING ADJACENT TO WETLANDS /JURISDICTIONAL AREAS, AND AS DIRECTED

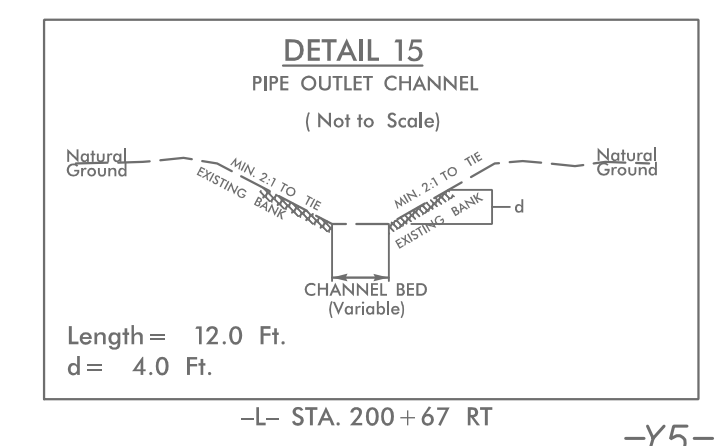
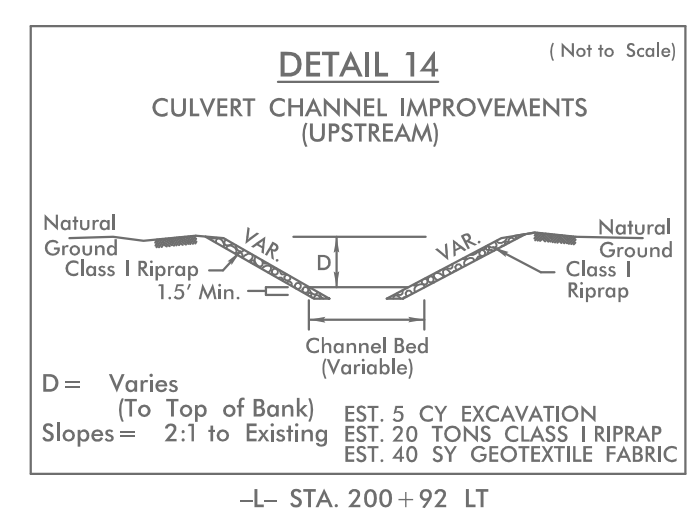
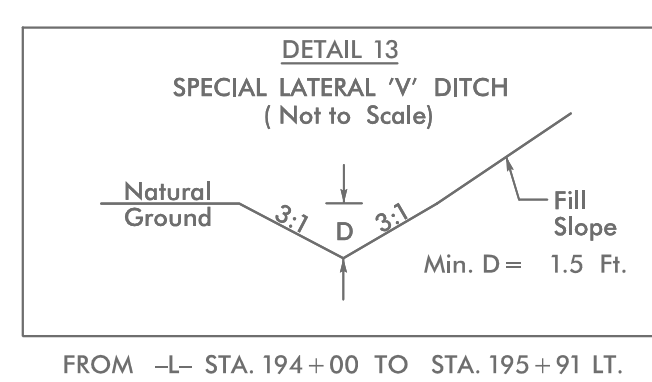
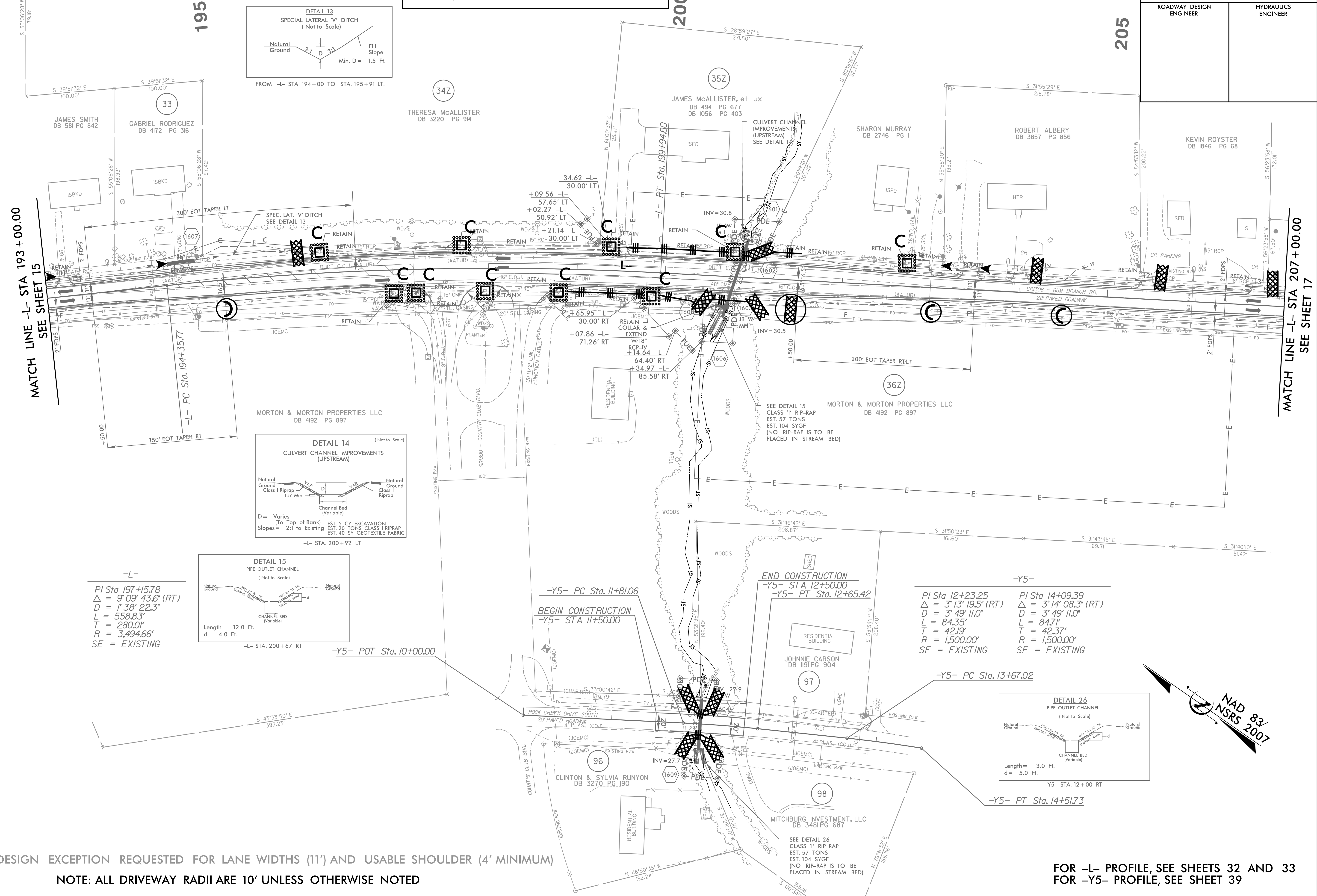

-L-  
PI Sta 197+15.78  
 $\Delta = 9'09''43.6''$  (RT)  
D = 1'38''22.3''  
L = 558.83'  
T = 280.0'  
R = 3,494.66'  
SE = EXISTING

-Y5-  
PI Sta 12+23.25  
 $\Delta = 3'13''19.5''$  (RT)  
D = 3'49''11.0''  
L = 84.35'  
T = 42.19'  
R = 1,500.00'  
SE = EXISTING

PI Sta 14+09.39  
 $\Delta = 3'14''08.3''$  (RT)  
D = 3'49''11.0''  
L = 84.71'  
T = 42.37'  
R = 1,500.00'  
SE = EXISTING

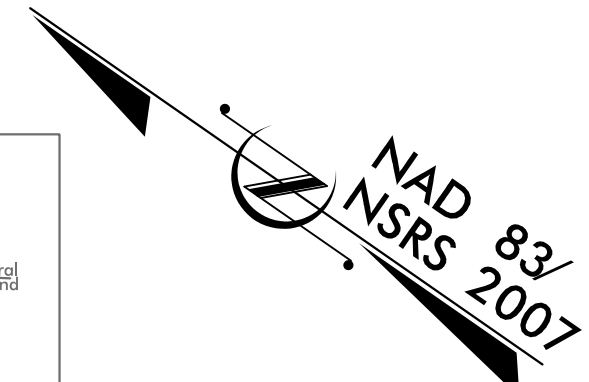
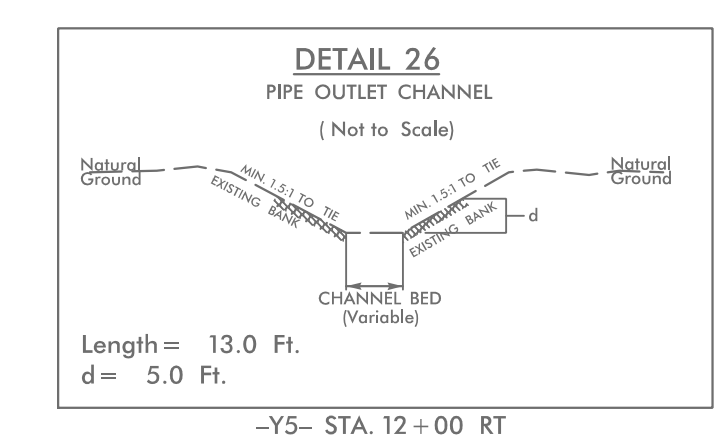

DESIGN EXCEPTION REQUESTED FOR LANE WIDTHS (11') AND USABLE SHOULDER (4' MINIMUM)  
NOTE: ALL DRIVEWAY RADII ARE 10' UNLESS OTHERWISE NOTED

FOR -L- PROFILE, SEE SHEETS 32 AND 33  
FOR -Y5- PROFILE, SEE SHEET 39