

8/17/99

PROJECT REFERENCE NO.	SHEET NO.
U-4906	EC-34/CONST.II
RW SHEET NO.	
ROADWAY DESIGN ENGINEER	HYDRAULICS ENGINEER

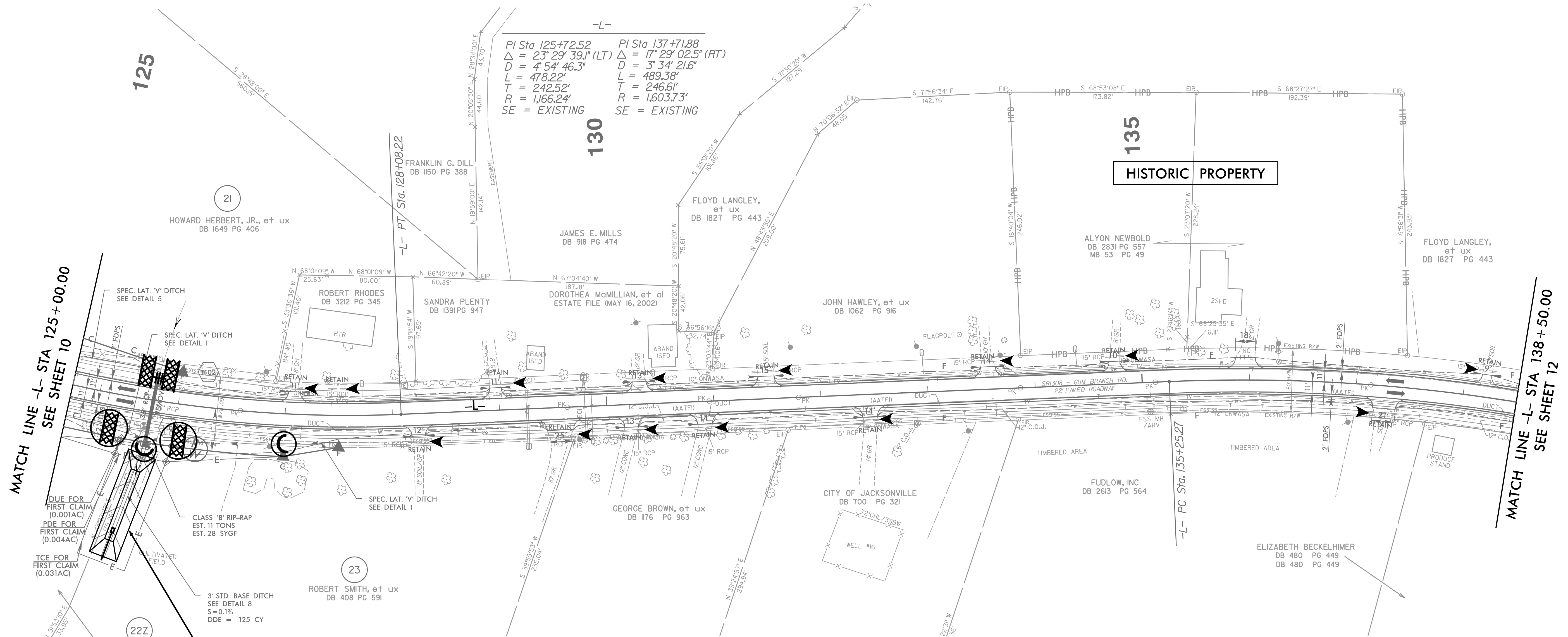
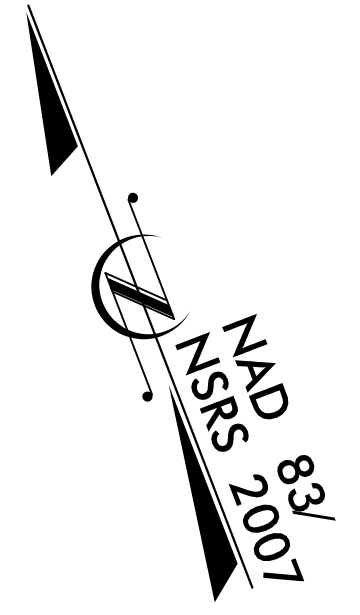

PI Sta 125+72.52    PI Sta 137+71.88  
 $\Delta = 23^\circ 29' 39.1''$  (LT)     $\Delta = 17^\circ 29' 02.5''$  (RT)  
 $D = 4' 54'' 46.3''$      $D = 3' 34'' 21.6''$   
 $L = 478.22'$      $L = 489.38'$   
 $T = 242.52'$      $T = 246.61'$   
 $R = 1,663.24'$      $R = 1,603.73'$   
 SE = EXISTING    SE = EXISTING

MATCH LINE -L- STA 125+00.00  
 SEE SHEET 10

MATCH LINE -L- STA 138+50.00  
 SEE SHEET 12

**103 x 27 x 3  
 1.5 inch Skimmer  
 with 1.5 inch  
 Orifice Diameter  
 11 ft. weir  
 ID 11.1B**

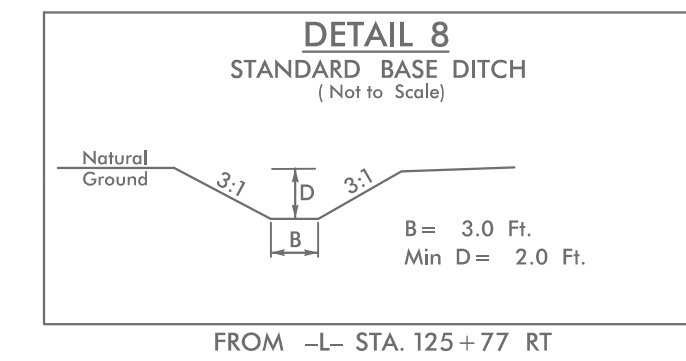
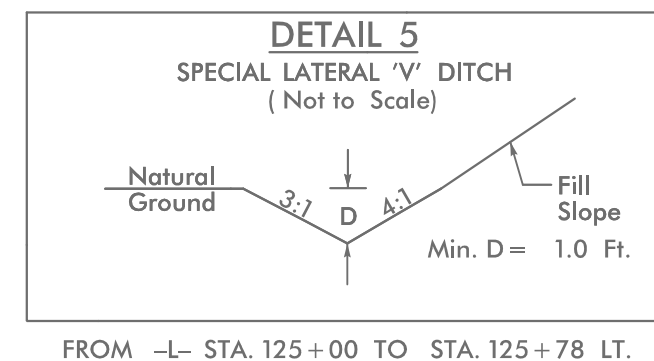
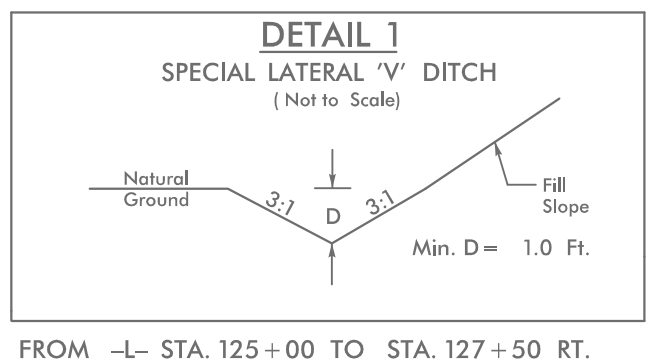

DESIGN EXCEPTION REQUESTED FOR LANE WIDTHS (11') AND USABLE SHOULDER (4' MINIMUM)  
 NOTE: ALL DRIVEWAY RADII ARE 10' UNLESS OTHERWISE NOTED

FOR -L- PROFILE, SEE SHEET 30

5/18/2021  
 1066-EC-11-Const-11.dgn