

5/14/99

HNTB HNTB NORTH CAROLINA, P.C.
343 E. Six Forks Road, Suite 200
Raleigh, North Carolina 27609
NC License No: C-1554

PROJECT REFERENCE NO.	SHEET NO.
U-4906	EC-32/CONST.9
RW SHEET NO.	
ROADWAY DESIGN ENGINEER	HYDRAULICS ENGINEER

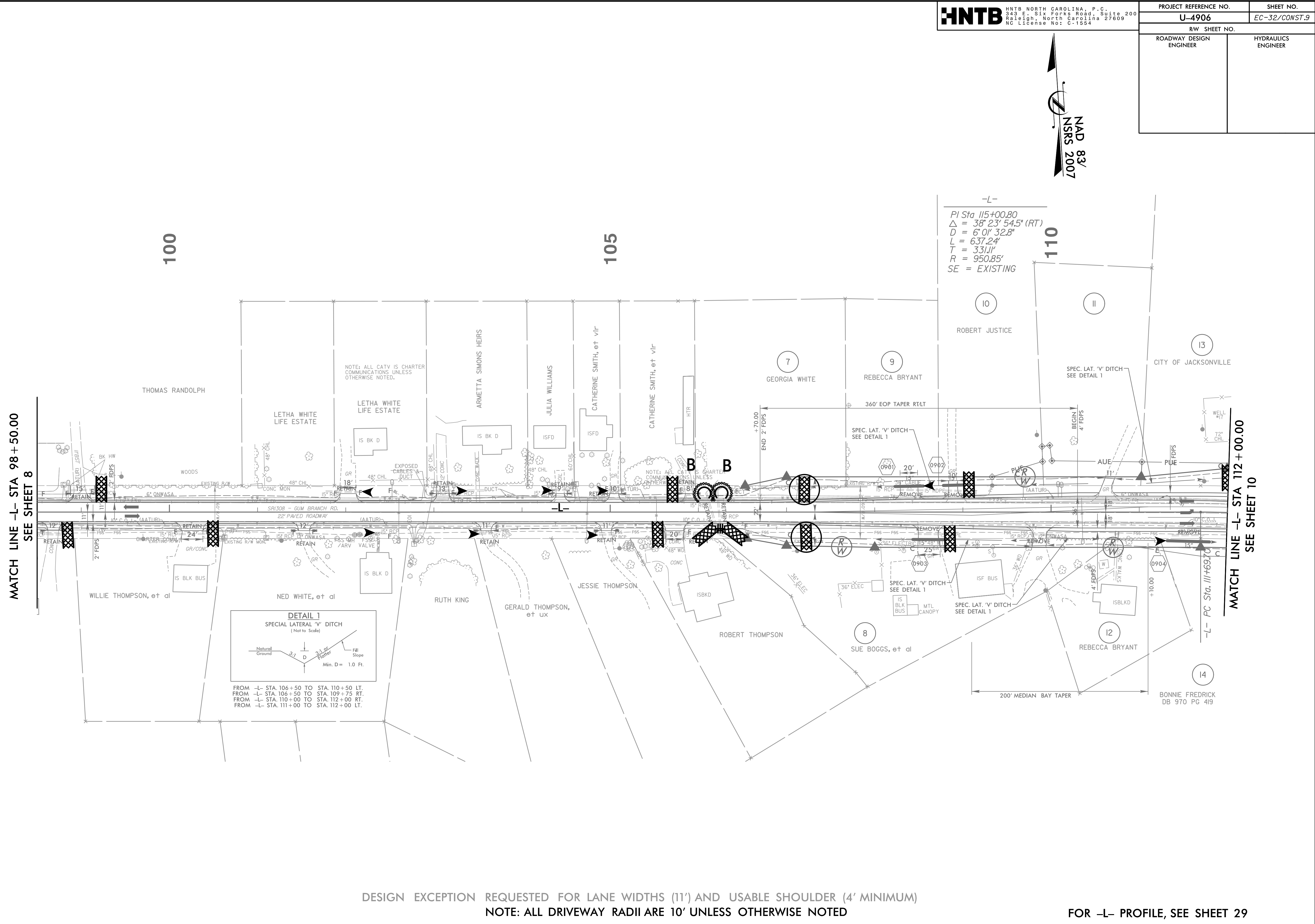

MATCH LINE -L- STA 98 + 50.00
SEE SHEET 8

MATCH LINE -L- STA 112 + 00.00
SEE SHEET 10

-L-
 PI Sta 115+00.80
 $\Delta = 38^{\circ} 23' 54.5" (RT)$
 $D = 6^{\circ} 0' 32.8"$
 $L = 637.24'$
 $T = 331.11'$
 $R = 950.85'$
 SE = EXISTING

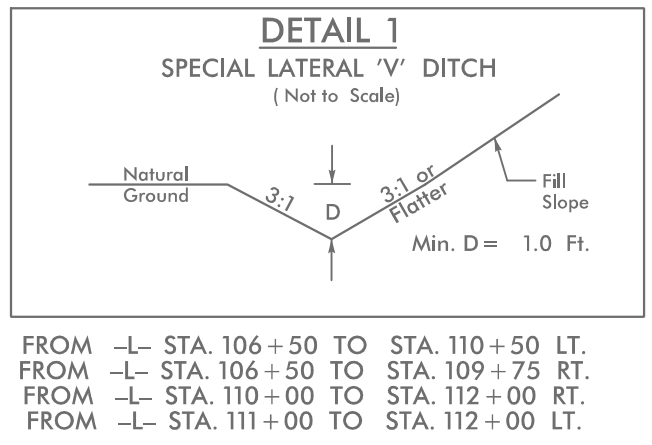

DESIGN EXCEPTION REQUESTED FOR LANE WIDTHS (11') AND USABLE SHOULDER (4' MINIMUM)
 NOTE: ALL DRIVEWAY RADII ARE 10' UNLESS OTHERWISE NOTED

FOR -L- PROFILE, SEE SHEET 29

\\V:\2009\112019\112019.dgn
5/14/99
HNTB