

5/14/99
1/1/2009
U-4906-EC-5_Const-5.dgn
HNTB

PROJECT REFERENCE NO.	SHEET NO.
U-4906	EC-28/CONST.5
RW SHEET NO.	
ROADWAY DESIGN ENGINEER	HYDRAULICS ENGINEER

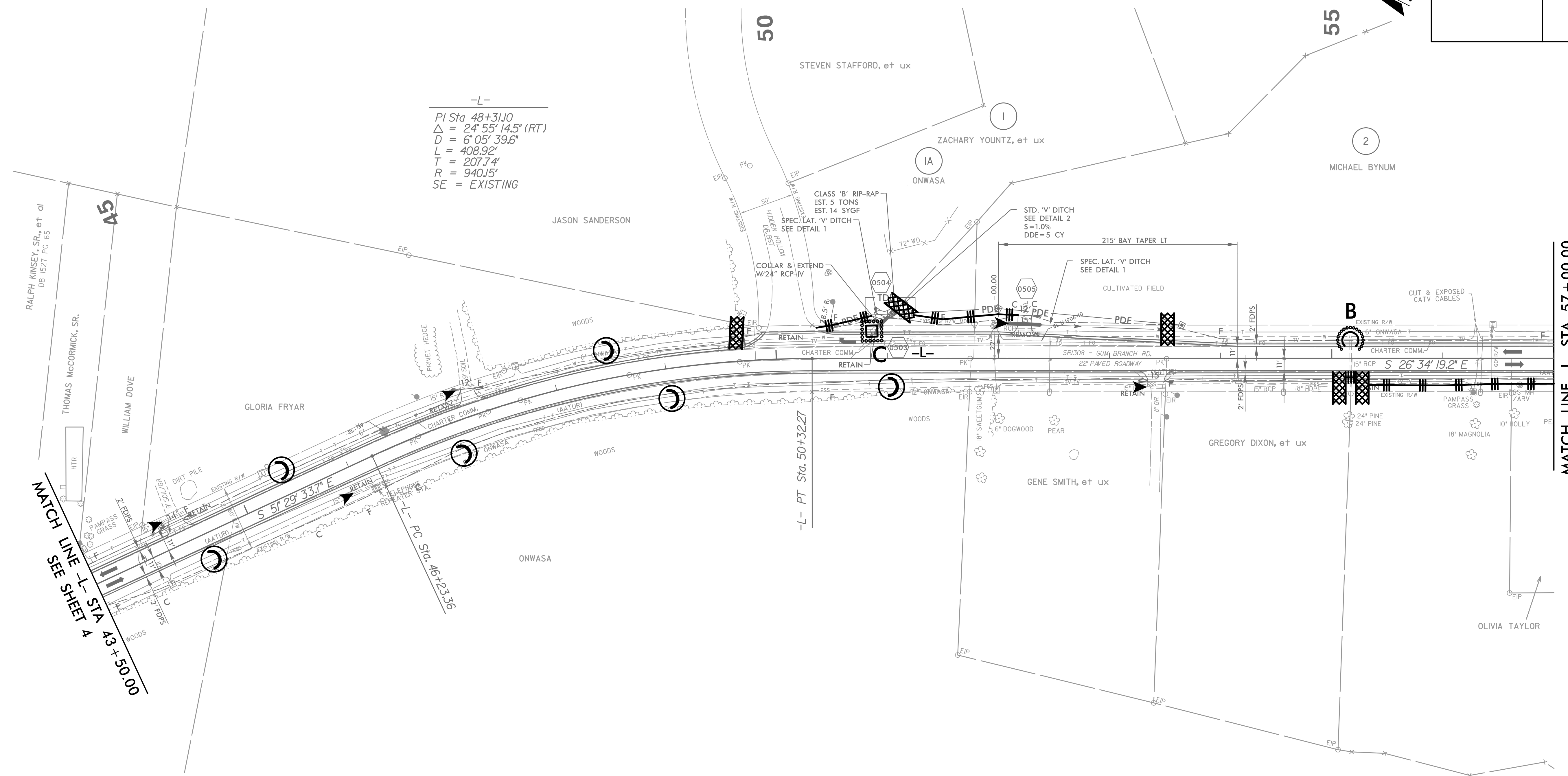

-L-
PI Sta 48+31.10
 $\Delta = 24^\circ 55' 14.5''$ (RT)
D = 6' 05" 39.6"
L = 408.92'
T = 207.74'
R = 940.15'
SE = EXISTING

MATCH LINE -L- STA 43+50.00
SEE SHEET 4

MATCH LINE -L- STA 57+00.00
SEE SHEET 6

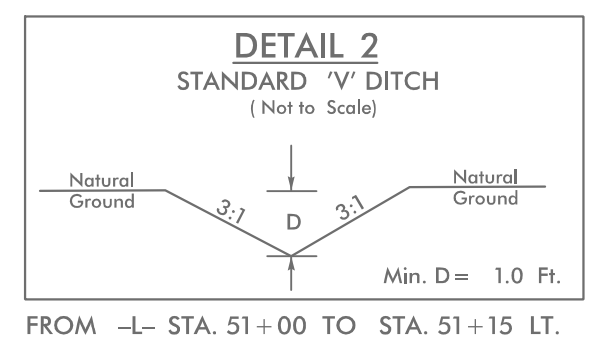
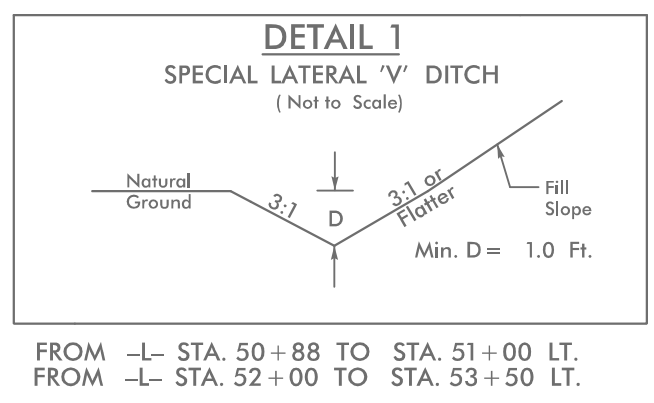

DESIGN EXCEPTION REQUESTED FOR LANE WIDTHS (11') AND USABLE SHOULDER (4' MINIMUM)

NOTE: ALL DRIVEWAY RADII ARE 10' UNLESS OTHERWISE NOTED

FOR -L- PROFILE, SEE SHEET 27