

PROJECT REFERENCE NO.	SHEET NO.
U-4906	EC-16B/CONST.16
RW SHEET NO.	
ROADWAY DESIGN ENGINEER	HYDRAULICS ENGINEER

CULVERT CONSTRUCTION SEQUENCE STA. 12+00 -Y5-

1. SET UP SIGNS FOR OFF SITE DETOUR.
2. UTILIZE SPECIAL STILLING BASIN(S) AS NEEDED THROUGHOUT CULVERT CONSTRUCTION.
3. INSTALL IMPERVIOUS DIKES AS SHOWN.
4. INSTALL PUMP AND 42" TEMPORARY PIPE A AS SHOWN
5. REMOVE EXISTING 42" PIPE. INSTALL 87" X 63" CAAP, UPSTREAM HEADWALL AND DOWNSTREAM CLASS 'I' RIP-RAP.
6. REMOVE IMPERVIOUS DIKES, 42" TEMPORARY PIPE, AND ANY REMAINING SPECIAL STILLING BASIN(S).
7. COMPLETE ROADWAY.

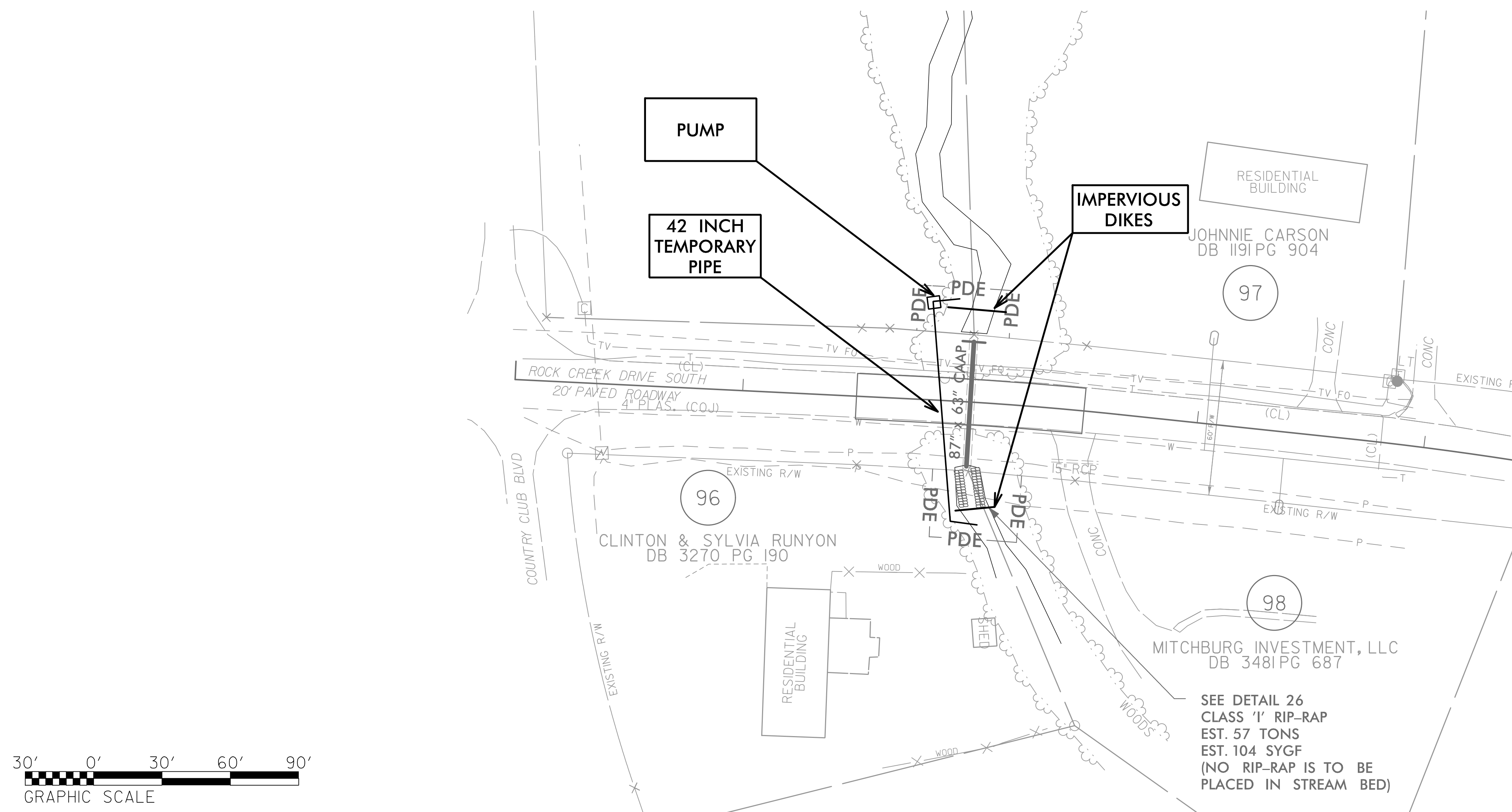

SEE DETAIL 26
 CLASS 'I' RIP-RAP
 EST. 57 TONS
 EST. 104 SYGF
 (NO RIP-RAP IS TO BE
 PLACED IN STREAM BED)