

| | | |
|--|---------------------|------------------------|
| PROJECT REFERENCE NO. U-4906 | | SHEET NO. 15 |
| RW SHEET NO. | | |
| ROADWAY DESIGN ENGINEER | HYDRAULICS ENGINEER | |
| | | |
| DOCUMENT NOT CONSIDERED FINAL UNLESS ALL SIGNATURES COMPLETED | | |

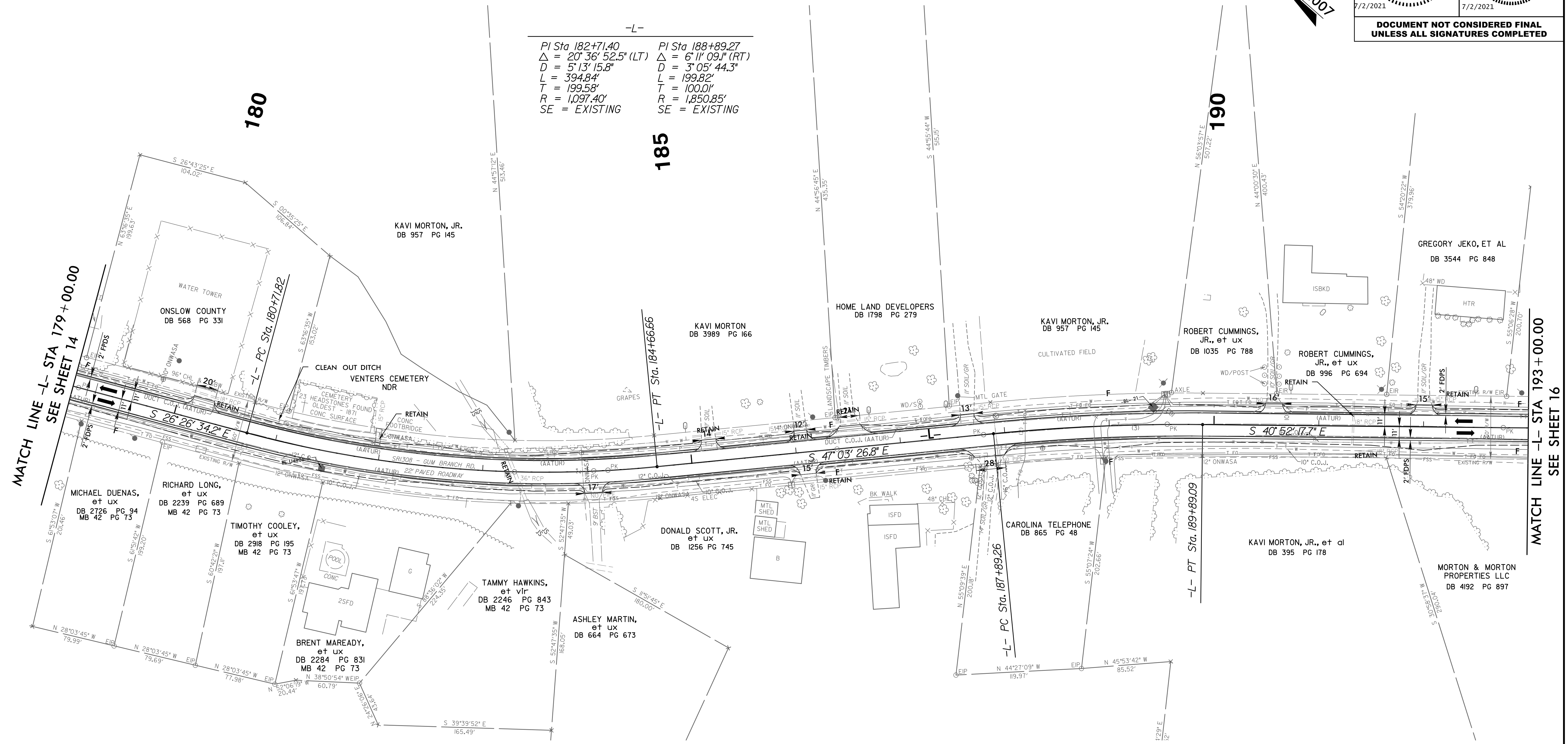
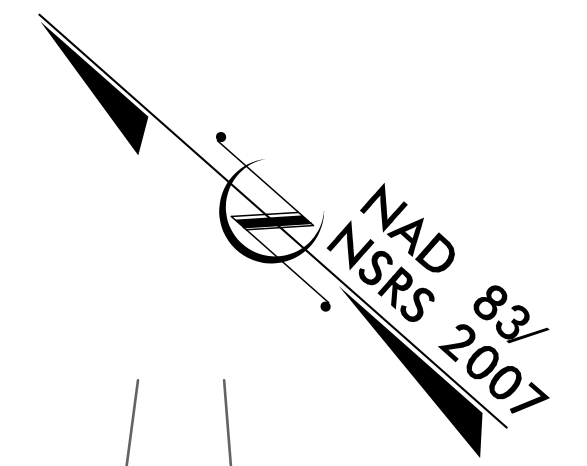

-L-

| | |
|-------------------------------------|------------------------------------|
| PI Sta 182+71.40 | PI Sta 188+89.27 |
| $\Delta = 20^\circ 36' 52.5''$ (LT) | $\Delta = 6^\circ 11' 09.1''$ (RT) |
| $D = 5^\circ 13' 15.8''$ | $D = 3^\circ 05' 44.3''$ |
| $L = 394.84'$ | $L = 199.82'$ |
| $T = 199.58'$ | $T = 100.01'$ |
| $R = 1,097.40'$ | $R = 1,850.85'$ |
| SE = EXISTING | SE = EXISTING |

MATCH LINE -L- STA 179+00.00
SEE SHEET 14

MATCH LINE -L- STA 193+00.00
SEE SHEET 16

DESIGN EXCEPTION REQUESTED FOR LANE WIDTHS (11') AND USABLE SHOULDER (4' MINIMUM)
 NOTE: ALL DRIVEWAY RADII ARE 10' UNLESS OTHERWISE NOTED

FOR -L- PROFILE, SEE SHEET 32