

8/17/19

PROJECT REFERENCE NO. U-4906	SHEET NO. 14
RW SHEET NO.	
ROADWAY DESIGN ENGINEER	HYDRAULICS ENGINEER
DOCUMENT NOT CONSIDERED FINAL UNLESS ALL SIGNATURES COMPLETED	

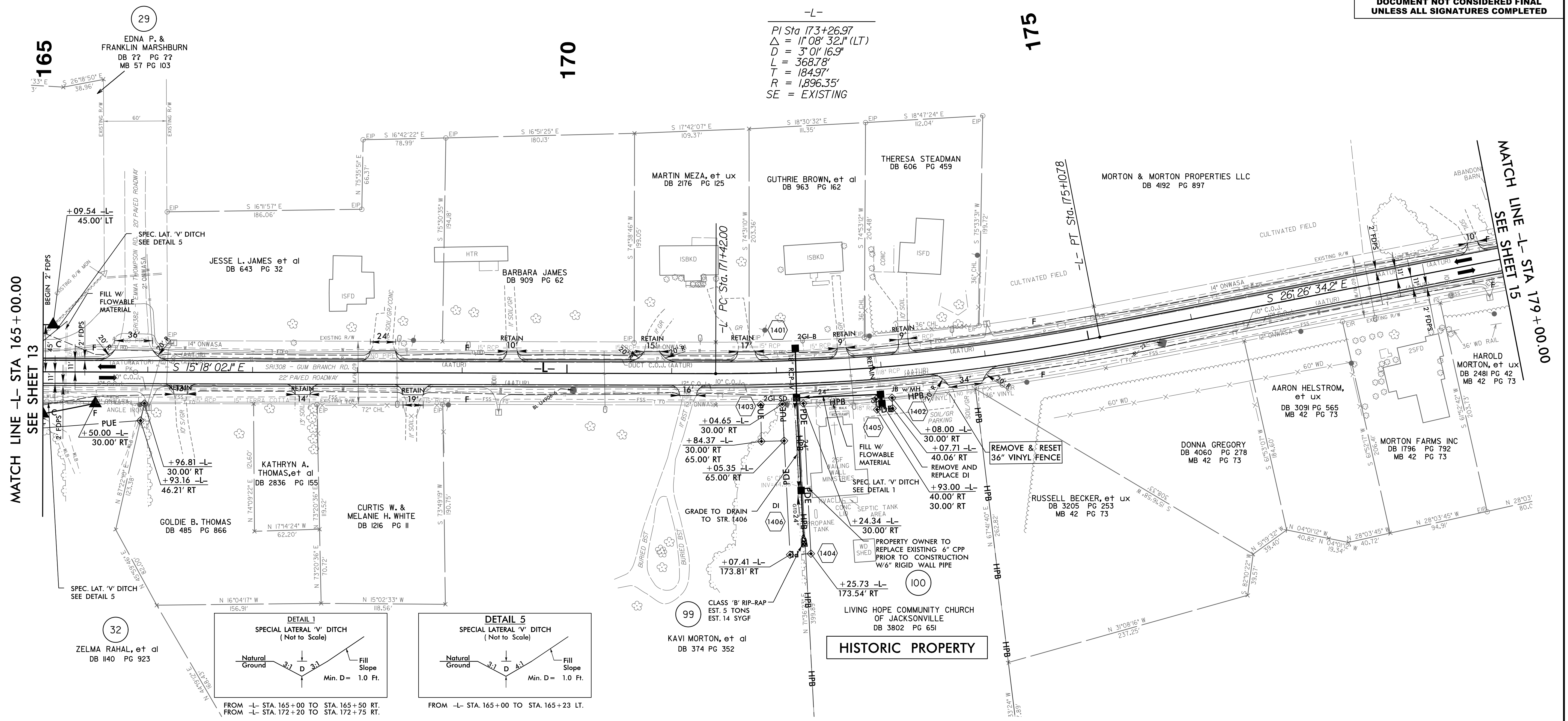
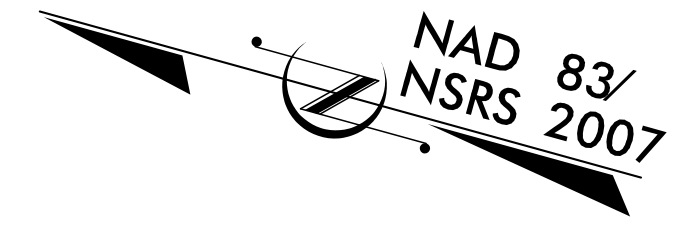

-L-
 PI Sta 173+26.97
 $\Delta = 11^{\circ}08'32.1''$ (LT)
 $D = 3^{\circ}01'16.9''$
 $L = 368.78'$
 $T = 184.97'$
 $R = 1,896.35'$
 SE = EXISTING

MATCH LINE -L- STA 165+00.00
 SEE SHEET 13

MATCH LINE -L- STA 179+00.00
 SEE SHEET 15

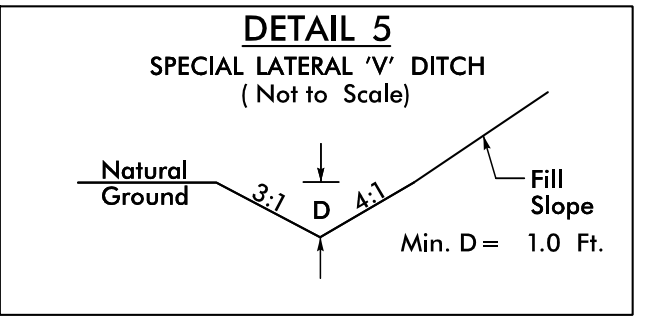
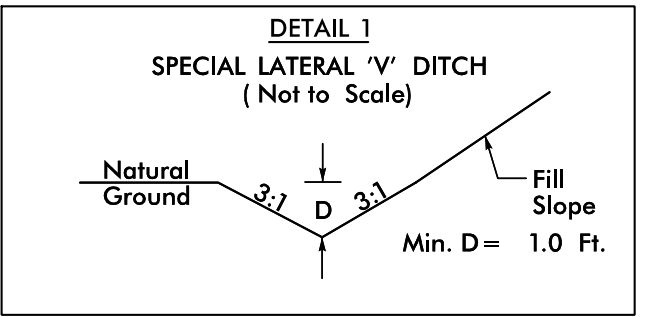

DESIGN EXCEPTION REQUESTED FOR LANE WIDTHS (11') AND USABLE SHOULDER (4' MINIMUM)
 NOTE: ALL DRIVEWAY RADII ARE 10' UNLESS OTHERWISE NOTED

FOR -L- PROFILE, SEE SHEETS 31 AND 32

15-JUN-2021 13:23
 Regdway\Pro\144906.rdj.psh14.dgn