

PROJECT REFERENCE NO. R-5709A	SHEET NO. EC-17/CONST.17
RW SHEET NO.	
ROADWAY DESIGN ENGINEER	HYDRAULICS ENGINEER

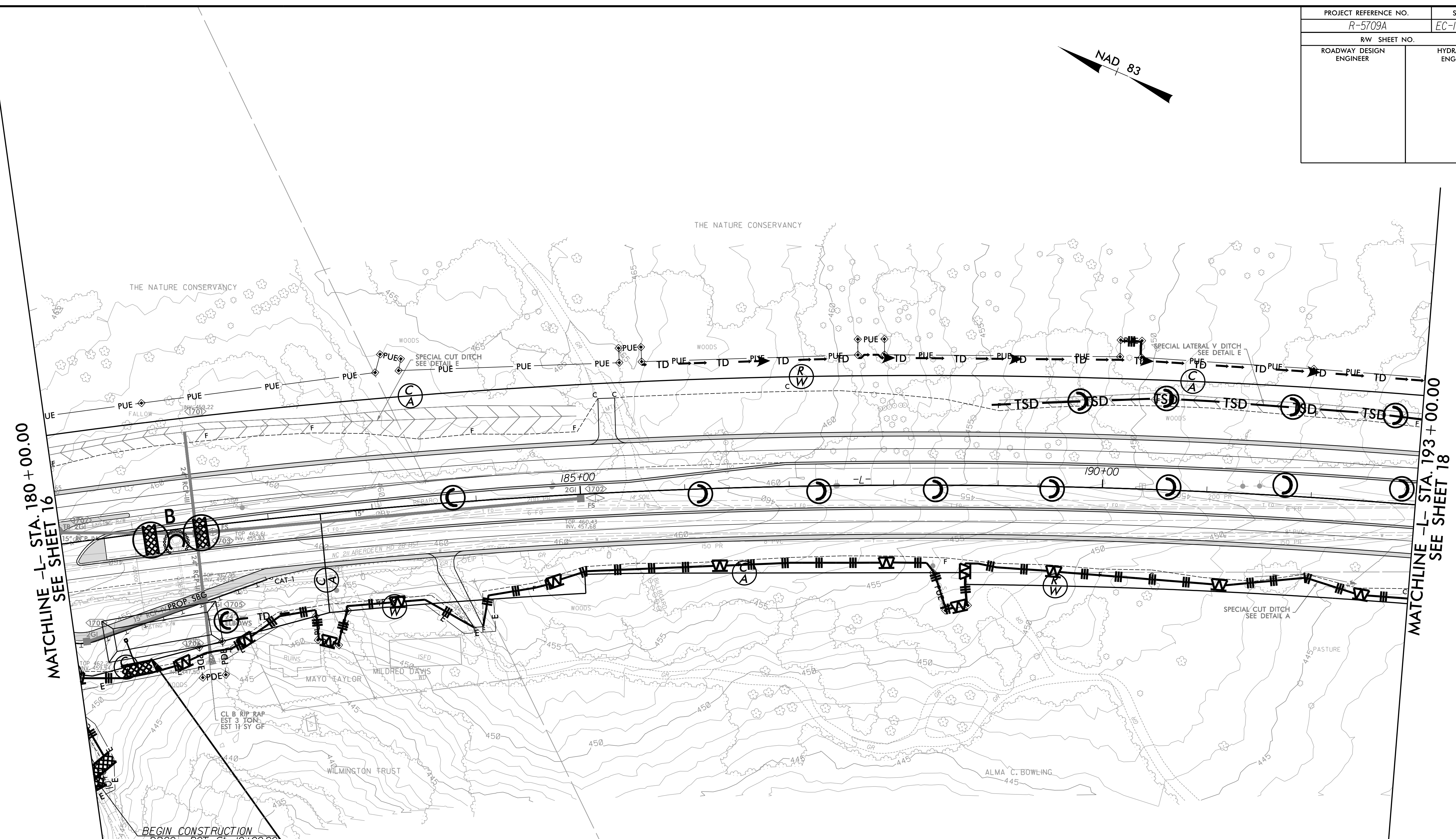
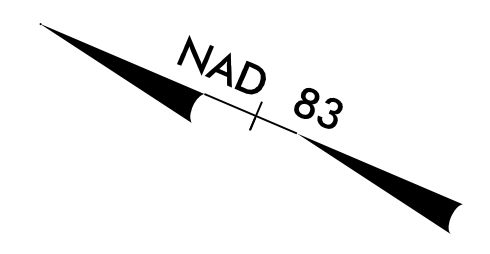

MATCHLINE -L- STA. 180 + 00.00
SEE SHEET 16

MATCHLINE -L- STA. 193 + 00.00
SEE SHEET 18

BEGIN CONSTRUCTION
-DR2C- POT Sta.10+00.00

111 x 40 x 3
2.0 inch Skimmer
with 1.875 inch
Orifice Diameter
17 ft. weir
ID 17.1

SETH JONES, EI
LEVEL III NAME

4183
LEVEL III CERTIFICATION NO.

CLEARING AND GRUBBING
EROSION CONTROL FOR
CONSTRUCTION SHEET 17

NOTE:
PLACE TEMPORARY ROCK SEDIMENT DAMS TYPE - B
AND TEMPORARY ROCK SILT CHECKS TYPE - A AT
DRAINAGE OUTLETS.

RKK
P: (919) 378-9550
8601 Six Forks Road, Forum 1, Suite 700
Raleigh, North Carolina 27615-3960
NC License No. F-0112
Engineers | Construction Managers | Planners | Scientists
www.rkk.com
Responsive People | Creative Solutions

8/17/99
7/23/2021
R:\Projects\2021\Hydraulics\CADD\PSH\EC - Early Start C&S\Section 1\R5709A_EC_ESCG_psh17.dgn