

Shoring I.D. No.	Estimated Average Height (ft.)	Quantity (sq. ft.)
③	4.0 FT.	124 SQ. FT.
④	4.0 FT.	124 SQ. FT.

SEE TMP-5 FOR -L- CROSS-SECTIONS

TEMPORARY PAVEMENT MARKING LEGEND

P1 - PAINT - WHITE EDGELINE - (4")

P4 - PAINT - WHITE MINISKIP - (4")

P13 - PAINT - YELLOW DOUBLE CENTER - (4")

P61 - PAINT - WHITE STOP BAR - (24")

REFER TO RSD NOS. 1205.01 AND 1205.02 FOR PLACEMENT OF TEMPORARY PAVEMENT MARKINGS UNLESS NOTED OTHERWISE.

MESSAGE NO. 1	MESSAGE NO. 2
ONE LANE ROAD 1 MILE	BE PREPARED TO STOP
CHANGEABLE MESSAGE SIGN	

****PLACE CMS 1 MILE IN ADVANCE OF THE PORTABLE TRAFFIC SIGNAL****

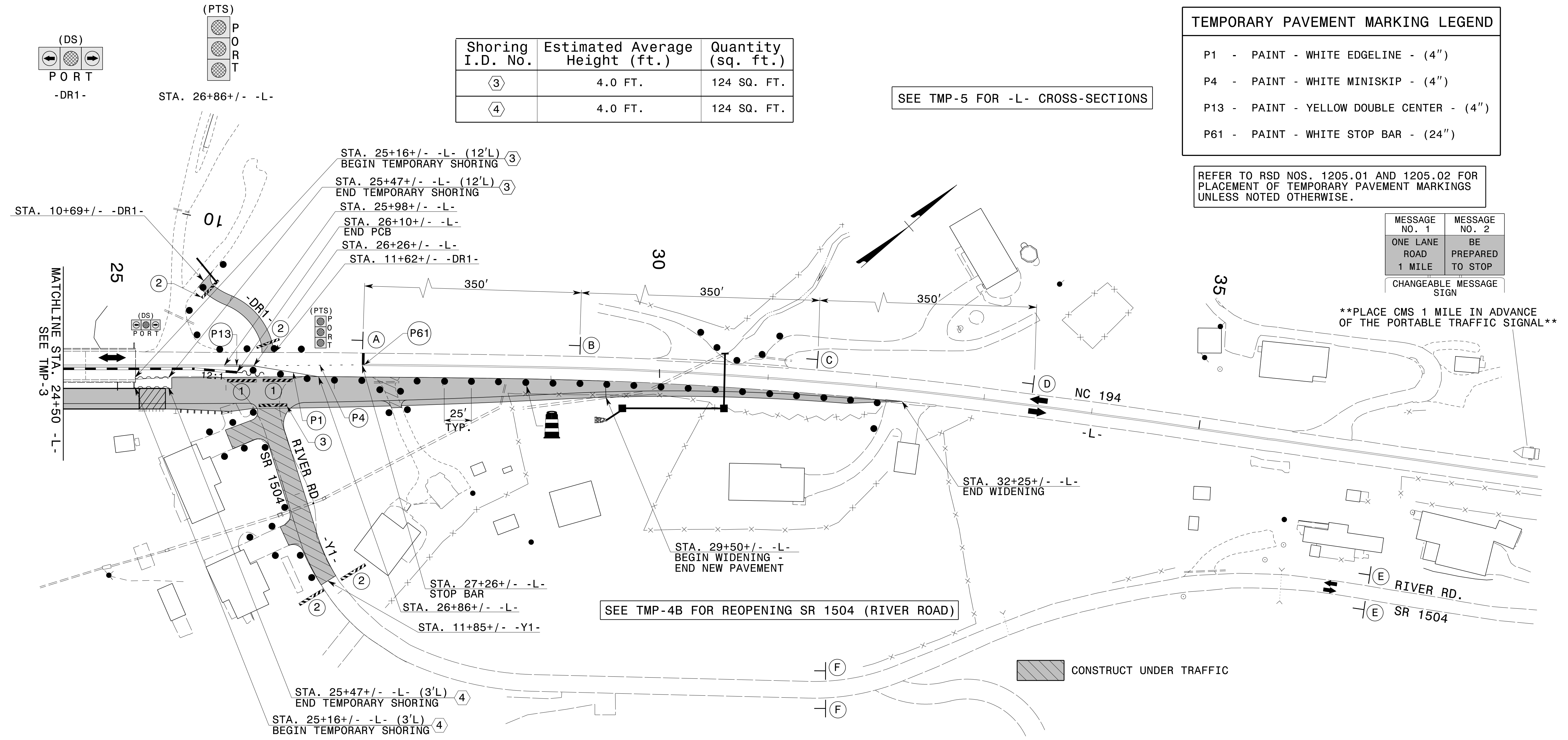

SEE TMP-4A FOR SR 1504 (RIVER ROAD) DETOUR

CONTRACTOR SHALL MAINTAIN ACCESS TO ALL DRIVEWAYS

APPROVED: *Karen Davis*
 DATE: 8/16/2021

Seal: NORTH CAROLINA PROFESSIONAL ENGINEER SEAL 046203 KAREN E. DAVIS

DOCUMENT NOT CONSIDERED FINAL UNLESS ALL SIGNATURES COMPLETED

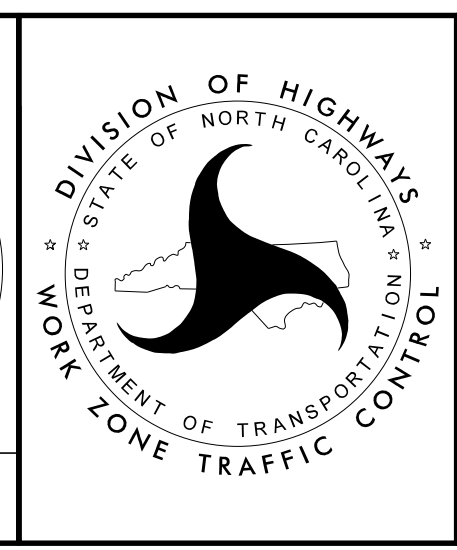

PHASE I DETAILS