

09/08/99

**TIP PROJECT: R-5020B**

STATE OF NORTH CAROLINA  
DIVISION OF HIGHWAYS

T.I.P. NO.	SHEET NO.
R-5020B	UO-1

**NOTE:**  
ALL UTILITY WORK SHOWN ON THIS SHEET IS DONE BY OTHERS.  
NO PAYMENT WILL BE MADE TO THE CONTRACTOR FOR UTILITY WORK SHOWN ON THIS SHEET.

# UTILITIES BY OTHERS PLANS COLUMBUS COUNTY

**LOCATION: US 701 BYPASS (MADISON STREET-JK POWELL BLVD.)  
FROM SR 1437 (VIRGIL AVENUE) TO US 7476**

**TYPE OF WORK: AERIAL/BURIED POWER (DISTRIBUTION),  
AERIAL/BURIED COMMUNICATION & GAS RELOCATIONS**

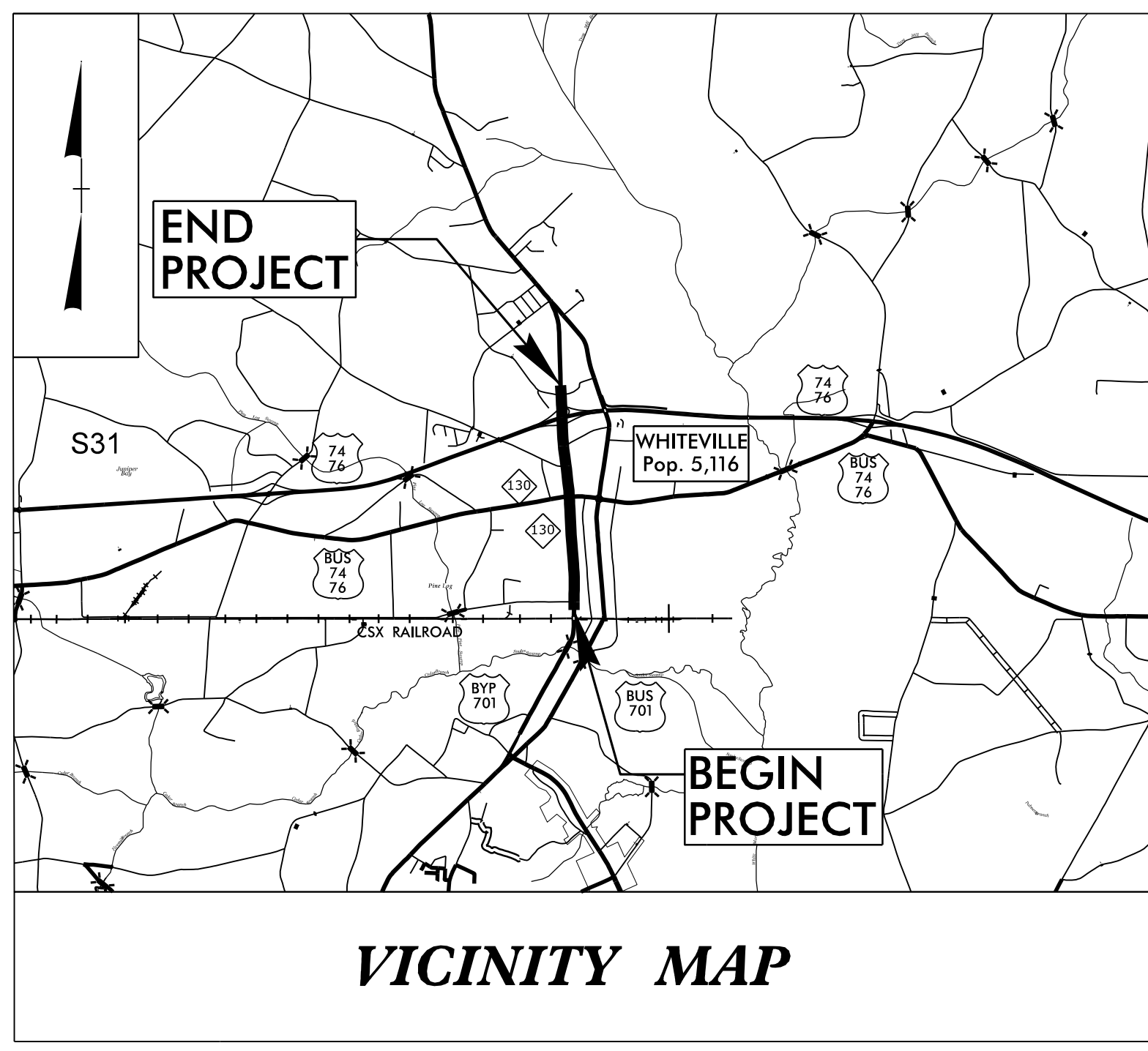

**END TIP PROJECT R-5020B  
-L- POT STA 289+75.00**

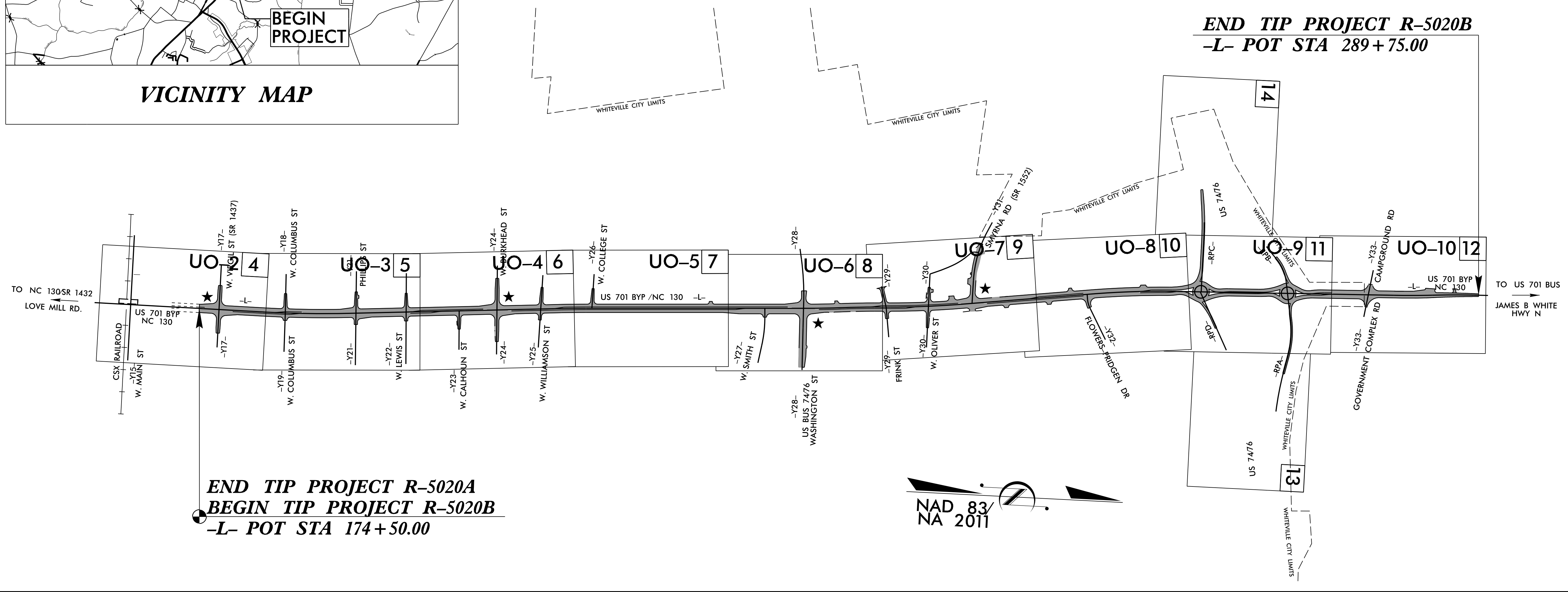

**END TIP PROJECT R-5020A  
BEGIN TIP PROJECT R-5020B  
-L- POT STA 174+50.00**

NAD 83  
NA 2011

**GRAPHIC SCALES**

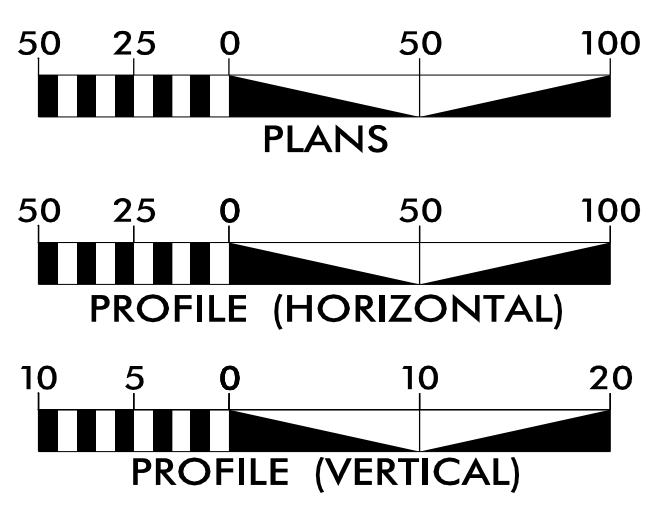

**INDEX OF SHEETS**

SHEET NO.:	DESCRIPTION:
UO-1	TITLE SHEET
UO-2 THRU UO-10	UBO PLAN SHEETS

**UTILITY OWNERS WITH CONFLICTS**

- (A) POWER (DISTRIBUTION) - DUKE ENERGY
- (B) COMMUNICATIONS - SPECTRUM
- (C) COMMUNICATIONS - CENTURYLINK
- (D) GAS - PIEDMONT NATURAL GAS
- (E) COMMUNICATIONS - MCNC

PREPARED IN THE OFFICE OF:



**JOHN FAISON** UTILITY PROJECT MANAGER  
**JOHN FAISON** PROJECT UTILITY COORDINATOR  
**DANIEL ALLEN** PROJECT UTILITY DESIGNER

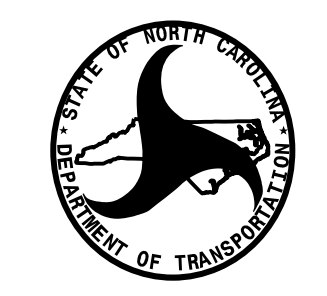

**DIVISION OF HIGHWAYS  
DIVISION 6**  
558 GILLESPIE ST.  
FAYETTEVILLE, NC 28301

**RANDY ROGERS** DIV. UTILITY COORDINATOR  
**RICK HANDLIN** DIV. UTILITY ENGINEER  
**STEVEN KENDALL, P.E.** PROJECT ENGINEER

11-JUN-2020 08:21  
M:\2016\22161889\_NCDOT R-5020B\Utilities\290\_00L\_R5020B\_ut\_tsh\_U001\_psh.dgn  
\$\$\$\$\$SERVNAME\$\$\$\$\$

### UTILITIES BY OTHERS

**NOTE:**  
 ALL UTILITY WORK SHOWN ON THIS SHEET IS DONE BY OTHERS.  
 NO PAYMENT WILL BE MADE TO THE CONTRACTOR FOR UTILITY WORK SHOWN ON THIS SHEET.

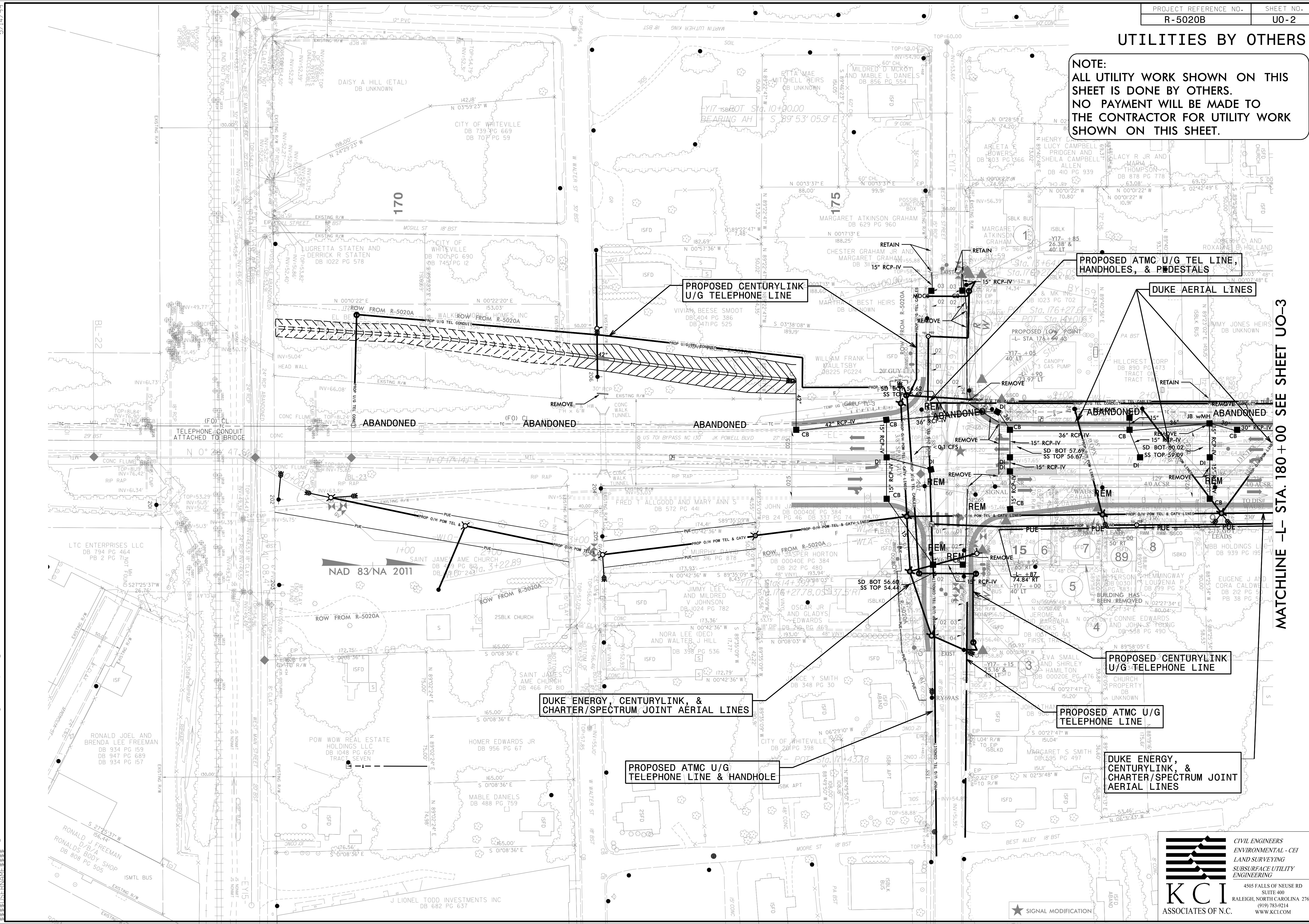

MATCHLINE -L- STA. 180+00 SEE SHEET U0-3

PROPOSED AT&T U/G TEL LINE, HANDHOLES, & PDESTALS

DUKE AERIAL LINES

PROPOSED CENTURYLINK U/G TELEPHONE LINE

ABANDONED

ABANDONED

ABANDONED

ABANDONED

ABANDONED

DUKE ENERGY, CENTURYLINK, & CHARTER/SPECTRUM JOINT AERIAL LINES

PROPOSED AT&T U/G TELEPHONE LINE & HANDHOLE

PROPOSED CENTURYLINK U/G TELEPHONE LINE

PROPOSED AT&T U/G TELEPHONE LINE

DUKE ENERGY, CENTURYLINK, & CHARTER/SPECTRUM JOINT AERIAL LINES

**KCI**  
 ASSOCIATES OF N.C.

CIVIL ENGINEERS  
 ENVIRONMENTAL - CEI  
 LAND SURVEYING  
 SUBSURFACE UTILITY  
 ENGINEERING

4505 FALLS OF NEUSE RD  
 SUITE 400  
 RALEIGH, NORTH CAROLINA 27609  
 (919) 783-9214  
 WWW.KCI.COM

5/14/2014 4:49 PM  
 T:\R-5020B\150-200\Utilities\230-002-R5020B.ut\_rdy4\_U002\_esh.dgn  
 150-200-002-R5020B.ut\_rdy4\_U002\_esh.dgn  
 150-200-002-R5020B.ut\_rdy4\_U002\_esh.dgn



### UTILITIES BY OTHERS

**NOTE:**  
 ALL UTILITY WORK SHOWN ON THIS SHEET IS DONE BY OTHERS.  
 NO PAYMENT WILL BE MADE TO THE CONTRACTOR FOR UTILITY WORK SHOWN ON THIS SHEET.

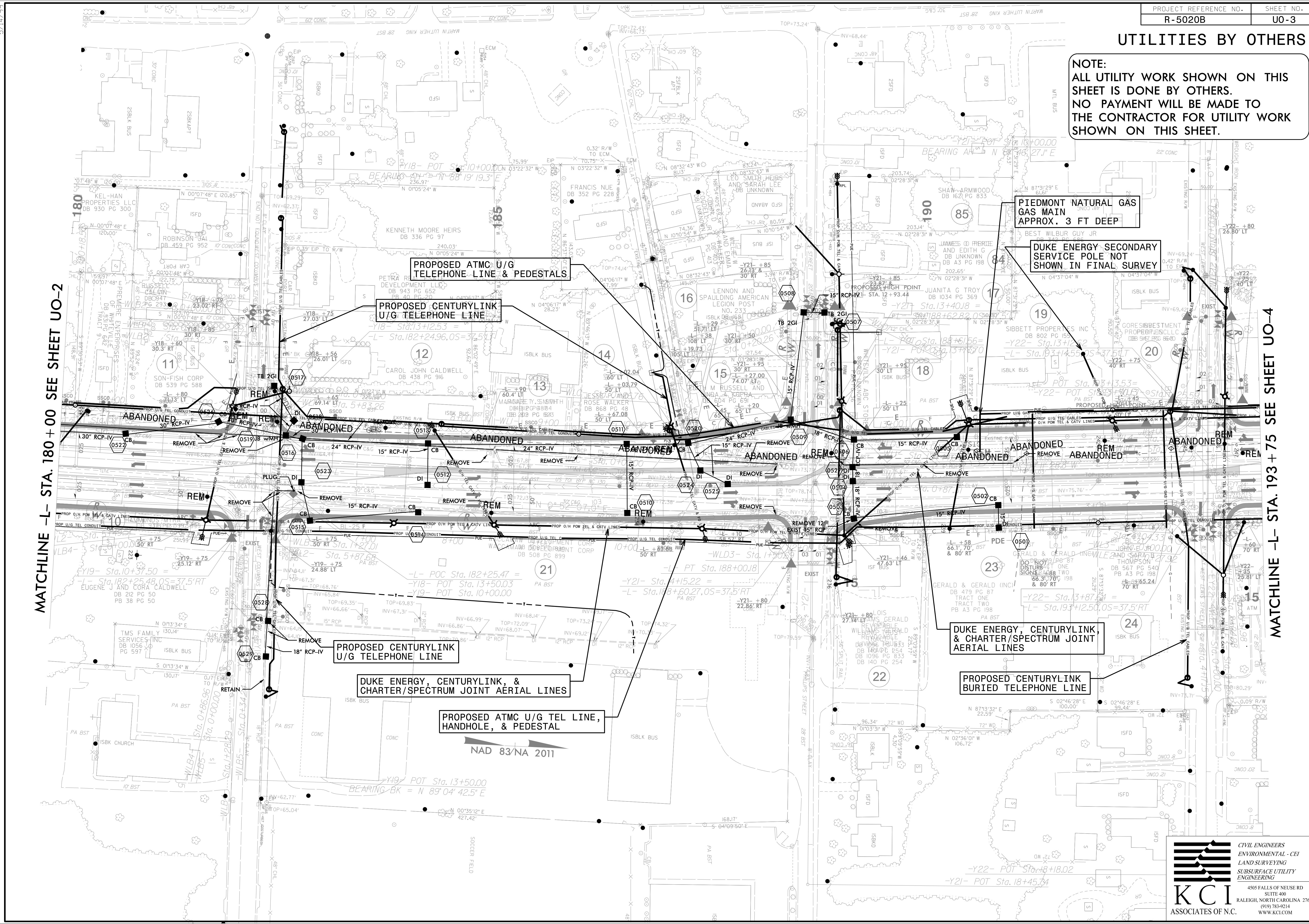



### UTILITIES BY OTHERS

**NOTE:**  
 ALL UTILITY WORK SHOWN ON THIS SHEET IS DONE BY OTHERS.  
 NO PAYMENT WILL BE MADE TO THE CONTRACTOR FOR UTILITY WORK SHOWN ON THIS SHEET.

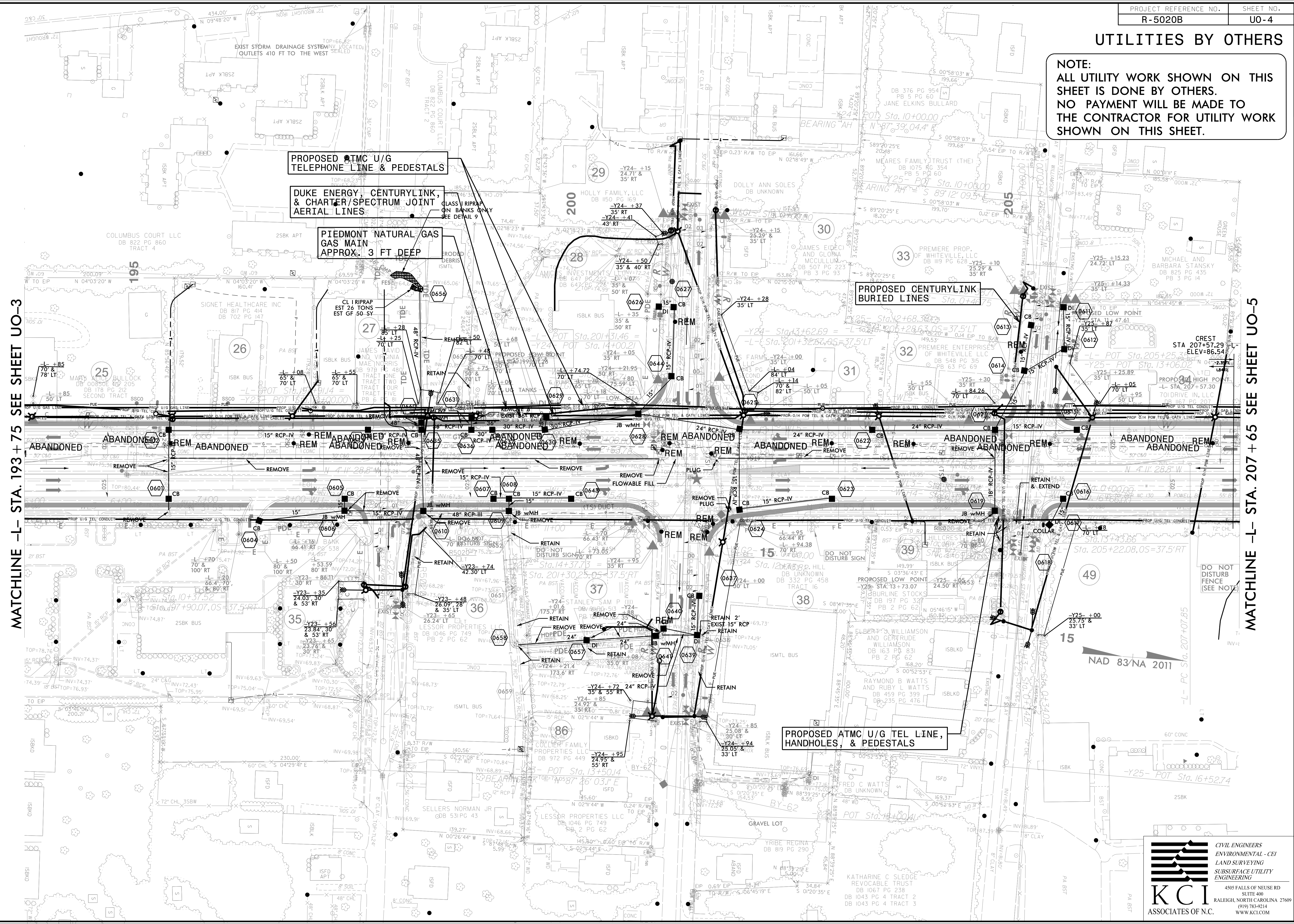

MATCHLINE -L- STA. 193 + 75 SEE SHEET UO-3

MATCHLINE -L- STA. 207 + 65 SEE SHEET UO-5

NAD 83/NA 2011

5/14/09  
 R-5020B.dwg  
 20110502  
 R-5020B.dwg  
 Utilities  
 230\_004\_R5020B.ut\_rdy6\_U004\_psh.dgn



### UTILITIES BY OTHERS

**NOTE:**  
 ALL UTILITY WORK SHOWN ON THIS SHEET IS DONE BY OTHERS.  
 NO PAYMENT WILL BE MADE TO THE CONTRACTOR FOR UTILITY WORK SHOWN ON THIS SHEET.

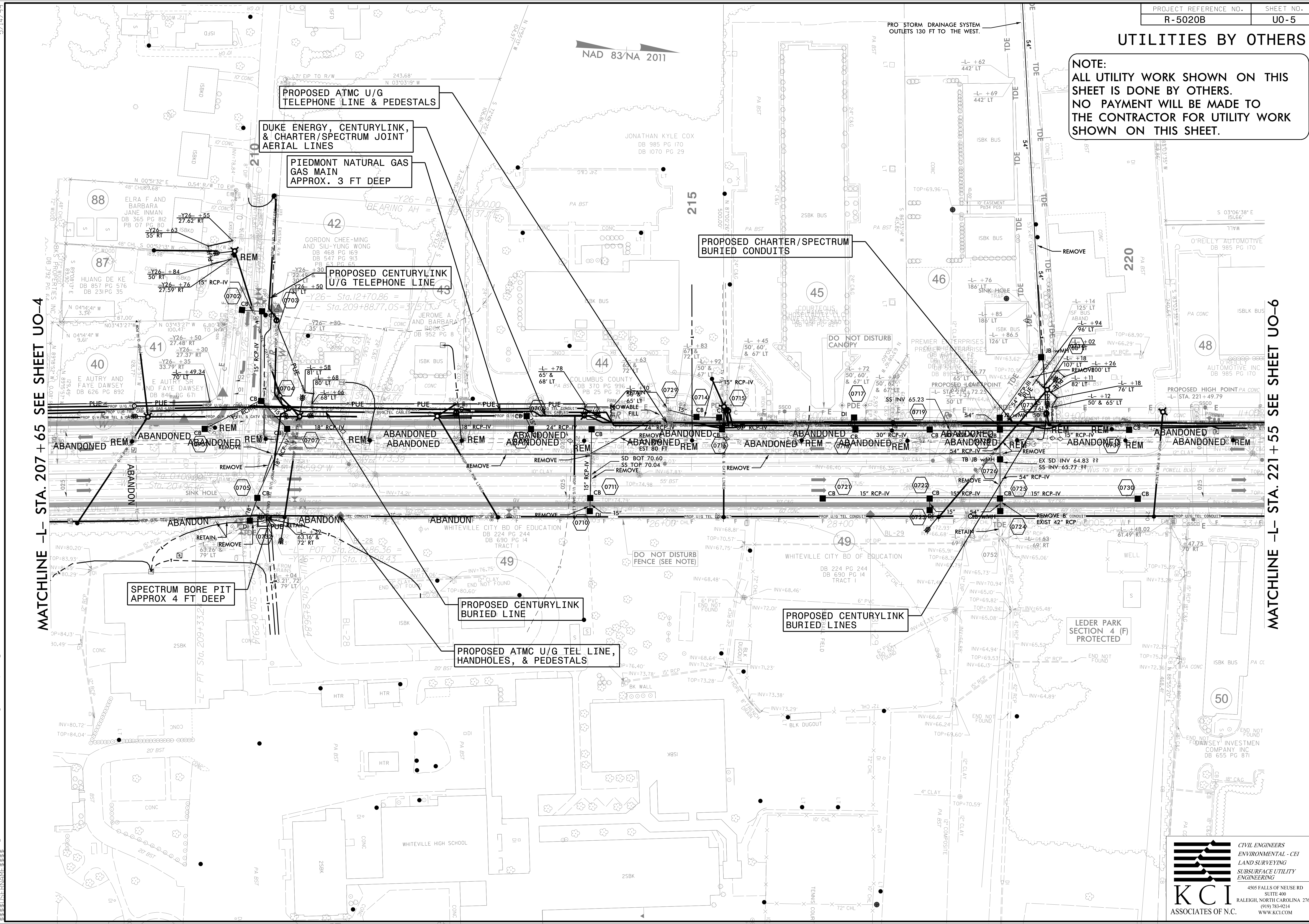

MATCHLINE -L- STA. 207 + 65 SEE SHEET UO-4

MATCHLINE -L- STA. 221 + 55 SEE SHEET UO-6

NAD 83/NA 2011

15-MAR-2010 10:26 T:\R-5020B\Drawings\Utilities\230-005-R5020B.ut\_r.dwg 7\_U005\_psh.dgn







### UTILITIES BY OTHERS

**NOTE:**  
 ALL UTILITY WORK SHOWN ON THIS SHEET IS DONE BY OTHERS.  
 NO PAYMENT WILL BE MADE TO THE CONTRACTOR FOR UTILITY WORK SHOWN ON THIS SHEET.

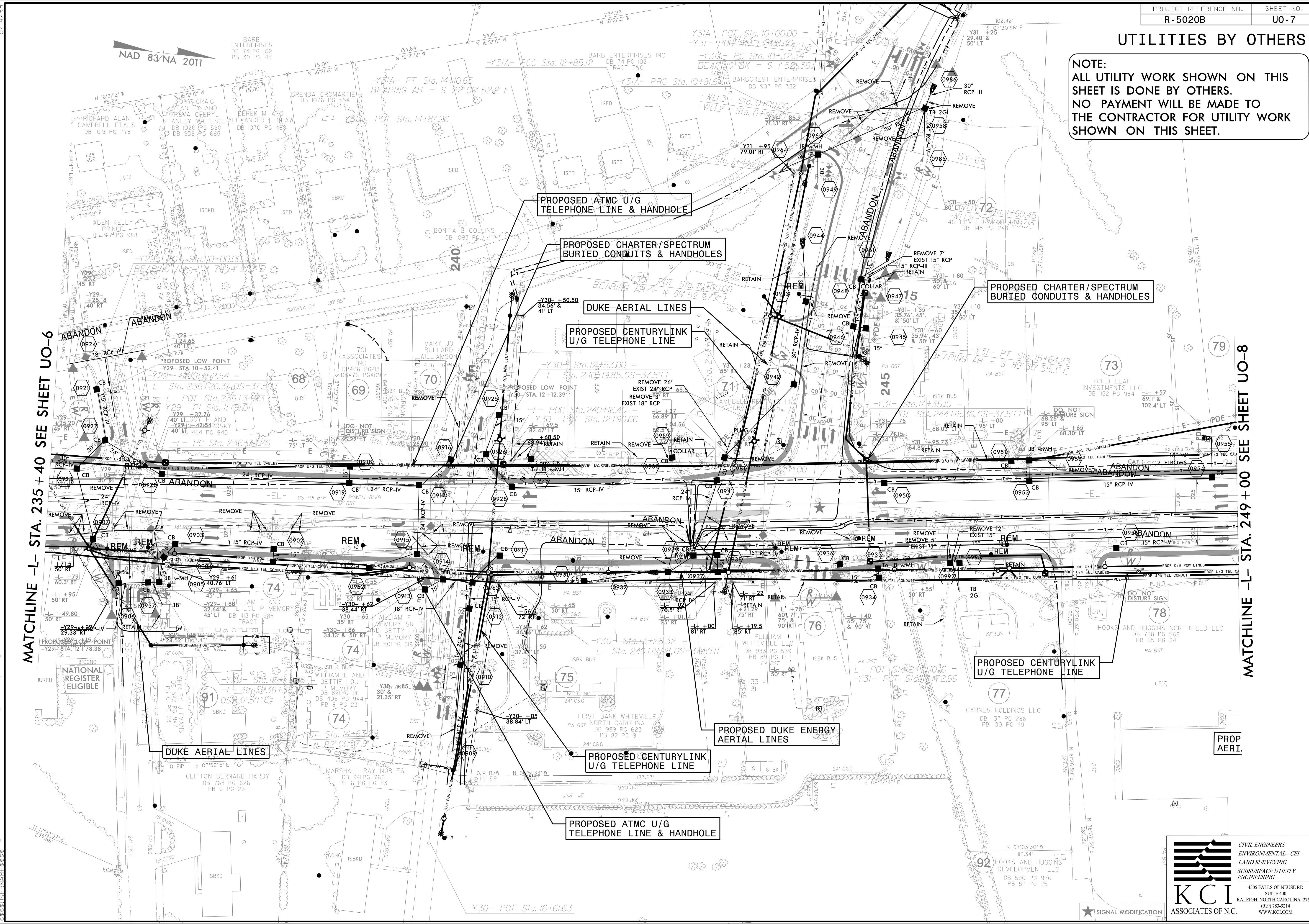

MATCHLINE -L- STA. 235 + 40 SEE SHEET UO-6

MATCHLINE -L- STA. 249 + 00 SEE SHEET UO-8

15-MAR-2010 10:38 R-5020B.dwg Utilities\230-007-R5020B.ut\_rdy9\_U007\_esh.dgn

**KCI**  
 ASSOCIATES OF N.C.

CIVIL ENGINEERS  
 ENVIRONMENTAL - CEI  
 LAND SURVEYING  
 SUBSURFACE UTILITY  
 ENGINEERING

4505 FALLS OF NEUSE RD  
 SUITE 400  
 RALEIGH, NORTH CAROLINA 27609  
 919 783-9214  
 WWW.KCI.COM

★ SIGNAL MODIFICATION











