

# INTERSECTION DETAIL 6

## -L- AND -Y28- (US7476 BUS./WASHINGTON ST.)

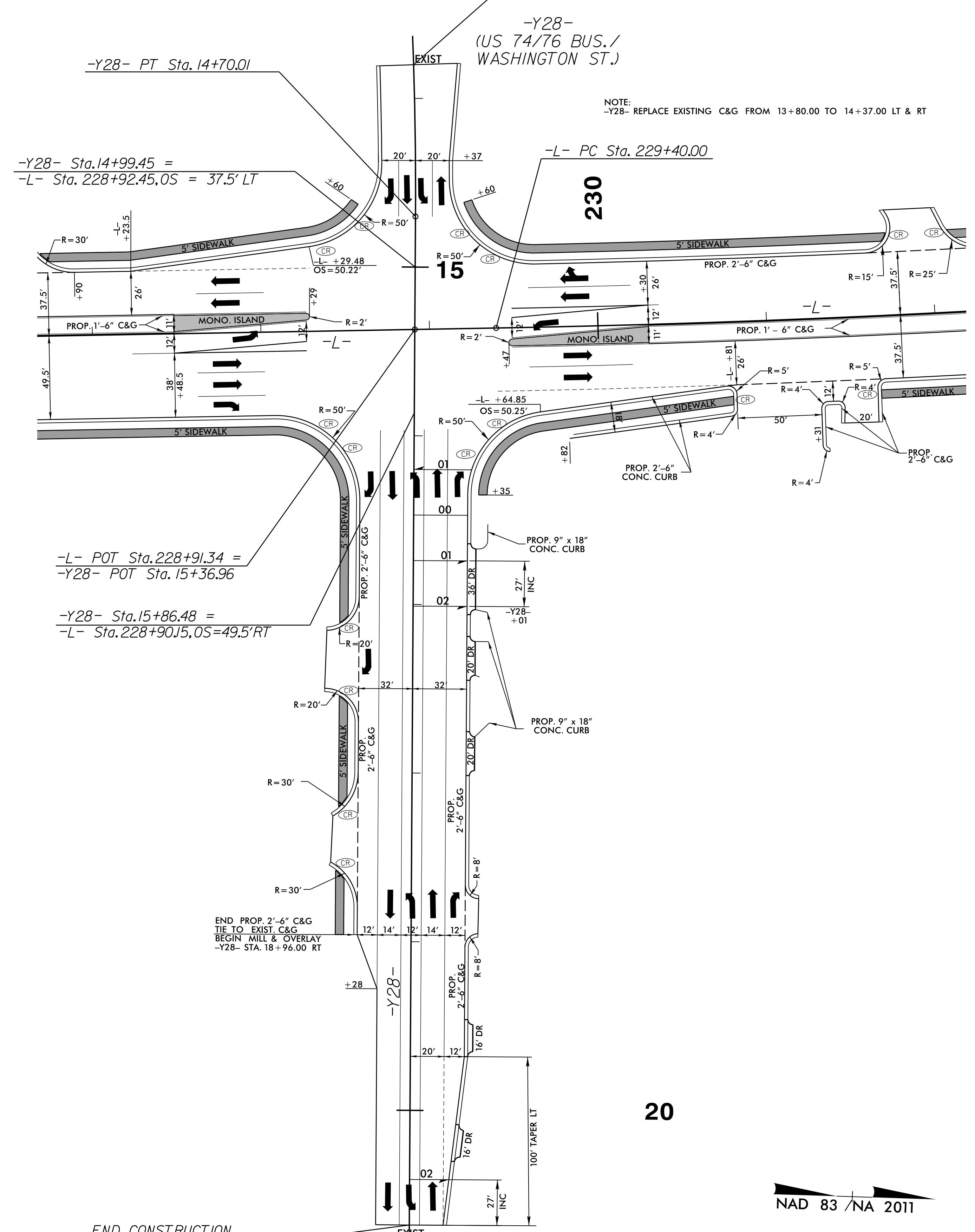

END CONSTRUCTION  
 -Y28- POT Sta. 20+68.00  
 -Y28- POT Sta. 20+93.11  
 BEARING BK = N 88° 29' 03.9" E

END PROP. 2'-6" C&G  
 TIE TO EXIST. C&G  
 BEGIN MILL & OVERLAY  
 -Y28- STA. 18+96.00 RT

NOTE:  
 -Y28- REPLACE EXISTING C&G FROM 13+80.00 TO 14+37.00 LT & RT

SEE PLAN SHEET 8



# INTERSECTION DETAIL 7

## -L- AND -Y29- (FRINK ST.)

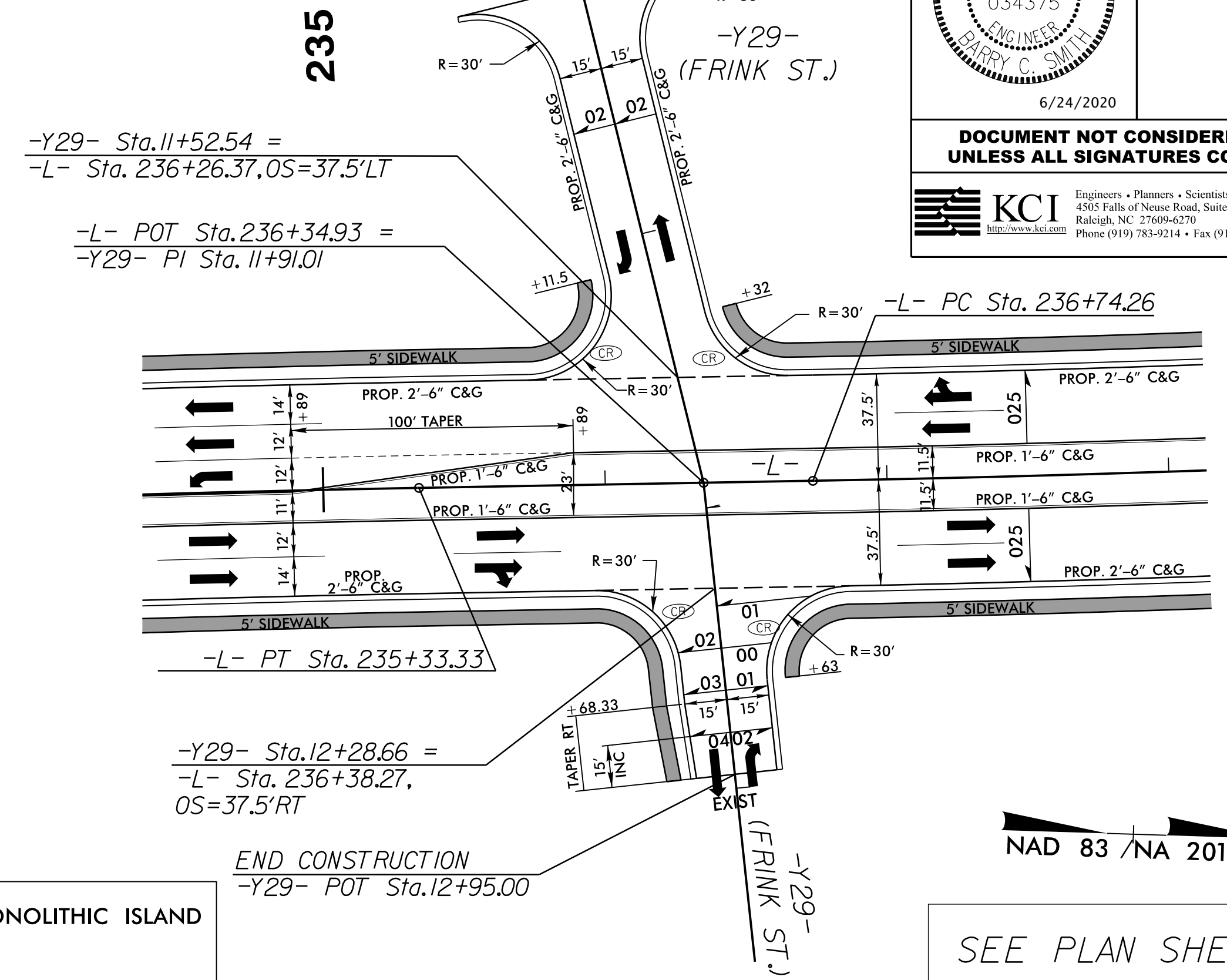

END CONSTRUCTION  
 -Y29- POT Sta. 12+95.00

SEE PLAN SHEET 9



# INTERSECTION DETAIL 8

## -L- AND -Y30- (OLIVER ST.)

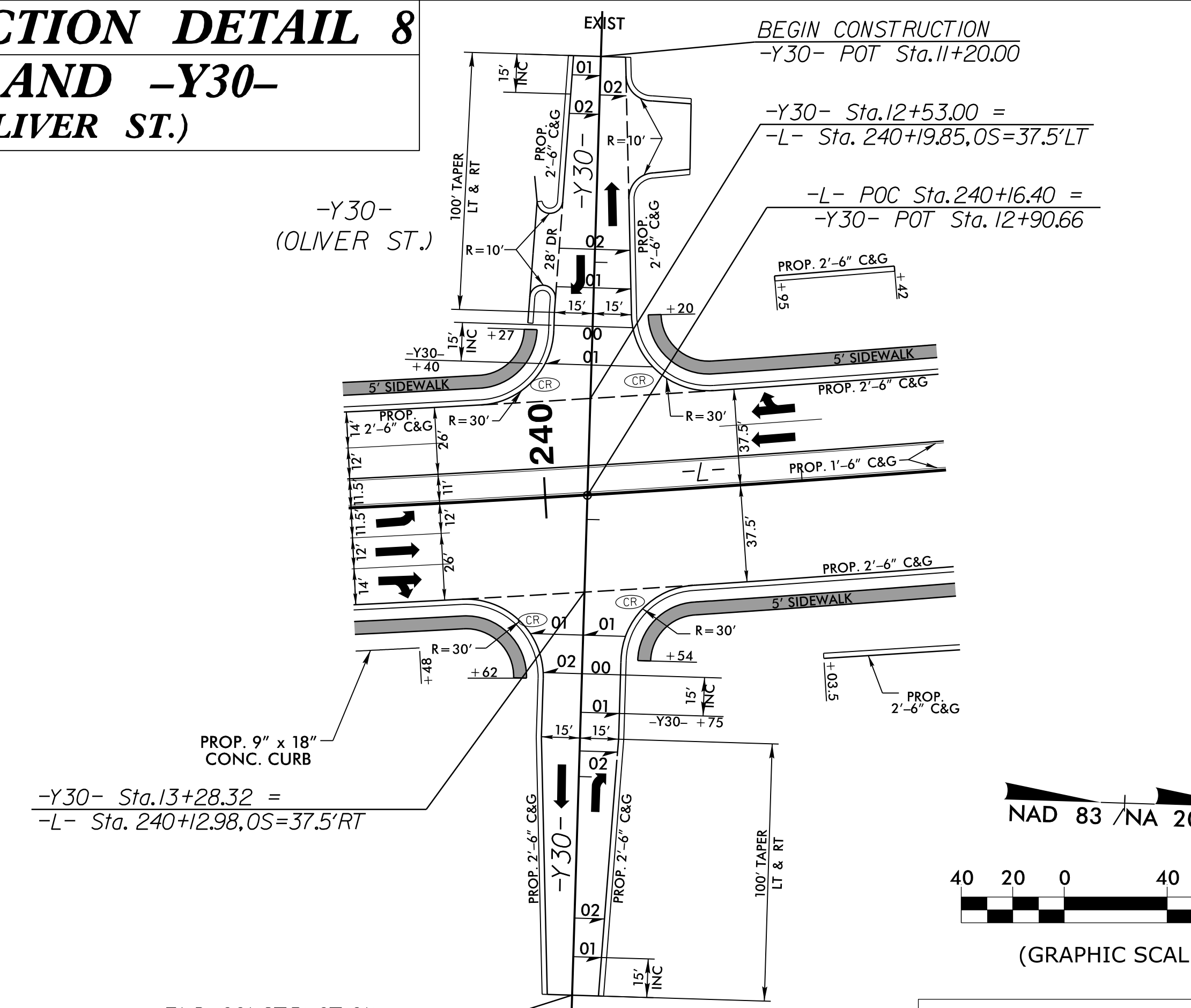

END CONSTRUCTION  
 -Y30- POT Sta. 14+85.00

SEE PLAN SHEET 9

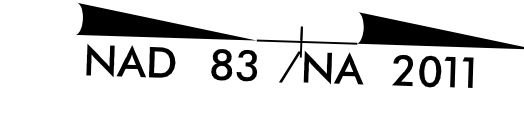

(GRAPHIC SCALE)

PROJECT REFERENCE NO. R-5020B	SHEET NO. 2B-5
ROADWAY DESIGN ENGINEER 	
DATE 6/24/2020	
DOCUMENT NOT CONSIDERED FINAL UNLESS ALL SIGNATURES COMPLETED	
KCI <small>Engineers • Planners • Scientists • Construction Managers          4505 Falls of Neuse Road, Suite 400          Raleigh, NC 27609-6270          Phone (919) 783-0214 • Fax (919) 783-9266</small>	

6/24/2020 10:36 AM  
 K:\2016\2020\5020B\5020B\Roadway\Pro\5020B\_Rdy.dtl\Intersections.dgn  
 701 Widening\Roadway\Pro\5020B\_Rdy.dtl\Intersections.dgn  
 6/24/2020 10:36 AM  
 K:\2016\2020\5020B\5020B\Roadway\Pro\5020B\_Rdy.dtl\Intersections.dgn