

STATE OF NORTH CAROLINA
DIVISION OF HIGHWAYS

TRANSPORTATION MANAGEMENT PLAN

WILSON COUNTY

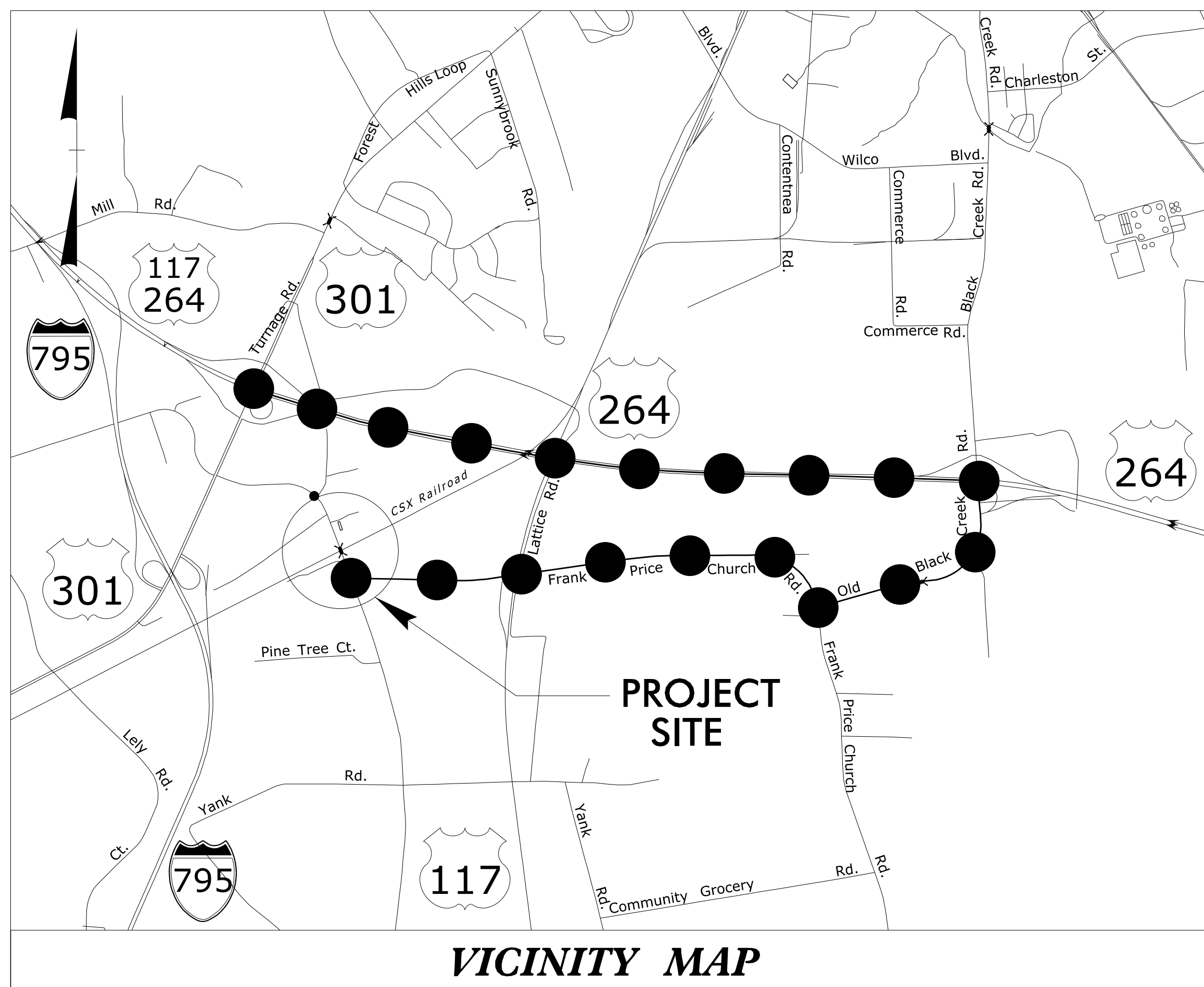
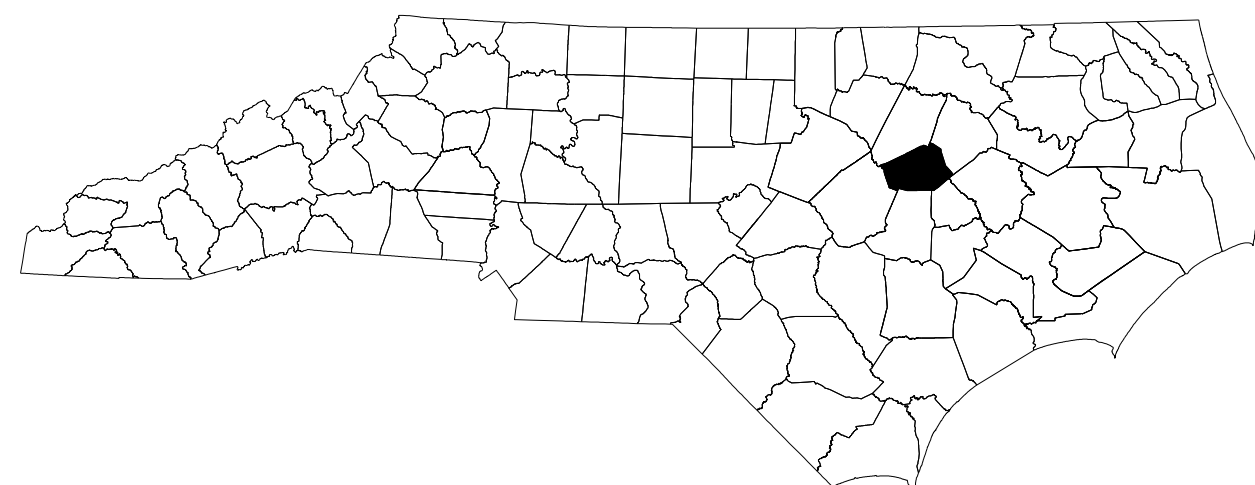

**LOCATION: BRIDGE NO. 47 OVER
SCL RAILROAD ON US 117**

● — ● — ● OFFSITE DETOUR ROUTE

INDEX OF SHEETS	
SHEET NO.	TITLE
TMP-1	TITLE SHEET, VICINITY MAP, AND INDEX OF SHEETS
TMP-1A	LIST OF APPLICABLE ROADWAY STANDARD DRAWINGS AND LEGEND
TMP-1B	TRANSPORTATION OPERATIONS PLAN: (MANAGEMENT STRATEGIES, GENERAL NOTES, LOCAL NOTES, AND TEMPORARY TRAFFIC CONTROL PHASING)
TMP-2	NO SHEET
TMP-3	OFFSITE DETOUR

SHEET NO.
TMP-1

3/7/9/2020 Ms:\2018\251801945\22 B-5666\TrafficControl\TCP\B5666_TC_TMP_01.dgn User:bryan.hough

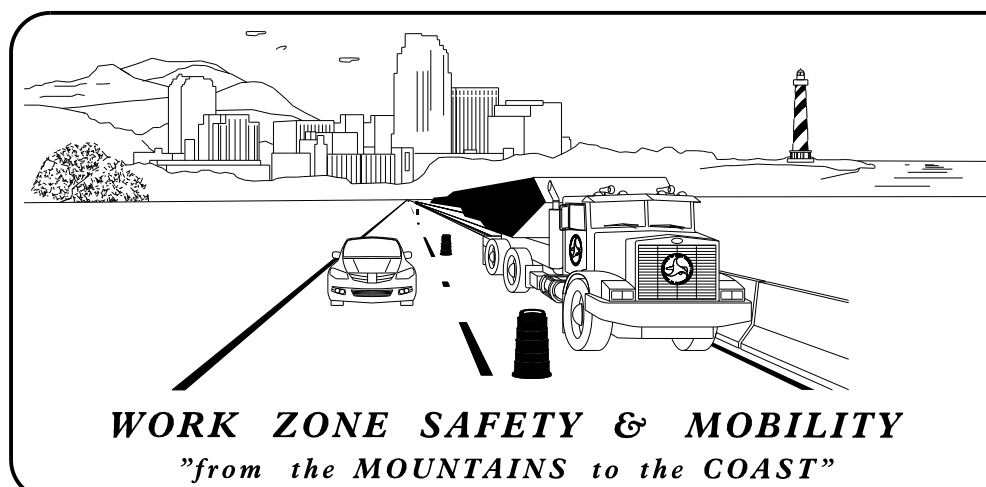

N.C.D.O.T. WORK ZONE TRAFFIC CONTROL
1561 MAIL SERVICE CENTER (MSC) RALEIGH, NC 27699-1561
750 N. GREENFIELD PARKWAY, GARNER, NC 27529 (DELIVERY)
PHONE: (919) 773-2800 FAX: (919) 771-2745

J.E. HUMMER, PHD, PE STATE TRAFFIC MANAGEMENT ENGINEER
STEVE KITE, P.E. TRAFFIC CONTROL PROJECT ENGINEER
SPENCER JENNINGS TRAFFIC CONTROL PROJECT DESIGN ENGINEER
WILLIAM DEBREW TRAFFIC CONTROL DESIGN ENGINEER

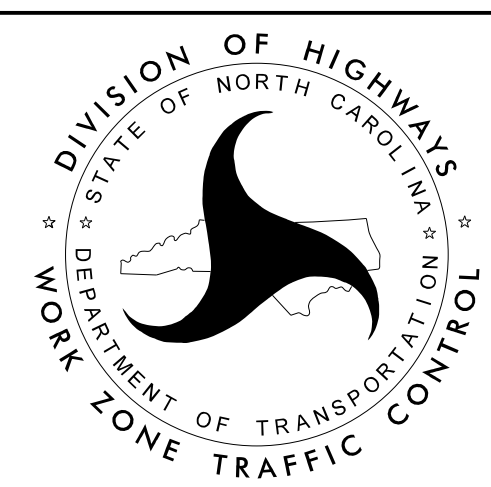

KCI ASSOCIATES OF N.C.
CIVIL ENGINEERS
ENVIRONMENTAL - CEI
LAND SURVEYING
SUBSURFACE UTILITY ENGINEERING
4505 FALLS OF NEUSE ROAD
SUITE 400
RALEIGH, NORTH CAROLINA 27609
(919) 783-9214
WWW.KCI.COM

DOCUMENT NOT CONSIDERED FINAL
UNLESS ALL SIGNATURES COMPLETED

APPROVED: _____
DATE: 5/7/2020

SEAL

TIP PROJECT: B-5666

ROADWAY STANDARD DRAWINGS

THE FOLLOWING ROADWAY STANDARDS AS SHOWN IN "ROADWAY STANDARD DRAWINGS" - PROJECT SERVICES UNIT - N.C. DEPARTMENT OF TRANSPORTATION - RALEIGH, N.C., DATED JANUARY 2018 ARE APPLICABLE TO THIS PROJECT AND BY REFERENCE HEREBY ARE CONSIDERED A PART OF THESE PLANS:

STD. NO.	TITLE
1101.01	WORK ZONE ADVANCE WARNING SIGNS
1101.02	TEMPORARY LANE CLOSURES
1101.03	TEMPORARY ROAD CLOSURES
1101.04	TEMPORARY SHOULDER CLOSURES
1101.05	WORK ZONE VEHICLE ACCESSES
1101.11	TRAFFIC CONTROL DESIGN TABLES
1110.01	STATIONARY WORK ZONE SIGNS
1110.02	PORTABLE WORK ZONE SIGNS
1115.01	FLASHING ARROW BOARDS
1130.01	DRUM
1135.01	CONES
1145.01	BARRICADES
1150.01	FLAGGING DEVICES
1160.01	TEMPORARY CRASH CUSHION
1165.01	WORK VEHICLE LIGHTING SYSTEMS AND TMA DELINEATION
1170.01	POSITIVE PROTECTION
1180.01	SKINNY-DRUM
1205.01	PAVEMENT MARKINGS - LINE TYPES AND OFFSETS
1205.02	PAVEMENT MARKINGS - TWO-LANE AND MULTI-LANE ROADWAYS
1205.04	PAVEMENT MARKINGS - INTERSECTIONS
1205.05	PAVEMENT MARKINGS - TURN LANES
1205.08	PAVEMENT MARKINGS - SYMBOLS AND WORD MESSAGES
1205.12	PAVEMENT MARKINGS - BRIDGES
1250.01	RAISED PAVEMENT MARKERS - INSTALLATION SPACING
1251.01	RAISED PAVEMENT MARKERS - PERMANENT AND TEMPORARY
1261.01	GUARDRAIL AND BARRIER DELINEATORS - INSTALLATION SPACING
1261.02	GUARDRAIL AND BARRIER DELINEATORS - TYPES AND MOUNTING
1262.01	GUARDRAIL END DELINEATION
1264.01	OBJECT MARKERS - TYPES
1264.02	OBJECT MARKERS - INSTALLATION

LEGEND

GENERAL

- DIRECTION OF TRAFFIC FLOW
- EXIST. PVMT.
- NORTH ARROW
- PROPOSED PVMT.

WORK AREA

REMOVAL

PAVEMENT MARKINGS

- EXISTING LINES
- TEMPORARY LINES

TRAFFIC CONTROL DEVICES

- BARRICADE (TYPE III)
- DRUM
- FLAGGER
- CHANGEABLE MESSAGE SIGN

TEMPORARY SIGNING

- PORTABLE SIGN
- STATIONARY SIGN
- STATIONARY OR PORTABLE SIGN

PAVEMENT MARKERS

- CRYSTAL/CRYSTAL
- CRYSTAL/RED
- YELLOW/YELLOW

PAVEMENT MARKING SYMBOLS

- PAVEMENT MARKING SYMBOLS

25-MAR-2021 10:22 AM \\2018\251801945_22 B-5666\Traffic\TrafficControl\TCP\B5666_TC_TMP_01A.dgn \$\$\$USERNAME\$\$\$

KCI
 Engineers • Planners • Scientists • Construction Managers
 4265 Falls of Neuse Road, Suite 400
 Raleigh, NC 27609-4270
 Phone (919) 783-9214 • Fax (919) 783-9266

APPROVED: _____
 DATE: 3/25/2021
 SEAL

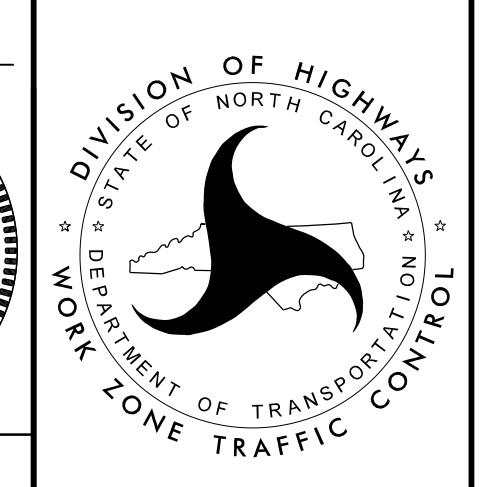
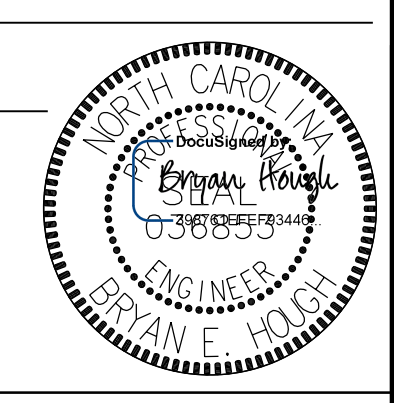

ROADWAY STANDARD
 DRAWINGS & LEGEND

**DOCUMENT NOT CONSIDERED FINAL
UNLESS ALL SIGNATURES COMPLETED**

MANAGEMENT STRATEGIES

1. CLOSE NC 117 AND DETOUR TRAFFIC OFF-SITE VIA FRANK PRICE CHURCH RD, BLACK CREEK RD, NC 264, AND NC 301. LOCAL ACCESS TO ALL RESIDENCES AND BUSINESSES WILL BE MAINTAINED BETWEEN CLOSURE POINTS AT ALL TIMES DURING CONSTRUCTION.

LOCAL NOTES

1. NOTIFY WILSON COUNTY EMERGENCY SERVICES (252)237-0789 AND THE COUNTY SCHOOLS (252)399-7700 AT LEAST ONE MONTH PRIOR TO ROAD CONSTRUCTION. COORDINATE WITH SEABOARD COAST LINE RAILROAD TO MINIMIZE POTENTIAL IMPACTS ON RAILROAD OPERATIONS BEFORE AND DURING THE CONSTRUCTION PROCESS

GENERAL NOTES

CHANGES MAY BE REQUIRED WHEN PHYSICAL DIMENSIONS IN THE DETAIL DRAWINGS, STANDARD DETAILS, AND ROADWAY DETAILS ARE NOT ATTAINABLE TO MEET FIELD CONDITIONS OR RESULT IN DUPLICATE OR UNDESIRED OVERLAPPING OF DEVICES. MODIFICATION MAY INCLUDE: MOVING, SUPPLEMENTING, COVERING, OR REMOVAL OF DEVICES AS DIRECTED BY THE ENGINEER.

THE FOLLOWING GENERAL NOTES APPLY AT ALL TIMES FOR THE DURATION OF THE CONSTRUCTION PROJECT EXCEPT WHEN OTHERWISE NOTED IN THE PLAN OR DIRECTED BY THE ENGINEER.

TRAFFIC PATTERN ALTERATIONS

- A) NOTIFY THE ENGINEER THIRTY (30) CALENDAR DAYS PRIOR TO ANY TRAFFIC PATTERN ALTERATION.

SIGNING

- B) PROVIDE SIGNING AND DEVICES REQUIRED TO CLOSE THE ROAD ACCORDING TO THE ROADWAY STANDARD DRAWINGS AND TRAFFIC MANAGEMENT PLANS.

PROVIDE SIGNING REQUIRED FOR THE OFF-SITE DETOUR ROUTE AS SHOWN IN THE TRAFFIC MANAGEMENT PLANS.

- C) COVER OR REMOVE ALL SIGNS AND DEVICES REQUIRED TO CLOSE THE ROAD WHEN ROAD CLOSURE IS NOT IN OPERATION.

COVER OR REMOVE ALL SIGNS REQUIRED FOR THE OFF-SITE DETOUR WHEN THE DETOUR IS NOT IN OPERATION.

- D) ENSURE ALL NECESSARY SIGNING IS IN PLACE PRIOR TO ALTERING ANY TRAFFIC PATTERN.

TRAFFIC CONTROL DEVICES

- E) PLACE TYPE III BARRICADES WITH "ROAD CLOSED" SIGN R11-2 ATTACHED OF SUFFICIENT LENGTH TO CLOSE ENTIRE ROADWAY.

PAVEMENT MARKINGS AND MARKERS

- F) INSTALL PAVEMENT MARKINGS AND PAVEMENT MARKERS ON THE FINAL SURFACE AS SHOWN IN THE FINAL PAVEMENT MARKING PLAN.

- G) TIE PROPOSED PAVEMENT MARKING LINES TO EXISTING PAVEMENT MARKING LINES.

PHASING

- STEP 1) PLACE CHANGEABLE MESSAGE SIGNS (CMS) 7 DAYS PRIOR TO ROAD CLOSURE.
- STEP 2) USING ROADWAY STD. DRAWING 1101.03, SHEET 1 OF 9, CLOSE US 117 AND DETOUR TRAFFIC OFF-SITE AS SHOWN ON TMP-3.
- STEP 3) REMOVE THE EXISTING STRUCTURE.
- STEP 4) CONSTRUCT THE PROPOSED STRUCTURE AND ROADWAY -L- UP TO BUT NOT INCLUDING THE FINAL LIFT OF SURFACE COURSE.
- STEP 5) PLACE THE FINAL LIFT OF SURFACE COURSE.
- STEP 6) PLACE FINAL PAVEMENT MARKINGS AND MARKERS ACCORDING TO THE FINAL PAVEMENT MARKING PLANS.
- STEP 7) REMOVE ALL WORK ZONE TRAFFIC CONTROL DEVICES AND SIGNING. OPEN US 117 AND PLACE TRAFFIC ONTO THE FINAL PATTERN.

25-MAR-2021 10:21
 M:\2018\251801945\22 B-5666\Traffic\TrafficControl\TCP\B5666_TC_TMP_01B.dgn
 \$\$\$USERNAME\$\$\$

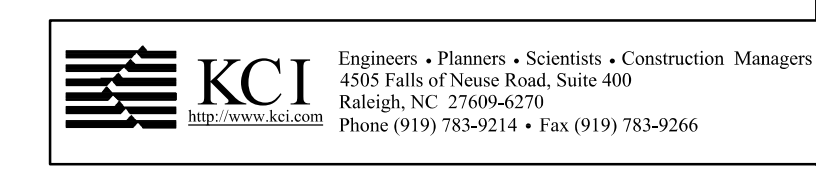

APPROVED: _____
 DATE: 3/25/2021
 SEAL

**DOCUMENT NOT CONSIDERED FINAL
UNLESS ALL SIGNATURES COMPLETED**

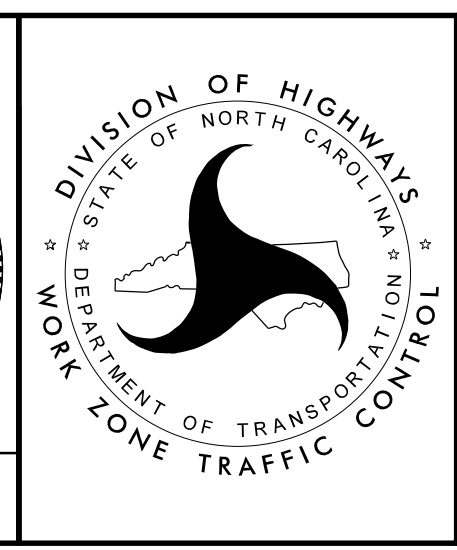

**TRANSPORTATION
OPERATIONS
PLAN**

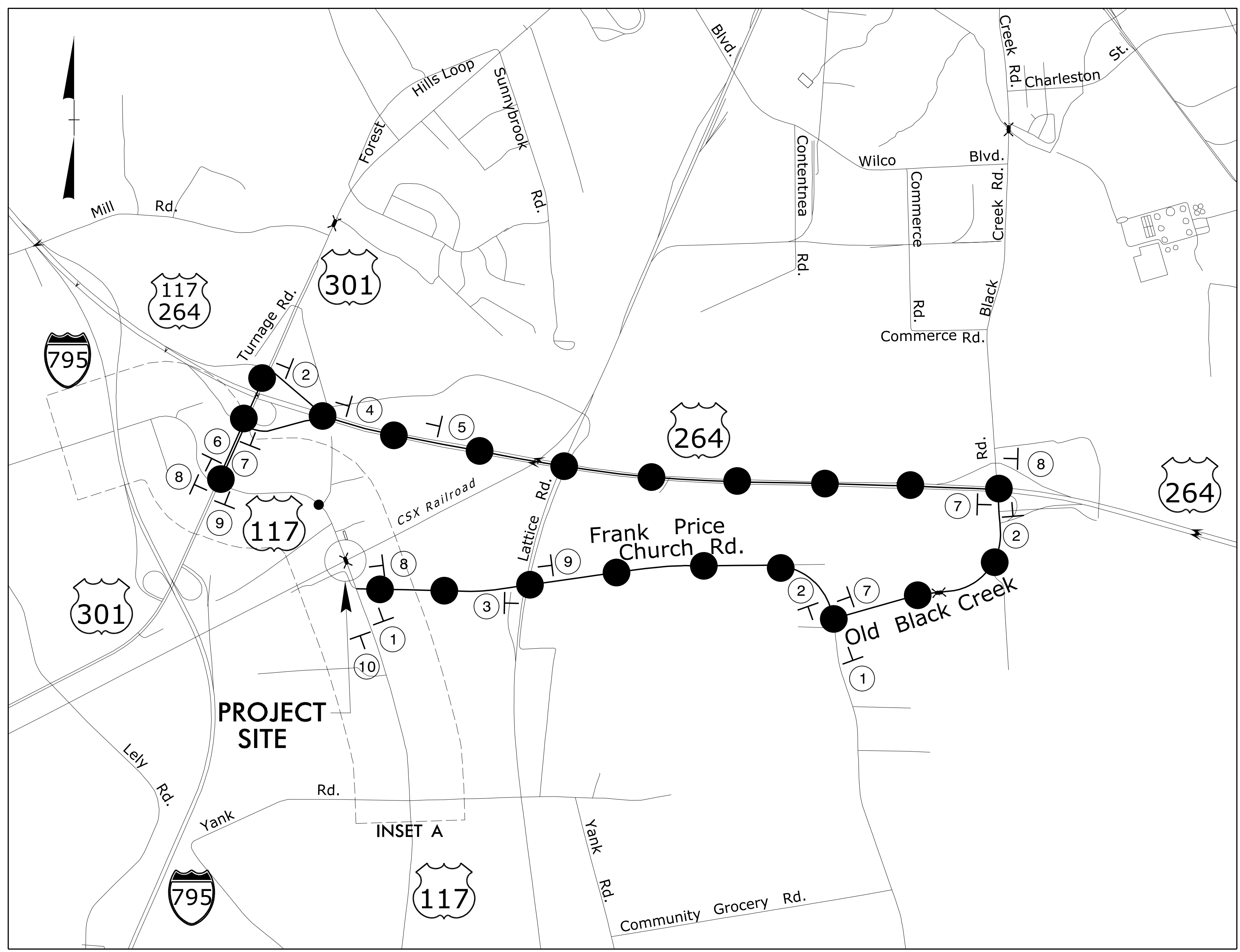

DETOUR ROUTE

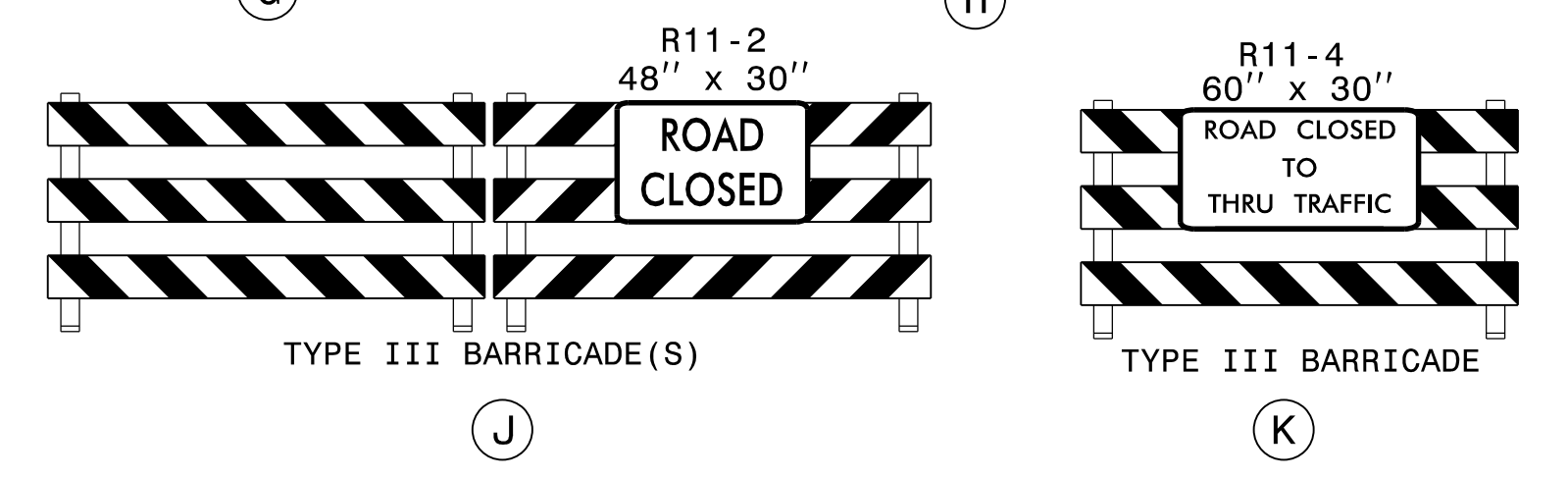
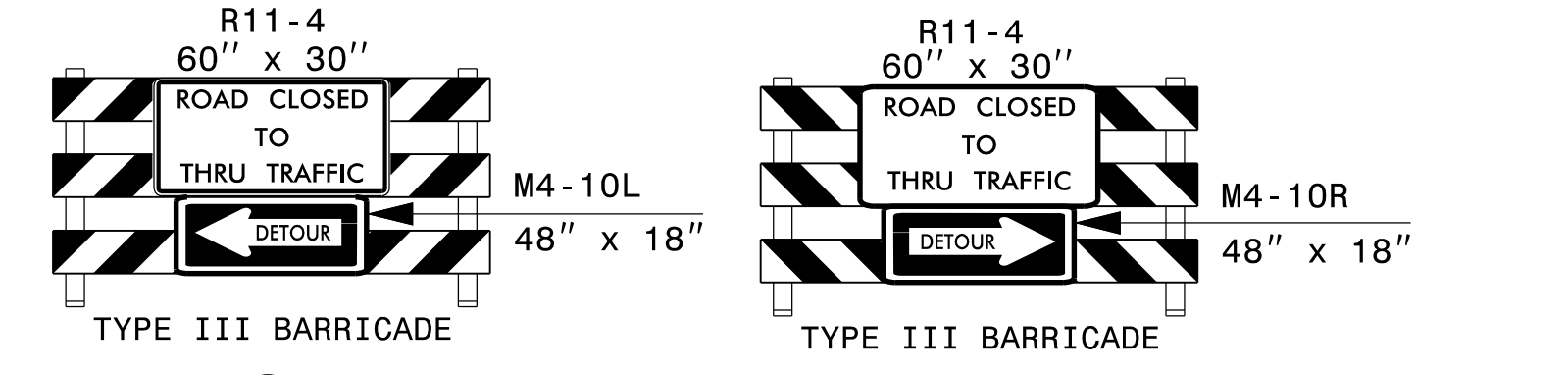
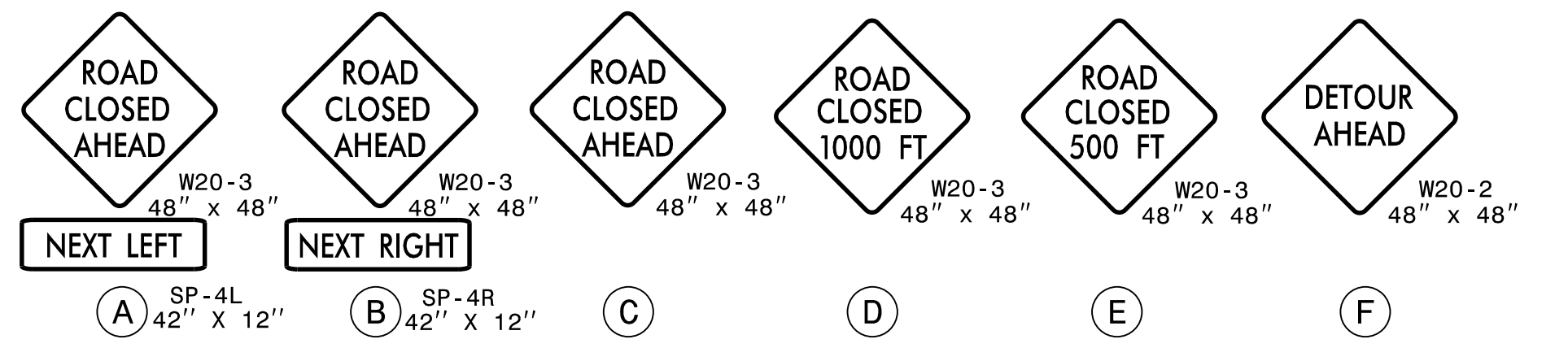
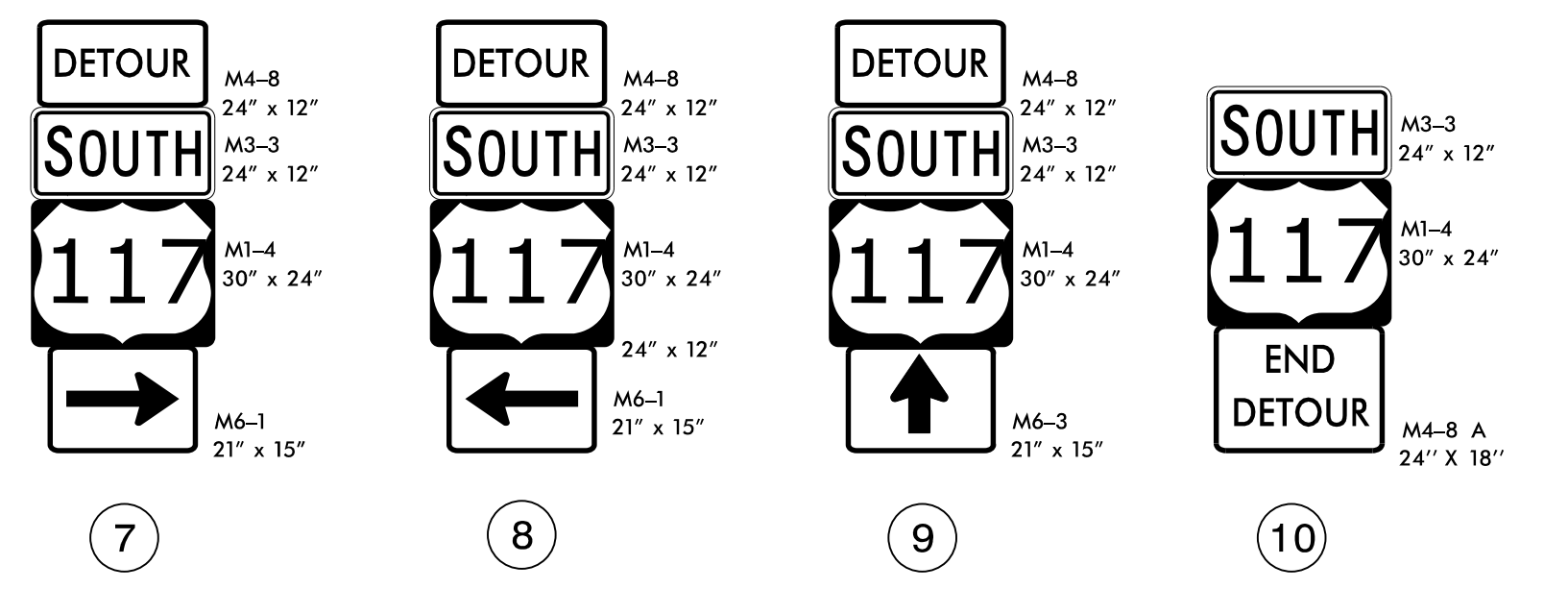
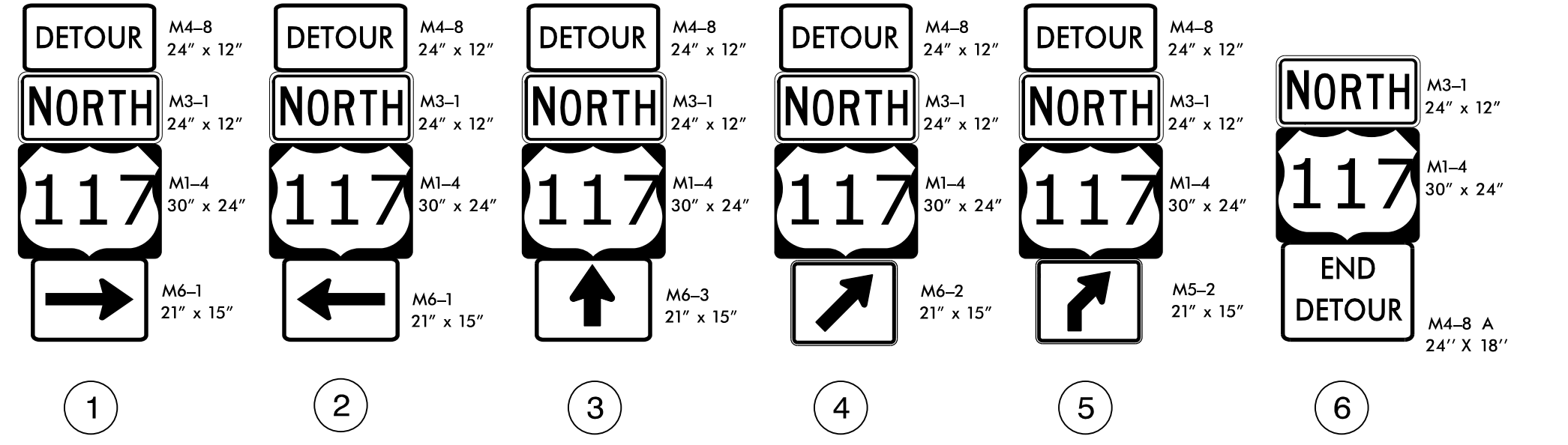

INSET A

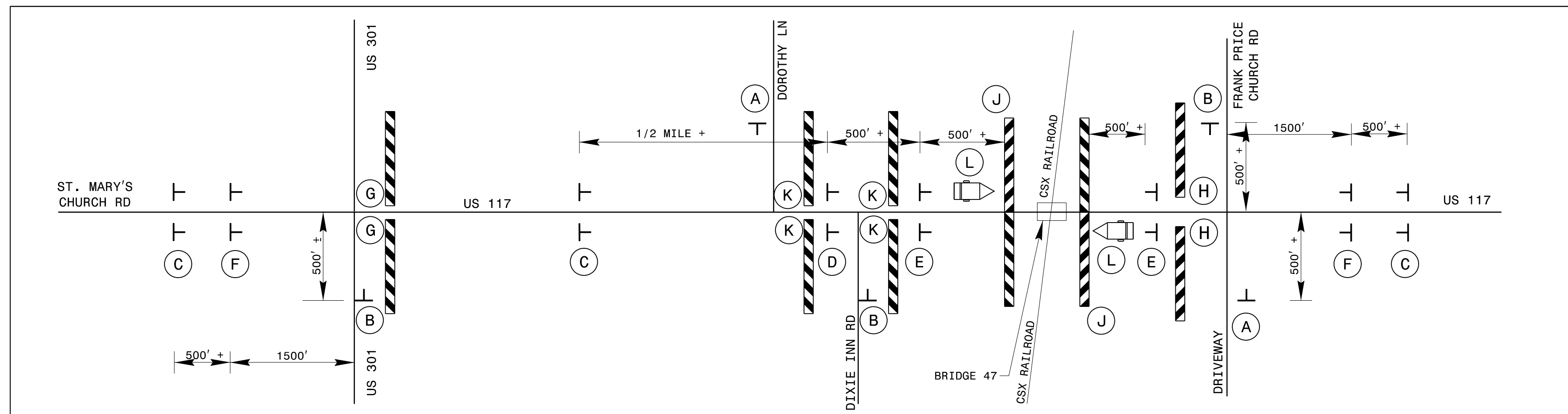

NOTES:
 1. REFER TO ROADWAY STANDARD DRAWING 1101.03, SHEET 1 OF 9 FOR APPLICABLE NOTES.
 2. ALL SIGN SPACING DIMENSIONS ARE APPROXIMATE. FIELD ADJUST AS NECESSARY OR AS DIRECTED BY THE ENGINEER.
 3. ALL DETOUR SIGN LOCATIONS ARE APPROXIMATE.

MESSAGE NO. 1	MESSAGE NO. 2
BRIDGE CLOSED XX/XX/XX	FOLLOW POSTED DETOUR
CHANGEABLE MESSAGE SIGN	

KCI Engineers • Planners • Scientists • Construction Managers
 4505 Falls of Neuse Road, Suite 400
 Raleigh, NC 27609-6270
 Phone (919) 783-9214 • Fax (919) 783-9266

APPROVED: _____
 DATE: 3/25/2021
 SEAL

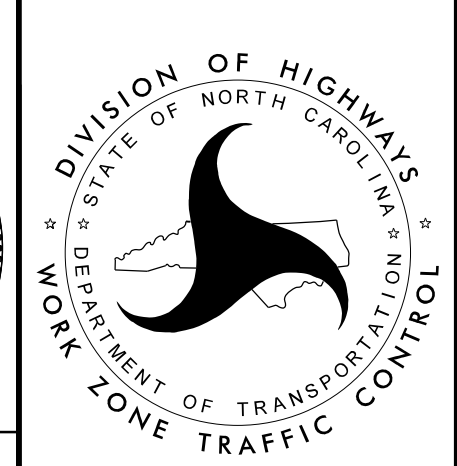
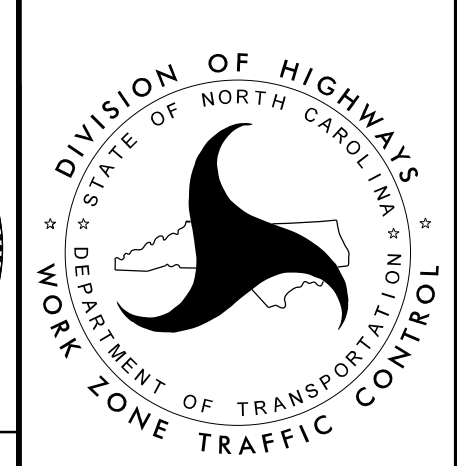

OFFSITE DETOUR ROUTE

DOCUMENT NOT CONSIDERED FINAL UNLESS ALL SIGNATURES COMPLETED

25-MAR-2021 10:28
 M:\2018\251801945\22 B-5666\TrafficControl\TCP\B5666_TC_TMP_03.dgn
 \$\$\$USERNAME\$\$\$