

DETOUR ROUTE

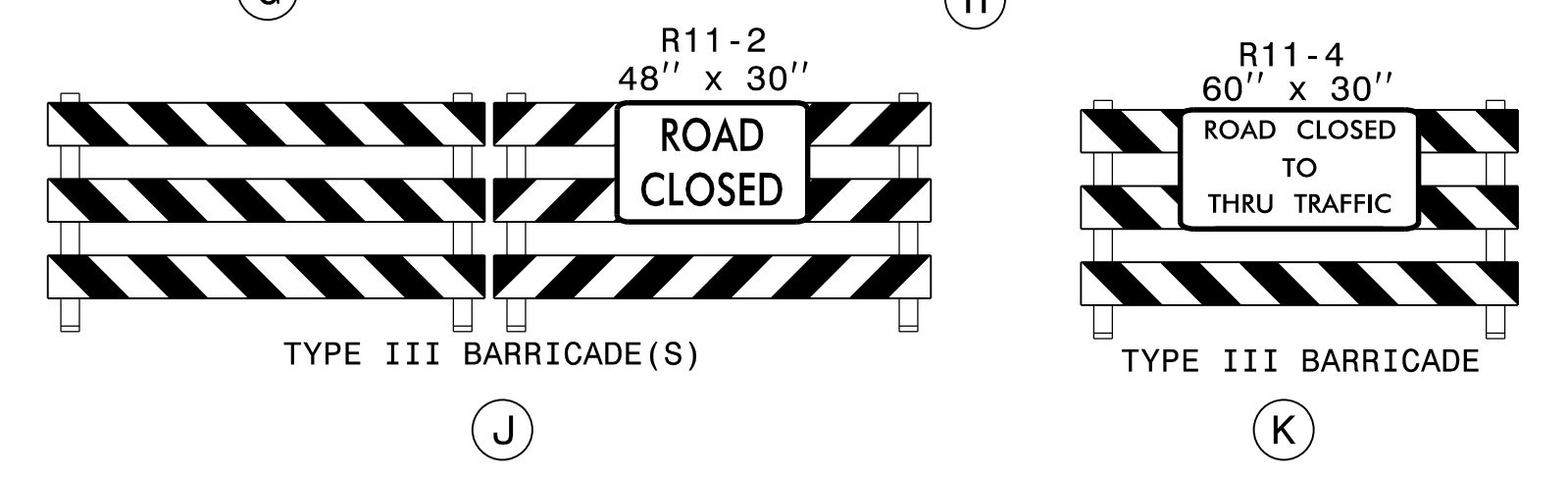

INSET A

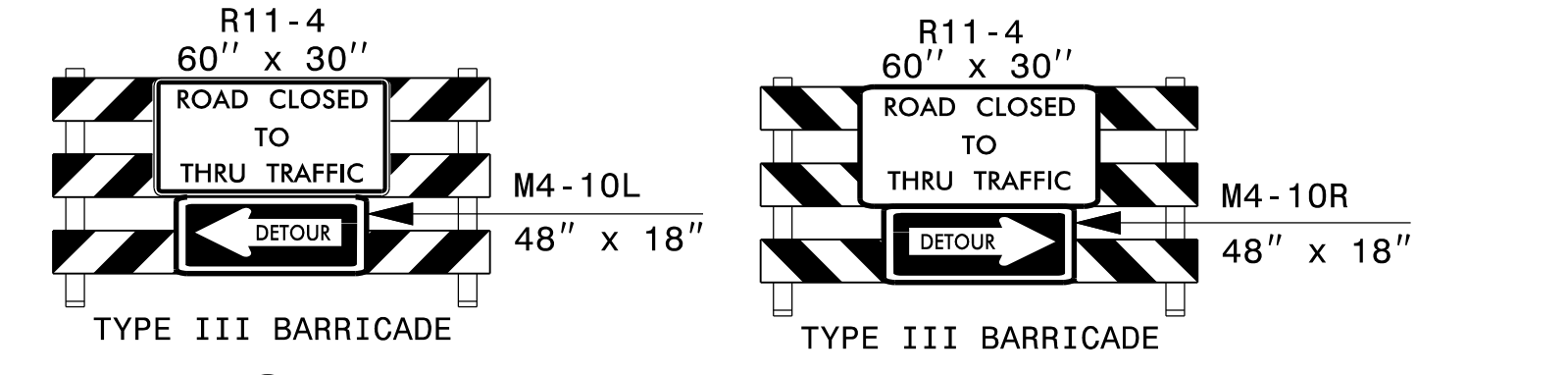
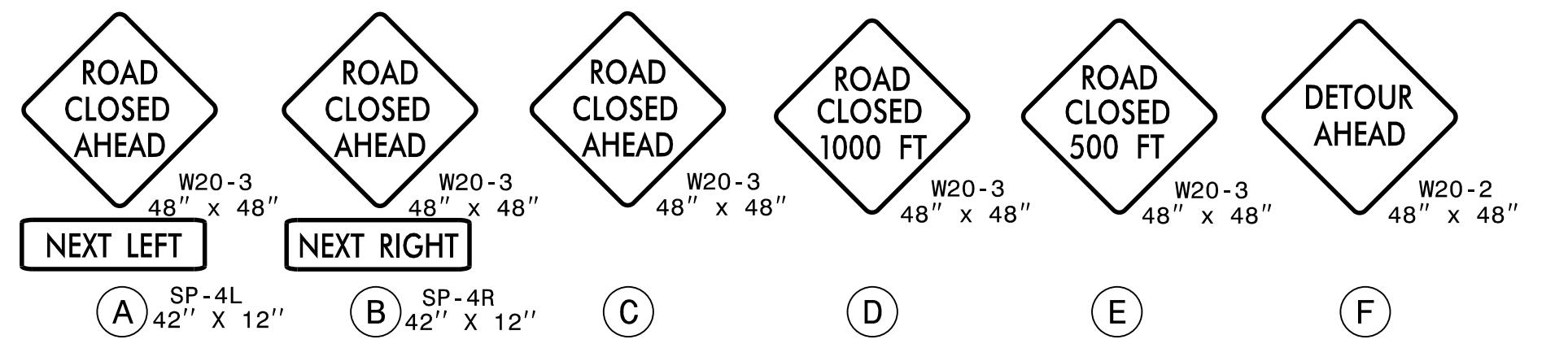
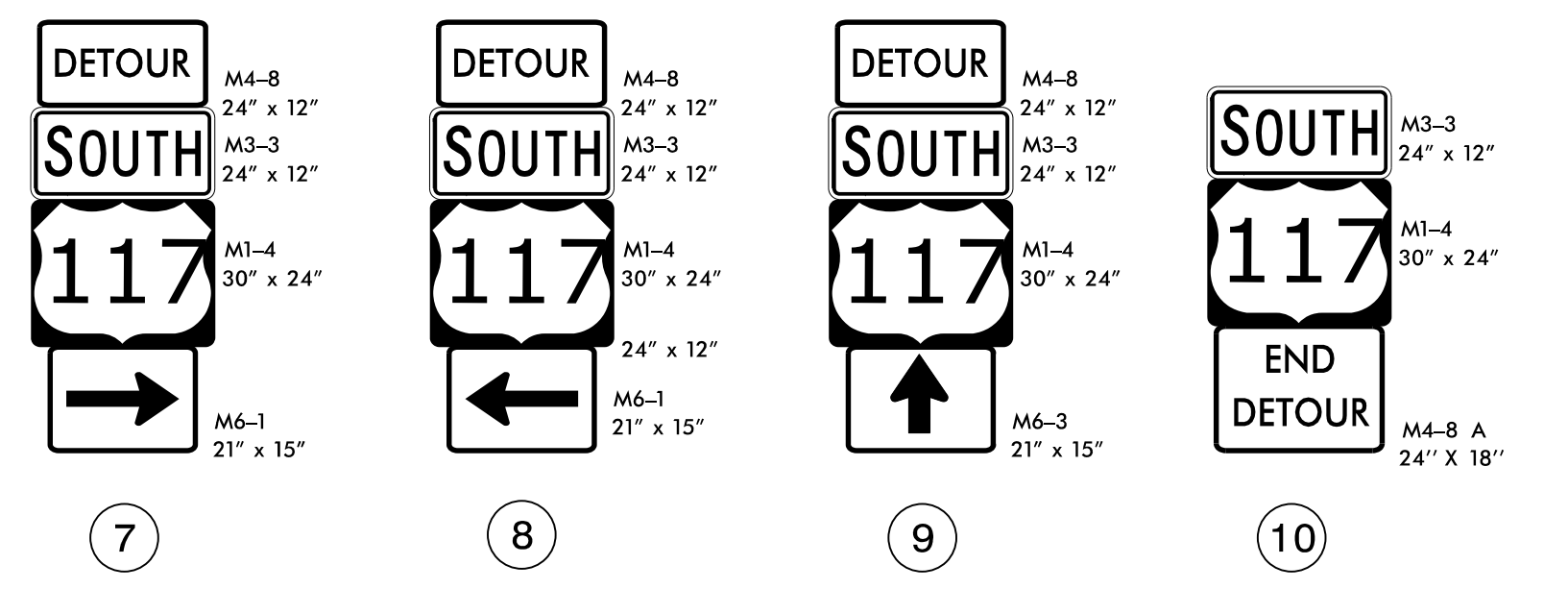
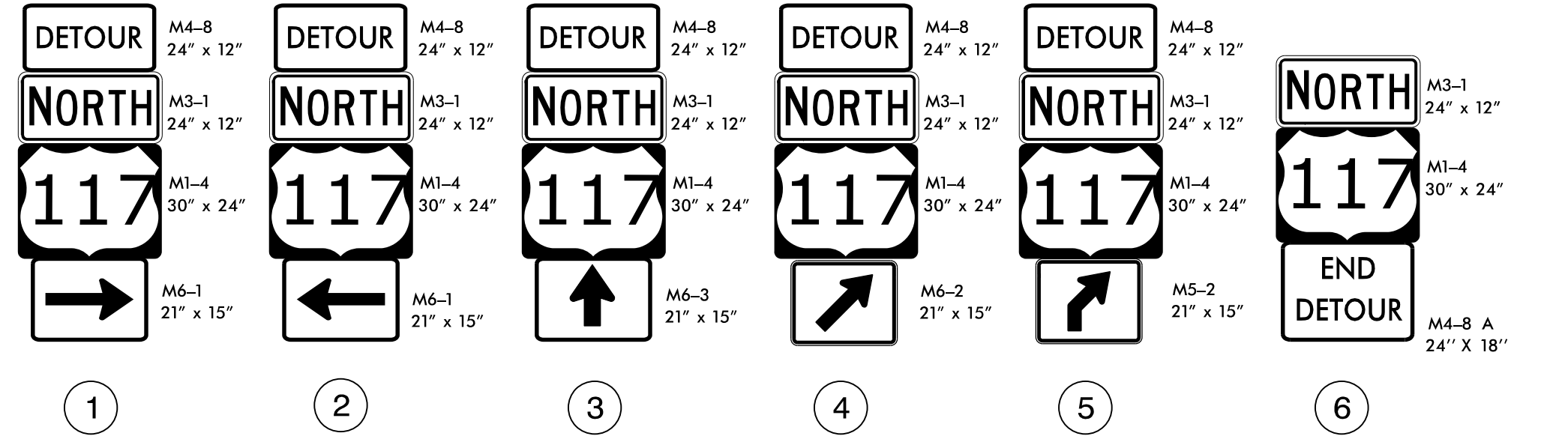
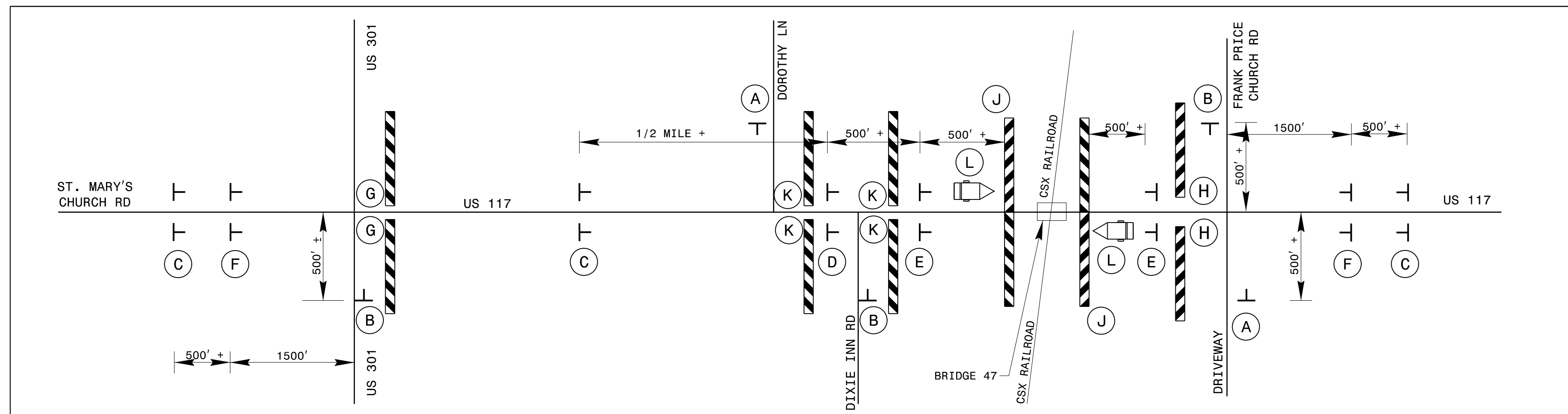

NOTES:
 1. REFER TO ROADWAY STANDARD DRAWING 1101.03, SHEET 1 OF 9 FOR APPLICABLE NOTES.
 2. ALL SIGN SPACING DIMENSIONS ARE APPROXIMATE. FIELD ADJUST AS NECESSARY OR AS DIRECTED BY THE ENGINEER.
 3. ALL DETOUR SIGN LOCATIONS ARE APPROXIMATE.

MESSAGE NO. 1	MESSAGE NO. 2
BRIDGE CLOSED XX/XX/XX	FOLLOW POSTED DETOUR
CHANGEABLE MESSAGE SIGN	

KCI Engineers • Planners • Scientists • Construction Managers
 4505 Falls of Neuse Road, Suite 400
 Raleigh, NC 27609-6270
 Phone (919) 783-9214 • Fax (919) 783-9266

APPROVED: _____
 DATE: 3/25/2021
 SEAL

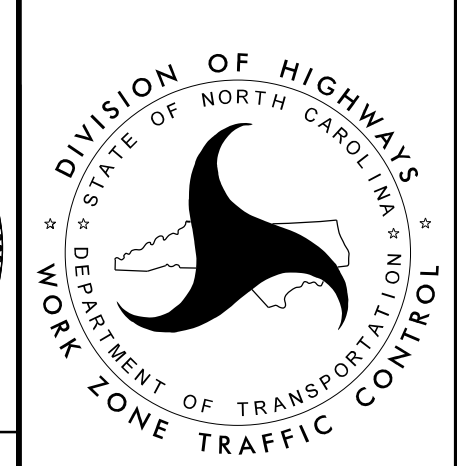
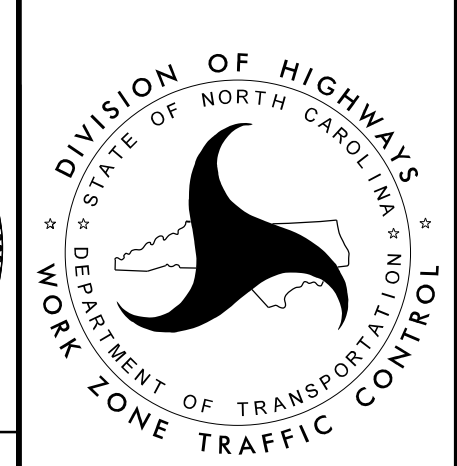

OFFSITE DETOUR ROUTE

DOCUMENT NOT CONSIDERED FINAL UNLESS ALL SIGNATURES COMPLETED

25-MAR-2021 10:28
 M:\2018\251801945\22 B-5666\TrafficControl\TCP\B5666_TC_TMP_03.dgn
 \$\$\$USERNAME\$\$\$