

PROJECT REFERENCE NO.	SHEET NO.
BR-0107	EC-05/CONST.04
RW SHEET NO.	
ROADWAY DESIGN ENGINEER	HYDRAULICS ENGINEER

-L-	-DR-
PI Sta 12+86.01 Δ = 30° 16' 53.0" (RT) D = 9° 57' 52.1" L = 303.89' T = 155.59' R = 575.00'	PI Sta 19+38.74 Δ = 23° 28' 16.0" (RT) D = 8° 54' 38.5" L = 263.40' T = 133.58' R = 643.00' SE = 0.06 RO = 114' DS = 45 MPH
PI Sta 10+65.88 Δ = 16° 17' 45.7" (LT) D = 57° 17' 44.8" L = 28.44' T = 14.32' R = 100.00'	



END TIP PROJECT BR-0107
-L- POC STA. 20+35.00

BEGIN TIP PROJECT BR-0107
-L- POT STA. 15+50.00

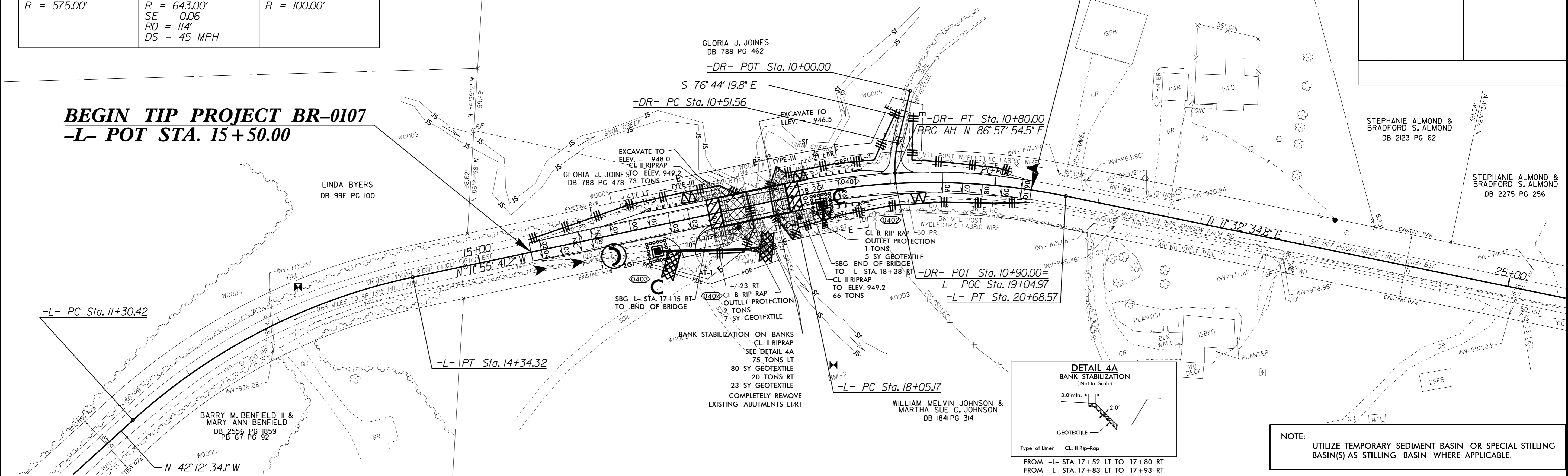

NOTE: UTILIZE TEMPORARY SEDIMENT BASIN OR SPECIAL STILLING BASIN(S) AS STILLING BASIN WHERE APPLICABLE.

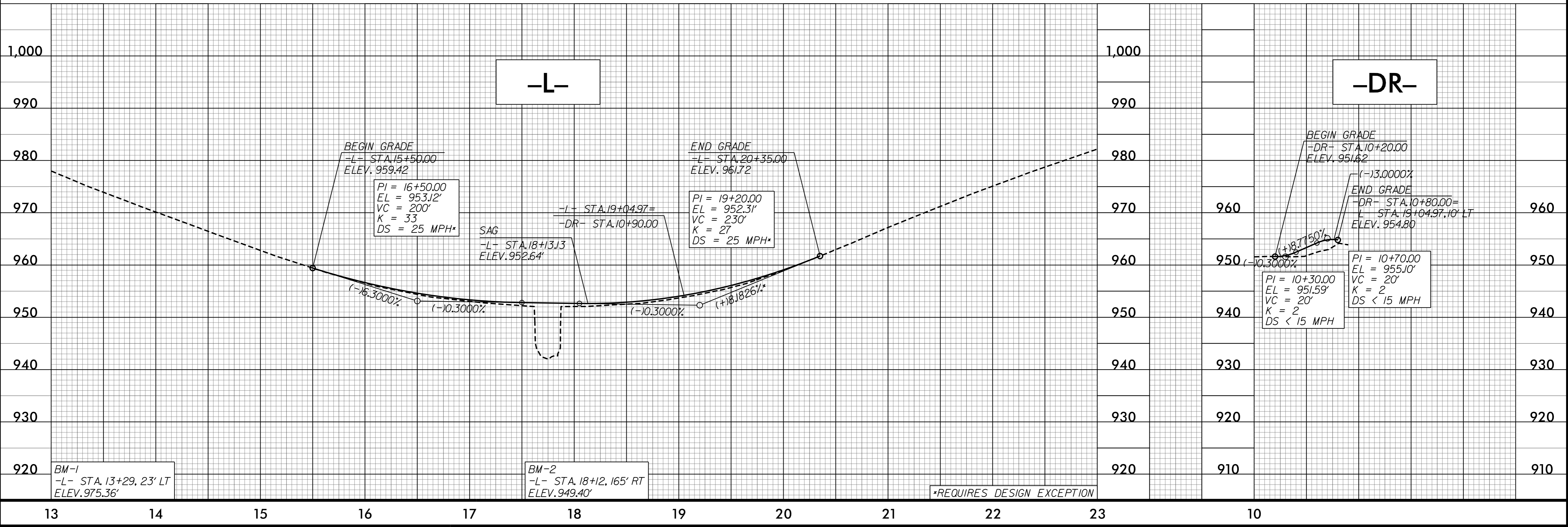

REVISIONS

1/15/2010 10:33:00 AM S:\545.dgn