

GEOTECHNICAL ENGINEER

ENGINEER

SEAL 029147

KRISTEN H. HILL

DocuSigned by: Kristen Hill

5/12/2021

SIGNATURE DATE SIGNATURE DATE

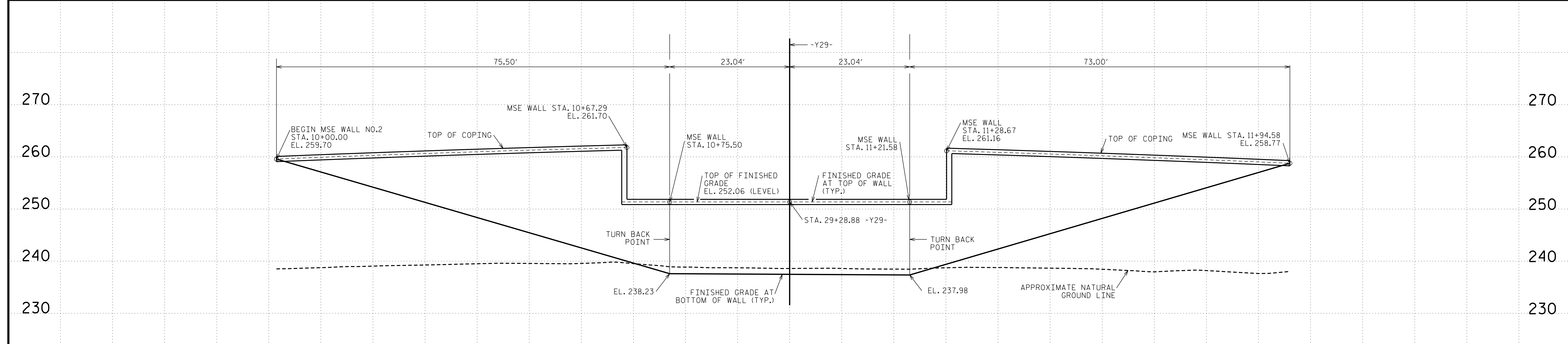
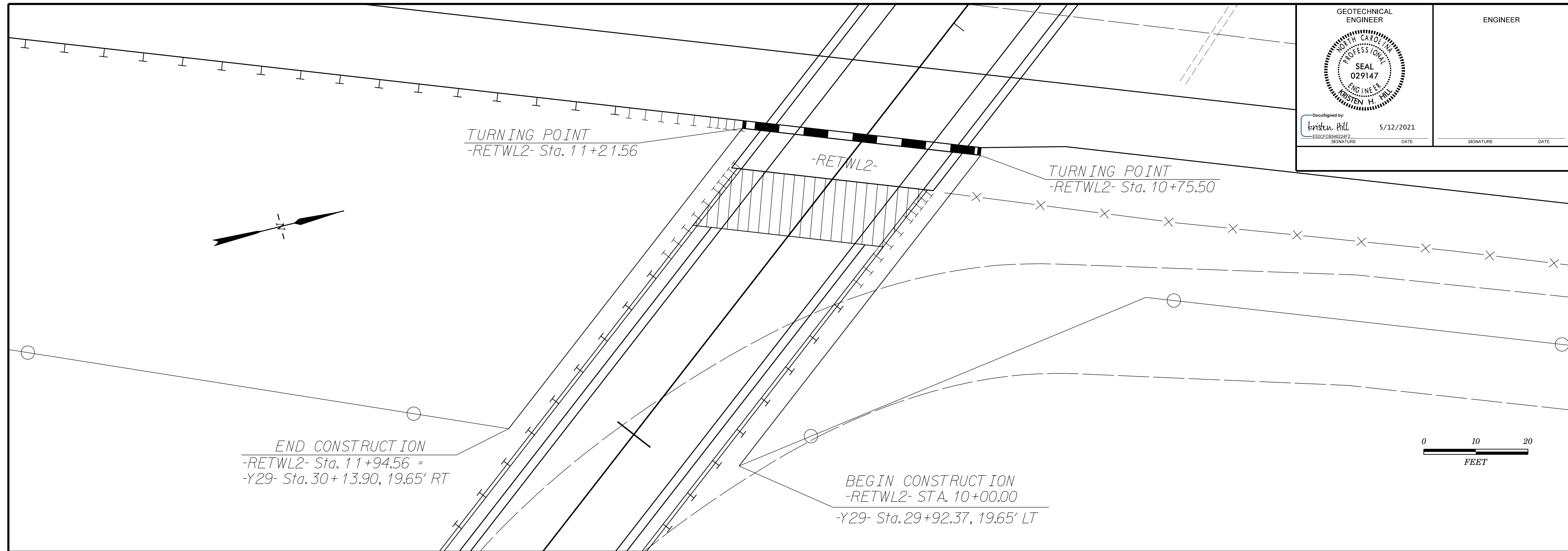

ESTIMATED MSE WALL QUANTITY (SQUARE FEET)	
MSE RETAINING WALL NO. 2	2,770 SF
ARCHITECTURAL CONCRETE SURFACE TREATMENT	2,178 SF

WALL ENVELOPE FOR RETAINING WALL NO. 2
LOOKING AHEAD STATION (-Y29-) AT FRONT FACE OF MSE WALL AT END BENT 2

PROJECT NO.: I-5986B
JOHNSTON COUNTY
STATION: 28+39.21 -Y29- / 1294+89.16 -L-
SHEET 2 OF 5

PREPARED BY: KHH DATE: 3/10/20
REVIEWED BY: SEM DATE: 3/10/20

9751 SOUTHERN PINE BLVD
CHARLOTTE, NC 28273
(704) 523-4726

MSE RETAINING WALL NO. 2 WALL ENVELOPES					
REVISIONS					
NO.	BY	DATE	NO.	BY	DATE
1			3		
2			4		

SHEET NO. W-2