

-WL5- RETAINING WALL ENVELOPE

-WL4- RETAINING WALL ENVELOPE

GEOTECHNICAL ENGINEER
 ENGINEER

 DocuSigned by:
 Kristen Hill
 5/19/2021
 SIGNATURE DATE SIGNATURE DATE

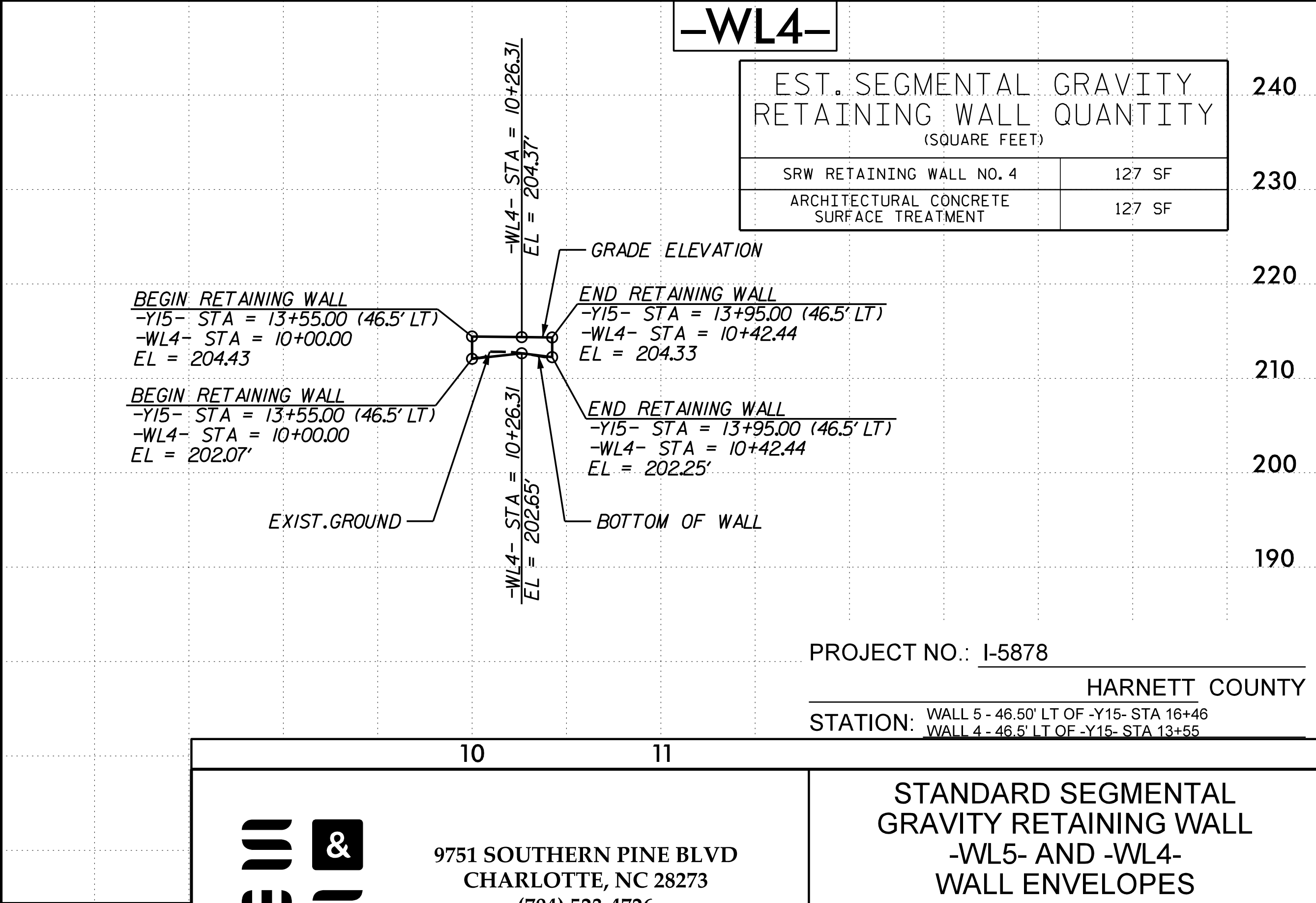
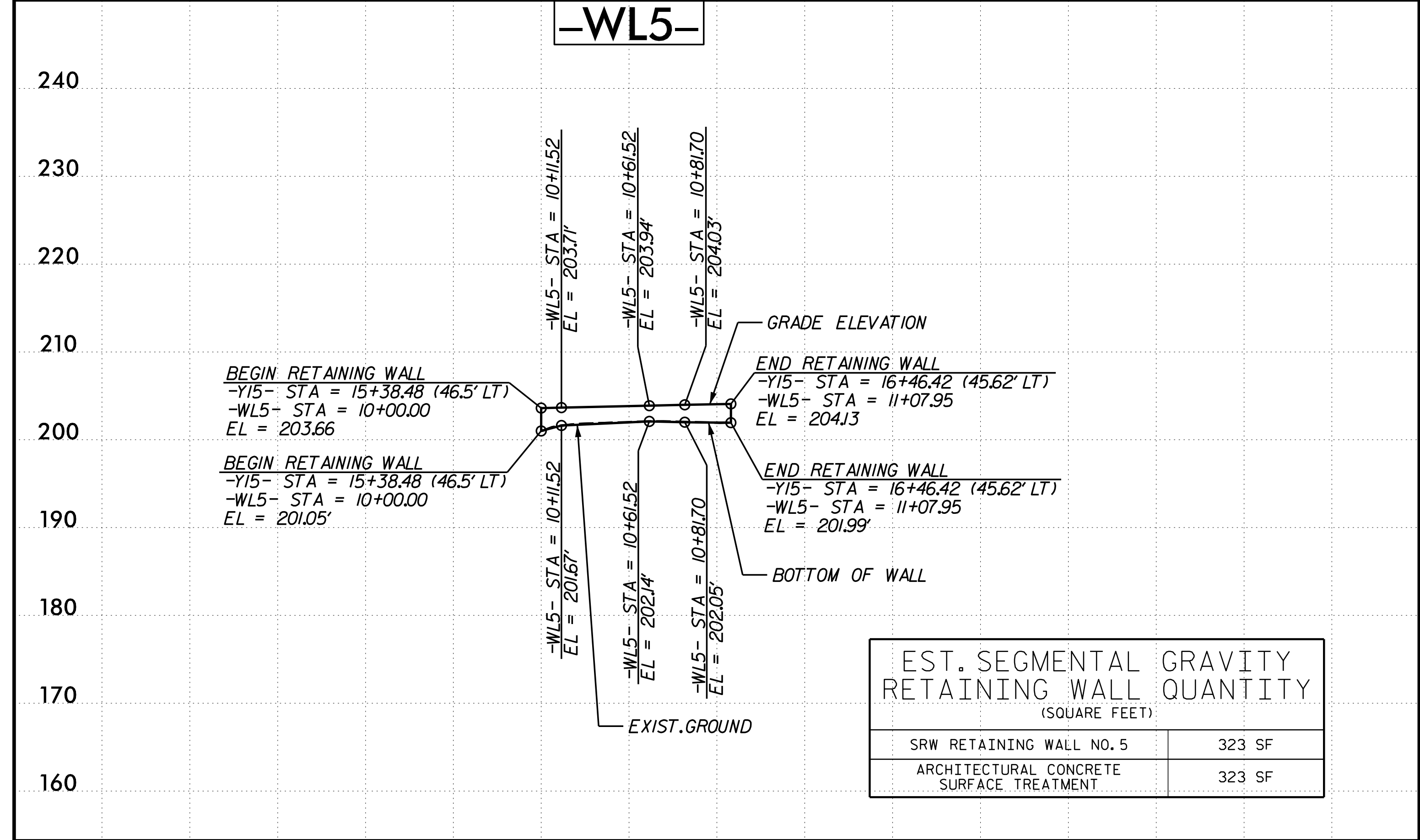
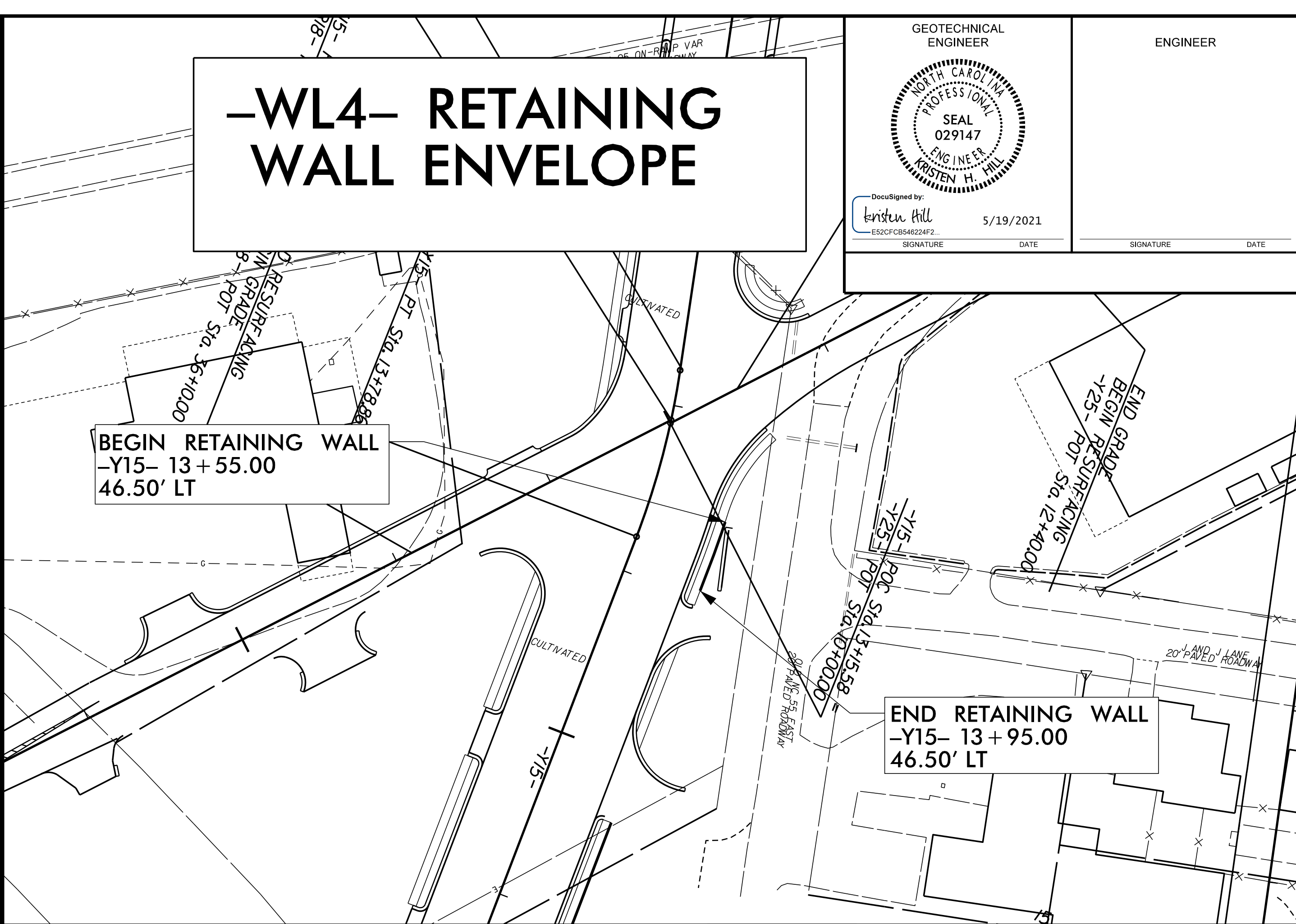
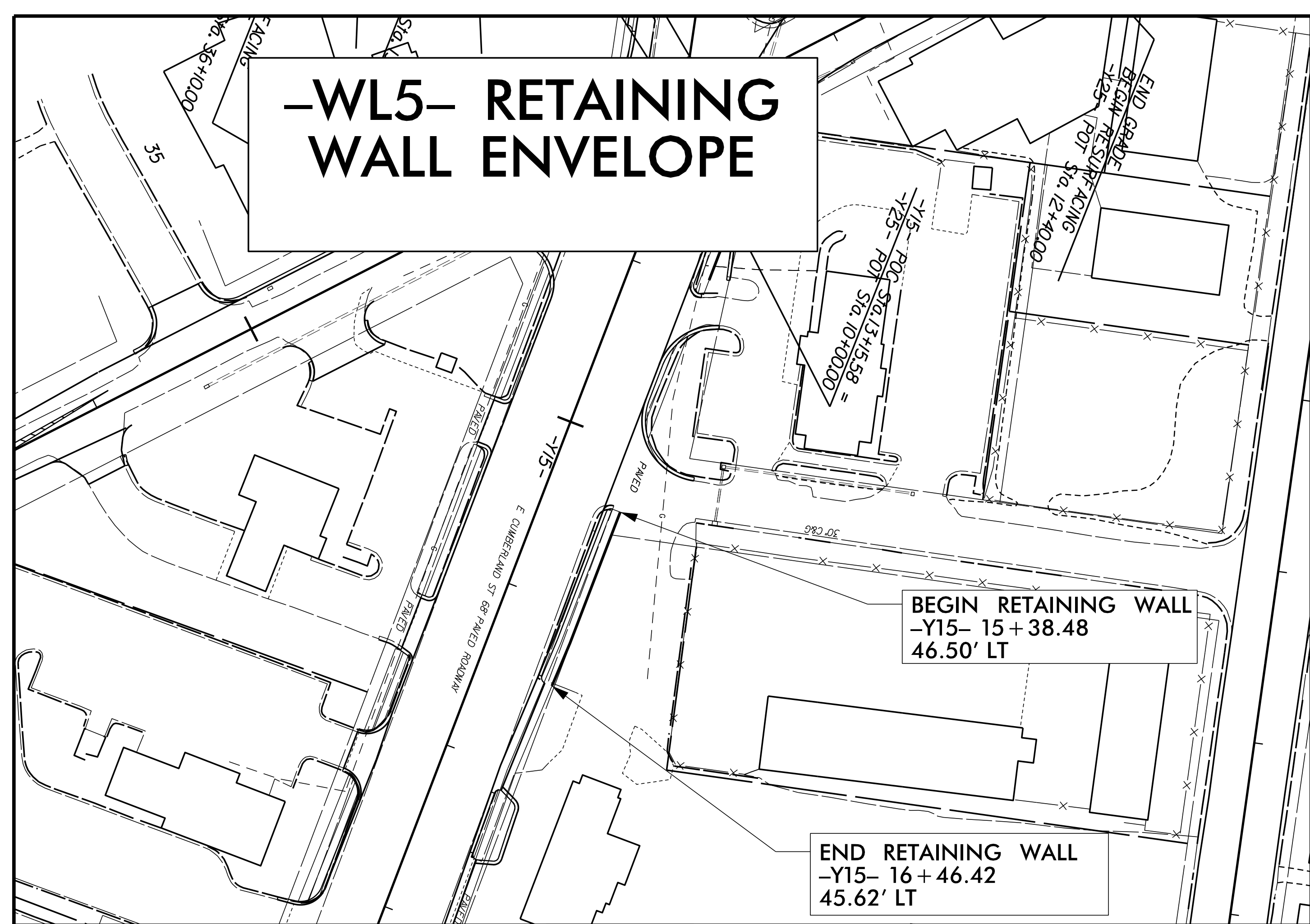

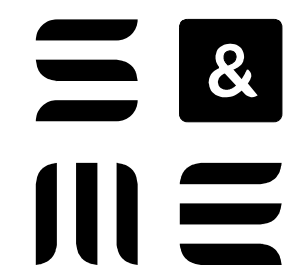
PREPARED BY: KHH
 DATE: 09/10/20
 REVIEWED BY: SEM
 DATE: 09/10/20



9751 SOUTHERN PINE BLVD
 CHARLOTTE, NC 28273
 (704) 523-4726

PROJECT NO.: I-5878
 HARNETT COUNTY
 STATION: WALL 5 - 46.50' LT OF -Y15- STA 16+46
 WALL 4 - 46.5' LT OF -Y15- STA 13+55

STANDARD SEGMENTAL GRAVITY RETAINING WALL -WL5- AND -WL4- WALL ENVELOPES					
REVISIONS					
NO.	BY	DATE	NO.	BY	DATE
1			3		
2			4		

SHEET NO. W-12