

PLAN OF SIDEWALK
RIGHT SIDE SHOWN, LEFT SIDE SIMILAR BY ROTATION.

NOTES:

- FOR END POST DETAILS AND REINFORCING STEEL, SEE "RAIL POST SPACINGS AND END OF RAIL DETAILS" SHEET.
- SIDEWALK IN A CONTINUOUS UNIT SHALL NOT BE CAST UNTIL ALL SLAB CONCRETE IN THE UNIT HAS BEEN CAST AND HAS REACHED A MINIMUM COMPRESSIVE STRENGTH OF 3,000 PSI.
- ALL REINFORCING STEEL IN SIDEWALKS SHALL BE EPOXY COATED.
- SIDEWALK REINFORCING STEEL AND CONCRETE ON BRIDGE SHALL BE INCLUDED IN THE PAY ITEM FOR THE "REINFORCED CONCRETE DECK SLAB".
- GROOVED CONTRACTION JOINTS 1/2" IN DEPTH, SHALL BE TOOLED IN ALL EXPOSED FACES OF THE SIDEWALK IN ACCORDANCE WITH ARTICLE 825-10(B) OF THE STANDARD SPECIFICATIONS. THE CONTRACTION JOINTS SHALL BE LOCATED AT A SPACING OF 8 FEET TO 10 FEET BETWEEN EXPANSION JOINTS. NO CONTRACTION JOINTS WILL BE REQUIRED FOR SEGMENTS LESS THAN 10 FEET IN LENGTH.

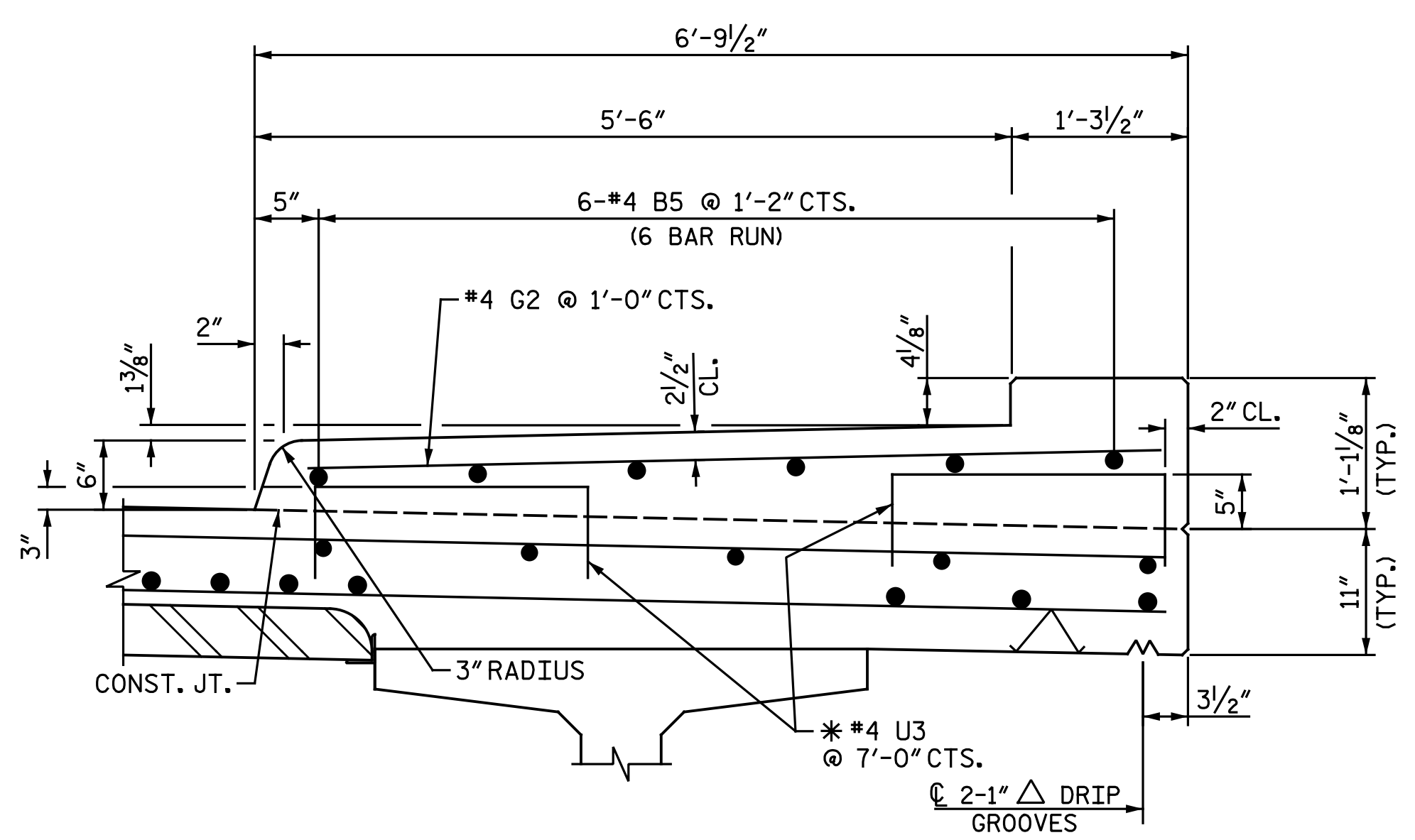

SECTION THRU SIDEWALK

* U3 BARS MAY BE PUSHED INTO GREEN CONCRETE AFTER SPAN HAS BEEN SCREEDED OFF.

SPLICE LENGTHS		
BAR SIZE	EPOXY COATED	UNCOATED
#4	2'-0"	-

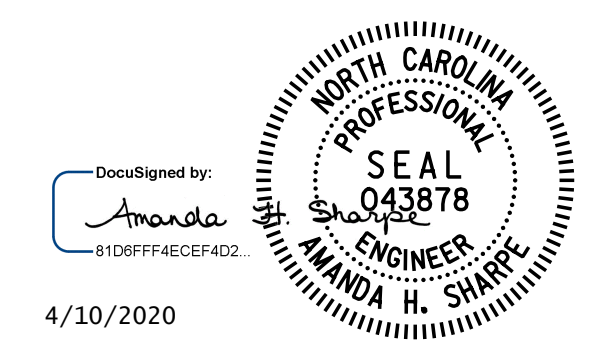

4/10/2020

PROJECT NO. I-5878
HARNETT COUNTY
STATION: 26+05.28 -Y14-

STATE OF NORTH CAROLINA
DEPARTMENT OF TRANSPORTATION
RALEIGH
SUPERSTRUCTURE
SIDEWALK DETAILS

DOCUMENT NOT CONSIDERED FINAL
UNLESS ALL SIGNATURES COMPLETED

Michael Baker INTERNATIONAL
Michael Baker Engineering
8000 Regency Parkway, Suite 600
Cary, North Carolina 27518
NC License No.: F-1084

REVISIONS						SHEET NO.
NO.	BY:	DATE:	NO.	BY:	DATE:	SI-21
1			3			TOTAL SHEETS
2			4			35

DRAWN BY : N. B. SPEAKS DATE : 7-8-19
CHECKED BY : A. H. SHARPE DATE : 8-30-19