

LAYOUT FOR COMPUTING AREA OF REINFORCED CONCRETE DECK SLAB (SQ. FT. = 9,587)

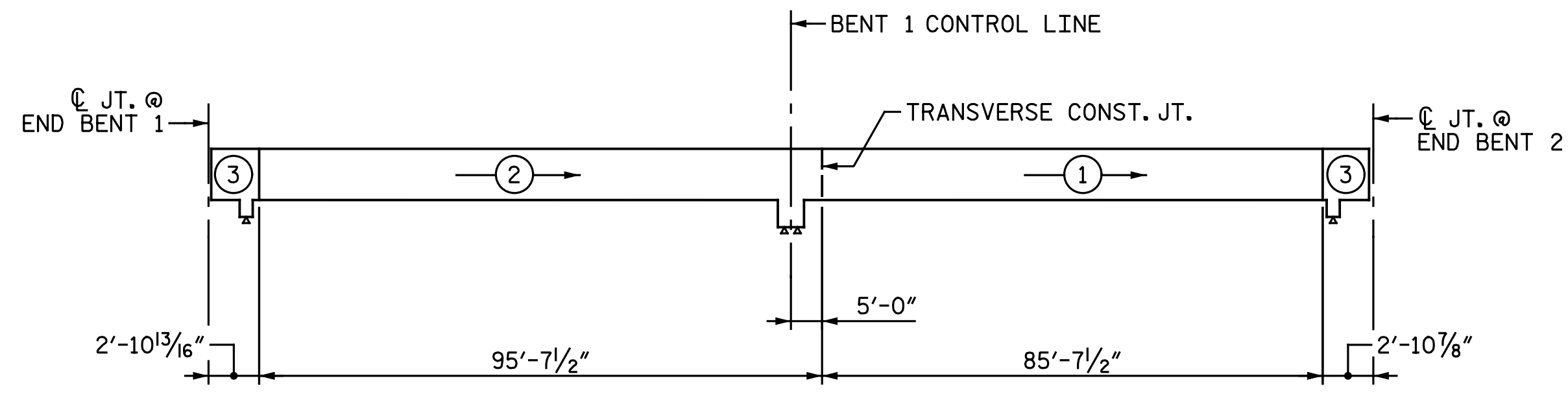

POURING SEQUENCE
 * DENOTES POUR NUMBER AND DIRECTION

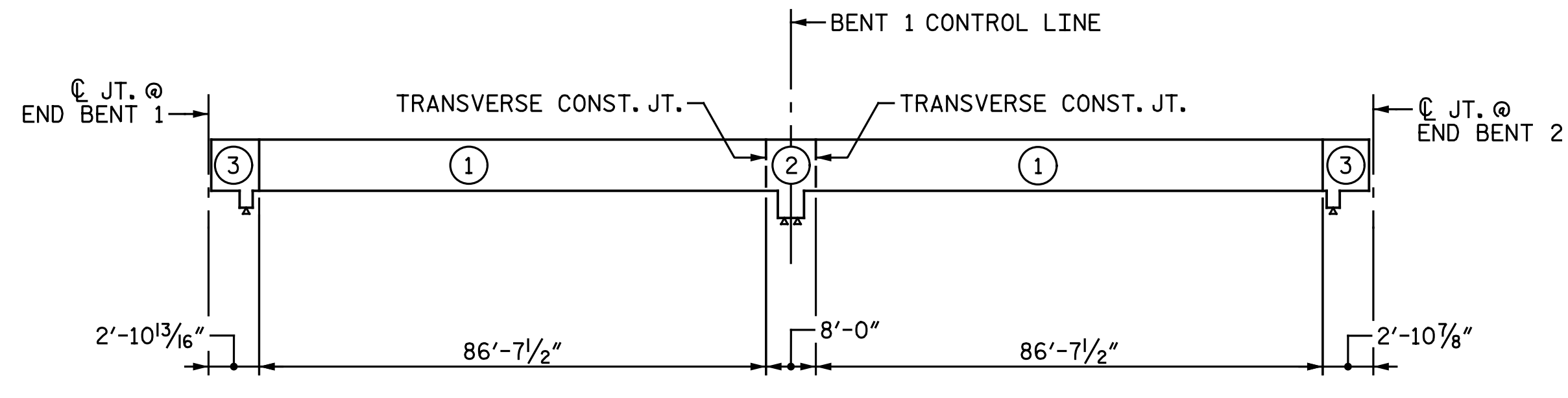

OPTIONAL POURING SEQUENCE
 * DENOTES POUR NUMBER

DRAWN BY : C. E. MAYHEW DATE : 1-9-19
 CHECKED BY : A. H. SHARPE DATE : 1-10-19

REINFORCING BAR SCHEDULE

SPANS A & B						SPANS A & B CONT'D.					
BAR	NO.	SIZE	TYPE	LENGTH	WEIGHT	BAR	NO.	SIZE	TYPE	LENGTH	WEIGHT
A1E	312	#5	STR.	50' - 11"	16,569	A221	2	#5	STR.	33' - 7"	70
A2	312	#5	STR.	50' - 11"	16,569	A222	2	#5	STR.	32' - 9"	68
A3E	8	#6	STR.	59' - 1"	710	A223	2	#5	STR.	31' - 11"	67
						A224	2	#5	STR.	31' - 1"	65
A101E	2	#5	STR.	50' - 6"	105	A225	2	#5	STR.	30' - 3"	63
A102E	2	#5	STR.	49' - 8"	104	A226	2	#5	STR.	29' - 4"	61
A103E	2	#5	STR.	48' - 10"	102	A227	2	#5	STR.	28' - 6"	59
A104E	2	#5	STR.	48' - 0"	100	A228	2	#5	STR.	27' - 8"	58
A105E	2	#5	STR.	47' - 2"	98	A229	2	#5	STR.	26' - 10"	56
A106E	2	#5	STR.	46' - 4"	97	A230	2	#5	STR.	26' - 0"	54
A107E	2	#5	STR.	45' - 5"	95	A231	2	#5	STR.	25' - 2"	52
A108E	2	#5	STR.	44' - 7"	93	A232	2	#5	STR.	24' - 3"	51
A109E	2	#5	STR.	43' - 9"	91	A233	2	#5	STR.	23' - 5"	49
A110E	2	#5	STR.	42' - 11"	90	A234	2	#5	STR.	22' - 7"	47
A111E	2	#5	STR.	42' - 1"	88	A235	2	#5	STR.	21' - 9"	45
A112E	2	#5	STR.	41' - 3"	86	A236	2	#5	STR.	20' - 11"	44
A113E	2	#5	STR.	40' - 4"	84	A237	2	#5	STR.	20' - 1"	42
A114E	2	#5	STR.	39' - 6"	82	A238	2	#5	STR.	19' - 2"	40
A115E	2	#5	STR.	38' - 8"	81	A239	2	#5	STR.	18' - 4"	38
A116E	2	#5	STR.	37' - 10"	79	A240	2	#5	STR.	17' - 6"	37
A117E	2	#5	STR.	37' - 0"	77	A241	2	#5	STR.	16' - 8"	35
A118E	2	#5	STR.	36' - 2"	75	A242	2	#5	STR.	15' - 10"	33
A119E	2	#5	STR.	35' - 3"	74	A243	2	#5	STR.	15' - 0"	31
A120E	2	#5	STR.	34' - 5"	72	A244	2	#5	STR.	14' - 1"	29
A121E	2	#5	STR.	33' - 7"	70	A245	2	#5	STR.	13' - 3"	28
A122E	2	#5	STR.	32' - 9"	68	A246	2	#5	STR.	12' - 5"	26
A123E	2	#5	STR.	31' - 11"	67	A247	2	#5	STR.	11' - 7"	24
A124E	2	#5	STR.	31' - 1"	65	A248	2	#5	STR.	10' - 9"	22
A125E	2	#5	STR.	30' - 3"	63	A249	2	#5	STR.	9' - 11"	21
A126E	2	#5	STR.	29' - 4"	61	A250	2	#5	STR.	9' - 0"	19
A127E	2	#5	STR.	28' - 6"	59	A251	2	#5	STR.	8' - 2"	17
A128E	2	#5	STR.	27' - 8"	58	A252	2	#5	STR.	7' - 4"	15
A129E	2	#5	STR.	26' - 10"	56	A253	2	#5	STR.	6' - 6"	14
A130E	2	#5	STR.	26' - 0"	54	A254	2	#5	STR.	5' - 8"	12
A131E	2	#5	STR.	25' - 2"	52	A255	2	#5	STR.	4' - 10"	10
A132E	2	#5	STR.	24' - 3"	51	A256	2	#5	STR.	3' - 11"	8
A133E	2	#5	STR.	23' - 5"	49	A257	2	#5	STR.	3' - 1"	6
A134E	2	#5	STR.	22' - 7"	47	A258	2	#5	STR.	2' - 3"	5
A135E	2	#5	STR.	21' - 9"	45						
A136E	2	#5	STR.	20' - 11"	44	B1E	210	#4	STR.	22' - 3"	3,121
A137E	2	#5	STR.	20' - 1"	42	B2	260	#5	STR.	48' - 4"	13,107
A138E	2	#5	STR.	19' - 2"	40	B3E	105	#6	STR.	23' - 9"	3,746
A139E	2	#5	STR.	18' - 4"	38	B4E	66	#6	STR.	34' - 2"	3,387
A140E	2	#5	STR.	17' - 6"	37						
A141E	2	#5	STR.	16' - 8"	35	G1E	2	#5	STR.	59' - 1"	123
A142E	2	#5	STR.	15' - 10"	33						
A143E	2	#5	STR.	15' - 0"	31	J1E	112	#4	7	1' - 5"	106
A144E	2	#5	STR.	14' - 1"	29						
A145E	2	#5	STR.	13' - 3"	28	K1E	8	#8	1	15' - 11"	340
A146E	2	#5	STR.	12' - 5"	26	K2E	16	#8	2	23' - 6"	1,004
A147E	2	#5	STR.	11' - 7"	24	K3E	20	#5	STR.	8' - 2"	170
A148E	2	#5	STR.	10' - 9"	22	K4E	30	#6	STR.	7' - 10"	353
A149E	2	#5	STR.	9' - 11"	21	K5	10	#4	STR.	7' - 10"	52
A150E	2	#5	STR.	9' - 0"	19	K6	20	#4	STR.	8' - 11"	119
A151E	2	#5	STR.	8' - 2"	17	K7	10	#4	STR.	8' - 3"	55
A152E	2	#5	STR.	7' - 4"	15	K8	10	#4	STR.	5' - 10"	39
A153E	2	#5	STR.	6' - 6"	14	K9	10	#4	3	6' - 10"	46
A154E	2	#5	STR.	5' - 8"	12	K10	20	#4	4	12' - 4"	165
A155E	2	#5	STR.	4' - 10"	10	K11	16	#4	STR.	3' - 8"	39
A156E	2	#5	STR.	3' - 11"	8						
A157E	2	#5	STR.	3' - 1"	6	S1E	80	#4	5	5' - 0"	267
A158E	2	#5	STR.	2' - 3"	5	S2E	80	#5	6	5' - 9"	480
						S3	140	#4	8	3' - 0"	281
A201	2	#5	STR.	50' - 6"	105						
A202	2	#5	STR.	49' - 8"	104	U1	30	#4	9	14' - 1"	282
A203	2	#5	STR.	48' - 10"	102	U2	10	#4	5	6' - 11"	46
A204	2	#5	STR.	48' - 0"	100						
A205	2	#5	STR.	47' - 2"	98						
A206	2	#5	STR.	46' - 4"	97						
A207	2	#5	STR.	45' - 5"	95						
A208	2	#5	STR.	44' - 7"	93						
A209	2	#5	STR.	43' - 9"	91						
A210	2	#5	STR.	42' - 11"	90						
A211	2	#5	STR.	42' - 1"	88						
A212	2	#5	STR.	41' - 3"	86						
A213	2	#5	STR.	40' - 4"	84						
A214	2	#5	STR.	39' - 6"	82						
A215	2	#5	STR.	38' - 8"	81						
A216	2	#5	STR.	37' - 10"	79						
A217	2	#5	STR.	37' - 0"	77						
A218	2	#5	STR.	36' - 2"	75						
A219	2	#5	STR.	35' - 3"	74						
A220	2	#5	STR.	34' - 5"	72						

GROOVING BRIDGE FLOORS		
APPROACH SLABS	1,795	SQ.FT.
BRIDGE DECK	7,058	SQ.FT.
TOTAL	8,853	SQ.FT.

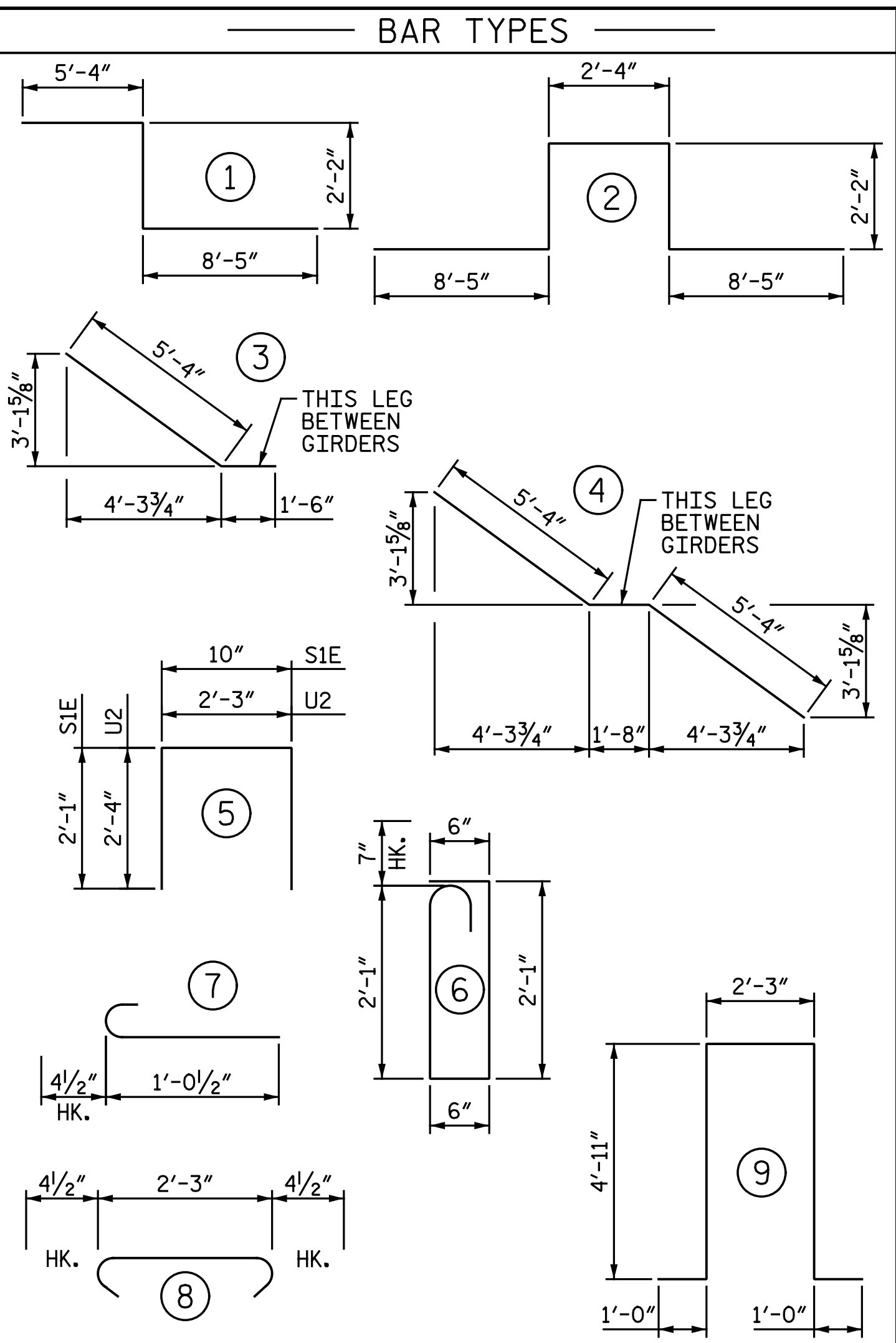

ALL BAR DIMENSIONS ARE OUT TO OUT
 SUPERSTRUCTURE BILL OF MATERIAL

	CLASS AA CONCRETE (CU. YDS.)	REINFORCING STEEL (LBS.)	EPOXY COATED REINFORCING STEEL (LBS.)
SPANS A & B		33,994	33,570
POUR 1	140.1		
POUR 2	175.9		
POUR 3	16.9		
MONOLITHIC CONC. ISLAND	10.5		644
TOTALS*	343.4	33,994	34,214

*QUANTITIES FOR BARRIER RAIL ARE NOT INCLUDED

PROJECT NO. I-5883
 HARNETT COUNTY
 STATION: 27+09.19 -Y16-



STATE OF NORTH CAROLINA
 DEPARTMENT OF TRANSPORTATION
 RALEIGH
 SUPERSTRUCTURE
 BILL OF MATERIAL

DOCUMENT NOT CONSIDERED FINAL
 UNLESS ALL SIGNATURES COMPLETED

NO.	REVISIONS			SHEET NO.
	BY:	DATE:	NO.	
1			3	SI-21
2			4	

Michael Baker INTERNATIONAL

Michael Baker Engineering
 8000 Regency Parkway, Suite 600
 Cary, North Carolina 27518
 NC License No.: F-1084

4/8/2020