

23+50 24+00 24+50 25+00 25+50 26+00 26+50 27+00

SCOPE OF WORK

- REMOVE EXISTING JOINT SEALS.
- PARTIALLY REMOVE CONCRETE IN DESIGNATED BRIDGE DECK AREA BY SCARIFICATION METHODS.
- PERFORM REPAIRS IF NECESSARY IN SCARIFIED BRIDGE DECK AREA.
- REMOVE EXISTING SIDEWALK AND THREE BAR METAL RAIL ON EACH SIDE OF BRIDGE.
- REMOVE ASPHALT PAVEMENT ON APPROACH SLABS IN PROPOSED SIDEWALK AREAS. PREPARE APPROACH SLAB SURFACES FOR PROPOSED SIDEWALK CONSTRUCTION WITH SHOTBLASTING AND OTHER APPROPRIATE METHODS.
- CONSTRUCT PROPOSED PARAPET AND TWO BAR METAL RAIL ON EACH SIDE OF BRIDGE.
- CONSTRUCT PROPOSED SIDEWALK ON EACH SIDE OF BRIDGE.
- CLEAN AND OTHERWISE PREPARE SCARIFIED BRIDGE DECK AREA WITH SHOTBLASTING AND OTHER APPROPRIATE METHODS.
- OVERLAY PREPARED BRIDGE DECK AREA WITH POLYESTER POLYMER CONCRETE.
- RECONSTRUCT BRIDGE JOINTS AND INSTALL BACKER ROD AND SILICONE JOINT SEALANT.
- GROOVE POLYESTER POLYMER CONCRETE DECK.
- CLEAN AND PAINT BOTH ENDS OF EACH EXISTING STEEL GIRDER FOR LENGTH OF 9'-3" AND EACH EXISTING STEEL BEARING COMPONENT AT END BENTS AND INTERIOR BENT.
- CLEAN AND EPOXY COAT ENTIRE TOP SURFACE OF END BENT CAPS.
- CLEAN AND EPOXY COAT TOP SURFACE AND SIDE FACES OF INTERIOR BENT CAP FOR LENGTH OF 3'-0" FROM EACH OUTSIDE END TO ADJACENT COLUMN FACE, AS WELL AS OUTSIDE END FACES OF INTERIOR BENT CAP.

NOTES:

GENERAL DRAWING INFORMATION IS TAKEN FROM THE EXISTING BRIDGE PLANS AND THE ROUTINE INSPECTION REPORT DATED 10/20/2020.
BRIDGE ORIENTATION CONFORMS TO EXISTING BRIDGE PLANS.

I HEREBY CERTIFY THAT THIS STRUCTURE WAS REHABILITATED ACCORDING TO THESE PLANS OR AS NOTED HEREIN.

RESIDENT ENGINEER _____ DATE _____

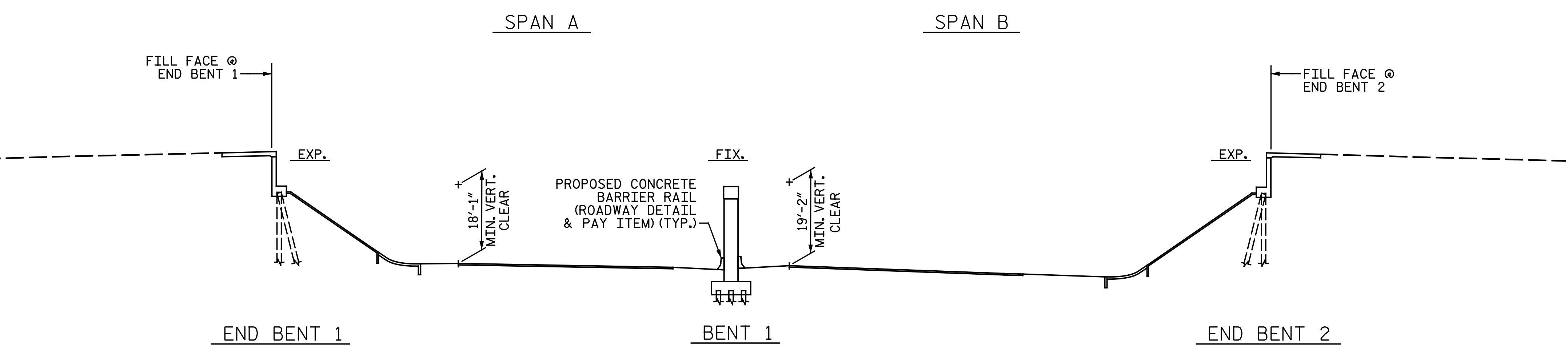

PROPOSED -L- HORIZONTAL CURVE DATA

P.I. STA. 1330+88.15
 $\Delta = 30^\circ-59'-22.4"$ (RT)
 $D = 1^\circ-00'-00"$
 $L = 3,098.96'$
 $T = 1,588.39'$
 $R = 5,729.58'$

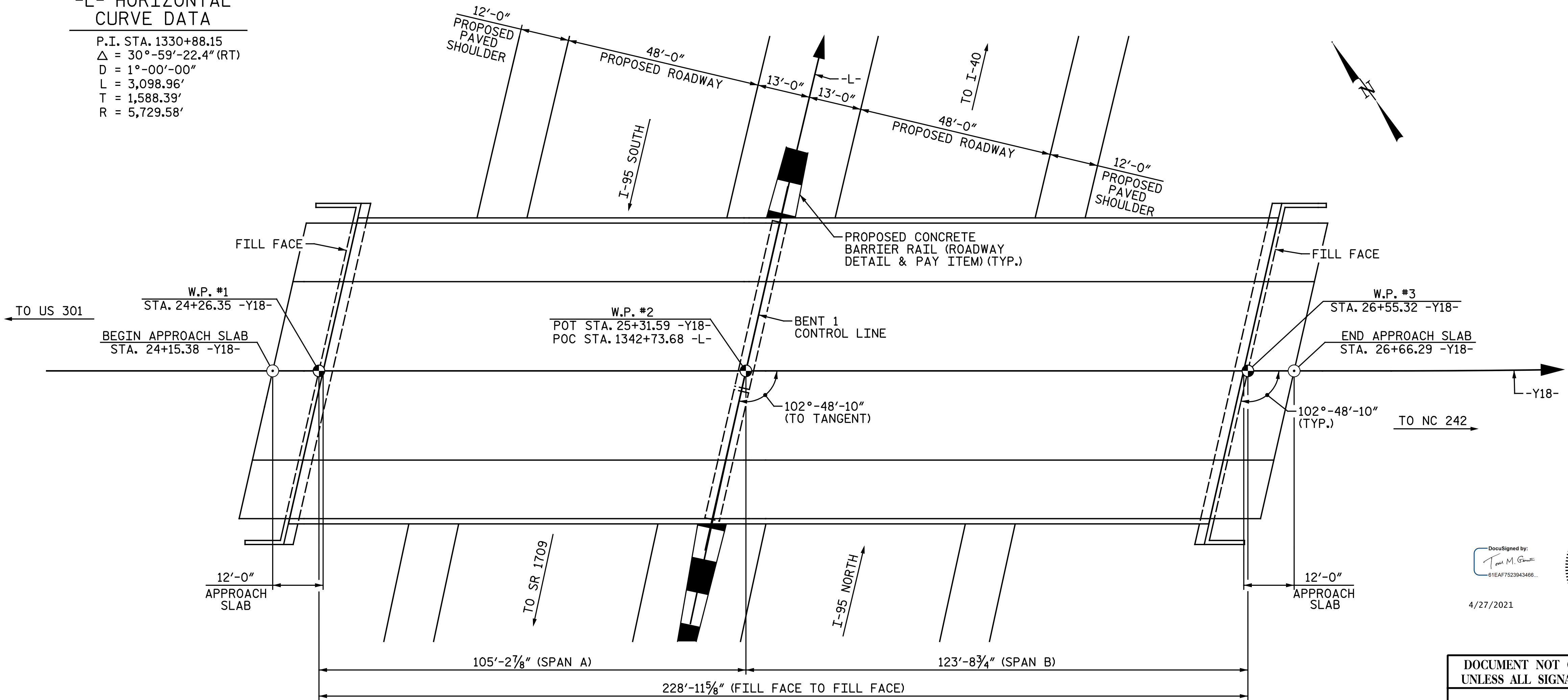

DocuSigned by:
 Todd M. Garrison
 61EAF7523943466...
 4/27/2021



PROJECT NO. I-5986B
JOHNSTON COUNTY
 STATION: 25+31.59 -Y18-
1342+73.68 -L-
 SHEET 1 OF 2 REHABILITATION OF BRIDGE NO. 500051

STATE OF NORTH CAROLINA
 DEPARTMENT OF TRANSPORTATION
 RALEIGH

GENERAL DRAWING
 FOR BRIDGE NO. 500051
 ON NC 50 OVER I-95

DOCUMENT NOT CONSIDERED FINAL
 UNLESS ALL SIGNATURES COMPLETED

Michael Baker International		Michael Baker Engineering 8000 Regency Parkway, Suite 600 Cary, North Carolina 27518 NC License No.: F-1084		REVISIONS			SHEET NO.
NO.	BY:	DATE:	NO.	BY:	DATE:	TOTAL SHEETS	
1			3			14	
2			4				

DRAWN BY : C. E. MAYHEW DATE : 3-24-21
 CHECKED BY : T. M. GARRISON DATE : 3-24-21