

LAYOUT FOR COMPUTING AREA OF REINFORCED CONCRETE DECK SLAB (STAGE III SQ. FT. = 6,410)

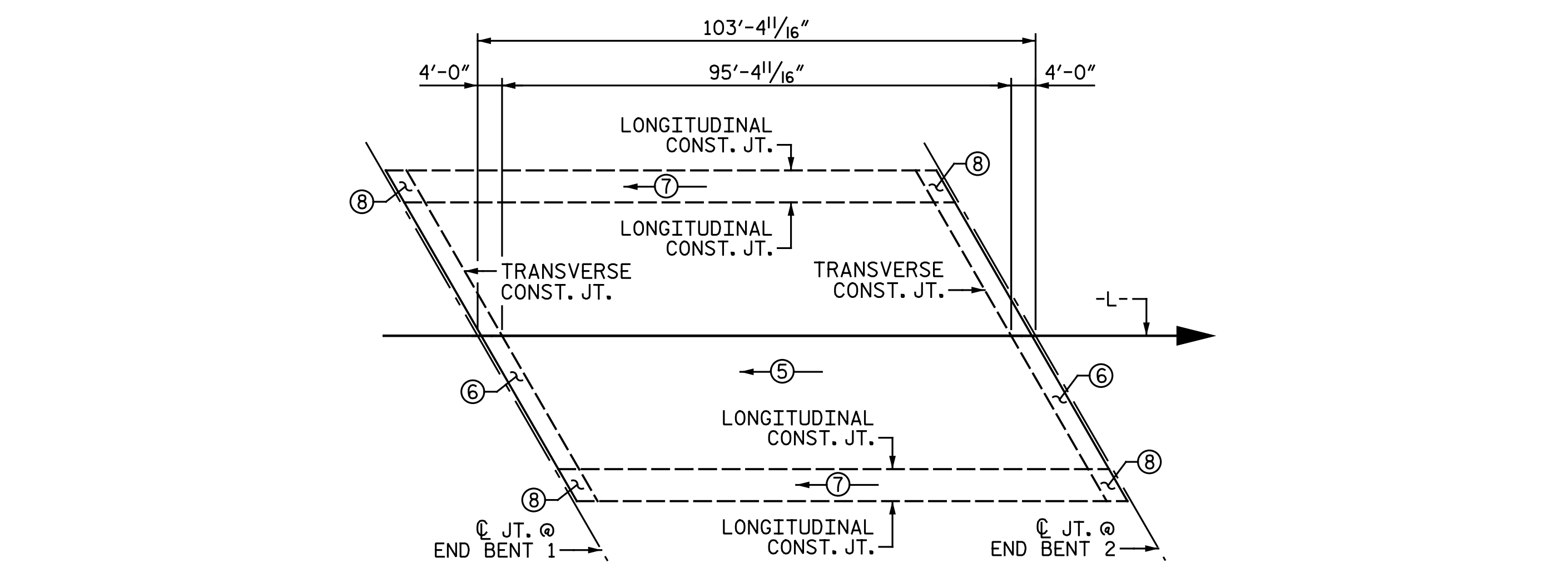

POURING SEQUENCE

⑧ → DENOTES POUR NUMBER AND DIRECTION

DRAWN BY : C. E. MAYHEW DATE : 12-10-19  
 CHECKED BY : J. M. GARRISON DATE : 12-15-19

REINFORCING BAR SCHEDULE

SPAN A - STAGE III

BAR	NO.	SIZE	TYPE	LENGTH	WEIGHT	BAR	NO.	SIZE	TYPE	LENGTH	WEIGHT
* A4	117	#5	STR.	49' - 8"	6,061	A511	2	#5	STR.	38' - 5"	80
A5	117	#5	STR.	49' - 8"	6,061	A512	2	#5	STR.	37' - 4"	78
* A6	20	#5	STR.	51' - 3"	1,069	A513	2	#5	STR.	36' - 3"	76
						A514	2	#5	STR.	35' - 2"	73
* A401	2	#5	STR.	49' - 3"	103	A515	2	#5	STR.	34' - 1"	71
* A402	2	#5	STR.	48' - 2"	100	A516	2	#5	STR.	33' - 0"	69
* A403	2	#5	STR.	47' - 1"	98	A517	2	#5	STR.	31' - 11"	67
* A404	2	#5	STR.	46' - 0"	96	A518	2	#5	STR.	30' - 10"	64
* A405	2	#5	STR.	44' - 11"	94	A519	2	#5	STR.	29' - 9"	62
* A406	2	#5	STR.	43' - 10"	91	A520	2	#5	STR.	28' - 8"	60
* A407	2	#5	STR.	42' - 9"	89	A521	2	#5	STR.	27' - 7"	58
* A408	2	#5	STR.	41' - 8"	87	A522	2	#5	STR.	26' - 6"	55
* A409	2	#5	STR.	40' - 7"	85	A523	2	#5	STR.	25' - 5"	53
* A410	2	#5	STR.	39' - 6"	82	A524	2	#5	STR.	24' - 4"	51
* A411	2	#5	STR.	38' - 5"	80	A525	2	#5	STR.	23' - 3"	48
* A412	2	#5	STR.	37' - 4"	78	A526	2	#5	STR.	22' - 2"	46
* A413	2	#5	STR.	36' - 3"	76	A527	2	#5	STR.	21' - 1"	44
* A414	2	#5	STR.	35' - 2"	73	A528	2	#5	STR.	20' - 0"	42
* A415	2	#5	STR.	34' - 1"	71	A529	2	#5	STR.	18' - 11"	39
* A416	2	#5	STR.	33' - 0"	69	A530	2	#5	STR.	17' - 10"	37
* A417	2	#5	STR.	31' - 11"	67	A531	2	#5	STR.	16' - 9"	35
* A418	2	#5	STR.	30' - 10"	64	A532	2	#5	STR.	15' - 8"	33
* A419	2	#5	STR.	29' - 9"	62	A533	2	#5	STR.	14' - 7"	30
* A420	2	#5	STR.	28' - 8"	60	A534	2	#5	STR.	13' - 6"	28
* A421	2	#5	STR.	27' - 7"	58	A535	2	#5	STR.	12' - 5"	26
* A422	2	#5	STR.	26' - 6"	55	A536	2	#5	STR.	11' - 4"	24
* A423	2	#5	STR.	25' - 5"	53	A537	2	#5	STR.	10' - 3"	21
* A424	2	#5	STR.	24' - 4"	51	A538	2	#5	STR.	9' - 2"	19
* A425	2	#5	STR.	23' - 3"	48	A539	2	#5	STR.	8' - 1"	17
* A426	2	#5	STR.	22' - 2"	46	A540	2	#5	STR.	7' - 0"	15
* A427	2	#5	STR.	21' - 1"	44	A541	2	#5	STR.	5' - 11"	12
* A428	2	#5	STR.	20' - 0"	42	A542	2	#5	STR.	4' - 10"	10
* A429	2	#5	STR.	18' - 11"	39	A543	2	#5	STR.	3' - 9"	8
* A430	2	#5	STR.	17' - 10"	37	A544	2	#5	STR.	2' - 8"	6
* A431	2	#5	STR.	16' - 9"	35						
* A432	2	#5	STR.	15' - 8"	33	* B1	132	#4	STR.	35' - 8"	3,145
* A433	2	#5	STR.	14' - 7"	30	B2	118	#5	STR.	52' - 6"	6,461
* A434	2	#5	STR.	13' - 6"	28						
* A435	2	#5	STR.	12' - 5"	26	* D1	318	#5	STR.	7' - 0"	2,322
* A436	2	#5	STR.	11' - 4"	24	D2	318	#5	STR.	6' - 6"	2,156
* A437	2	#5	STR.	10' - 3"	21	* D4	40	#5	STR.	12' - 7"	525
* A438	2	#5	STR.	9' - 2"	19						
* A439	2	#5	STR.	8' - 1"	17	* G2	2	#5	STR.	57' - 4"	120
* A440	2	#5	STR.	7' - 0"	15						
* A441	2	#5	STR.	5' - 11"	12	* J1	140	#4	1	1' - 5"	132
* A442	2	#5	STR.	4' - 10"	10						
* A443	2	#5	STR.	3' - 9"	8	* K3	16	#8	3	25' - 4"	1,082
* A444	2	#5	STR.	2' - 8"	6	* K4	42	#6	STR.	9' - 2"	578
						* K5	28	#4	STR.	9' - 10"	184
A501	2	#5	STR.	49' - 3"	103	* K6	8	#8	2	13' - 10"	295
A502	2	#5	STR.	48' - 2"	100	* K7	8	#8	STR.	9' - 10"	210
A503	2	#5	STR.	47' - 1"	98						
A504	2	#5	STR.	46' - 0"	96	* S1	84	#4	4	6' - 10"	383
A505	2	#5	STR.	44' - 11"	94	* S2	84	#5	5	5' - 10"	511
A506	2	#5	STR.	43' - 10"	91	* S3	56	#5	6	2' - 11"	170
A507	2	#5	STR.	42' - 9"	89						
A508	2	#5	STR.	41' - 8"	87	REINFORCING STEEL			LBS.	17,060	
A509	2	#5	STR.	40' - 7"	85	* EPOXY COATED REINF. STEEL			LBS.	19,169	
A510	2	#5	STR.	39' - 6"	82						

BAR TYPES

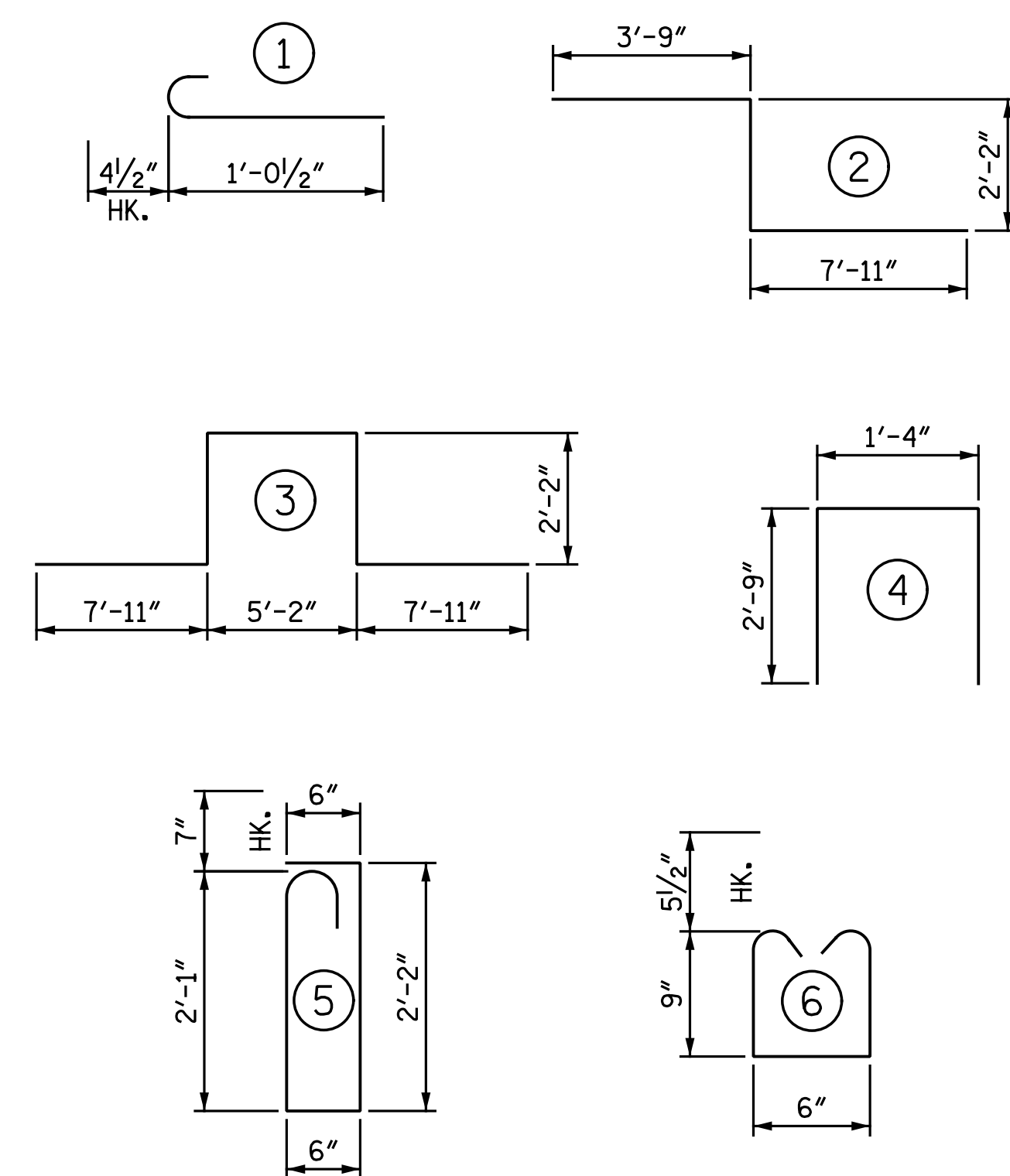

ALL BAR DIMENSIONS ARE OUT TO OUT

— SUPERSTRUCTURE BILL OF MATERIAL —

	CLASS AA CONCRETE (CU. YDS.)	REINFORCING STEEL (LBS.)	EPOXY COATED REINFORCING STEEL (LBS.)
STAGE III	-	17,060	19,169
POUR 5	158.7	-	-
POUR 6	30.0	-	-
CLOSURE POUR 7	43.3	-	-
CLOSURE POUR 8	10.3	-	-
TOTALS **	242.3	17,060	19,169

\*\* QUANTITIES FOR BARRIER RAILS & MEDIAN BARRIER ARE NOT INCLUDED

GROOVING BRIDGE FLOORS	
STAGE III	
APPROACH SLABS	2,694 SQ.FT.
BRIDGE DECK	5,812 SQ.FT.
TOTAL	8,506 SQ.FT.



DOCUMENT NOT CONSIDERED FINAL UNLESS ALL SIGNATURES COMPLETED

Michael Baker INTERNATIONAL

STATE OF NORTH CAROLINA  
 DEPARTMENT OF TRANSPORTATION  
 RALEIGH  
 SUPERSTRUCTURE  
 BILL OF MATERIAL  
 STAGE III

REVISIONS						SHEET NO.
NO.	BY:	DATE:	NO.	BY:	DATE:	
1			3			TOTAL SHEETS
2			4			44

PROJECT NO. I-5986B  
 JOHNSTON COUNTY  
 STATION: 1391+19.65 -L-

SHEET 3 OF 3