

NOTE:
 FOR MAINTENANCE OF TRAFFIC, REMOVAL OF EXISTING PAVEMENT, AND LOCATIONS OF
 TEMPORARY SHORING, TEMPORARY PAVEMENT, AND PORTABLE CONCRETE BARRIERS, SEE
 TRAFFIC CONTROL PLANS.

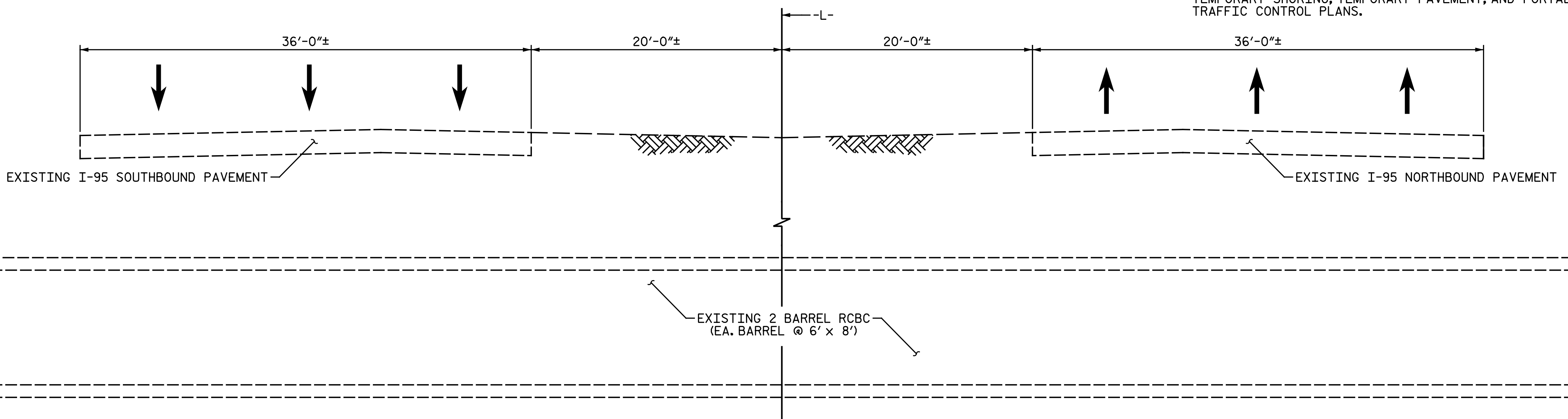

EXISTING

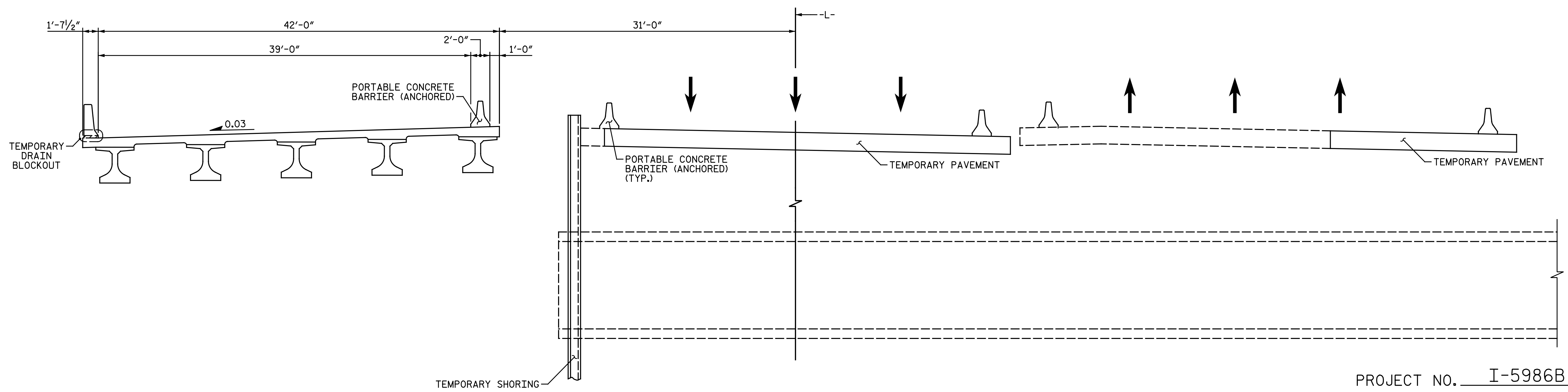

STAGE I

MOVE SOUTHBOUND TRAFFIC INTO I-95 MEDIAN SECTION AND SHIFT NORTHBOUND TRAFFIC.
 REMOVE PORTION OF EXISTING CULVERT BEHIND TEMPORARY SHORING ON LEFT SIDE OF I-95.
 CONSTRUCT LEFT SIDE OF PROPOSED BRIDGE.

PROJECT NO. I-5986B
JOHNSTON COUNTY
 STATION: 1391+19.65 -L-

SHEET 1 OF 3



DocuSigned by:
 Todd M. Garrison
 01EAF7523943466
 4/30/2020

DOCUMENT NOT CONSIDERED FINAL
 UNLESS ALL SIGNATURES COMPLETED

STATE OF NORTH CAROLINA
 DEPARTMENT OF TRANSPORTATION
 RALEIGH

CONSTRUCTION SEQUENCE

DRAWN BY : N. B. SPEAKS DATE : 8-19-19
 CHECKED BY : J. M. GARRISON DATE : 11-7-19

REVISIONS						SHEET NO.
NO.	BY:	DATE:	NO.	BY:	DATE:	S3-6
1			3			TOTAL SHEETS
2			4			44

Michael Baker INTERNATIONAL
 Michael Baker Engineering
 8000 Regency Parkway, Suite 600
 Cary, North Carolina 27518
 NC License No.: F-1084