

PLAN @ END BENT 1 PLAN @ END BENT 2
DIMENSIONS SHOWN ARE TYPICAL FOR BOTH APPROACH SLABS

NOTES

FOR BRIDGE APPROACH FILL INCLUDING GEOTEXTILE, MSE WALL REINFORCEMENT AND BACKFILL MATERIAL SEE ROADWAY PLANS.

GEOTEXTILE SHALL BE TYPE 1 IN ACCORDANCE WITH THE STANDARD SPECIFICATIONS SECTION 1056.

BACKFILL MATERIAL SHALL BE THE SAME MATERIAL USED IN THE MSE REINFORCED ZONE.

APPROACH SLAB SHALL NOT BE CONSTRUCTED PRIOR TO COMPLETION OF THE BRIDGE DECK.

THE JOINT SHALL BE SAWS PRIOR TO THE CASTING OF THE BARRIER RAIL.

AREA BETWEEN THE WINGWALL AND APPROACH SLAB SHALL BE GRADED TO DRAIN THE WATER AWAY FROM THE FILL FACE OF THE BRIDGE AND SHALL BE PAVED. SEE ROADWAY PLANS.

WITH FOAM JOINT SEAL

FOR FOAM JOINT SEALS, SEE SPECIAL PROVISIONS.

THE NOMINAL UNCOMPRESSED SEAL WIDTH OF THE FOAM JOINT SEAL SHALL BE 2".

FOR ELASTOMERIC CONCRETE, SEE SPECIAL PROVISIONS.

BILL OF MATERIAL

APPROACH SLAB AT END BENT 1					
BAR	NO.	SIZE	TYPE	LENGTH	WEIGHT
* A1	15	#4	STR.	36' - 4"	364
A2	16	#4	STR.	36' - 4"	388
* B1	62	#5	STR.	13' - 5"	868
B2	62	#6	STR.	14' - 7"	1,358
REINFORCING STEEL				LBS.	1,746
* EPOXY COATED REINFORCING STEEL				LBS.	1,232
CLASS AA CONCRETE				C.Y.	20.5

APPROACH SLAB AT END BENT 2					
BAR	NO.	SIZE	TYPE	LENGTH	WEIGHT
* A1	15	#4	STR.	36' - 4"	364
A2	16	#4	STR.	36' - 4"	388
* B1	62	#5	STR.	13' - 5"	868
B2	62	#6	STR.	14' - 7"	1,358
REINFORCING STEEL				LBS.	1,746
* EPOXY COATED REINFORCING STEEL				LBS.	1,232
CLASS AA CONCRETE				C.Y.	20.5

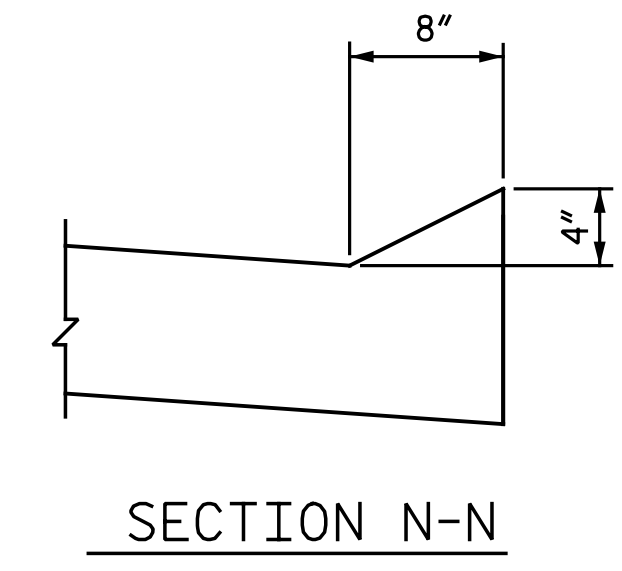
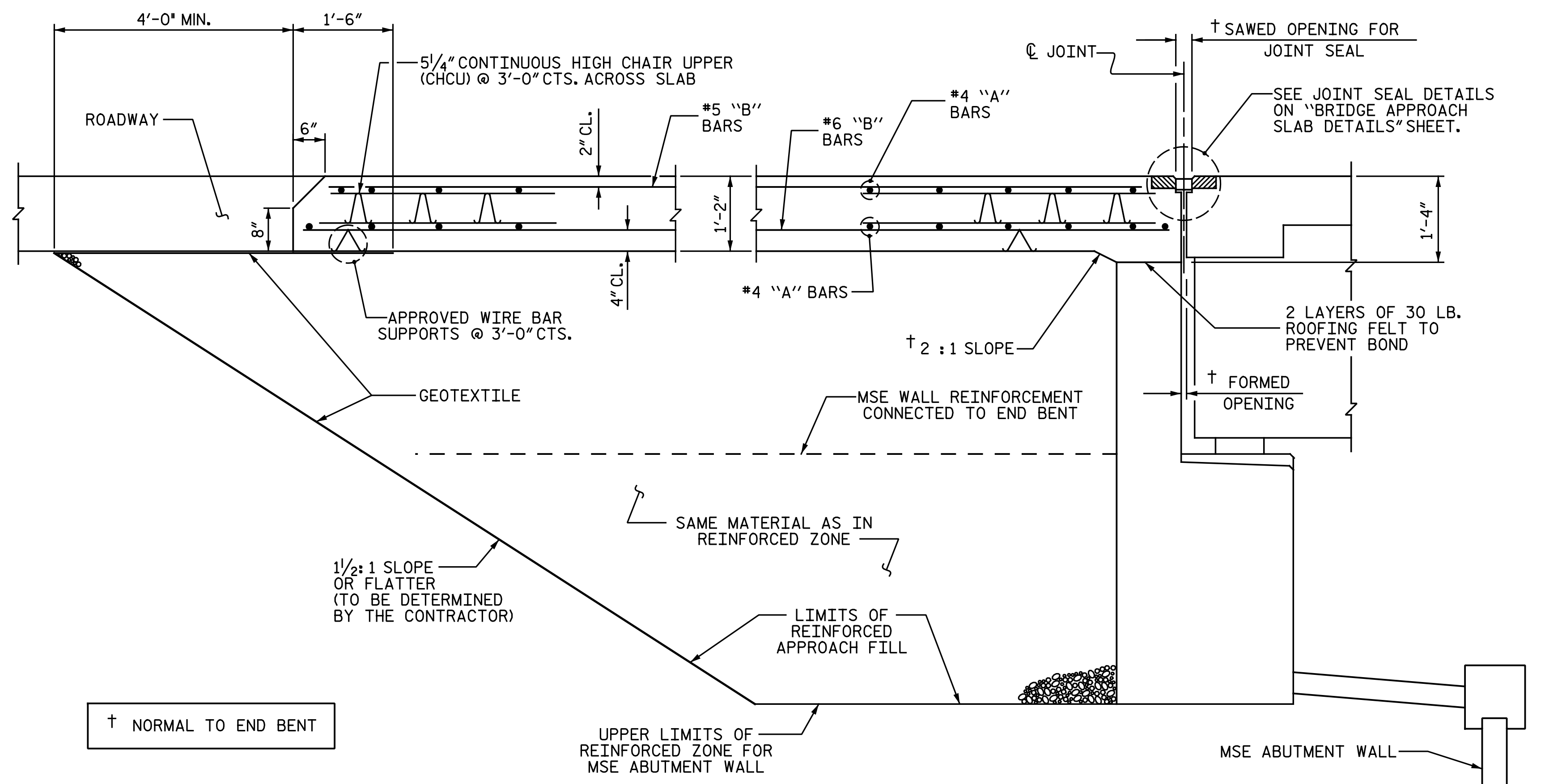

SECTION THRU SLAB
(TYPE III - REINFORCED APPROACH FILL)

PROJECT NO. I-5986B
JOHNSTON COUNTY
STATION: 28+39.21 -Y29-



STATE OF NORTH CAROLINA
DEPARTMENT OF TRANSPORTATION
RALEIGH
STANDARD
BRIDGE APPROACH SLAB
FOR FLEXIBLE PAVEMENT

ASSEMBLED BY : N.B. SPEAKS	DATE : 6-27-19
CHECKED BY : V. A. PATEL	DATE : 8-1-19
DRAWN BY : EEM 3/95	REV. 12/21/11 MAA/GM
CHECKED BY : VAP 3/95	REV. 6/13 MAA/GM
	REV. 12/17 MAA/THC

DOCUMENT NOT CONSIDERED FINAL
UNLESS ALL SIGNATURES COMPLETED

Michael Baker INTERNATIONAL
Michael Baker Engineering
8000 Regency Parkway, Suite 600
Cary, North Carolina 27518
NC License No. : F-1084

REVISIONS						SHEET NO.
NO.	BY:	DATE:	NO.	BY:	DATE:	
1			3			TOTAL SHEETS
2			4			28