

LAYOUT FOR COMPUTING AREA OF REINFORCED CONCRETE DECK SLAB (SQ. FT. = 6,486)

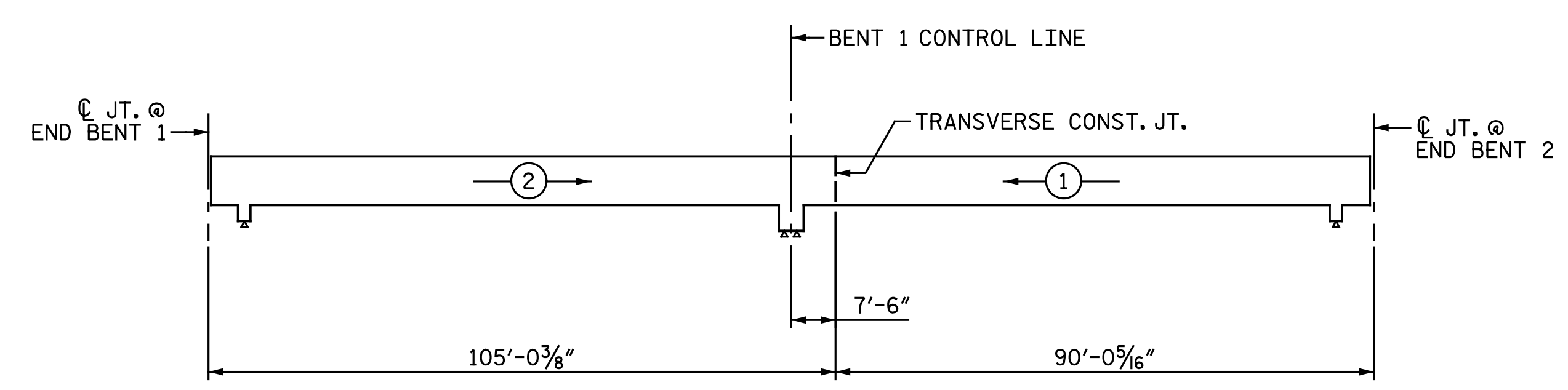

POURING SEQUENCE
② → DENOTES POUR NUMBER AND DIRECTION

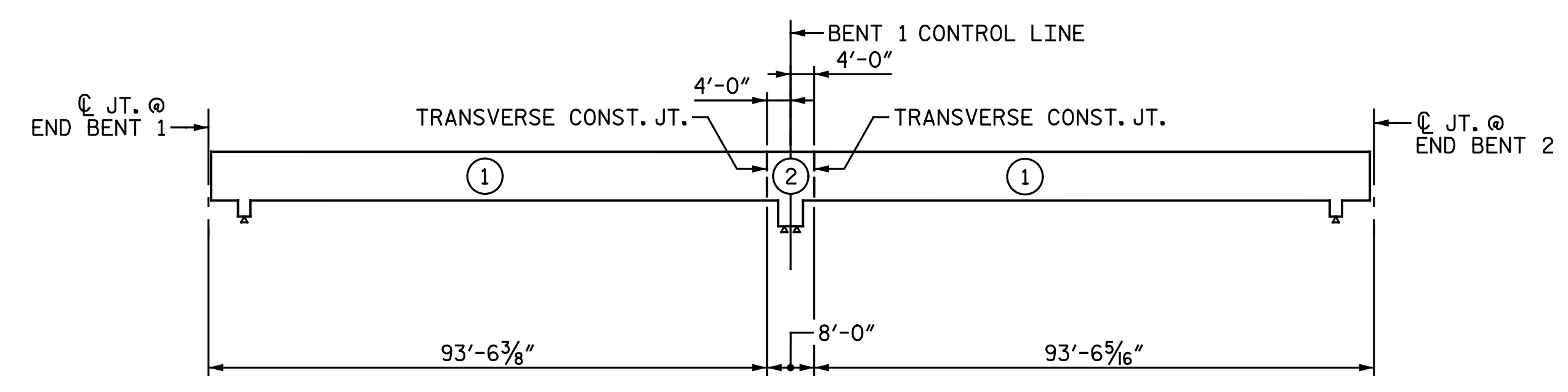

OPTIONAL POURING SEQUENCE
② DENOTES POUR NUMBER

REINFORCING BAR SCHEDULE											
SPANS A & B						SPANS A & B CONT'D.					
BAR	NO.	SIZE	TYPE	LENGTH	WEIGHT	BAR	NO.	SIZE	TYPE	LENGTH	WEIGHT
*A1	349	#5	STR.	32' - 11"	11,982	*B1	92	#4	STR.	34' - 0"	2,090
A2	349	#5	STR.	32' - 11"	11,982	B2	172	#5	STR.	50' - 4"	9,030
*A3	8	#6	STR.	38' - 7"	464	*B3	69	#6	STR.	24' - 6"	2,539
						*B4	44	#6	STR.	35' - 4"	2,335
*A101	2	#5	STR.	31' - 7"	66	*G1	2	#5	STR.	38' - 7"	80
*A102	2	#5	STR.	30' - 9"	64						
*A103	2	#5	STR.	29' - 11"	62						
*A104	2	#5	STR.	29' - 1"	61	*K1	8	#8	1	15' - 6"	331
*A105	2	#5	STR.	28' - 3"	59	*K2	8	#8	2	23' - 5"	500
*A106	2	#5	STR.	27' - 5"	57	*K3	12	#5	STR.	7' - 10"	98
*A107	2	#5	STR.	26' - 8"	56	*K4	18	#6	STR.	7' - 10"	212
*A108	2	#5	STR.	25' - 10"	54	K5	6	#4	STR.	7' - 10"	31
*A109	2	#5	STR.	25' - 0"	52	K6	12	#4	STR.	9' - 1"	73
*A110	2	#5	STR.	24' - 2"	50	K7	6	#4	STR.	8' - 6"	34
*A111	2	#5	STR.	23' - 4"	49	K8	6	#4	STR.	5' - 11"	24
*A112	2	#5	STR.	22' - 7"	47	K9	10	#4	3	6' - 5"	43
*A113	2	#5	STR.	21' - 9"	45	K10	10	#4	4	12' - 6"	84
*A114	2	#5	STR.	20' - 11"	44	K11	16	#4	STR.	3' - 8"	39
*A115	2	#5	STR.	20' - 1"	42						
*A116	2	#5	STR.	19' - 3"	40	*S1	48	#4	5	5' - 1"	163
*A117	2	#5	STR.	18' - 6"	39	*S2	48	#5	6	6' - 0"	300
*A118	2	#5	STR.	17' - 8"	37	*S3	84	#4	7	3' - 1"	173
*A119	2	#5	STR.	16' - 10"	35						
*A120	2	#5	STR.	16' - 0"	33	U1	18	#4	8	14' - 0"	168
*A121	2	#5	STR.	15' - 2"	32	U2	6	#4	5	7' - 0"	28
*A122	2	#5	STR.	14' - 4"	30						
*A123	2	#5	STR.	13' - 7"	28						
*A124	2	#5	STR.	12' - 9"	27						
*A125	2	#5	STR.	11' - 11"	25						
*A126	2	#5	STR.	11' - 1"	23						
*A127	2	#5	STR.	10' - 3"	21						
*A128	2	#5	STR.	9' - 6"	20						
*A129	2	#5	STR.	8' - 8"	18						
*A130	2	#5	STR.	7' - 10"	16						
*A131	2	#5	STR.	7' - 0"	15						
*A132	2	#5	STR.	6' - 2"	13						
*A133	2	#5	STR.	5' - 5"	11						
*A134	2	#5	STR.	4' - 7"	10						
*A135	2	#5	STR.	3' - 9"	8						
*A136	2	#5	STR.	2' - 11"	6						
*A137	2	#5	STR.	2' - 1"	4						
A201	2	#5	STR.	31' - 7"	66						
A202	2	#5	STR.	30' - 9"	64						
A203	2	#5	STR.	29' - 11"	62						
A204	2	#5	STR.	29' - 1"	61						
A205	2	#5	STR.	28' - 3"	59						
A206	2	#5	STR.	27' - 5"	57						
A207	2	#5	STR.	26' - 8"	56						
A208	2	#5	STR.	25' - 10"	54						
A209	2	#5	STR.	25' - 0"	52						
A210	2	#5	STR.	24' - 2"	50						
A211	2	#5	STR.	23' - 4"	49						
A212	2	#5	STR.	22' - 7"	47						
A213	2	#5	STR.	21' - 9"	45						
A214	2	#5	STR.	20' - 11"	44						
A215	2	#5	STR.	20' - 1"	42						
A216	2	#5	STR.	19' - 3"	40						
A217	2	#5	STR.	18' - 6"	39						
A218	2	#5	STR.	17' - 8"	37						
A219	2	#5	STR.	16' - 10"	35						
A220	2	#5	STR.	16' - 0"	33						
A221	2	#5	STR.	15' - 2"	32						
A222	2	#5	STR.	14' - 4"	30						
A223	2	#5	STR.	13' - 7"	28						
A224	2	#5	STR.	12' - 9"	27						
A225	2	#5	STR.	11' - 11"	25						
A226	2	#5	STR.	11' - 1"	23						
A227	2	#5	STR.	10' - 3"	21						
A228	2	#5	STR.	9' - 6"	20						
A229	2	#5	STR.	8' - 8"	18						
A230	2	#5	STR.	7' - 10"	16						
A231	2	#5	STR.	7' - 0"	15						
A232	2	#5	STR.	6' - 2"	13						
A233	2	#5	STR.	5' - 5"	11						
A234	2	#5	STR.	4' - 7"	10						
A235	2	#5	STR.	3' - 9"	8						
A236	2	#5	STR.	2' - 11"	6						
A237	2	#5	STR.	2' - 1"	4						

GROOVING BRIDGE FLOORS	
APPROACH SLABS	728 SQ.FT.
BRIDGE DECK	5,224 SQ.FT.
TOTAL	5,952 SQ.FT.

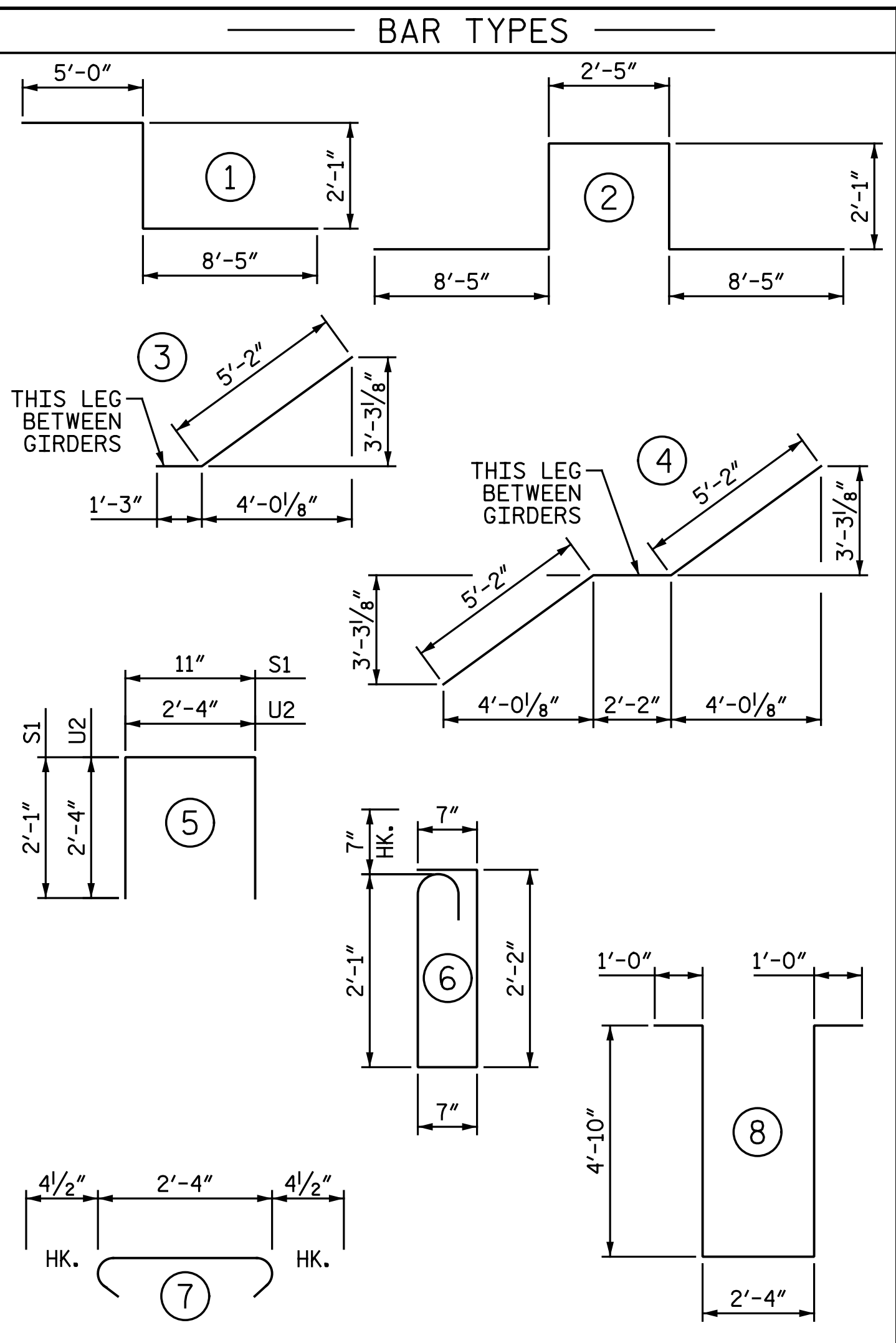

ALL BAR DIMENSIONS ARE OUT TO OUT

SUPERSTRUCTURE BILL OF MATERIAL			
	CLASS AA CONCRETE	REINFORCING STEEL	EPOXY COATED REINFORCING STEEL
	(CU. YDS.)	(LBS.)	(LBS.)
SPANS A & B		23,008	22,393
POUR 1	95.7		
POUR 2	122.7		
TOTALS **	218.4	23,008	22,393

** QUANTITIES FOR BARRIER RAIL ARE NOT INCLUDED

PROJECT NO. I-5986B
JOHNSTON COUNTY
STATION: 28+39.21 -Y29-

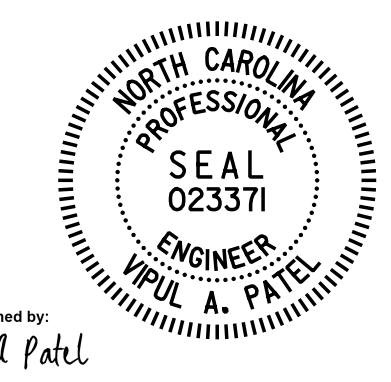

DocuSigned by:
Vipul A Patel
4/13/2020

DOCUMENT NOT CONSIDERED FINAL
UNLESS ALL SIGNATURES COMPLETED

Michael Baker International
Michael Baker Engineering
8000 Regency Parkway, Suite 600
Cary, North Carolina 27518
NC License No.: F-1084

STATE OF NORTH CAROLINA
DEPARTMENT OF TRANSPORTATION
RALEIGH
SUPERSTRUCTURE
BILL OF MATERIAL

REVISIONS						SHEET NO.
NO.	BY:	DATE:	NO.	BY:	DATE:	S2-17
1			3			TOTAL SHEETS
2			4			28

DRAWN BY: C. E. MAYHEW DATE: 12-7-19
CHECKED BY: V. A. PATEL DATE: 12-30-19