

POURING SEQUENCE
 ⊕ DENOTES POUR NUMBER AND DIRECTION

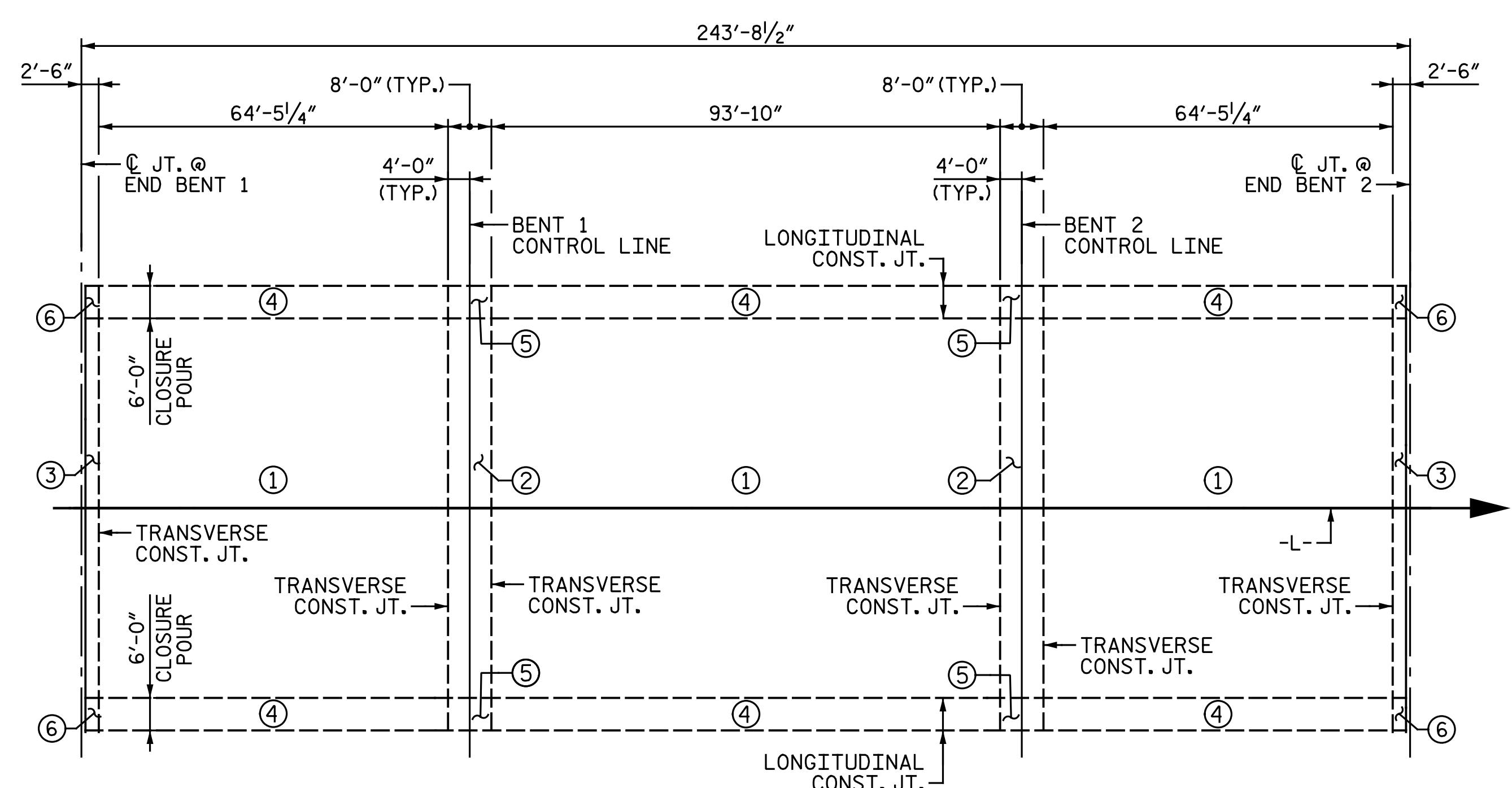

OPTIONAL POURING SEQUENCE
 ⊕ DENOTES POUR NUMBER

| GROOVING BRIDGE FLOORS | |
|------------------------|----------------------|
| STAGE II | |
| APPROACH SLABS | 3,667 SQ.FT. |
| BRIDGE DECK | 18,676 SQ.FT. |
| TOTAL | 22,343 SQ.FT. |

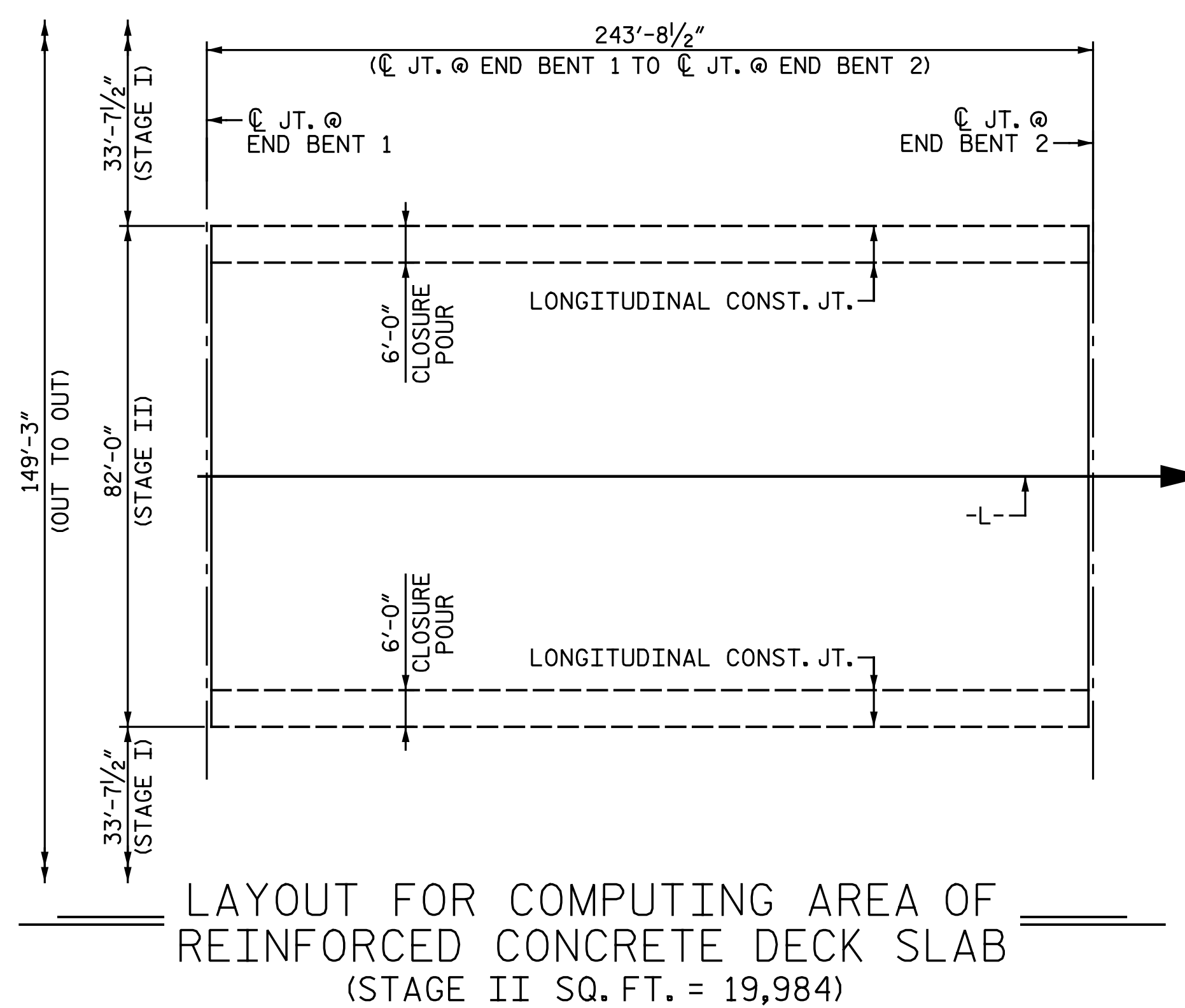

LAYOUT FOR COMPUTING AREA OF REINFORCED CONCRETE DECK SLAB
 (STAGE II SQ. FT. = 19,984)

| REINFORCING BAR SCHEDULE | | | | | |
|----------------------------|-----|------|------|-----------|--------|
| STAGE II | | | | | |
| BAR | NO. | SIZE | TYPE | LENGTH | WEIGHT |
| *A3 | 778 | #5 | STR. | 36' - 1" | 29,280 |
| A4 | 778 | #5 | STR. | 35' - 11" | 29,145 |
| *B1 | 232 | #4 | STR. | 24' - 4" | 3,771 |
| B2 | 380 | #5 | STR. | 50' - 5" | 19,982 |
| *B3 | 232 | #5 | STR. | 32' - 1" | 7,763 |
| *B4 | 216 | #6 | STR. | 40' - 8" | 13,194 |
| *B5 | 58 | #4 | STR. | 34' - 8" | 1,343 |
| *D1 | 778 | #5 | STR. | 7' - 0" | 5,680 |
| D2 | 778 | #5 | STR. | 6' - 6" | 5,274 |
| D3 | 20 | #4 | STR. | 8' - 6" | 114 |
| *G2 | 4 | #5 | STR. | 36' - 1" | 151 |
| *J1 | 164 | #4 | 1 | 1' - 5" | 155 |
| *K2 | 24 | #8 | 3 | 22' - 7" | 1,447 |
| *K3 | 8 | #8 | 2 | 12' - 9" | 272 |
| *K4 | 36 | #5 | STR. | 8' - 7" | 322 |
| K5 | 36 | #4 | STR. | 5' - 2" | 124 |
| K6 | 72 | #4 | STR. | 8' - 6" | 409 |
| K7 | 36 | #4 | STR. | 7' - 2" | 172 |
| K8 | 36 | #4 | STR. | 4' - 3" | 102 |
| K10 | 20 | #4 | STR. | 34' - 7" | 462 |
| *K11 | 8 | #8 | STR. | 8' - 7" | 183 |
| *S1 | 90 | #5 | 5 | 5' - 10" | 548 |
| *S2 | 108 | #5 | 6 | 3' - 5" | 385 |
| S3 | 540 | #4 | 7 | 2' - 9" | 992 |
| U1 | 90 | #4 | 3 | 12' - 6" | 752 |
| U2 | 72 | #4 | 4 | 5' - 10" | 281 |
| U3 | 36 | #4 | 4 | 4' - 2" | 100 |
| REINFORCING STEEL | | | | LBS. | 57,909 |
| *EPOXY COATED REINF. STEEL | | | | LBS. | 64,494 |

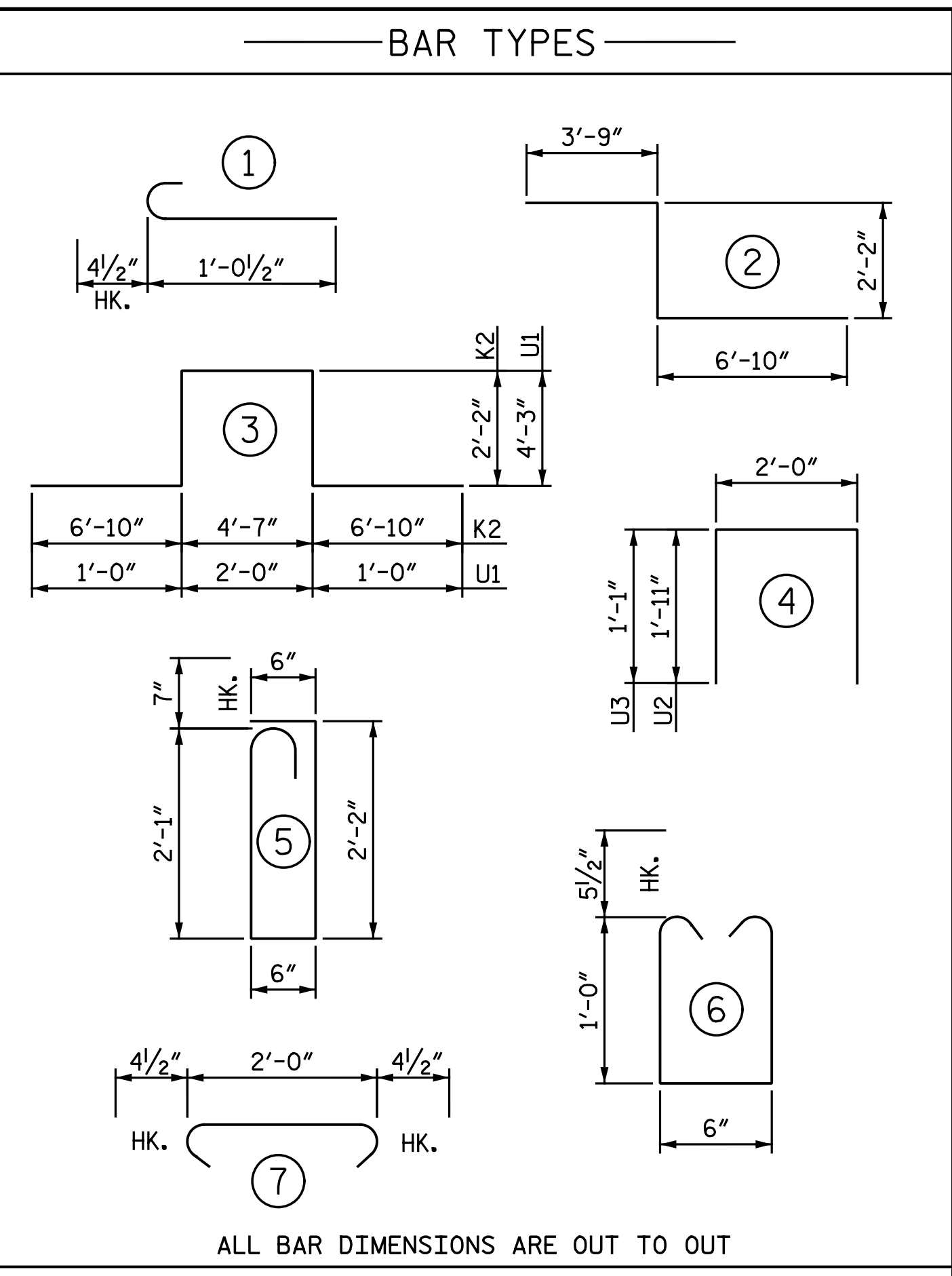

ALL BAR DIMENSIONS ARE OUT TO OUT

| SUPERSTRUCTURE BILL OF MATERIAL | | | |
|---------------------------------|---------------------------------|-----------------------------|--|
| | CLASS AA CONCRETE (CU. YDS.) | REINFORCING STEEL (LBS.) | EPOXY COATED REINFORCING STEEL (LBS.) |
| STAGE II | - | 57,909 | 64,494 |
| POUR 5 | 144.9 | - | - |
| POUR 6 | 258.2 | - | - |
| POUR 7 | 194.9 | - | - |
| POUR 8 | 20.3 | - | - |
| CLOSURE POUR 9 | 28.2 | - | - |
| CLOSURE POUR 10 | 52.6 | - | - |
| CLOSURE POUR 11 | 40.3 | - | - |
| CLOSURE POUR 12 | 4.7 | - | - |
| TOTALS** | 744.1 | 57,909 | 64,494 |

** QUANTITIES FOR BARRIER RAILS & MEDIAN BARRIER ARE NOT INCLUDED

PROJECT NO. I-5986B
JOHNSTON COUNTY
 STATION: 1260+34.00 -L-

SHEET 2 OF 2

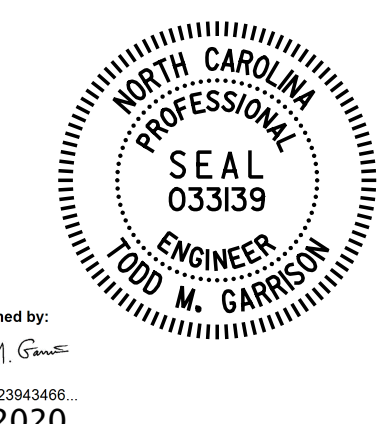

DOCUMENT NOT CONSIDERED FINAL
 UNLESS ALL SIGNATURES COMPLETED



STATE OF NORTH CAROLINA
 DEPARTMENT OF TRANSPORTATION
 RALEIGH
 SUPERSTRUCTURE
 BILL OF MATERIAL
 STAGE II

| REVISIONS | | | | | | SHEET NO. |
|-----------|-----|-------|-----|-----|-------|--------------|
| NO. | BY: | DATE: | NO. | BY: | DATE: | SI-37 |
| 1 | | | 3 | | | TOTAL SHEETS |
| 2 | | | 4 | | | 57 |

DRAWN BY: C. E. MAYHEW DATE: 10-30-19
 CHECKED BY: J. M. GARRISON DATE: 11-4-19