

AT END BENT DIAPHRAGMS

TYPICAL SECTION

STAGE II (LEFT HALF)
(DIAPHRAGM REINFORCEMENT DENOTED AS TYP. EA. BAY ALSO TYP. EA. CLOSURE POUR BAY)

AT BENT DIAPHRAGMS

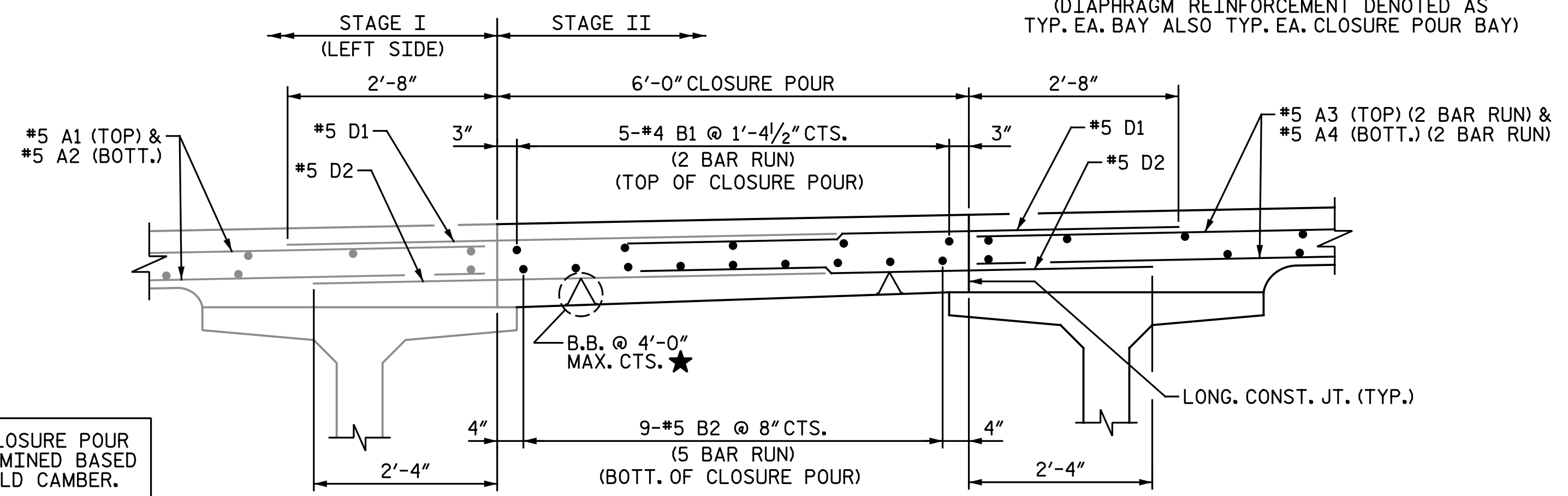

CLOSURE POUR AT END BENT DIAPHRAGMS

(DIAPHRAGM AND DIAPHRAGM REINFORCEMENT IN CLOSURE POUR BAY NOT SHOWN FOR CLARITY)
(CLOSURE POUR BETWEEN STAGE I RIGHT SIDE AND STAGE II SIMILAR)
(CLOSURE POUR IN SPAN B NEAR MIDSPAN SIMILAR EXCEPT #4 B5 BARS IN TOP OF CLOSURE POUR)
(FOR "CLOSURE POUR AT BENT DIAPHRAGMS" DETAIL, SEE SHEET 4 OF 5)
(DOWELS SHALL BE SPLICED TO TOP AND BOTTOM SLAB REINFORCING STEEL)

★ B.B. HEIGHT IN CLOSURE POUR BAY TO BE DETERMINED BASED ON MEASURED FIELD CAMBER.

DRAWN BY : P. SMITH DATE : 4-24-19
CHECKED BY : T.M. GARRISON DATE : 3-11-20



DocuSigned by:
Todd M. Garrison
4/21/2020

DOCUMENT NOT CONSIDERED FINAL
UNLESS ALL SIGNATURES COMPLETED

REVISIONS		SHEET NO.	
NO.	BY:	DATE:	NO.
1			SI-9
2			TOTAL SHEETS
			57

PROJECT NO. I-5986B
JOHNSTON COUNTY
STATION: 1260+34.00 -L-
SHEET 3 OF 5

STATE OF NORTH CAROLINA
DEPARTMENT OF TRANSPORTATION
RALEIGH

SUPERSTRUCTURE
TYPICAL SECTION
STAGE II
(LEFT HALF)