

NOTES:

PROVIDE 1/4" HIGH BEAM BOLSTERS UPPER AT 4'-0" CTS. ATOP THE METAL STAY-IN-PLACE FORMS TO SUPPORT THE BOTTOM MAT OF "A" BARS. WHEN USING REMOVABLE FORMS, PROVIDE CONTINUOUS HIGH CHAIRS FOR METAL DECK (C.H.C.M.) @ 4'-0" CTS. WITH A HEIGHT TO SUPPORT THE BOTTOM MAT OF "A" BARS A CLEAR DISTANCE OF 2 1/2" ABOVE THE TOP OF THE REMOVABLE FORM.

LONGITUDINAL STEEL MAY BE SHIFTED SLIGHTLY, AS NECESSARY, TO AVOID INTERFERENCE WITH STIRRUPS IN PRESTRESSED CONCRETE BEAMS AND TO FACILITATE INSTALLATION OF CONCRETE BARRIER RAIL AND CONCRETE MEDIAN BARRIER REINFORCEMENT.

FOR CONCRETE BARRIER RAIL DETAILS, INCLUDING TEMPORARY DRAIN BLOCKOUTS, SEE "CONCRETE BARRIER RAIL" SHEET.

FOR CONCRETE MEDIAN BARRIER DETAILS, SEE "CONCRETE MEDIAN BARRIER" SHEET.

PREVIOUSLY CAST CONCRETE IN A CONTINUOUS UNIT SHALL HAVE ATTAINED A MINIMUM COMPRESSIVE STRENGTH OF 3,000 PSI BEFORE ADDITIONAL CONCRETE IS CAST IN THE UNIT.

SEE TRAFFIC CONTROL PLANS FOR LOCATIONS AND PAY LIMITS OF THE ANCHORED PORTABLE CONCRETE BARRIERS.

AT END BENT DIAPHRAGMS
 AT BENT DIAPHRAGMS
TYPICAL SECTION
 STAGE I (LEFT SIDE)

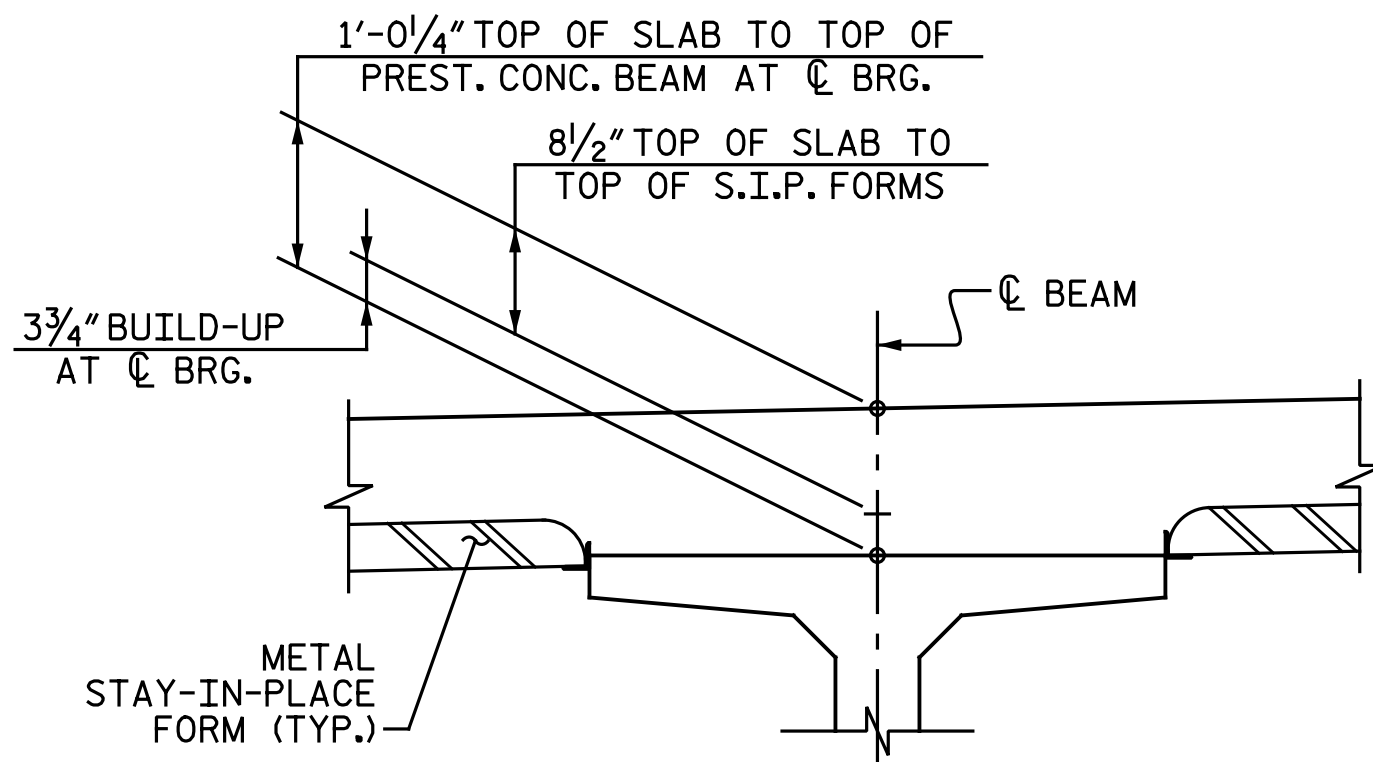

DETAIL "A"

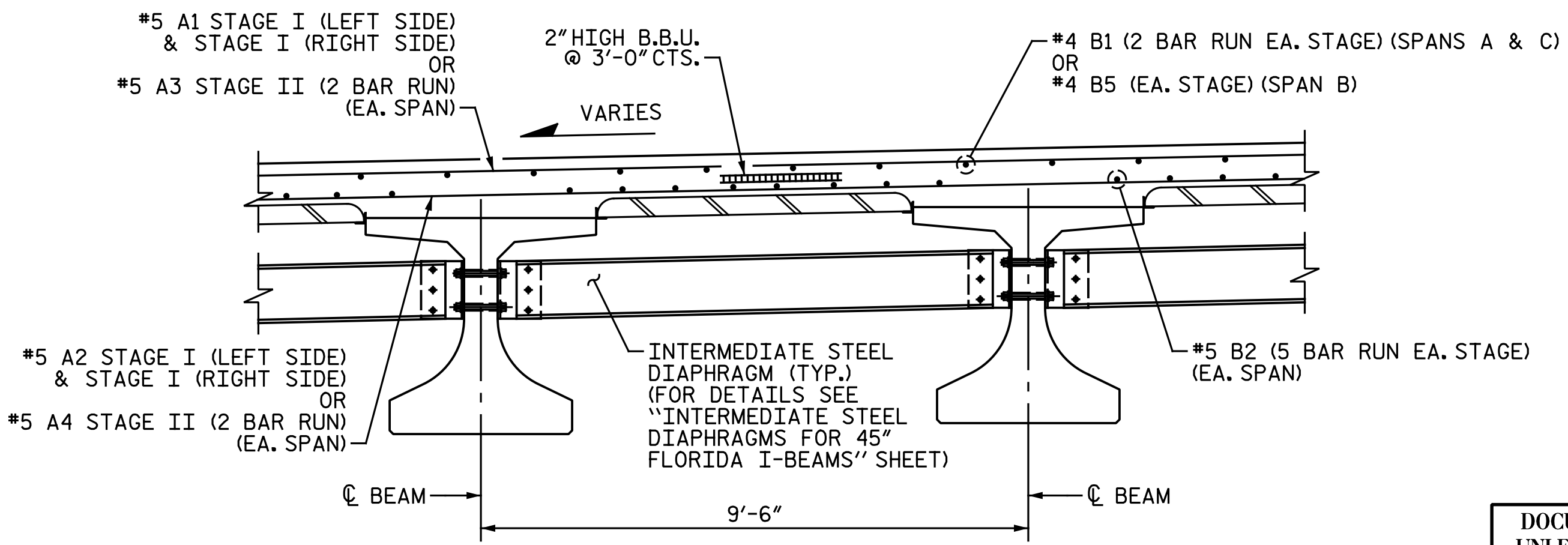

PARTIAL TYPICAL SECTION
 AT INTERMEDIATE DIAPHRAGMS

PROJECT NO. I-5986B
JOHNSTON COUNTY
 STATION: 1260+34.00 -L-
 SHEET 1 OF 5

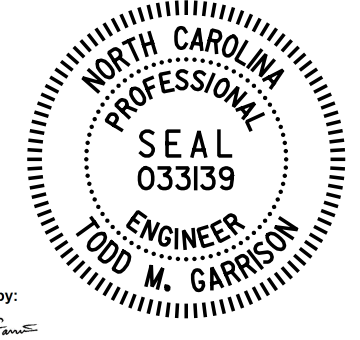

DOCUMENT NOT CONSIDERED FINAL
 UNLESS ALL SIGNATURES COMPLETED

REVISIONS						SHEET NO.
NO.	BY:	DATE:	NO.	BY:	DATE:	SI-7
1			3			TOTAL SHEETS
2			4			57

DRAWN BY: P. SMITH DATE: 4-23-19
 CHECKED BY: I.M. GARRISON DATE: 4-26-19

Michael Baker International
 Michael Baker Engineering
 8000 Regency Parkway, Suite 600
 Cary, North Carolina 27518
 NC License No.: F-1084