

PROJECT REFERENCE NO. 1-5883	SHEET NO. EC-97/CONST.31
RW SHEET NO.	
ROADWAY DESIGN ENGINEER	HYDRAULICS ENGINEER
FINAL GRADING EROSION CONTROL FOR CONSTRUCTION SHEET 31	

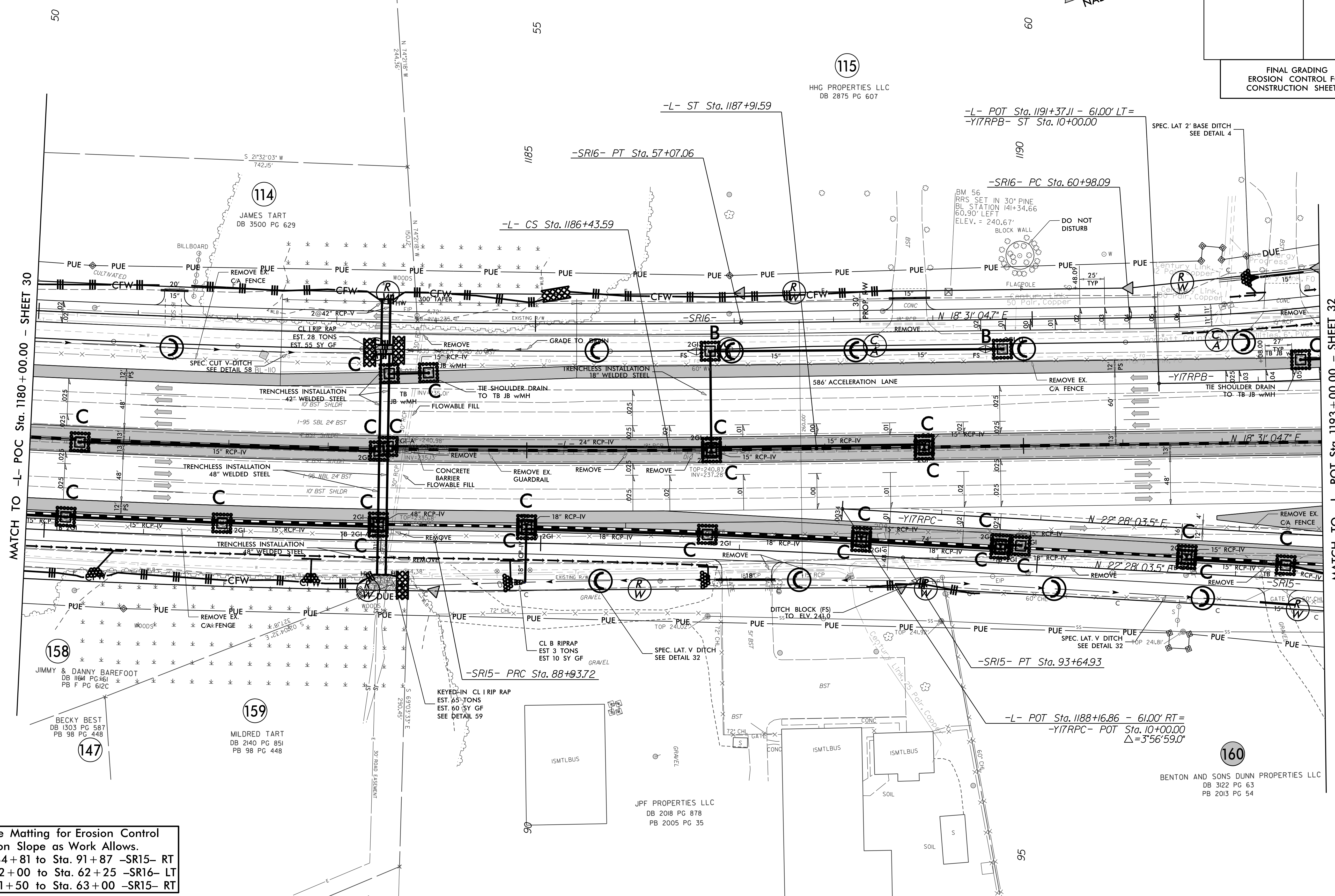
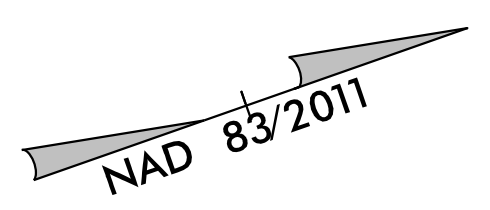

Place Matting for Erosion Control
on Slope as Work Allows.
Sta. 84+81 to Sta. 91+87 -SR15- RT
Sta. 62+00 to Sta. 62+25 -SR16- LT
Sta. 61+50 to Sta. 63+00 -SR15- RT

NOTE: DRIVEWAY RADII = 10'
UNLESS SHOWN OTHERWISE

MATCH TO -L- POC Sta. 1180+00.00 - SHEET 30

MATCH TO -L- POT Sta. 1193+00.00 - SHEET 32