

| | |
|-------------------------|---------------------|
| PROJECT REFERENCE NO. | SHEET NO. |
| 1-5878 | EC-69A/CONST.2B-15 |
| RW SHEET NO. | |
| ROADWAY DESIGN ENGINEER | HYDRAULICS ENGINEER |

DETOUR
EROSION CONTROL FOR
CONSTRUCTION SHEET 2B-15

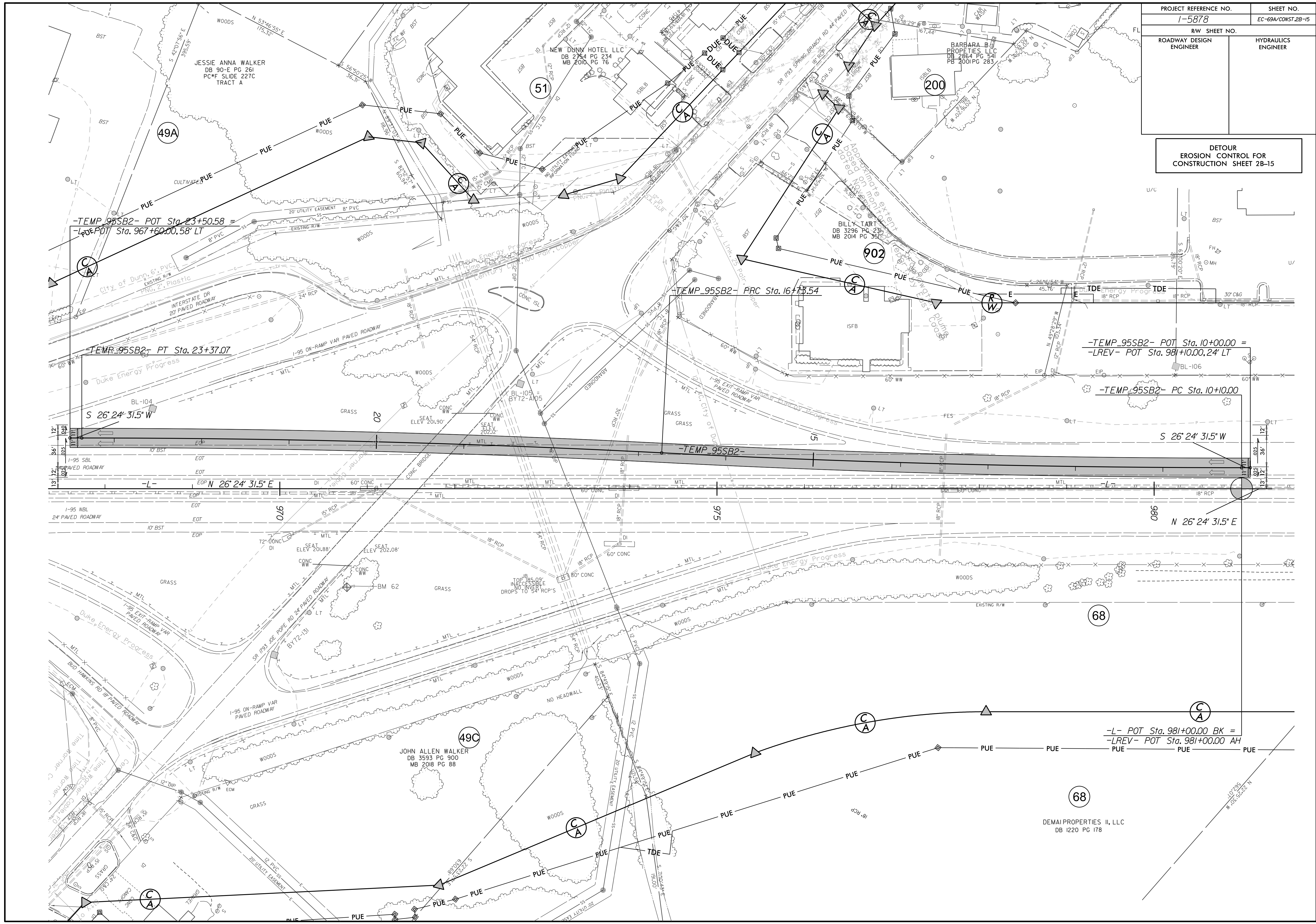

68
DEMAI PROPERTIES II, LLC
DB I220 PG 178

49C
JOHN ALLEN WALKER
DB 3593 PG 900
MB 2018 PG 88

49A
JESSIE ANNA WALKER
DB 90-E PG 261
PC*F SLIDE 227C
TRACT A

51
NEW DUNN HOTEL LLC
DB 2754 PG 234
MB 2010 PG 76

200
BARBARA B
PROPERTIES LLC
DB 2864 PG 541
PB 2001 PG 283

902
BILLY TART
DB 3296 PG 231
MB 2014 PG 351

68

49C

68