

PROJECT REFERENCE NO.	SHEET NO.
1-5878	EC-56/CONST.56
RW SHEET NO.	
ROADWAY DESIGN ENGINEER	HYDRAULICS ENGINEER
CLEARING AND GRUBBING EROSION CONTROL FOR CONSTRUCTION SHEET 56	

NOTE:
UTILIZE FABRIC INSERT INLET PROTECTION DEVICES IN LIEU OF
ROCK INLET SEDIMENT TRAPS, TYPE-C AS DIRECTED TO AVOID
IMPOUNDMENT OF RUNOFF IN ROADWAY OPEN TO TRAFFIC.

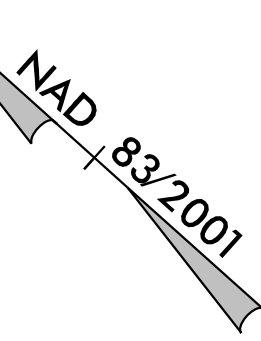
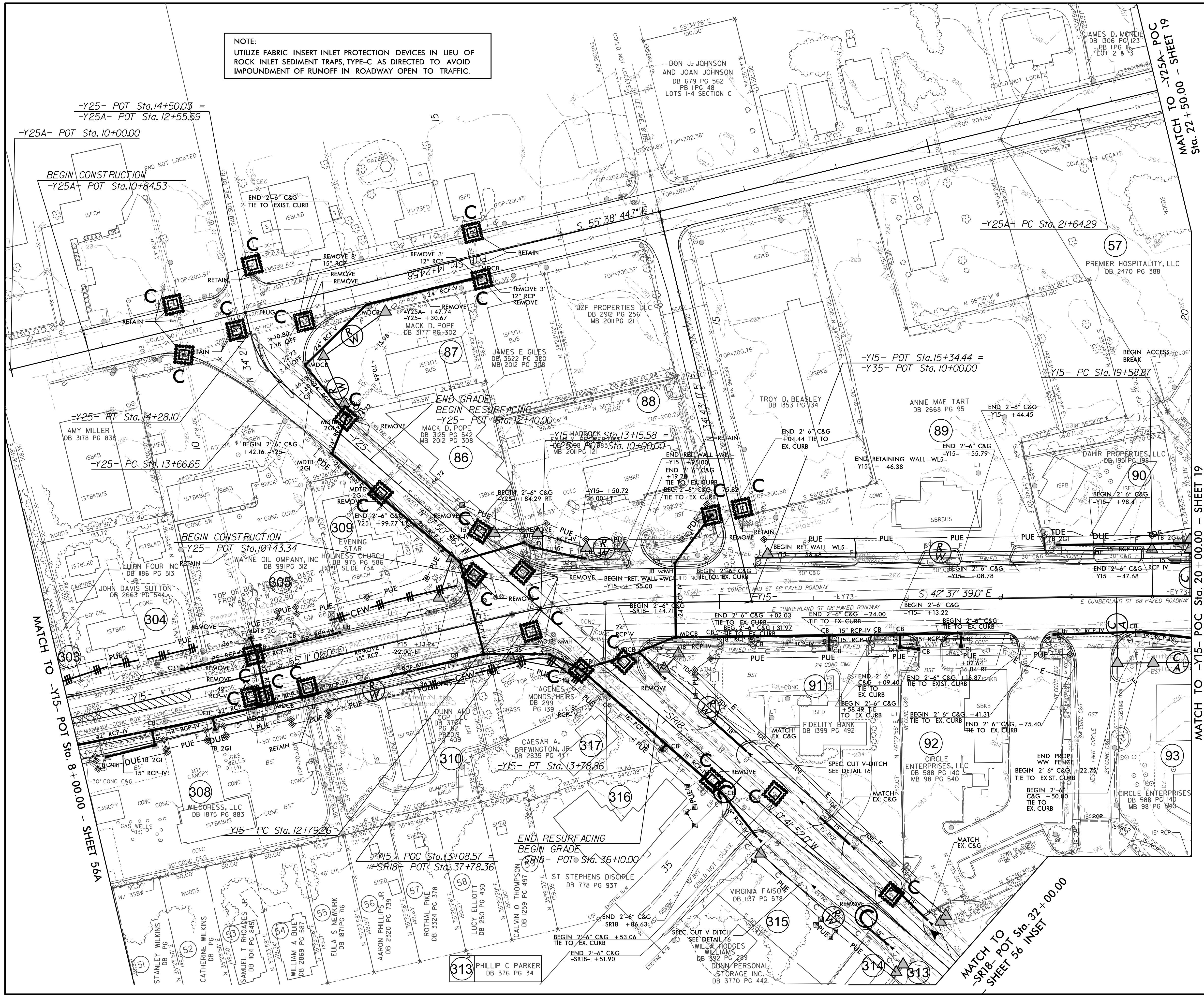

NOTE: DRIVEWAY RADII = 10'
UNLESS SHOWN OTHERWISE