

DOCUMENT NOT CONSIDERED FINAL UNLESS ALL SIGNATURES COMPLETED

Michael Baker
INTERNATIONAL

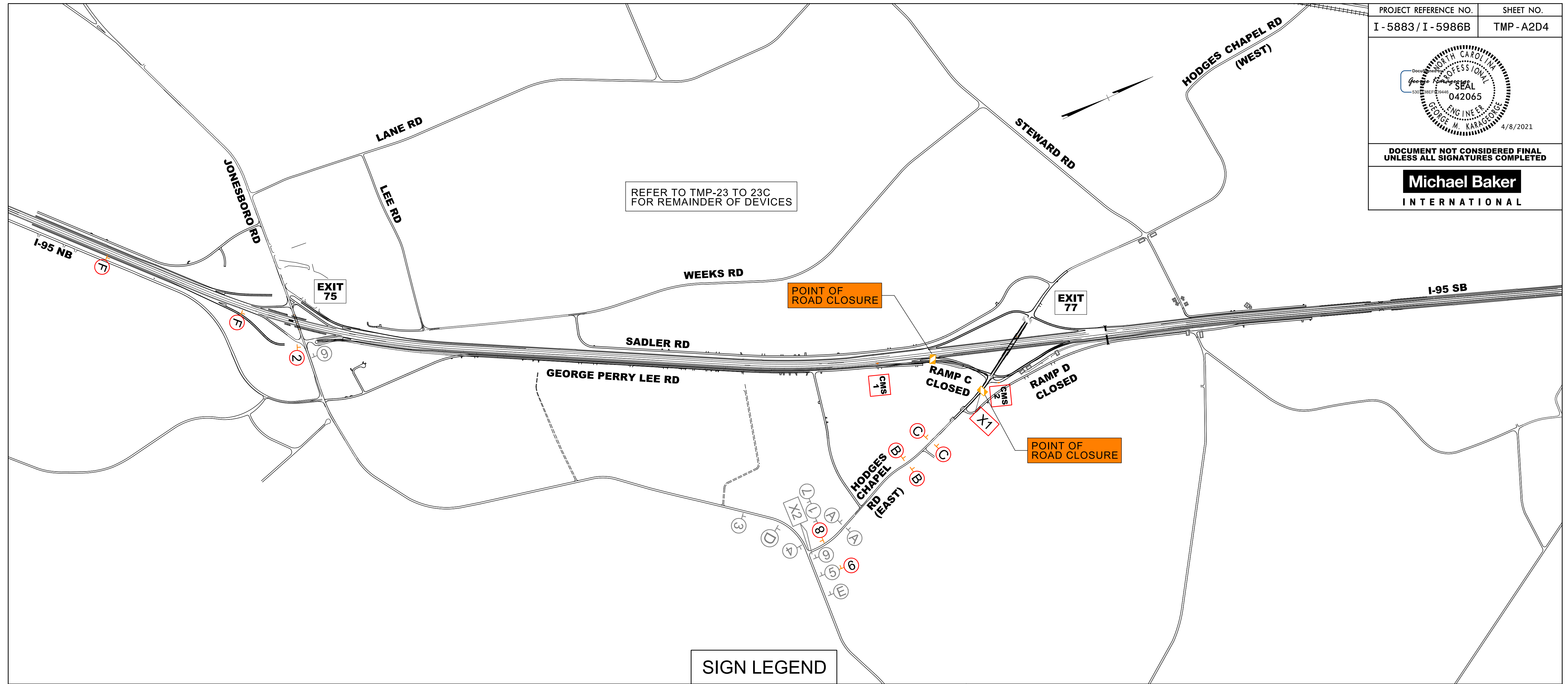

SIGN LEGEND

A W20-3 48" X 48"	B W20-3 48" X 48"	C W20-3 48" X 48"	D W20-3 48" X 48" SP-4L 48" X 12"	E W20-3 48" X 48" SP-4R 48" X 12"	F SP-04 COVER CARDINAL DIRECTION
1 M4-5 24" X 12" M3-4 24" X 12" M6-1 21" X 15"	2 M4-5 24" X 12" M3-4 24" X 12" M3-2 24" X 12" M6-1L 21" X 15" M6-1 21" X 15"	3 HODGES CHAPEL RD EAST M3-2 24" X 12" M4-8 24" X 12" M5-1 21" X 15"	4 HODGES CHAPEL RD EAST M3-2 24" X 12" M4-8 24" X 12" M6-1L 21" X 15"	5 TO M4-5 24" X 12" SOUTH M3-3 24" X 12" INTERSTATE 95 M1-1 24" X 24" M6-3 21" X 15"	6 TO M4-5 24" X 12" NORTH M3-1 24" X 12" INTERSTATE 95 M1-1 24" X 24" M6-1 21" X 15" M6-3 21" X 15"
7 TO M4-5 24" X 12" SOUTH M3-3 24" X 12" INTERSTATE 95 M1-1 24" X 24" M6-1 21" X 15"	8 TO M4-5 24" X 12" NORTH M3-1 24" X 12" INTERSTATE 95 M1-1 24" X 24" M6-1 21" X 15"	9 TO M4-5 24" X 12" HODGES CHAPEL RD WEST M3-4 24" X 12" M6-3 21" X 15"			

X1

R11-2 (48" X 30")
ROAD CLOSED

TYPE III BARRICADES WITH SUFFICIENT LENGTH TO CLOSE ENTIRE TRAVELWAY

X2

R11-4 (60" x 30")
ROAD CLOSED TO THRU TRAFFIC
DETOUR

M4-10L (48" x 18")
TYPE III BARRICADE

CMS MESSAGES PRIOR TO ROAD CLOSURE

CMS 1	CHANGEABLE MESSAGE SIGN EXIT 77 CLOSING STARTS MM/DD	CMS 2	CHANGEABLE MESSAGE SIGN RAMP CLOSING STARTS MM/DD
--------------	---	--------------	--

ALL PREVIOUS (GREY) SIGNS AND BARRICADES ERECTED FOR DETOUR TMP-A2D1

AREA 2
HODGES CHAPEL RD
RAMP C & D CLOSURE
FOR RAMP TIE-INS
DETOUR

4/1/2021 R:\Traf\Traf\Transportation Management\PLAN SHEETS\I-5986B TMP A2D4 AREA 02 PHASE 03.dgn Caroline.Owings