

DOCUMENT NOT CONSIDERED FINAL UNLESS ALL SIGNATURES COMPLETED

Michael Baker
INTERNATIONAL

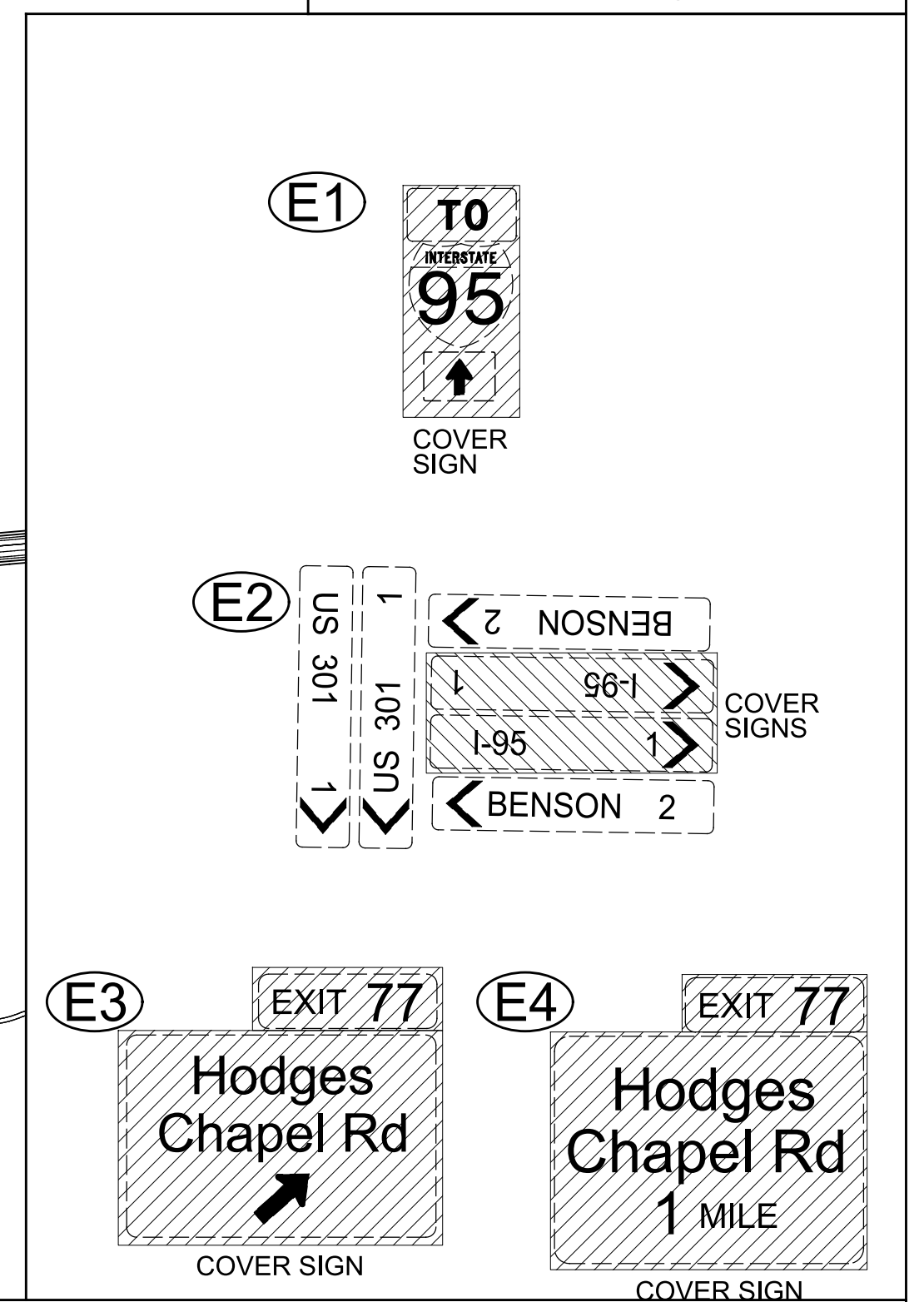
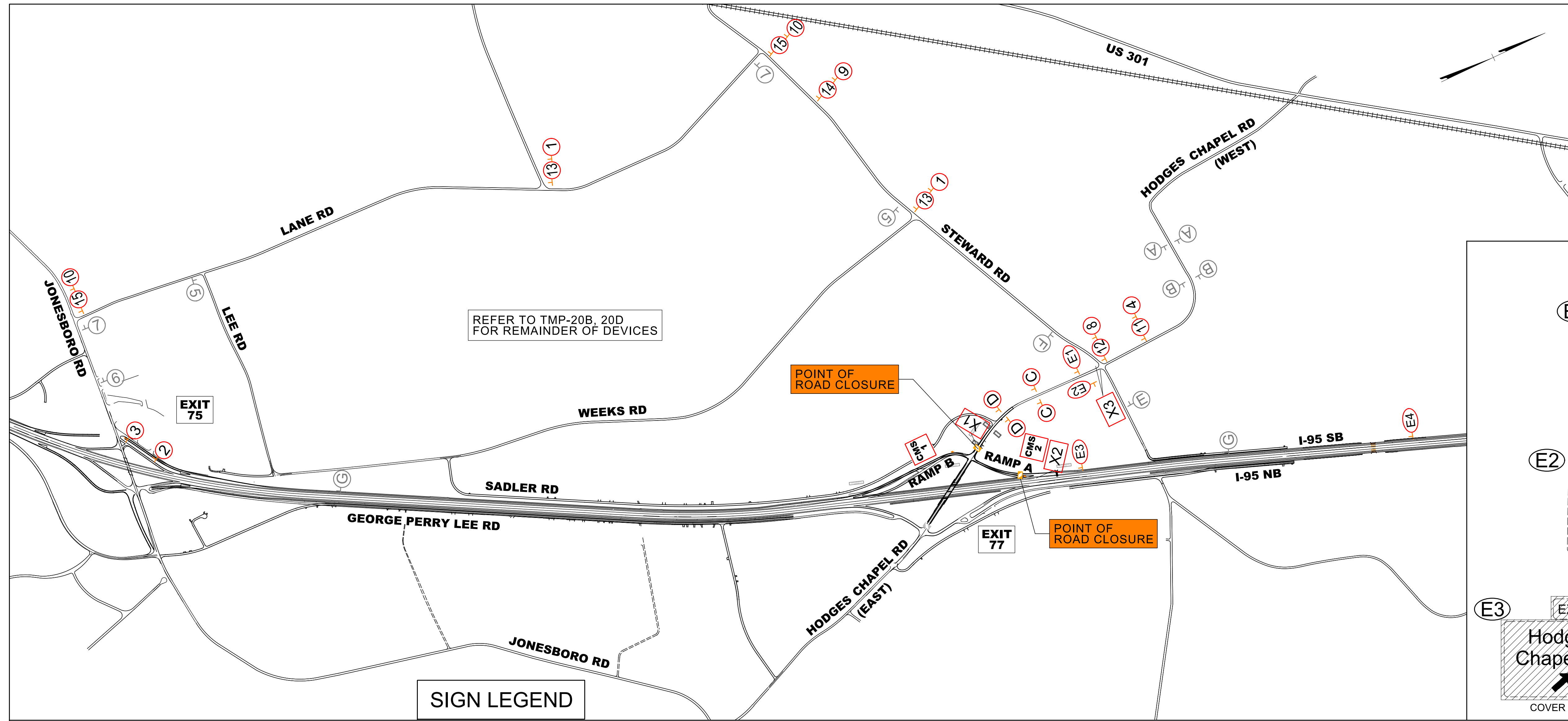

SIGN LEGEND

- A** W20-3 48" X 48"
- B** W20-2 48" X 48"
- C** W20-3 48" X 48"
- D** W20-3 48" X 48"
- E** W20-3 48" X 48" SP-4L 48" X 12"
- F** W20-3 48" X 48" SP-4R 48" X 12"
- G** SP-03 COVER CARDINAL DIRECTION
- 1** SP-13 (TYP) M3-2 24" X 12" M4-8 24" X 12" M6-3 21" X 15"
- 2** M4-5 24" X 12" M3-2 24" X 12" M4-8 24" X 12" M5-1R 21" X 15" M5-1L 21" X 15"
- 3** M4-5 24" X 12" M3-2 24" X 12" M4-8 24" X 12" M5-1R 21" X 15" M5-1L 21" X 15"
- 4** M3-2 24" X 12" M4-8 24" X 12" M5-1R 21" X 15"
- 5** M4-5 24" X 12" M3-4 24" X 12" M6-3 21" X 15"
- 6** M4-5 24" X 12" M3-4 24" X 12" M5-1R 21" X 15"
- 7** M4-5 24" X 12" M3-4 24" X 12" M6-1 21" X 15"
- 8** M3-2 24" X 12" M4-8 24" X 12" M6-1 21" X 15"
- 9** M3-2 24" X 12" M4-8 24" X 12" M5-1 21" X 15"
- 10** M3-2 24" X 12" M4-8 24" X 12" M6-1L 21" X 15"
- 11** M4-5 24" X 12" M1-1 24" X 24" M5-1R 21" X 15"
- 12** M4-5 24" X 12" M1-1 24" X 24" M6-1 21" X 15"
- 13** M4-5 24" X 12" M1-1 24" X 24" M6-3 21" X 15"
- 14** M4-5 24" X 12" M1-1 24" X 24" M5-1 21" X 15"
- 15** M4-5 24" X 12" M1-1 24" X 24" M6-1L 21" X 15"

CMS MESSAGES PRIOR TO ROAD CLOSURE

- CMS 1** RAMP CLOSING STARTS MM/DD
- CMS 2** EXIT 77 CLOSING STARTS MM/DD

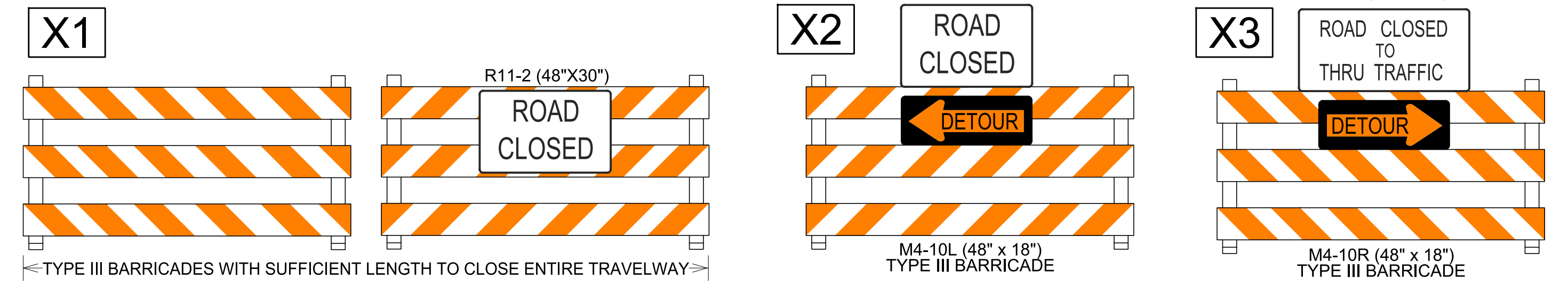

ALL PREVIOUS (GREY) SIGNS AND BARRICADES ERRECTED FOR DETOUR TMP-A2D1

AREA 2
HODGES CHAPEL RD
RAMP A & B CLOSURE
FOR RAMP TIE-INS
DETOUR

4/1/2021 R:\Trafico\Transportation Management\PLAN SHEETS\I-5986B TMP A2D3 AREA 02 PHASE 02.dgn Caroline.Owings