

PROJECT REFERENCE NO. I-5878	SHEET NO. TMP-A1D6
<p><b>DOCUMENT NOT CONSIDERED FINAL UNLESS ALL SIGNATURES COMPLETED</b></p>	
<p><b>Michael Baker INTERNATIONAL</b></p>	

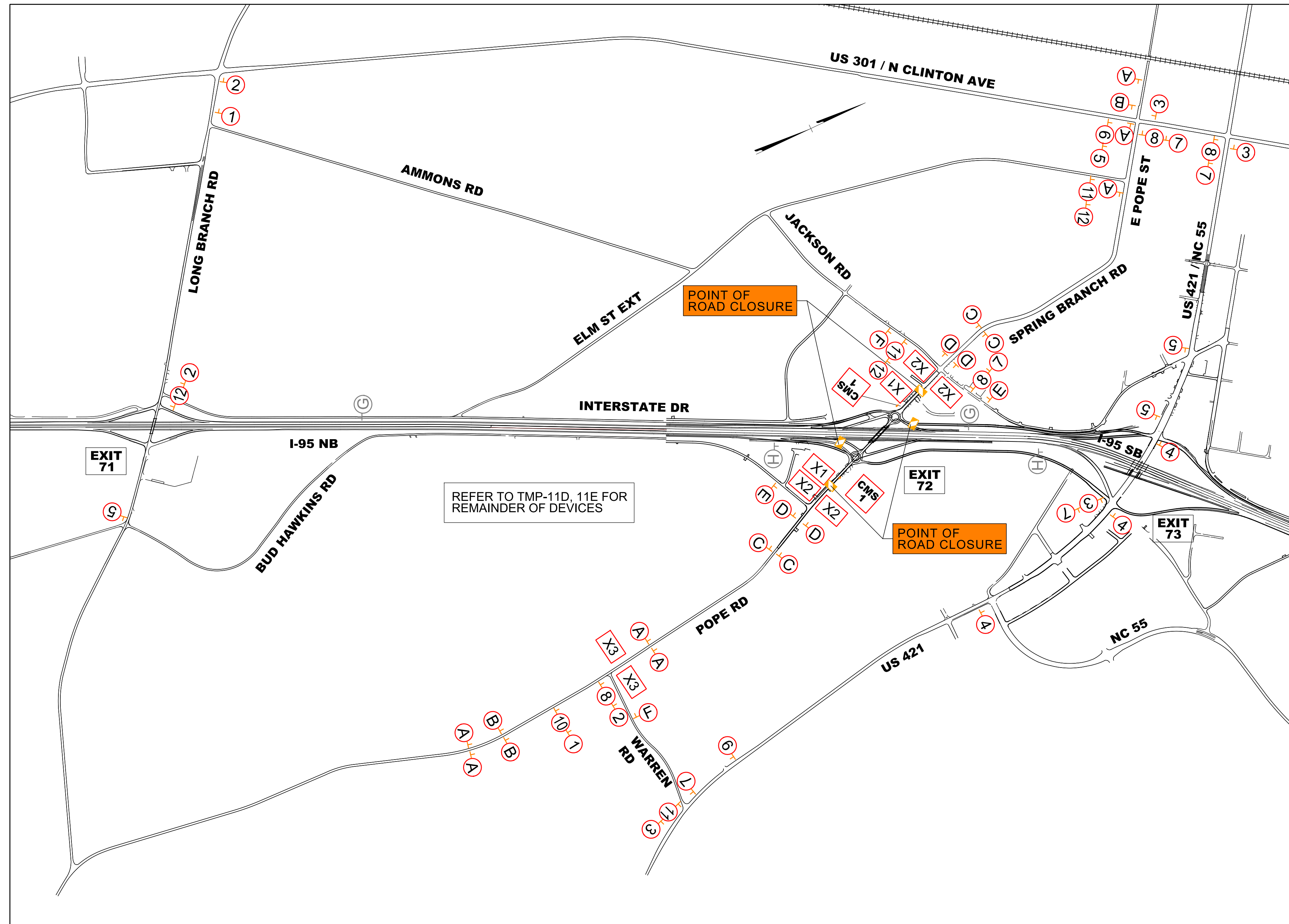

**SIGN LEGEND**

- A** ROAD CLOSED AHEAD  
W20-3 48" X 48"
- B** DETOUR AHEAD  
W20-2 48" X 48"
- C** ROAD CLOSED 1000 FT  
W20-3 48" X 48"
- D** ROAD CLOSED 500 FT  
W20-3 48" X 48"
- E** ROAD CLOSED  
W20-3 48" X 48"  
NEXT LEFT SP-4L 48" X 12"
- F** ROAD CLOSED  
W20-3 48" X 48"  
NEXT RIGHT SP-4R 48" X 12"
- 1** TO M4-5 24" X 12"  
SPRING BRANCH RD SP-11 (TYP)  
WEST M3-4 24" X 12"  
M5-1R 21" X 15"
- 2** TO M4-5 24" X 12"  
SPRING BRANCH RD  
WEST M3-4 24" X 12"  
M6-1 21" X 15"
- 3** TO M4-5 24" X 12"  
SPRING BRANCH RD  
WEST M3-4 24" X 12"  
M6-1L 21" X 15"
- 4** TO M4-5 24" X 12"  
SPRING BRANCH RD  
WEST M3-4 24" X 12"  
M6-3 21" X 15"
- 5** TO M4-5 24" X 12"  
POPE RD SP-12 (TYP)  
M6-3 21" X 15"
- 6** TO M4-5 24" X 12"  
INTERSTATE 95 M1-1 24" X 24"  
M6-3 21" X 15"
- 7** TO M4-5 24" X 12"  
POPE RD  
M6-1 21" X 15"
- 8** TO M4-5 24" X 12"  
INTERSTATE 95 M1-1 24" X 24"  
M6-1 21" X 15"
- 9** TO M4-5 24" X 12"  
POPE RD  
M5-1R 21" X 15"
- 10** TO M4-5 24" X 12"  
INTERSTATE 95 M1-1 24" X 24"  
M5-1R 21" X 15"
- 11** TO M4-5 24" X 12"  
INTERSTATE 95 M1-1 24" X 24"  
M6-1L 21" X 15"
- 12** TO M4-5 24" X 12"  
POPE RD  
M6-1L 21" X 15"

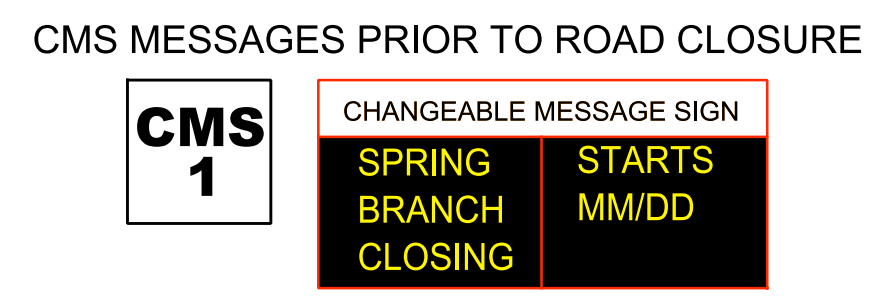
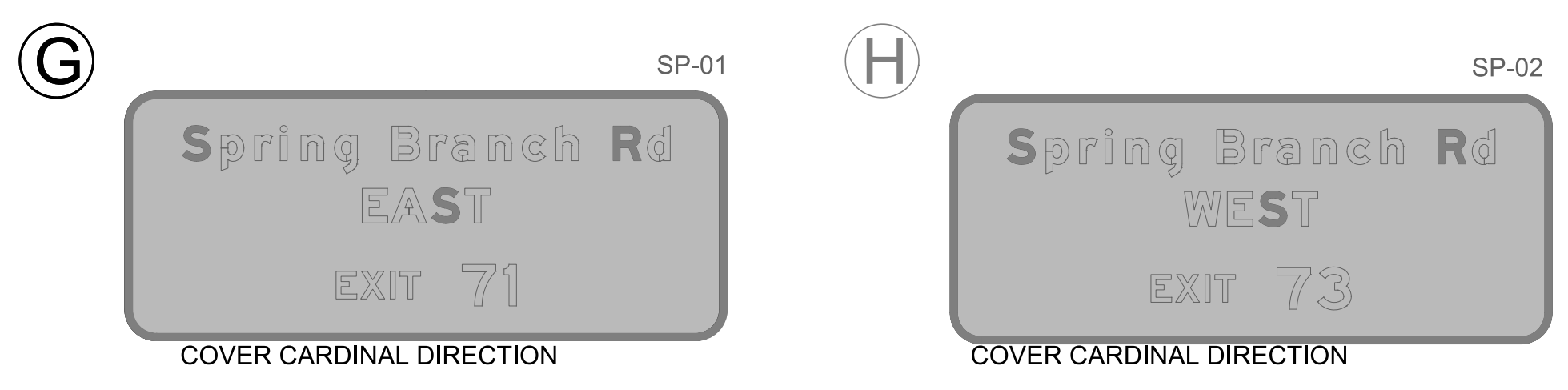
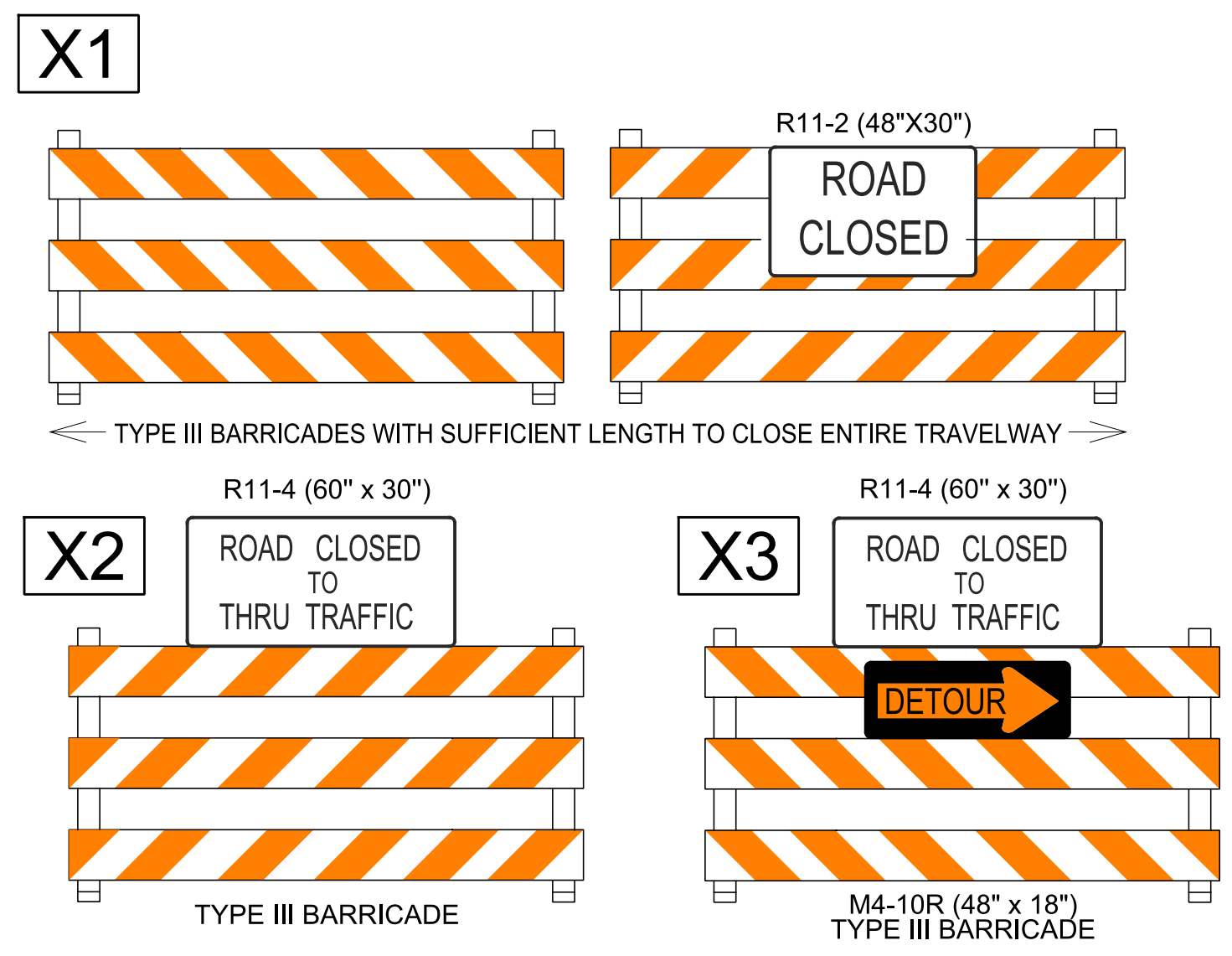

ALL PREVIOUS (GREY) SIGNS  
ERECTED FOR DETOUR TMP-A1D1

**AREA 1**  
SPRING BRANCH RD  
INTERCHANGE CLOSURE  
TO TIE IN ROUNDABOUTS  
DETOUR

4/1/2021 R:\Trafico\Transportation Management\PLAN SHEETS\I-5986B TMP A1D6 AREA 01PHASE 02.dgn Caroline Owings