

PROJECT REFERENCE NO. 1-5883		SHEET NO. 65	
RW SHEET NO.			
ROADWAY DESIGN ENGINEER SUNGATE DESIGN GROUP, P.A. SEAL 027373 SUSAN C. LANCASTER 5/13/2021		HYDRAULICS ENGINEER SUNGATE DESIGN GROUP, P.A. SEAL 26971 JOSHUA G. DALTON 5/12/2021	
DOCUMENT NOT CONSIDERED FINAL UNLESS ALL SIGNATURES COMPLETED			
Michael Baker Engineering, Inc. 1000 Regency Park Suite 600 Cary, NC 27518 Tel: 919.241.1000 Fax: 919.241.1001 NC License: P-1084		SUNGATE DESIGN GROUP, P.A. 602 ZONES FRANKER ROAD RALEIGH, NORTH CAROLINA 27604 NC CDA No. C-4890	

-SR17-

PI Sta 13+90.18 Δ = 90° 00' 00.0" (LT) D = 47° 44' 47.3" L = 188.50' T = 120.00' R = 120.00' SE = 0.04 RUNOFF = SEE PLANS	PI Sta 18+33.27 Δ = 17° 15' 19.8" (RT) D = 2° 27' 32.6" L = 701.72' T = 353.53' R = 2330.00' SE = 0.04 RUNOFF = SEE PLANS
------------------------------------------------------------------------------------------------------------------------------------------------	------------------------------------------------------------------------------------------------------------------------------------------------

-Y17-

PI Sta 35+08.75 Δ = 11° 32' 4" (RT) D = 3° 19' 52" L = 346.57' T = 173.87' R = 1720.00' SE = 0.04 RUNOFF = SEE PLANS

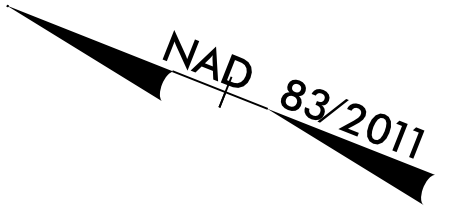

8/17/99

REVISIONS

R:\MAR-2021\08-43-2021\1-5883\RDY-159868.Rdy-159868.dgn

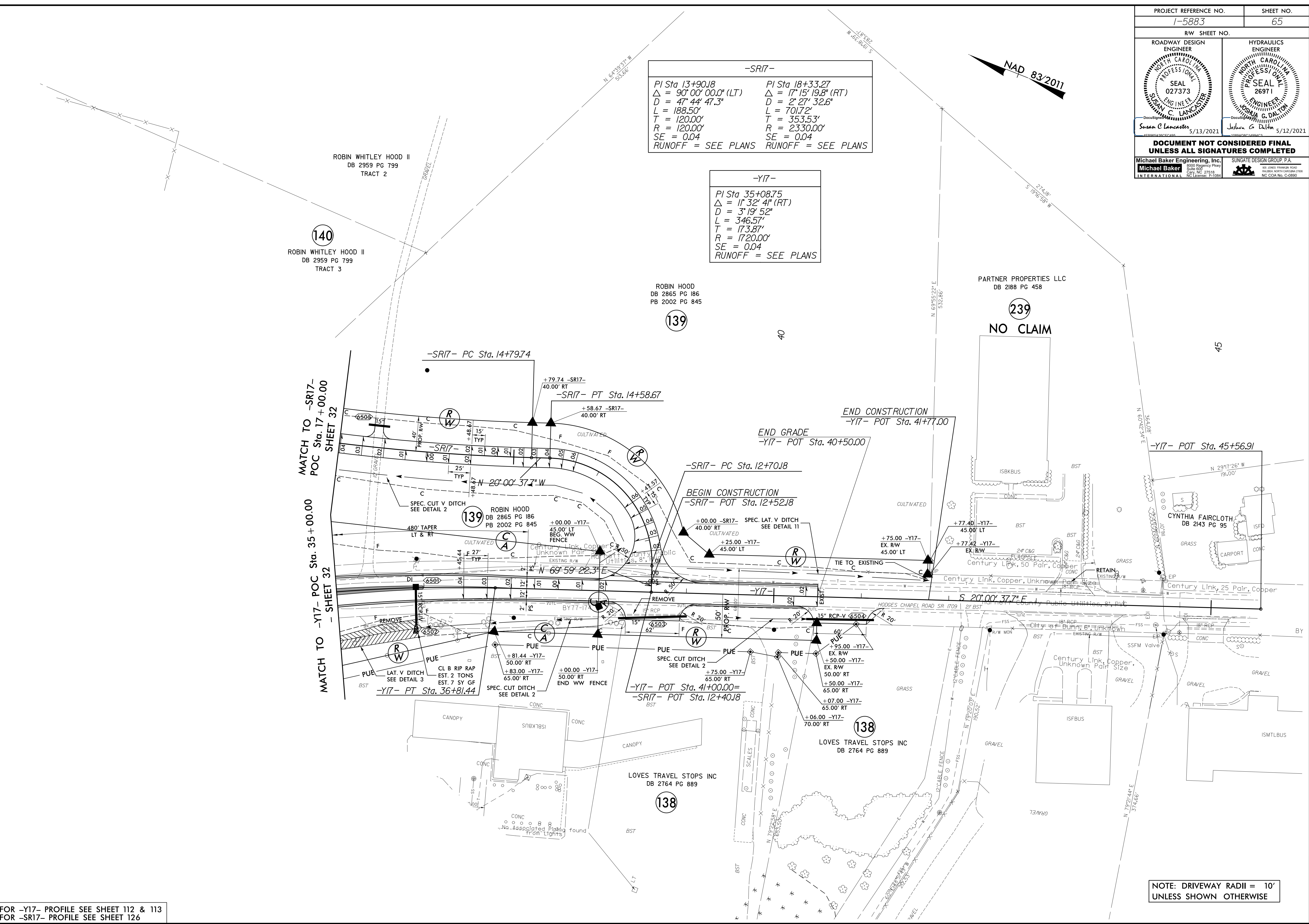

FOR -Y17- PROFILE SEE SHEET 112 & 113
FOR -SR17- PROFILE SEE SHEET 126

NOTE: DRIVEWAY RADII = 10'
UNLESS SHOWN OTHERWISE