

PROJECT REFERENCE NO. 1-5986B		SHEET NO. 44	
RW SHEET NO.			
ROADWAY DESIGN ENGINEER SEAL 027373 SUSAN C LANCASTER		HYDRAULICS ENGINEER SEAL 26971 JOSHUA G DALTON	
Susan C Lancaster 5/13/2021		Joshua G Dalton 5/12/2021	
DOCUMENT NOT CONSIDERED FINAL UNLESS ALL SIGNATURES COMPLETED			
Michael Baker Engineering, Inc. 1800 Regency Park Raleigh, NC 27618 NC License: F-1084		SUNGATE DESIGN GROUP, P.A. 10000 SunGate Blvd Raleigh, NC 27615 NC License: C-8899	

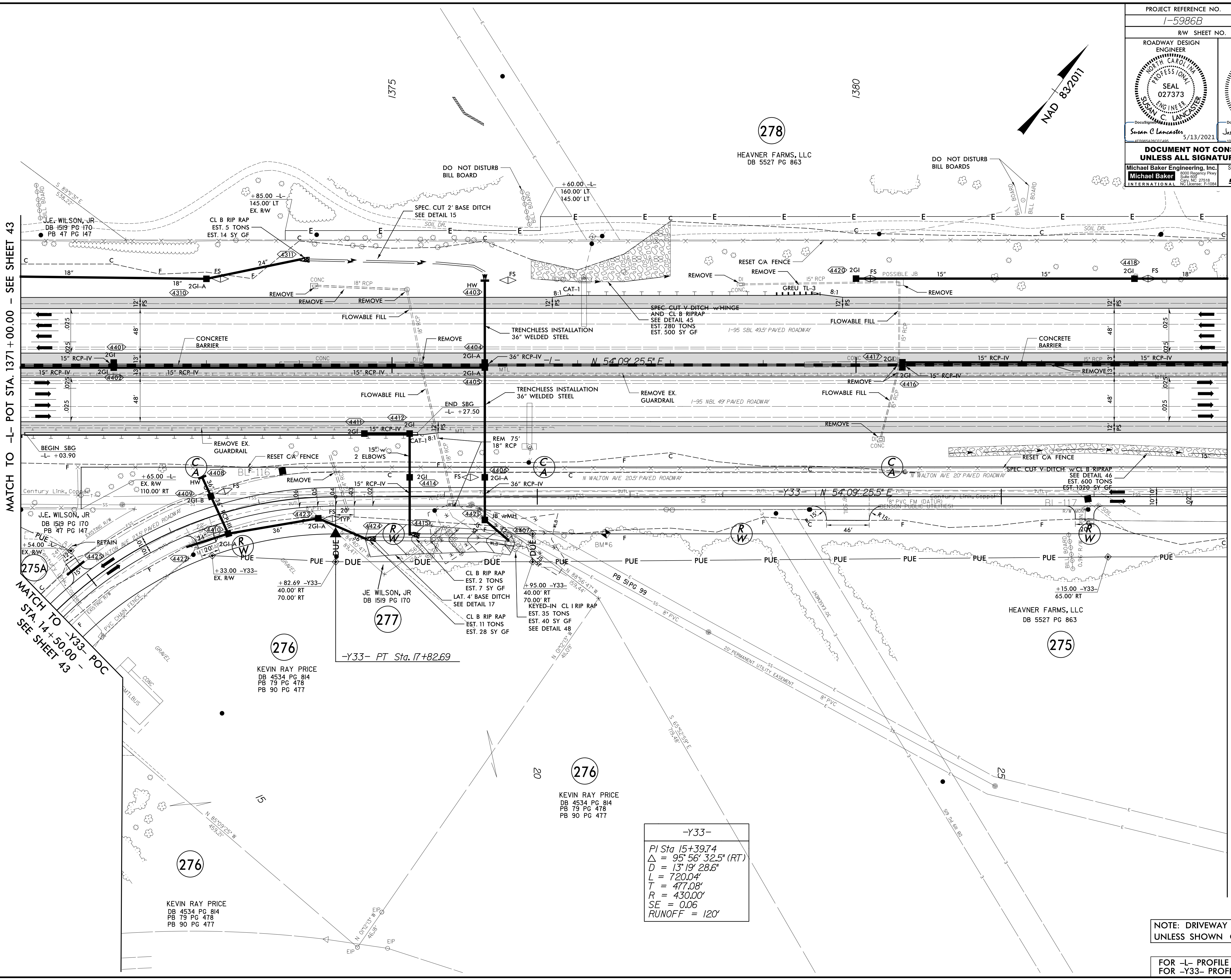
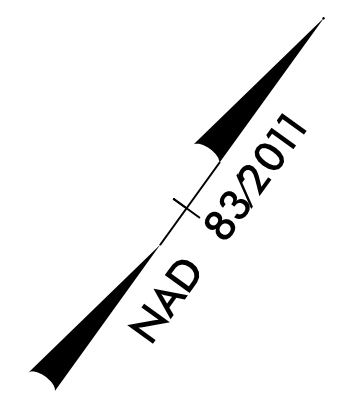

MATCH TO -L- POT STA. 1371 + 00.00 - SEE SHEET 43

MATCH TO -L- POT STA. 1384 + 00.00 - SEE SHEET 45

MATCH TO -Y33- POC
STA. 14 + 50.00 -
SEE SHEET 43

-Y33-
 PI Sta 15+39.74
 $\Delta = 95^\circ 56' 32.5''$ (RT)
 $D = 13' 19'' 28.6''$
 $L = 720.04'$
 $T = 477.08'$
 $R = 430.00'$
 $SE = 0.06$
 $RUNOFF = 120'$

NOTE: DRIVEWAY RADII = 10'
UNLESS SHOWN OTHERWISE

FOR -L- PROFILE SEE SHEETS 87
FOR -Y33- PROFILE SEE SHEET 140

REVISIONS

5/14/99

R:\05-APR-2021\1370-5986B_Rdly_psh_44.dgn
3:33:50 PM 5/14/2021