

PROJECT REFERENCE NO. 1-5986B		SHEET NO. 43	
RW SHEET NO.			
ROADWAY DESIGN ENGINEER SUSAN C LANCASTER SEAL 027373 5/13/2021		HYDRAULICS ENGINEER JOSHUA G DALTON SEAL 26971 5/12/2021	
DOCUMENT NOT CONSIDERED FINAL UNLESS ALL SIGNATURES COMPLETED			
Michael Baker Engineering, Inc. INTERNATIONAL		SUNGATE DESIGN GROUP, P.A.	

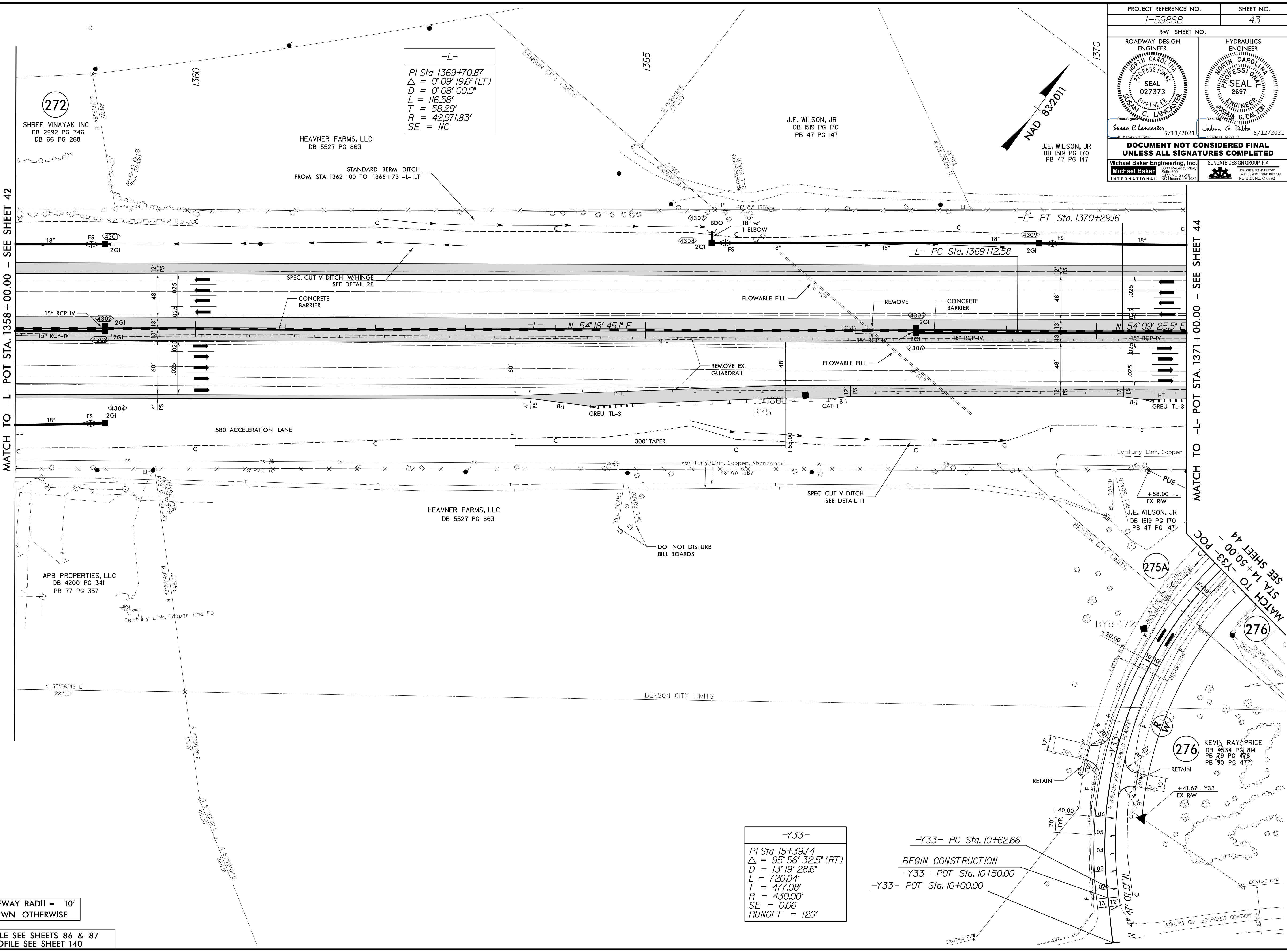

-L-
 PI Sta 1369+70.87
 $\Delta = 0^\circ 09' 19.6''$ (LT)
 $D = 0' 08' 00.0''$
 $L = 116.58'$
 $T = 58.29'$
 $R = 42,971.83'$
 $SE = NC$

-Y33-
 PI Sta 15+39.74
 $\Delta = 95^\circ 56' 32.5''$ (RT)
 $D = 13' 19' 28.6''$
 $L = 720.04'$
 $T = 477.08'$
 $R = 430.00'$
 $SE = 0.06$
 $RUNOFF = 120'$

-Y33- PC Sta. 10+62.66
BEGIN CONSTRUCTION
-Y33- POT Sta. 10+50.00
-Y33- POT Sta. 10+00.00

NOTE: DRIVEWAY RADII = 10'
UNLESS SHOWN OTHERWISE

FOR -L- PROFILE SEE SHEETS 86 & 87
FOR -Y33- PROFILE SEE SHEET 140

REVISIONS

5/14/99

R:\12-MAR-2021\08155-5986B_Rdly_psh_43.dgn
 11:59:59 AM 3/15/21

MATCH TO -L- POT STA. 1358 + 00.00 - SEE SHEET 42

MATCH TO -L- POT STA. 1371 + 00.00 - SEE SHEET 44

MATCH TO -Y33- POT STA. 14 + 50.00 - SEE SHEET 44

276 KEVIN RAY PRICE
DB 4534 PG 814
PB 79 PG 478
PB 90 PG 477

275A
 J.E. WILSON, JR
 DB 1519 PG 170
 PB 47 PG 147

272 SHREE VINAYAK INC
DB 2992 PG 746
DB 66 PG 268

HEAVNER FARMS, LLC
DB 5527 PG 863

APB PROPERTIES, LLC
DB 4200 PG 341
PB 77 PG 357

J.E. WILSON, JR
DB 1519 PG 170
PB 47 PG 147

J.E. WILSON, JR
DB 1519 PG 170
PB 47 PG 147

HEAVNER FARMS, LLC
DB 5527 PG 863

Michael Baker Engineering, Inc.
INTERNATIONAL

SUNGATE DESIGN GROUP, P.A.