

PROJECT REFERENCE NO. 1-5986B		SHEET NO. 40	
RW SHEET NO.			
ROADWAY DESIGN ENGINEER SEAL 027373 SUSAN C LANCASTER		HYDRAULICS ENGINEER SEAL 26971 JOSHUA G DALTON	
Susan C Lancaster 5/13/2021		Joshua G Dalton 5/12/2021	
DOCUMENT NOT CONSIDERED FINAL UNLESS ALL SIGNATURES COMPLETED			
Michael Baker Engineering, Inc. 1000 Poplarway Raleigh, NC 27615 Tel: 919.876.7000 Fax: 919.876.7001 NC License: P-1084		SUNGATE DESIGN GROUP, P.A. 1400 S. W. 10th St. Maitland, FL 32751 Tel: 407.876.7000 Fax: 407.876.7001 FL License: C-0899	

-L-

Pls Sta 1314+01.00 Os = 1' 28' 48.0" Ls = 296.00' LT = 197.34' ST = 98.67'	Pls Sta 1330+88.15 Δ = 30° 59' 22.4" (RT) D = 1' 00' 00.0" L = 3,098.96' T = 1,588.39' R = 5,729.58' SE = 0.04	Pls Sta 1346+97.38 Os = 1' 28' 48.0" Ls = 296.00' LT = 197.34' ST = 98.67'
--	--	--

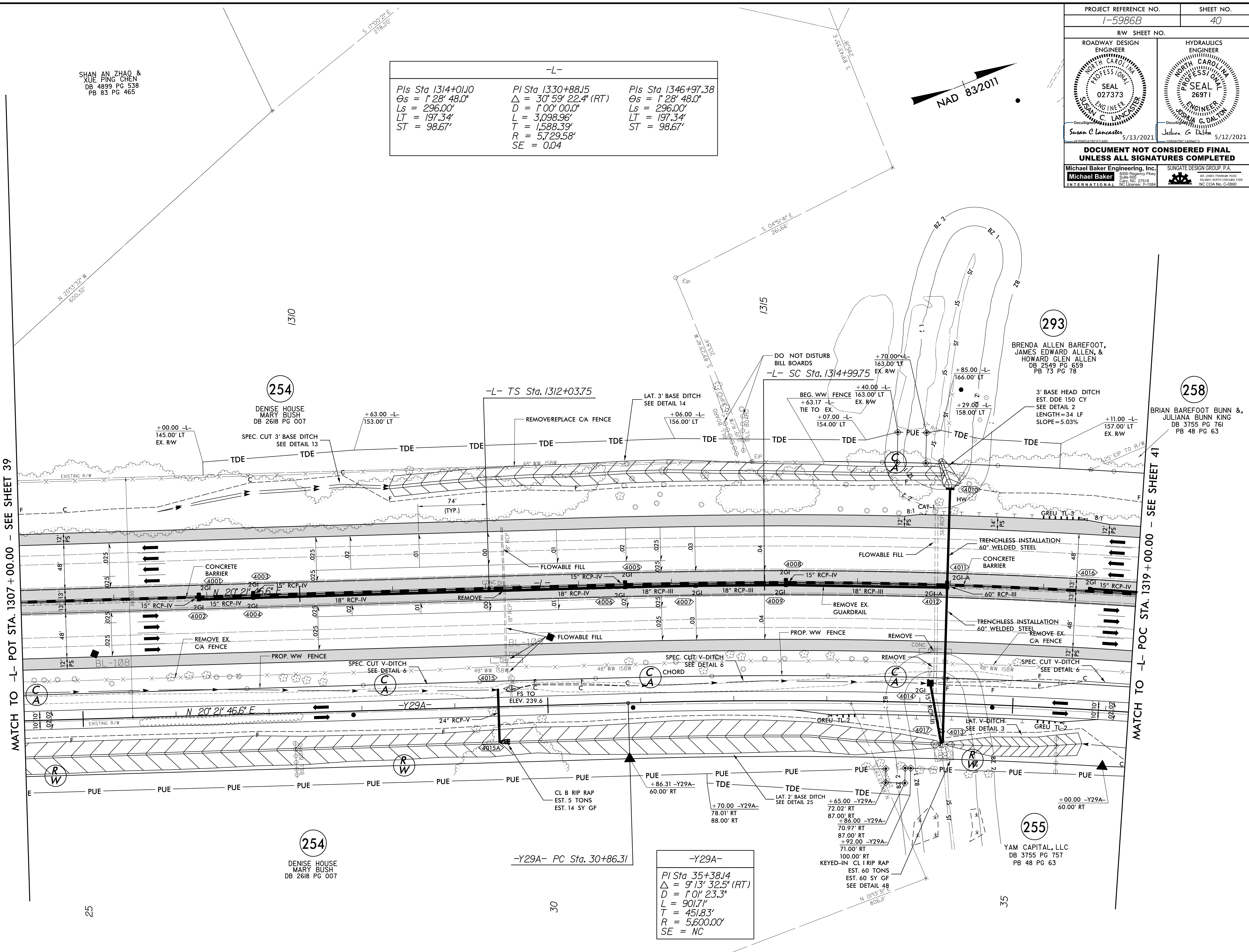

-Y29A-

Pls Sta 35+38.14 Δ = 9° 13' 32.5" (RT) D = 1' 01' 23.3" L = 901.71' T = 451.83' R = 5,600.00' SE = NC
---

MATCH TO -L- POT STA. 1307 + 00.00 - SEE SHEET 39

MATCH TO -L- POC STA. 1319 + 00.00 - SEE SHEET 41

REVISIONS

R:\06-APR-2021\2104-5986B\_Rdly\_psh\_40.dgn