

(-)-0.5000% (-)-2.5792%

(-)-2.5792% (-)-0.3088%

**GRADE DATA**

PI STA. 46+90.00 -L-  
EL. = 20.55  
VC = 250'

**GRADE DATA**

PI STA. 52+20.00 -L-  
EL. = 6.88  
VC = 220'

SPAN W

SPAN X

SPAN Y

SPAN Z

SPAN AA

SPAN BB

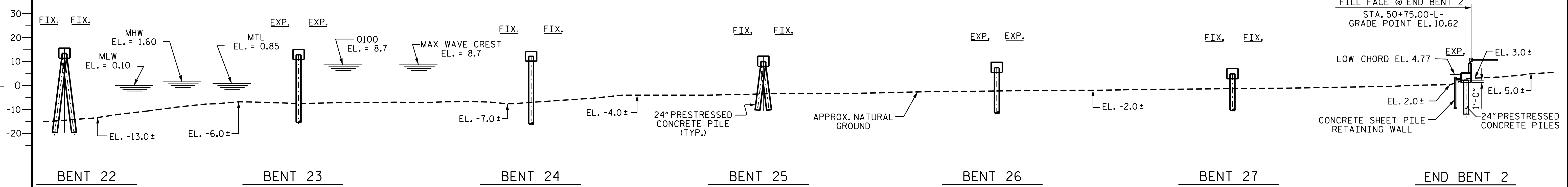

**SECTION ALONG -L-**

(SECTIONS @ BENTS AND END BENT ARE TAKEN AT RIGHT ANGLES)

**HORIZONTAL CURVE DATA**

PI STA.	= 34+74.21 -L-	PI STA.	= 51+04.28 -L-
Δ	= 27°-28'-03.8" (LT.)	Δ	= 14°-20'-50.1" (RT.)
D	= 1°-08'-45.3"	D	= 2°-23'-14.4"
L	= 2397.01'	L	= 600.98'
T	= 1222.00'	T	= 302.07'
R	= 5000.00'	R	= 2400.00'

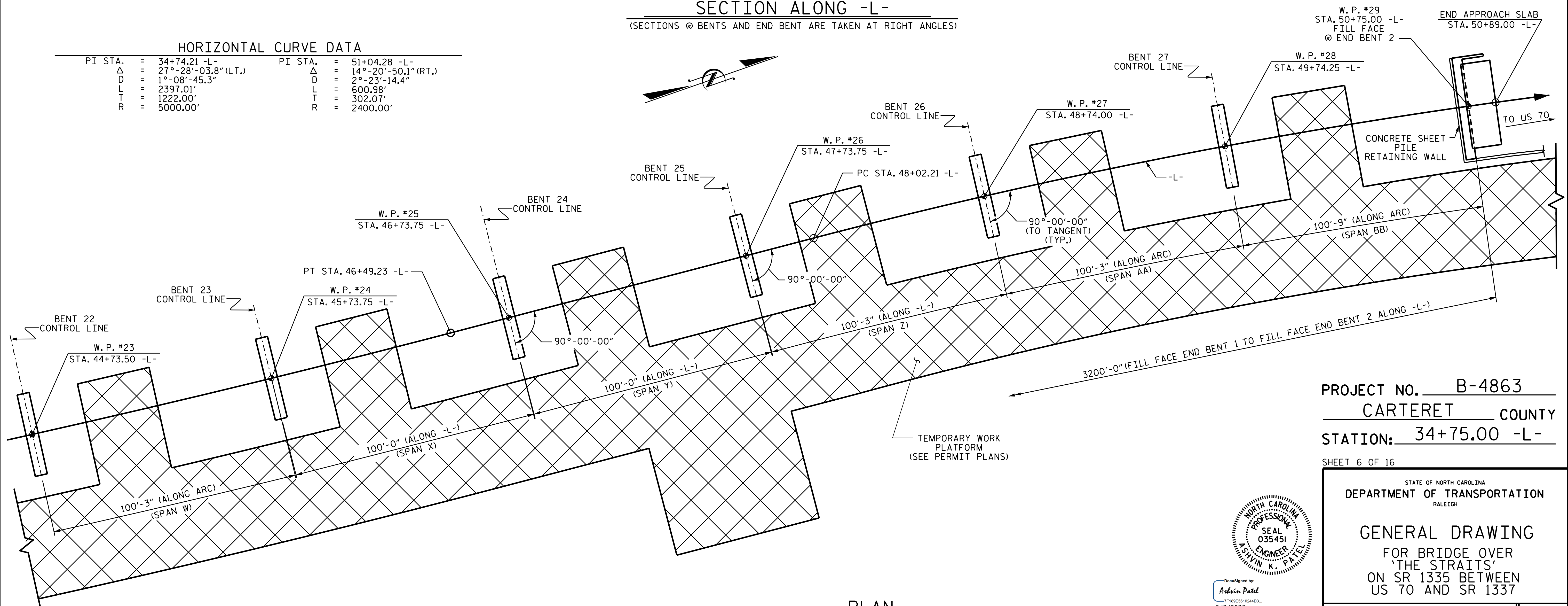

PROJECT NO. B-4863  
CARTERET COUNTY  
STATION: 34+75.00 -L-

SHEET 6 OF 16

STATE OF NORTH CAROLINA  
DEPARTMENT OF TRANSPORTATION  
RALEIGH

**GENERAL DRAWING**  
FOR BRIDGE OVER  
'THE STRAITS'  
ON SR 1335 BETWEEN  
US 70 AND SR 1337



DocuSigned by:  
Ashwin Patel  
7F186E6102403  
3/9/2020

DRAWN BY : B. N. BARODAWALA DATE : 4-19  
CHECKED BY : M. A. ALLEN DATE : 11-19  
DESIGN ENGINEER OF RECORD : A. K. PATEL DATE : 01-20

**PLAN**  
PILES NOT SHOWN FOR CLARITY

DOCUMENT NOT CONSIDERED  
FINAL UNLESS ALL  
SIGNATURES COMPLETED

REVISIONS						SHEET NO.
NO.	BY:	DATE:	NO.	BY:	DATE:	S1-008
1			3			TOTAL SHEETS 194
2			4			