

PLANTING DETAILS

DIBBLE PLANTING METHOD USING THE KBC PLANTING BAR

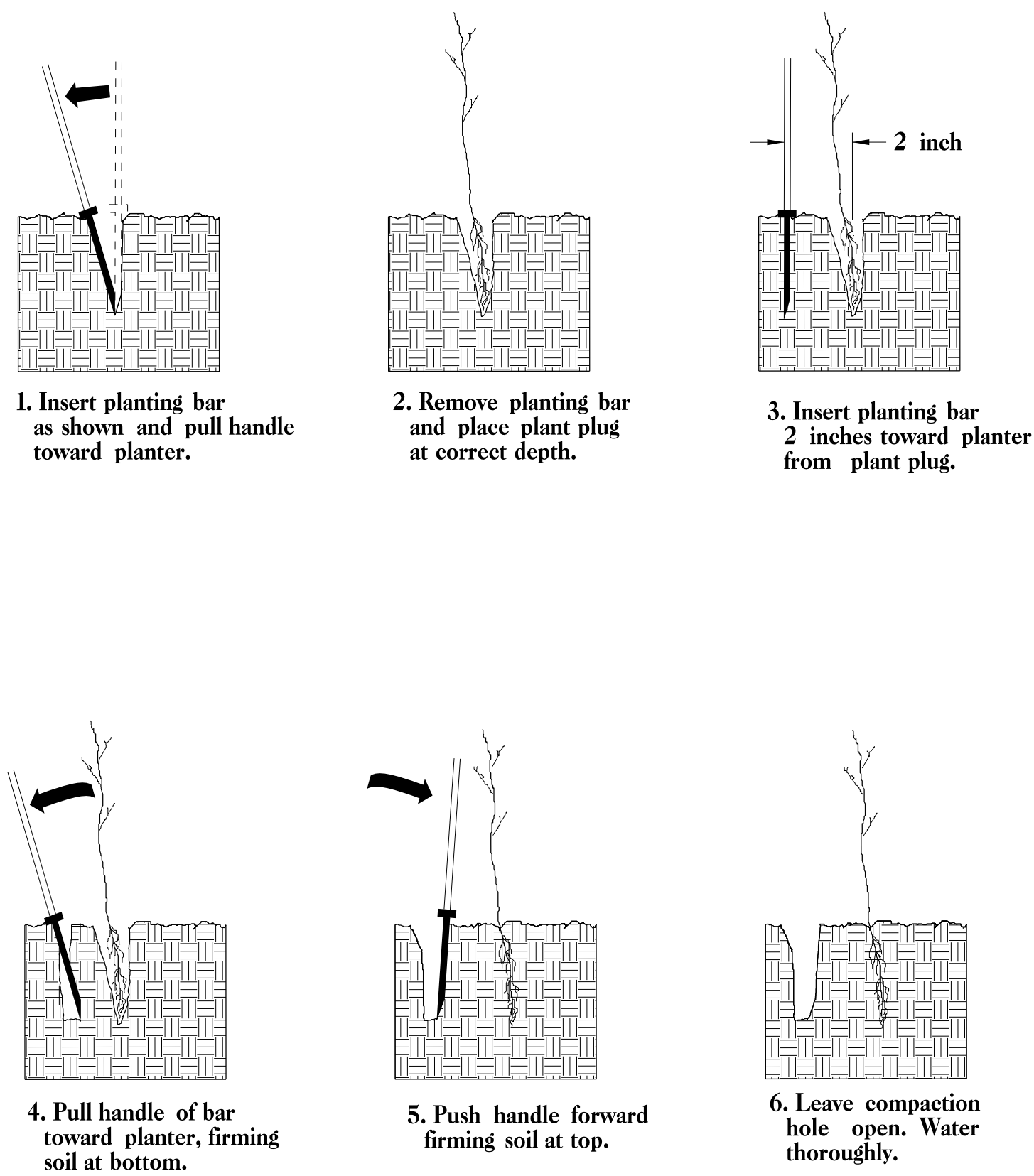

PLANTING NOTES:

PLANTING BAG
During planting, plant plugs shall be kept in a moist canvas bag or similar container to prevent the root systems from drying.



KBC PLANTING BAR
Planting bar shall have a blade with a triangular cross section, and shall be 12 inches long, 4 inches wide and 1 inch thick at center.

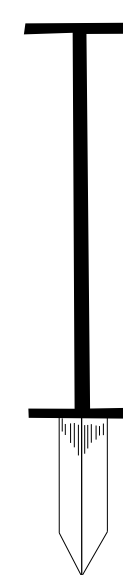

WETLAND GRASS PLANTING

- WETLAND GRASS SPECIES SHALL BE PLANTED 2 FT. TO 4 FT. ON CENTER, RANDOM SPACING, AVERAGING 3 FT. ON CENTER, APPROXIMATELY 4840 PLANTS PER ACRE.

WETLAND GRASS PLANTING AREA 1 (PATENS)

MIXTURE, TYPE, SIZE, AND FURNISH SHALL CONFORM TO THE FOLLOWING:

100% SPARTINA PATENS SALTMEADOW CORDGRASS 2 in PEAT POT

WETLAND GRASS PLANTING AREA 2 (ALTERNIFLORA)

MIXTURE, TYPE, SIZE, AND FURNISH SHALL CONFORM TO THE FOLLOWING:

100% SPARTINA ALTERNIFLORA SMOOTH CORDGRASS 2 in PEAT POT

WETLAND GRASS PLANTING DETAIL SHEET